



Hello

It's time to go outrageously mad and live on the funky edge with the original Nokia 3220! Flash it, dress it, snap pictures with it, wave it around in the air and write with it. It's cool, crazy and absolutely addictive!

Get a groovy grip right away, with Xpress-on™ Grips on each side of the phone. Eye-catching tri-colour lights on the Xpress-on™ Grips and keypad sync rhythmically with your tones, Java™⁴ games, SMS¹, MMS² and other phone functions to give you a truly personal and psychedelic mobile experience. Customise your fun further with do-it-yourself Cut-out covers³ and UI themes. Or, download your favourites using the xHTML² Browser, and fully transform the back of your phone as well as its 65,536 colours screen to reflect the real you! With an in-built camera and video recorder¹, you can fully explore your creativity. And, let your imagination go wild with the Enhanced Image Editor.

Wave 'hi' to your buddy or say anything else you like magically. The Tri-band enabled Nokia 3220 is the first-ever Nokia mobile phone with a 'Wave Message's that lets you literally write words and show pictures in the air. Just put on an Xpress-on™ Fun Shell³ and start moving those arms! With it, you can also play exciting motion games with radical sensory light and vibration effects.

Have fun!

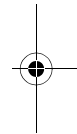
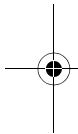

The Nokia 3220 supports a display resolution of 128 x 128 pixels. The image resolution shown in the advertising materials may vary from that displayed by the actual product.

1 Honour the privacy of others and follow local laws when recording image and voice.

2 Operations and some features such as SMS, MMS, HSCSD, GPRS, EDGE and others are SIM card and/or network dependent. Some features of this device such as POP3, IMAP4, SMTP and others require network support for WAP 2.0 and TCP/IP and thus will only be available if supported by network operator. Please check with your local network operator. Please check the roaming agreement availability with your network operator. MMS-related services are dependent on the network as well as on the compatibility of the devices used and the content formats supported. Some services are subject to a separate charge.

3 This is an optional enhancement and must be purchased separately. Availability is market dependent. Please check with your dealer.

4 Java™ is a trademark of Sun Microsystems, Inc. Other product and company names mentioned herein may be trademarks or trade names of their respective owners.

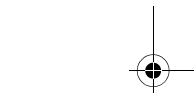
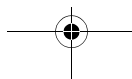

Welcome to your **Nokia** phone

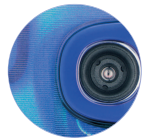

Integrated VGA Camera and Video Recorder

- Snap a picture or record an audio-video clip.

Talk key

- Dials a phone number and answers a call.
- Press  as a shortcut key for the select function when browsing mobile services.
- In standby mode: press to show the most recently dialled number.

Number keys

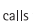
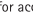
- Enter numbers and characters.
-  calls your voice mailbox when pressed and held.
- Press and hold  as a shortcut key for accessing mobile services.



Used for various purposes in different functions.

Power key

- Switches the phone on or off when pressed and held.
- When pressed briefly during a call or when in standby mode: enters the list of Profiles.

Selection keys

- Perform the function indicated by the text above it.
- During a call, press to activate Handsfree Loudspeaker.

End key

- Ends or rejects a call. Also exits from any function and goes to standby mode.

4-way scroll key

- Scrolls through names, phone numbers, menus or setting options.
- In standby mode, press the respective keys to quickly access some functions:
 - 'Up' – Camera and Video Recorder
 - 'Down' – Contacts
 - 'Centre' – Menu
 - 'Left' – Text Message Editor
 - 'Right' – Calendar

Tri-colour Xpress-on™ Grips

- Light up in sync with incoming calls, SMS, MMS and when playing games.

DECLARATION OF CONFORMITY

We, NOKIA CORPORATION declare under our sole responsibility that the product RH-37 is in conformity with the provisions of the following Council Directive: 1999/5/EC.

A copy of the Declaration of Conformity can be found from http://www.nokia.com/phones/declaration_of_conformity/.

CE 168

Copyright © 2005 Nokia. All rights reserved.

Reproduction, transfer, distribution or storage of part or all of the contents in this document in any form without the prior written permission of Nokia is prohibited.

Nokia, Nokia Connecting People, Xpress-on and Pop-Port are trademarks or registered trademarks of Nokia Corporation. Other product and company names mentioned herein may be trademarks or tradenames of their respective owners.

Nokia tune is a sound mark of Nokia Corporation.

US Patent No 5818437 and other pending patents. T9 text input software Copyright (C) 1997-2005. Tegic Communications, Inc. All rights reserved.



Includes RSA BSAFE cryptographic or security protocol software from RSA Security.



Java is a trademark of Sun Microsystems, Inc.

Nokia operates a policy of continuous development. Nokia reserves the right to make changes and improvements to any of the products described in this document without prior notice.

Under no circumstances shall Nokia be responsible for any loss of data or income or any special, incidental, consequential or indirect damages howsoever caused.

The contents of this document are provided "as is". Except as required by applicable law, no warranties of any kind, either express or implied, including, but not limited to, the implied warranties of merchantability and fitness for a particular purpose, are made in relation to the accuracy, reliability or contents of this document. Nokia reserves the right to revise this document or withdraw it at any time without prior notice.

The availability of particular products may vary by region. Please check with the Nokia dealer nearest to you.

Export Controls

This device may contain commodities, technology or software subject to export laws and regulations from the US and other countries. Diversion contrary to law is prohibited.

English

Issue 2

Contents

FOR YOUR SAFETY.....	iv
General information	vi
About your device	vi
Overview of the functions of the phone.....	vi
Shared memory	vii
Access codes.....	vii
Security code (5 to 10 digits).....	vii
PIN and PIN2 codes (4 to 8 digits), Module PIN and Signing PIN.....	vii
PUK and PUK2 codes (8 digits)	vii
Barring password (4 digits).....	vii
Wallet code (4 to 10 digits).....	vii
Network services	viii
Configuration settings service	viii
Nokia support on the Web.....	ix
1. Getting started	1
Installing the SIM card and the battery.....	1
Charging the battery.....	2
Switching the phone on and off.....	3
Normal operating position.....	3
Changing the covers.....	3
Changing the grips.....	4
Creating cut-out covers	4
Changing the cut-out cover.....	5
Putting on a wrist strap	5
2. Your phone.....	6
Keys and connectors.....	6
Standby mode	6
Wallpaper.....	7
Screen saver	7
Power saving	7
Essential indicators	7
Keypad lock (Keyguard)	8
3. Call functions.....	9
Making a call.....	9
Speed dialling a phone number.....	9
Answering or rejecting an incoming call	9
Call waiting	9
Options during a call	10
Writing text.....	10
Setting predictive text input on or off.....	10
Using predictive text input	10
Using traditional text input.....	11
Tips for writing text	11
4. Using the menu	13
Accessing a menu function	13
List of menu functions.....	14
5. Menu functions.....	16
Messages.....	16
Text messages (SMS)	16
Multimedia messages (MMS).....	18
Flash messages	21
Instant messages (Chat).....	21
E-mail application	26
Voice messages.....	27
Info messages	28
Service commands.....	28
Deleting all messages from a folder	28
Message settings.....	28
Message counter	30
Call register.....	30
Counters and timers for calls, data and messages	31
Positioning information	31
Contacts	31
Selecting settings for contacts	31
Saving names and phone numbers(Add contact)	32
Saving multiple numbers or text items or an image per name.....	32

Searching for a contact	32	using services	56
Editing or deleting details	33	Setting up the phone for a	
My presence	33	service	56
Subscribed names	35	Making a connection to a	
Sending and receiving a		service	56
business card	36	Browsing the pages of a service..	57
Speed dials	37	Disconnect from a service	57
Voice dialling	37	Appearance settings of the	
Settings	38	browser	58
Profiles	38	Cookies	58
Themes	38	Bookmarks	58
Tone settings	39	Downloading	59
Light settings	39	Service inbox	59
Personal shortcuts	39	The cache memory	60
Display settings	40	Browser security	60
Time and date settings	40	SIM services	62
Call settings	40	6. PC Connectivity	63
Phone settings	41	PC Suite	63
Connectivity	42	(E)GPRS, HSCSD and CSD	64
Enhancement settings	43	Using data communication	
Configuration settings	43	applications	64
Security settings	44	7. Battery information	65
Restore factory settings	45	Charging and Discharging	65
Operator menu	45	8. Genuine Enhancements	66
Gallery	45	Power	66
Media	46	Standard Charger (ACP-7)	66
Camera	46	Travel Charger (ACP-12)	67
Voice recorder	47	Audio	67
Organiser	47	Boom Headset (HDB-4)	67
Alarm clock	47	9. Care and maintenance	68
Calendar	48	10. Additional safety	
To-do list	49	information	69
Notes	49	Limited Warranty	73
Synchronisation	49	Index	74
Applications	50		
Games and applications	50		
Calculator	51		
Countdown timer	52		
Stopwatch	52		
Wallet	53		
Services	55		
Basic steps for accessing and			

FOR YOUR SAFETY

Read these simple guidelines. Not following them may be dangerous or illegal. Read the complete user guide for further information.



SWITCH ON SAFELY

Do not switch the phone on when wireless phone use is prohibited or when it may cause interference or danger.



ROAD SAFETY COMES FIRST

Obey all local laws. Always keep your hands free to operate the vehicle while driving. Your first consideration while driving should be road safety.



INTERFERENCE

All wireless phones may be susceptible to interference, which could affect performance.



SWITCH OFF IN HOSPITALS

Follow any restrictions. Switch the phone off near medical equipment.



SWITCH OFF IN AIRCRAFT

Follow any restrictions. Wireless devices can cause interference in aircraft.



SWITCH OFF WHEN REFUELLING

Don't use the phone at a refuelling point. Don't use near fuel or chemicals.



SWITCH OFF NEAR BLASTING

Follow any restrictions. Don't use the phone where blasting is in progress.



USE SENSIBLY

Use only in the normal position as explained in the product documentation. Don't touch the antenna unnecessarily.



QUALIFIED SERVICE

Only qualified personnel may install or repair this product.



ENHANCEMENTS AND BATTERIES

Use only approved enhancements and batteries. Do not connect incompatible products.



WATER-RESISTANCE

Your phone is not water-resistant. Keep it dry.



BACK-UP COPIES

Remember to make back-up copies or keep a written record of all important information stored in your phone.



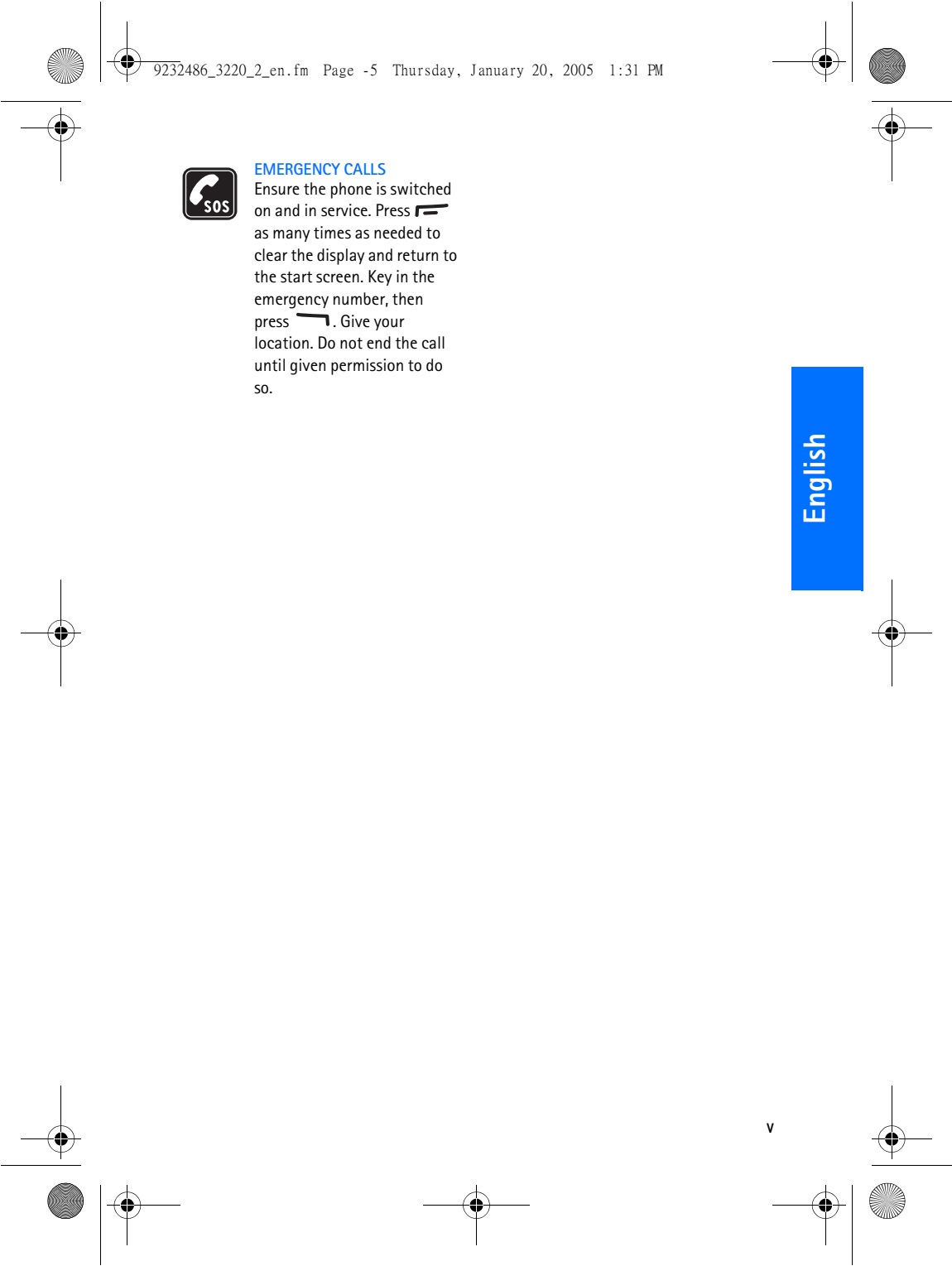

CONNECTING TO OTHER DEVICES

When connecting to any other device, read its user guide for detailed safety instructions. Do not connect incompatible products.



EMERGENCY CALLS

Ensure the phone is switched on and in service. Press  as many times as needed to clear the display and return to the start screen. Key in the emergency number, then press . Give your location. Do not end the call until given permission to do so.

English

General information

General information

About your device

The wireless device described in this guide is approved for use on the EGSM 900, GSM 1800 and GSM 1900 network. Contact your service provider for more information about networks.

When using the features in this device, obey all laws and respect privacy and legitimate rights of others.



Warning: To use any features in this device, other than the alarm clock, the device must be switched on. Do not switch the device on when wireless device use may cause interference or danger.

Your device and its enhancements may contain small parts. Keep them out of the reach of small children.

For availability of approved enhancements, please check with your dealer. When you disconnect the power cord of any enhancement, grasp and pull the plug, not the cord.

Overview of the functions of the phone

The Nokia 3220 phone provides many functions that are practical for daily use, such as a calendar, a clock, an alarm clock, and a built-in camera. Personalise your phone with cut-out covers and with themes. Also, a range of Nokia Xpress-on™ covers and Nokia Xpress-on™ grips are available for your phone. Some functions are

- Multimedia messaging. See Multimedia messages (MMS) on page 18.
- Instant messages, see Instant messages (Chat) on page 21.
- Presence-enhanced contacts, see My presence on page 33.
- E-mail application, see E-mail application on page 26.
- EDGE (Enhanced Data rates for GSM Evolution), see (E)GPRS on page 42.
- Java 2 Micro Edition, J2ME™, see Applications on page 50.
- xHTML browser, see Services on page 55.

Shared memory

The phone has three different memories. The following features in this device may share the first memory: contacts, text messages, instant messages and SMS e-mails, voice tags, calendar and notes. The second shared memory is used by multimedia messages, files stored in Gallery and configuration settings. The third shared memory is used by e-mail application, Java games and applications. Use of one or more of these features may reduce the memory available for the remaining features sharing the same memory. For example, saving many Gallery items may use all of the available memory in the second memory. Your device may display a message that the memory is full when you try to use a shared memory feature. In this case, delete some of the information or entries stored in the corresponding shared memory before continuing.

Access codes

Security code (5 to 10 digits)

The security code helps to protect your phone against unauthorised use. The pre-set code is 12345. To change the code, and to set the phone to request the code, see Security settings on page 44.

PIN and PIN2 codes (4 to 8 digits), Module PIN and Signing PIN

- The PIN (Personal Identification Number) code helps to protect your SIM card against unauthorised use. See Security settings on page 44.
- The PIN2 code may be supplied with the SIM card and is required to access some functions, such as call counters.
- The module PIN is required to access the information in the security module. See Security module on page 60.
- The signing PIN is required for the digital signature. See Digital signature on page 62.

PUK and PUK2 codes (8 digits)

The PUK (Personal Unblocking Key) code is required to change a blocked PIN code. The PUK2 code is required to change a blocked PIN2 code.

Barring password (4 digits)

The barring password is required when using the [Call barring service](#), see Security settings on page 44.

Wallet code (4 to 10 digits)

The wallet code is required to access the wallet services. For further information, see Wallet on page 53.

General information

■ Network services

To use the phone you must have service from a wireless service provider. Many of the features in this device depend on features in the wireless network to function. These Network Services may not be available on all networks or you may have to make specific arrangements with your service provider before you can utilize Network Services. Your service provider may need to give you additional instructions for their use and explain what charges will apply. Some networks may have limitations that affect how you can use Network Services. For instance, some networks may not support all language-dependent characters and services.

Your service provider may have requested that certain features be disabled or not activated in your device. Your device may also have been specially configured for your network provider. This configuration may include changes in menu names, menu order and icons. Contact your service provider for more information.

This device supports WAP 2.0 protocols (HTTP and SSL) that run on TCP/IP protocols. Some features of this device, such as multimedia messages, e-mail application, instant messages, presence service, Java games and applications and

Internet services require network support for these technologies.

Configuration settings service

To use some of the network services, such as mobile Internet services, MMS, Instant messages, E-Mail application, or Synchronisation, your phone needs the correct configuration settings. You may receive the settings directly as a configuration message and you need to save the settings on your phone. The service provider may provide a PIN that is needed to save the settings. For more information on the availability of the settings, contact your network operator, service provider or nearest authorised Nokia dealer.

When you have received a configuration message

Configuration sett. received is displayed. To view the received settings, press **Show**.

- To save the received settings, press **Save**. If the phone asks *Enter settings' PIN:*, key in the PIN code for the settings and press **OK**. Set these settings as the default or not. For availability of the PIN code, contact the service provider that supplies the settings.
- To discard the received settings, press **Discard**.

General information

To view and edit the settings see
Configuration settings on page 43.

■ **Nokia support on the
Web**

Check <[www.nokia-asia.com/
support](http://www.nokia-asia.com/support)> or your local Nokia Web
site for the latest version of this
guide, additional information,
downloads, and services related to
your Nokia product.

English

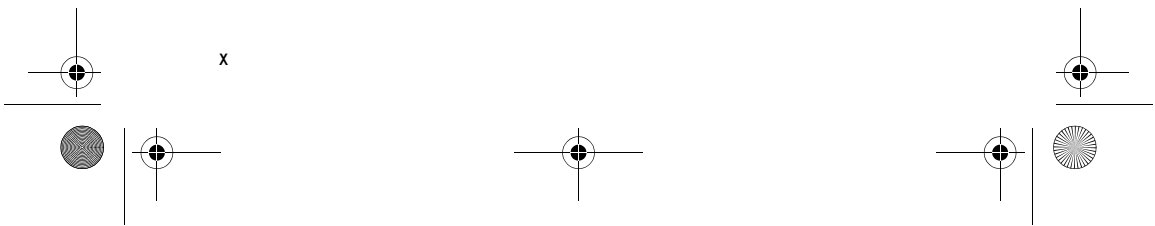
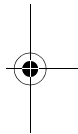
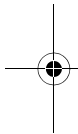

1. Getting started

■ Installing the SIM card and the battery

Keep all SIM cards out of the reach of small children. For availability and information on using SIM card services, contact your SIM card vendor. This may be the service provider, network operator, or other vendor.



Note: Always switch off the power and disconnect the charger and any other device before removing the cover. Avoid touching electronic components while changing the cover. Always store and use the device with the covers attached.

1. To remove the back cover of the phone:
Push the back cover release button (1) and gently prise the back cover away from the phone

beginning at the bottom of the phone (2).

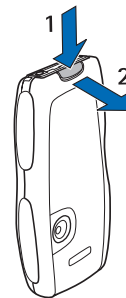

2. Remove the battery by lifting it as shown. Insert the SIM card into the SIM card holder until it snaps into position. Make sure that the SIM card is properly inserted and that the golden contact area on the card is facing downwards.

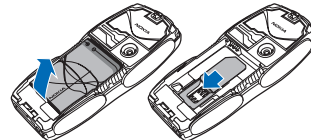

To remove the SIM card press the card release (1) and slide the SIM

English

Getting started

card towards the top of the phone (2).

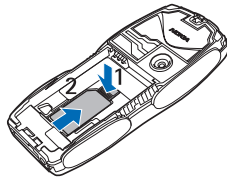

3. Replace the battery. Observe the contacts of the battery

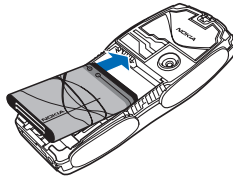

4. Align the top of the back cover with the top of the phone (1), press the bottom of the back cover to lock it (2).

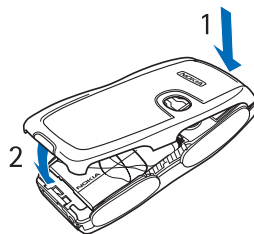

Charging the battery



Warning: Use only batteries, chargers, and enhancements approved by Nokia for use with this particular model. The use of any other types may invalidate any approval or warranty, and may be dangerous.

Check the model number of any charger before use with this device. This device is intended for use when supplied with power from ACP-7, ACP-8, ACP-12, LCH-9 or LCH-12 chargers.

1. Connect the lead from the charger to the socket on the bottom of your phone.

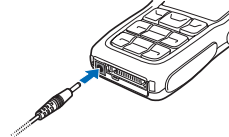

2. Connect the charger to an AC wall socket. If the battery is completely empty, it may take a few minutes before the charging indicator appears on the display or before any calls can be made.

The charging time depends on the charger and the battery used. For example, charging a battery with the ACP-12 charger takes approximately 1 hour and 20 minutes while the phone is in standby mode.

■ Switching the phone on and off



Warning: Do not switch the phone on when wireless phone use is prohibited or when it may cause interference or danger.

Press and hold the power key as shown.

If the phone asks for a PIN code, key in the PIN code (for example, displayed as ****), and press **OK**.

See also Access codes on page vii.



■ Normal operating position

Your phone has an internal antenna. Use the phone only in its normal operating position as shown.

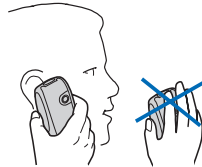

Note: As with any other radio transmitting device, do not touch the antenna unnecessarily when the device is switched on. Contact with the antenna affects call quality and may cause the device to operate at a higher power level than otherwise needed. Avoiding contact with the

antenna area when operating the device optimises the antenna performance and the battery life.

■ Changing the covers



Note: Before removing the cover, always switch off the power and disconnect the charger and any other device. Avoid touching electronic components while changing the covers. Always store and use the device with the covers attached.

1. Remove the back cover from the phone as described on page 1.
2. Remove the front cover from the phone. For this gently prise the front cover away from the phone beginning at the top of the phone (1) and detach the front cover (2).

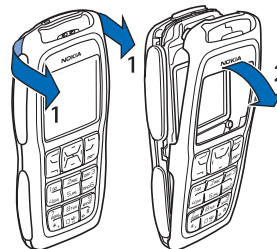

3. Remove the key mat from the front cover by taking it out gently.

Getting started

4. Place the key mat in the new front cover (3).

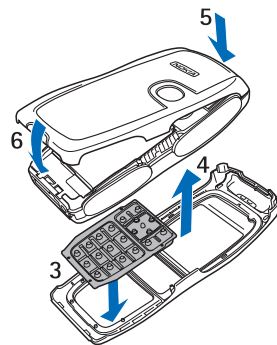

5. Replace the front cover by pressing it gently onto the phone until it snaps into position (4).
6. Align the top of the back cover with the top of the phone (5), press the bottom of the back cover to lock it (6).

■ Changing the grips

1. Remove the covers from the phone. See Changing the covers on page 3.

2. To remove the grips slide them to the top of the phone (1), then remove the grip (2).

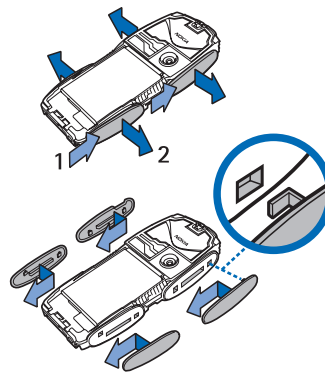

3. Replace the grips as shown.
4. Replace the covers of the phone. See Changing the covers on page 3.

■ Creating cut-out covers

Use the plastic stencil to create a cut-out cover using your own design.



Note: Use normal, plain paper as found in standard printers or use a photo print that is not thicker than 0.3 mm. To avoid affecting the antenna performance the material must not contain metal particles.

Getting started

1. Place the stencil in the correct position and draw the outline.

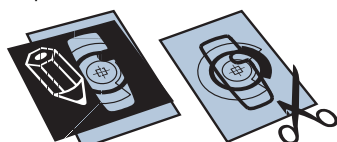

2. Carefully cut out your new cut-out cover.



Tip: The Nokia PC Suite provides within the image editor a tool to create cut-out covers.

■ Changing the cut-out cover

1. Remove the back cover from the phone. See Changing the covers on page 3.
2. Remove the cut-out cover from the back cover.
3. Place the new cut-out cover into the back cover by sliding the cut-out cover under the two guides at the bottom (1) and then under the guide at the top (2).

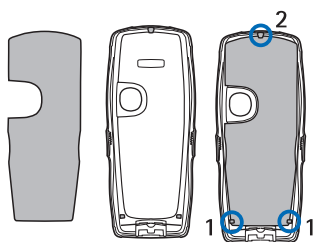

4. Replace the back cover.

■ Putting on a wrist strap

Remove the back cover and thread the strap as shown in the picture and tighten it. Replace the back cover.

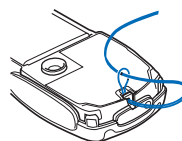

English



Your phone

2. Your phone



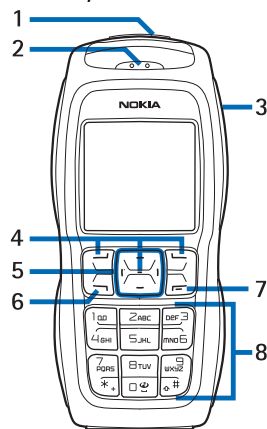

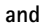

■ Keys and connectors

1. Power key 



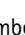

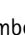

2. Earpiece
3. Loudspeaker
4. Selection keys  and , middle selection key 

The function of these keys depends on the guiding text shown on the display above the keys. See Standby mode on page 6.

5. 4-way scroll keys
Moves the cursor up  and down , left  and right . During a call, pressing  and  adjusts the volume.
6.  dials a phone number, and answers a call.

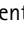
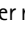
6

7.  ends an active call. Exits from any function.
8. 1  -   enter numbers and characters.
* + and  # are used for various purposes in different functions.
9. Charger connector

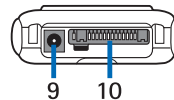

10. Pop-Port™ connector used, for example, for headsets and the data cable.

11. Camera lens

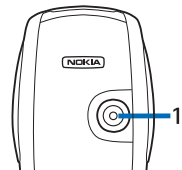

■ Standby mode

When the phone is ready for use, and you have not keyed in any characters, the phone is in standby mode.

1. Shows the name of the network or the operator logo.

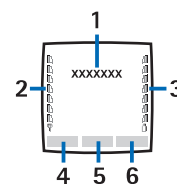

Your phone

2. Shows the signal strength of the cellular network at your current location.
3. Shows the battery charge level.
4. The left selection key in standby mode is **Go to**.
Press **Go to** to view the functions in your personal shortcut list. Select a function to activate it. See also Go to options on page 39.
5. The middle selection key in standby mode is **Menu**.
6. The right selection key in standby mode is **Names** to access the [Contacts](#) menu or another shortcut to a function you can select. See Personal shortcuts on page 39. Or the key has an operator-specific name to access an operator-specific web site.

Wallpaper

You can set your phone to display a background picture, wallpaper, when the phone is in standby mode. See Display settings on page 40.

Screen saver

You can set your phone to display a screen saver, when the phone is in standby mode. See Display settings on page 40.

Power saving



For power saving, a digital clock view overwrites the display when no phone function has been used for a certain period of time. Press any key to deactivate the screen saver.



Essential indicators

 You have received one or several text, picture messages or multimedia messages. See Reading and replying to an SMS message or an SMS e-mail on page 17 or Reading and replying to a multimedia message on page 20.

 The phone has registered a missed call. See Call register on page 30.

 or  Your phone is connected to the instant messages service and the availability status is online or offline, respectively. See Connecting to and disconnect from the instant messaging service on page 23.

 You have received one or several instant messages and you are connected to the instant messages

English

Your phone

service. See Connecting to and disconnect from the instant messaging service on page 23.



The phone's keypad is locked. See Keypad lock (Keyguard) on page 8.



The phone does not ring for an incoming call or text message when *Incoming call alert* is set to *Off* and *Message alert tone* is set to *Off*. See Tone settings on page 39.



The alarm clock is set to *On*. See Alarm clock on page 47.



When the (E)GPRS connection mode *Always online* is selected and the (E)GPRS service is available, the indicator is shown on the top left of the display. Refer to (E)GPRS connection on page 42.



When the (E)GPRS connection is established, the indicator is shown on the top left of the display. Refer to (E)GPRS connection on page 42 and Browsing the pages of a service on page 57.



The (E)GPRS connection is suspended (on hold), for example if there is an

incoming or outgoing call during the (E)GPRS dial-up connection.



The loudspeaker has been activated, see Options during a call on page 10.



Calls are limited to a closed user group. See Security settings on page 44.



A headset, handsfree, loopset or music stand is connected to the phone.

■ Keypad lock (Keyguard)



You can lock the keypad to prevent the keys being accidentally pressed. Press **Menu** or **Unlock** and then * + within 1.5 seconds to lock or unlock the keypad. During a call, the phone can be operated normally. When you end or reject the call, the keypad will automatically be locked.

For *Automatic keyguard*, see Phone settings on page 41.

When the keypad lock is on, calls still may be possible to the official emergency number programmed into your device. Key in the emergency number and press .

3. Call functions



■ Making a call

1. Key in the phone number, including the area code. If you key in an incorrect character, press **Clear** to delete it.
For international calls, press * + twice for the international prefix (the + character replaces the international access code) and then key in the country code, the area code without the leading 0, if necessary, and the phone number.
2. Press  to call the number.
3. Press  to end the call or to cancel the call attempt.

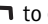
Making a call using the contacts

To search for a name/phone number that you have saved in **Contacts**, see Searching for a contact on page 32. Press  to call the number.

Last number redialling



In standby mode, press  once to access the list of up to 20 numbers you last called or attempted to call. Scroll to the number or name that you want, and press  to call the number.

Speed dialling a phone number

Assign a phone number to one of the speed-dialling keys, from Z_{ABC} to WXYZ , see Speed dials on page 37. Call the number in either of the following ways:

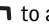

- Press the speed-dialling key that you want and then press .
- If **Speed dialling** is set to on, press and hold a speed-dialling key until the call is started. See Call settings on page 40.

■ Answering or rejecting an incoming call

Press  to answer an incoming call and press  to end the call.

Press  to reject an incoming call. If you press **Silence**, only the ringing tone is muted. Then either answer or reject the call.

Call waiting

During a call, press  to answer the waiting call. The first call is put on hold. Press  to end the active call. To activate the **Call waiting** function, see Call settings on page 40.

Call functions

■ Options during a call

Many of the options that you can use during a call are network services. For availability, contact your network operator or service provider.

Press **Options** during a call for some of the following options:

Mute or *Unmute*, *Contacts*, *Menu*, *Record*, *Lock keypad*, *Auto volume on* or *Auto volume off*, *Loudspeaker* or *Handset*, and the network services *Answer* and *Reject*, *Hold* or *Unhold*, *New call*, *Send DTMF* (to send tone strings), *Swap* (to switch between the active call and the call on hold), *Transfer* (to connect a call on hold to an active call and disconnect yourself), *Conference* (to set up a conference call), *Private call* (to discuss privately in a conference call), *End call*, *End all calls*.

For more information, see the extended user's guide for your phone model in the support area on the Nokia's web site, www.nokia-asia.com.



Note: Do not hold the device near your ear when the loudspeaker is in use, because the volume may be extremely loud.

■ Writing text

You can key in text, for example, when writing messages, using traditional or predictive text input.

When you are writing text, predictive text input is indicated by and traditional text input by at the top left of the display. The character case is indicated by **Abc**, **abc**, or **ABC** next to the text input indicator. You can change the character case by pressing \diamond #. The number mode is indicated by **123**, and you can change between the letter and number mode by pressing and holding \diamond #.

Setting predictive text input on or off

When writing text, press **Options** and select *Dictionary*.

- To set predictive text input on, select a language in the dictionary options list. Predictive text input is only available for the languages on the list.
- To revert to traditional text input, select *Dictionary off*.

Using predictive text input

You can key in any letter with a single keypress. Predictive text input is based on a built-in dictionary to which you can also add new words.

1. Start writing a word using the keys **ZABC** to **WXYZ9**. Press each

key only once for a single letter. The word changes after each keystroke.

 **Example:** To write Nokia when the English dictionary is selected, press **MNOB**, **MNOB**, **SJHL**, **4GHI** and **ZABC**.

For more instructions on writing text, see Tips for writing text on page 11.

2. When you have finished writing the word and it is correct, confirm it by adding a space with  or by pressing any of the scroll keys. Pressing a scroll key also moves the cursor.

If the word is not correct, press *** +** repeatedly or press **Options** and select **Matches**. When the word that you want appears, confirm it.

If the **?** character is displayed after the word, the word you intended to write is not in the dictionary. To add the word to the dictionary, press **Spell**, key in the word (traditional text input is used) and press **Save**. When the dictionary becomes full, the new word replaces the oldest one that was added.

3. Start writing the next word.

Writing compound words

Key in the first part of the word and confirm it by pressing . Write the

last part of the word and confirm the word.

Using traditional text input

Press a number key, **ZABC** to **WXYZ**, repeatedly until the desired character appears. Not all characters available under a number key are printed on the key. The characters available depend on the language selected in the *Phone language* menu, see Phone settings on page 41.

- If the next letter you want is located on the same key as the present one, wait until the cursor appears, or press any of the scroll keys and then key in the letter.
- The most common punctuation marks and special characters are available under the number key *** +**.

For more instructions on writing text, see Tips for writing text on page 11.

Tips for writing text

The following functions may also be available for writing text:

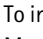
- To insert a space, press .
- Move the cursor to the left, right, down or up with the navigation key.
- To insert a number while in letter mode, press and hold the desired number key.

Call functions

- To delete a character to the left of the cursor, press **Clear**. Press and hold **Clear** to delete the characters more quickly. To delete all the characters at once when writing a message, press **Options** and select [Clear text](#).
- To insert a word when using predictive text input, press **Options** and select [Insert word](#). Write the word using traditional text input and press **Save**. The word is also added to the dictionary.
- To insert a special character when using traditional text input, press * +, or when using predictive text input, press and hold * +, or press **Options** and select [Insert symbol](#). Select the character and press **Use**.
- To insert a smiley when using traditional text input, press * + twice, or when using predictive text input, press and hold * + and press * + again, or press **Options** and select [Insert smiley](#). Select a smiley and press **Use**.

The following options are available when writing text messages:



- To insert a number while in letter mode, press **Options** and select [Insert number](#). Key in the phone number or search for it in [Contacts](#) and press **OK**.
- To insert a name from [Contacts](#), press **Options** and select [Insert](#)

[contact](#). To insert a phone number or a text item attached to the name, press **Options** and select [View details](#).

4. Using the menu

The phone offers you an extensive range of functions, which are grouped into menus.

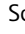
■ Accessing a menu function

1. To access the menu, press **Menu**.
2. Scroll with  or  through the menu (or with any of the scroll keys if the grid menu view is selected) and select, for example, *Settings* by pressing **Select**. To change the menu view, see *Menu view* in Display settings on page 40.
3. If the menu contains submenus, select the one that you want, for example *Call settings*.
4. If the selected submenu contains further submenus, repeat step 3. Select the next submenu, for example *Anykey answer*.
5. Select the setting of your choice.
6. Press **Back** to return to the previous menu level, and **Exit** to exit the menu.

English

Using the menu

List of menu functions

1. Messages

1. Create message
2. Inbox
3. Outbox
4. Sent items
5. Saved items
6. Instant messages
7. E-mail¹
8. Voice messages
9. Info messages
10. Service commands
11. Delete messages
12. Message settings
13. Message counter

2. Add new contact
3. Delete
4. My presence
5. Subscribed names
6. Copy
7. Settings
8. Speed dials
9. Voice tags
10. Service numbers²
11. My numbers²
12. Caller groups²

4. Settings

1. Profiles
2. Themes
3. Tone settings
4. Light settings
5. Personal shortcuts
6. Display settings
7. Time and date settings
8. Call settings
9. Phone settings
10. Connectivity
11. Enhancement settings³
12. Configuration settings
13. Security settings
14. Restore factory settings

2. Call register

1. Missed calls
2. Received calls
3. Dialed numbers
4. Delete recent call lists
5. Call duration
6. GPRS data counter
7. GPRS connection timer
8. Positioning

3. Contacts

1. Search

5. Operator menu⁴

1. If this menu is not shown the subsequent menu numbers changes accordingly.
2. If Service numbers are not supported, the number of this menu item changes accordingly.
3. This menu is shown only if the phone is or has been connected to a compatible enhancement available for the phone.
4. If this menu is not shown the subsequent menu numbers changes accordingly. The name depends on the network operator.

Using the menu

6. Gallery

1. Images
2. Video clips
3. Themes
4. Graphics
5. Tones
6. Recordings



11.SIM services¹



7. Media

1. Camera
2. Voice recorder



8. Organiser

1. Alarm clock
2. Calendar
3. To-do list
4. Notes
5. Synchronisation



9. Applications

1. Games
2. Collection
3. Extras



10.Services

1. Nokia.com
2. Home
3. Bookmarks
4. Download links
5. Last web addr.
6. Service inbox
7. Settings
8. Go to address
9. Clear the cache



English

1. Only shown if supported by your SIM card. The name and contents vary depending on the SIM card.

Menu functions

5. Menu functions

■ Messages



The message services can only be used if they are supported by your network or your service provider, and you have subscribed to them. Also appropriate settings need to be in place.

To select the font size for reading and writing messages, press **Menu**, and select *Messages*, *Message settings*, *Other settings* and *Font size*.



Note: When sending messages, your phone may display the words *Message sent*. This is an indication that the message has been sent by your device to the message centre number programmed into your device. This is not an indication that the message has been received at the intended destination. For more details about messaging services, check with your service provider. Only devices that offer compatible features can receive and display messages. The appearance of a message may vary

depending on the receiving device.



Important: Exercise caution opening messages. Messages may contain malicious software or otherwise be harmful to your device or PC.

Text messages (SMS)

Using the SMS (Short Message Service) your phone can send and receive multi-part messages, which consist of several ordinary text messages (network service). Invoicing may be based on the number of ordinary messages that are required for a multi-part message. This may affect the invoicing for the message.

Before you can send a message, you need to save some message settings. See Settings for text and SMS e-mail messages on page 28.

You can also send and receive text messages that contain pictures. A picture message can be a multi-part message.



The text messages function uses shared memory, see Shared memory on page vii.

Writing and sending messages

Your device supports the sending of text messages beyond the character

Menu functions

limit for a single message. Longer messages will be sent as a series of two or more messages. Your service provider may charge accordingly. Characters that use accents or other marks, and characters from some language options like Chinese, take up more space limiting the number of characters that can be sent in a single message.

1. Press **Menu**, and select *Messages, Create message* and *Text message*.
2. Key in a message. See Writing text on page 10. To insert text templates or a picture into the message, see Templates on page 18.
3. To send the message, press **Send** or .
The messages that you have sent will be saved in the *Sent items* folder if the setting *Save sent messages* is set to *Yes*. See Settings for text and SMS e-mail messages on page 28. Text messages are indicated with .
4. Enter the recipient's phone number or search for the phone number in *Contacts*. Press **OK** to send the message.

Options for sending a message

After you have written a message, press **Options** and select *Sending options*. With *Send to many* you can

send the message to several recipients and to send a message as an SMS e-mail (network service), select *Send as e-mail*. With *Sending profile* you can use a predefined message profile to send the message. To define a message profile, see Settings for text and SMS e-mail messages on page 28.

Reading and replying to an SMS message or an SMS e-mail

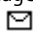
When you have received a message or an SMS e-mail, the indicator  and the number of new messages followed by *_ messages received* are shown.

The blinking  indicates that the message memory is full. Before you can receive new messages, delete some of your old messages in the *Inbox* folder.

1. Press **Show** to view the new message, or press **Exit** to view it later.
If more than one message has been received, select the one that you want to read. An unread text message or SMS e-mail is indicated by .
2. While reading a message, press **Options** and select an option, for example, to delete, forward or edit the message as a text message or an SMS e-mail, rename the message you are reading or to move it to another

Menu functions

folder. Select **Copy to calendar** to copy text at the beginning of the message to your phone's calendar as a reminder note for the current day. Select **Message details** to view, if available, the sender's name and phone number, the message centre used, and the date and time of receipt. Select **Use detail** to extract numbers, e-mail addresses and website addresses from the current message.



When reading a picture message, select **Save picture** to save the picture in the **Templates** folder.

3. To send the message, press **Send**, and press **OK** to send the message to the displayed number.

Inbox and sent items folders

The phone saves incoming text and multimedia messages in the **Inbox** folder. Sent text messages are saved in the **Sent items** folder, if saving is activated, see Settings for text and SMS e-mail messages on page 28.

Templates

Your phone includes text templates, indicated by , and picture templates, indicated by .

To access the template list, press **Menu**, and select **Messages**, **Saved items**, **Text messages** and **Templates**.

Saved items folder and My folders

To organise your messages, you can move some of them to the **Saved items** folder, or add new folders for your messages. While reading a message, press **Options**. Select **Move**, scroll to the folder that you want to move the message to and press **Select**.

To add or delete a folder, press **Menu**, and select **Messages**, **Saved items**, **Text messages** and **My folders**. To add a folder if you have not saved any folder, press **Add**. Otherwise, press **Options** and select **Add folder**. To delete a folder, scroll to the folder that you want to delete, press **Options** and select **Delete folder**.

Multimedia messages (MMS)

A multimedia message can contain text, sound and a picture or a video clip. The phone supports multimedia messages that are up to 100 kB in size. If the message contains a picture, the phone scales it down to fit the display area. The wireless network may limit the size of MMS messages. If the inserted picture exceeds this limit, the device may make it smaller so that it can be sent by MMS.

The multimedia message function uses shared memory, see Shared memory on page vii.

If *Allow multimedia reception* is set to *Yes* or *In home network*, your operator or service provider may charge you for every message you receive. The default setting to receive multimedia messages is generally on. See Settings for multimedia messages on page 28.

Multimedia messaging supports the following formats:

- Picture: JPEG, GIF, WBMP, BMP and PNG.
- Sound: Scalable Polyphonic MIDI (SP-MIDI), AMR audio and monophonic ringing tones.
- Video clips in 3gp format with SubQCIF and QCIF resolution and AMR audio.

The phone does not necessarily support all variations of the aforementioned file formats. If a received message contains any unsupported elements, they may be replaced with the file name and the text *Object format not supported*.

Note that you are not able to receive any multimedia messages if you have a call in progress, or a game or another Java application running. Because delivery of multimedia messages can fail for a variety of reasons, do not rely solely upon them for essential communications.

Writing and sending a multimedia message

To set the settings for multimedia messaging, see Settings for multimedia messages on page 28. To check availability and to subscribe to the multimedia messaging service, contact your network operator or service provider.

Copyright protections may prevent some images, ringing tones and other content from being copied, modified, transferred or forwarded.

1. Press **Menu**, and select *Messages*, *Create message* and *Multimedia msg..*
 2. Key in a message. See Writing text on page 10.
 - To insert a file in the message, press **Options**, select *Insert* and select the desired option from the Gallery or select *Calendar note* or *Business card*.
- To move the text component to the top or bottom of the message, press **Options** and select *Place text first* or *Place text last*.
- Your phone supports the sending and receiving of multimedia messages that contain several pages (slides). To insert a slide in the message, press **Options**, and select *Insert* and *Slide*. Each

Menu functions

slide can contain text, one image and one sound clip.



If the message contains several slides, you can open the desired one by pressing **Options** and selecting *Previous slide*, *Next slide* or *Slide list*. To set the interval between the slides, select *Slide timing*.

- The following options may also be available: *Delete* to delete an image, slide or sound clip from the message, *Preview* or *Save message*. In *More options* the following options may be available: *Insert contact*, *Insert number*, *Message details* and *Edit subject*.
3. To send the message, press **Send** and select *Phone number*, *E-mail address* or *Many*.
 4. Enter the recipient's phone number (or e-mail address) or search for it in *Contacts*.

While the multimedia message is being sent, the animated indicator  is displayed and you can use other functions on the phone. If there is an interruption while the message is being sent, the phone tries to resend it a few times. If this fails, the message will remain in the *Outbox* folder and you can try to resend it later.

The messages that you have sent will be saved in the *Sent items* folder if the setting *Save sent messages* is set to *Yes*. See Settings for multimedia messages on page 28. Multimedia messages are indicated with .

Reading and replying to a multimedia message

When your phone is receiving a multimedia message, the animated indicator  is displayed. When the message has been received, the indicator  and the text *Multimedia message received* are shown.

1. Press **Show** to view the message, or press **Exit** to view it later.
If more than one message has been received, select the one that you want to read. An unread multimedia message is indicated by .
2. Scroll to view the message. Press **Options** and, for example, some of the following options may be available: *Play presentation*, *View text*, *Open image*, *Open sound clip*, *Open video clip*, *Save image*, *Save sound clip*, *Save video clip*, *Details*, *Delete message*, *Reply*, *Reply to all*, *Forward*, *Edit*, *Message details*.

Refer also to the options in *Gallery*, see *Gallery* on page 45.

Inbox, Outbox, Saved and Sent items folders

The phone saves the received multimedia messages in the *Inbox* folder. Multimedia messages that have not yet been sent are moved to the *Outbox* folder. The multimedia messages that you wish to send later can be saved in the *Saved items* folder. The multimedia messages that have been sent are saved in the *Sent items* folder of the *Multimedia msgs.* submenu if the setting *Save sent messages* is set to *Yes*. See Settings for multimedia messages on page 28.

Multimedia messages memory full

When you have a new multimedia message waiting and the memory for the messages is full, the indicator  blinks and *Multimedia memory full, view waiting msg.* is shown. To view the waiting message, press **Show**. To save the message, press **Options**, select *Save message* and delete old messages by first selecting the folder and then the old message to be deleted. To discard the waiting message, press **Exit** and **Yes**. If you press **No**, you can view the message.

Flash messages

Flash messages are text messages that are instantly displayed upon reception.

Writing a flash message

Press **Menu**, and select *Messages*, *Create message* and *Flash message*. Write your message. The maximum length of a flash message is 70 characters. To insert a blinking text into the message, select *Insert blink char.* from the options list to set a marker. The text behind the marker blinks until a second marker is inserted.

Receiving a flash message

A received flash message is not automatically saved. To read the message, press **Read**. Press **Options** and select *Use detail* to extract phone numbers, e-mail addresses and website addresses from the current message. To save the message, press **Save** and select the folder in which you want to save the message.

Instant messages (Chat)

Instant messaging (Chat) is a way of sending short, simple text messages that are delivered over TCP/IP protocols to online users (network service). Your contact list shows you when the contacts on the list are online and available to participate in an instant messages conversation.

Before you can use instant messaging, you need to subscribe to the service. For availability, charging and subscription to the service, contact your service provider, from

Menu functions

whom you also receive your unique ID and password and the settings for instant messaging. For setting the required settings for the instant messaging service, see Instant messaging settings on page 26. The icons and texts on the display may vary depending on the instant messaging service.

You can use the other functions of the phone while you have an active instant messaging session in the background.

Instant messaging uses shared memory, see Shared memory on page vii.

Basic steps for the instant messaging

- To enter the instant messaging menu (offline), see Entering the instant messaging menu on page 22.
- To connect to the service (online), see Connecting to and disconnect from the instant messaging service on page 23.
- To start a conversation with a contact, see [IM contacts](#) in Starting an instant messaging conversation on page 23.

To create your own contact lists, see Contacts for instant messaging on page 25.

- To join a public group, see [Groups](#) in Starting an instant messaging conversation on page 23.

To join an instant messaging group via an invitation message, see Accepting or rejecting an invitation on page 24.

To create your own group, or to join or delete a public group, see Groups on page 25.

- To edit your own information, see Editing your own settings on page 24.
- To search users and groups, see [Search](#) in Starting an instant messaging conversation on page 23.
- To read a message, see Reading an instant message on page 24.
- To write and send messages during an active session, see Participating in a conversation on page 24.
- To view, rename or delete saved conversations, select [Saved convers.](#) when you have entered the [Instant messages](#) menu.
- To block/unblock contacts, see Blocking and unblocking messages on page 25.
- To disconnect from the service, see Connecting to and disconnect from the instant messaging service on page 23.

Entering the instant messaging menu

To enter the [Instant messages](#) menu while still offline, press **Menu**, and select [Messages](#) and [Instant](#)

Menu functions

messages. Activate a service and then select **Login** to connect to the service, **Saved convers.** to view, erase or rename the conversations that you have saved during a session, or **Connect. settings** to access the settings needed for a connection.

Connecting to and disconnect from the instant messaging service

To connect to the service, enter the **Instant messages** menu, activate a service and select **Login**. Select one of the available sets. If necessary key in the **User ID:** and the **Password:**. When the phone has successfully connected, **Logged in** is displayed.



Tip: To set the phone to automatically connect to the instant messaging service when you enter the **Instant messages** menu, connect to the service, select **My settings**, **Automatic login** and **On IM start-up**.

To disconnect from the service, select **Logout**.

Starting an instant messaging conversation

Enter the **Instant messages** menu and connect to a service. You can select

- **Conversations** to view the list of new and read messages or invitations to instant messaging during the active session. Scroll

to the message or invitation that you want and press **Open** to read the message.

indicates the new and the read instant messages.

indicates the new and the read group messages.

indicates the invitations.

- **IM contacts** includes the contacts that you have added. Scroll to the contact to whom you would like to send instant messages and press **Chat** or press **Open** if a new message is shown in the list.

If you have received a new message from a contact, it is indicated with .

indicates the online and the offline contacts in the phone's contacts memory. indicates a blocked contact, refer to Blocking and unblocking messages on page 25.

- **Groups** and **Public groups.** The list of bookmarks to public groups provided by the service provider is displayed. To start a conversation, scroll to a group and press **Join**. Enter the screen name that you want to use in the conversation. When you have successfully joined in the group conversation, the phone shows **Joined group:** and the group

Menu functions

name. To create a private group, see Groups on page 25.

- **Search** and select **Users** or **Groups** to search for other users or public groups on the network. To start the session when you have found the user or the group that you want, press **Options** and select **Chat** or **Join group**.
- To start a session from Contacts, see Viewing the subscribed names on page 36.

Accepting or rejecting an invitation

When you have connected to the service and you receive a new invitation, *New invitation received* is displayed. Press **Read** to read it. If more than one invitation is received, the number of messages followed by *_ new invitations received* is displayed. Press **Read**, scroll to an invitation that you want and press **Open**. Press **Accept**, to join the private group conversation, or press **Options** and select **Reject** or **Delete** to reject or delete the invitation.

Reading an instant message

When you have connected to the service and you receive a message from a person who is not taking part in the conversation, *New instant message* is displayed. Press **Read** to read it. If more than one message is received, the number of messages followed by *_ new instant messages*

is displayed. Press **Read**, scroll to a message and press **Open**.

New messages received during an active session are held in the *Conversations* of the *Instant messages* menu. If the message is from a person whose contact information is missing from the contact list in *IM contacts*, the sender's ID is shown. If the contact information can be found in the phone's memory for contacts and the phone recognises it, the sender's name is shown. To save a new contact in the phone's memory, press **Options** and select **Save contact** or and enter the name of the person, or **Add to contact**.



Participating in a conversation

Join or start a session by pressing **Write**. Write your message and press **Send** or  to send it. If you press **Options**, some of the following options are available: **View conversation**, **Save contact**, **Add to contact**, **Group members**, **End conversation**, **Dictionary**.

Editing your own settings

Enter the *Instant messages* menu and connect to the service. Select **My settings** to view and edit your own availability information or screen name. Select **Availability** and **Available for all** or **Avail. for contacts** (or **Appear offline**) to allow all the other users or only the contacts on your contact list to see

Menu functions

that you are online when you have connected to the service. When you are connected to the service,  indicates that you are online and  that you are not visible to others.

Contacts for instant messaging

To add contacts to the instant messaging contacts list, connect to the service and select *IM contacts*. If the contacts list is empty the phone displays *Contact list empty. Copy contacts from server?* to retrieve available contacts from the server. Otherwise press **Options** and select *Add contact*, or if you have no contacts added, press **Add**. Select *Enter ID manually*, *Search from serv.*, *From contacts*, or *Copy from server* to add a new contact. When the contact is added, the phone displays *Added to IM contacts:* and the contact name.

Scroll to a contact, and press **Chat** to start a session or press **Options** and select *Contact info*, *Edit name*, *Block contact* (or *Unblock contact*), *Add contact*, *Remove contact*, *Copy to server*, or *Availability alerts*.

Blocking and unblocking messages

Connect to the service and select *Conversations* or *IM contacts*. Highlight the contact in the contacts list from whom you want to block incoming messages. Press **Options**, select *Block contact* and press **OK**.

To unblock the messages, connect to the service and select *Blocked list*. Scroll to the contact from whom you want to unblock the messages and press **Unblock**.

Groups

You can create your own private groups for a session, or use the public groups provided by the service provider. The private groups exist only during an active session. You can add to a private group only the contacts that are in your contact list and thus in the phone's contacts memory. If the server you are logged onto does not support group services all groups related menus are dimmed.

Public groups

You can bookmark public groups that your service provider may maintain. Connect to the service, select *Groups* and *Public groups*. Scroll to a group that you want to chat with and press **Join**. If you are not in the group, key in your screen name as your nickname for the group. If you press **Options**, you can select *Delete group* to delete a group from your group list.

Creating a private group

Connect to the service, select *Groups* and *Create group*. Key in the name for the group and the screen name that you want to use for the group. You can use another screen name in another group. Mark your

Menu functions

private group members from the contacts list and key in an invitation to newly added members.

Instant messaging settings

You may receive the settings as a configuration message from the service provider. To receive the settings as a configuration message, see Configuration settings service on page viii. To key in the settings manually, see Configuration settings on page 43. For the instant messaging and presence settings, contact your service provider.

To enter the *Instant messages* menu while still offline, press **Menu**, and select *Messages* and *Instant messages*. Activate a service and select *Connect. settings*. Select *Configuration* and select the set you would like to activate. Select *Account* and choose the account you want to use. Select *User ID* to view or to edit the user ID. Select *Password* to enter the password.

E-mail application

The e-mail application allows you to access the compatible e-mail account that you use in the office or at home, via the phone (network service). You can write, send, and read e-mails with your phone. Your phone supports POP3 and IMAP4 e-mail servers.

The e-mail application uses shared memory, see Shared memory on page vii.

Before you can send and retrieve any e-mails, you may need to do the following:

- Obtain a new e-mail account or use the current one. For availability of your e-mail account contact your e-mail service provider.
- For the settings required for the e-mail application, contact your e-mail service provider. To receive the e-mail settings as a configuration message, see Configuration settings service on page viii.
- To set the e-mail settings on your phone, press **Menu** and select *Messages*, *Message settings* and *E-mail messages*. See Settings for e-mail application on page 29.

Writing and sending an e-mail

1. Press **Menu** and select *Messages*, *E-mail*, and *Create e-mail*.
2. Key in the recipient's e-mail address, a subject and the e-mail message.
3. Press **Send** and select *Send now*.

Downloading e-mails from your e-mail account

1. Press **Menu** and select *Messages, E-mail* and *Retrieve* to download e-mails that have been sent to your e-mail account.
Or:
Press **Menu** and select *Messages* and *E-mail*, press **Options** and select *Retrieve and send* to download new e-mails and to send e-mails that have been saved in the *Outbox* folder.
2. Your phone attempts to make a connection to the e-mail service. A status bar is shown while your phone is downloading e-mails to your phone.
3. Press **Select** to view the new message in the *Inbox*, or press **Back** to view it later. An unread text message is indicated by .

Reading and replying to an e-mail

Press **Menu**, select *Messages, E-mail* and *Inbox*. While reading the message, press **Options** to see the options available for this message.

To reply to an e-mail, press **Reply** and select *Original text* or *Empty screen*. Confirm or edit the e-mail address and subject, then write your reply. To send the message, press **Send** and select *Send now*.

Inbox and Other folders (Drafts, Archive, Outbox and Sent items)

Your phone saves e-mails that you have downloaded from your e-mail account in the *Inbox* folder. *Other folders* contains the folders: *Drafts* for saving unfinished e-mails, *Archive* for organising and saving your e-mails, *Outbox* for saving e-mails that have not been sent, and *Sent items* for saving e-mails that have been sent.

Deleting e-mails

To delete e-mails, press **Menu** and select *Messages* and *E-mail*, press **Options** and select *Delete messages*. To delete all messages from a folder, select the folder from which you want to delete the messages and press **Yes**. To delete all messages from all folders, select *All messages* and press **Yes**. Note that deleting an e-mail from your phone does not delete it from the e-mail server.

Voice messages

The voice mailbox is a network service and you may need to subscribe to it. For more information and for the voice mailbox number, contact your service provider.

Press **Menu**, and select *Messages* and *Voice messages*. To call your voice mailbox, select *Listen to voice messages*. To key in, search for or

Menu functions

edit your voice mailbox number, select [Voice mailbox number](#).

If supported by the network, the indicator  will show new voice messages. Press **Listen** to call your voice mailbox number.

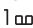

Tip: Pressing and holding  calls your voice mailbox if you have the number set.

Info messages

With the info message network service you may be able to receive messages on various topics. For details, contact your service provider.

Service commands

Press **Menu**, and select [Messages](#) and [Service commands](#). Key in and send service requests (also known as USSD commands), such as activation commands for network services, to your service provider.

Deleting all messages from a folder

To delete all messages from a folder, press **Menu**, and select [Messages](#) and [Delete messages](#). Select the folder from which you want to delete the messages and press **OK** to confirm the query.

If the folder contains unread messages, the phone will ask

whether you want to delete them also.

Message settings

The message settings affect the sending, receiving and viewing of messages.

Settings for text and SMS e-mail messages

Press **Menu**, and select [Messages](#), [Message settings](#), [Text messages](#). Select [Sending profile](#). If more than one message profile set is supported by your SIM card, select the set that you want to change. Each setting has the following settings: [Message centre number](#) (delivered by your service provider), [Messages sent via](#), [Message validity](#), [Default recipient number](#) (text messages) or [E-mail server](#) (e-mail), [Delivery reports](#), [Use GPRS](#), [Reply via same centre](#) (network service) and [Rename sending profile](#).

Select [Save sent messages](#). Select [Yes](#) to set the phone to save sent multimedia messages in the [Sent items](#) folder. If you select [No](#), the sent messages are not saved.

Settings for multimedia messages

Press **Menu**, and select [Messages](#), [Message settings](#) and [Multimedia msgs.](#). Select

- [Save sent messages](#). Select [Yes](#) to set the phone to save sent

Menu functions

multimedia messages in the *Sent items* folder. If you select *No*, the sent messages are not saved.

- *Delivery reports* to ask the network to send delivery reports about your messages (network service).
- *Scale image down* to define the image size when you insert the image into the multimedia message.
- *Default slide timing* to define the default time for slides in multimedia messages.
- *Allow multimedia reception*. Choose *No*, *Yes* or *In home network* to use the multimedia service. If *Allow multimedia reception* is set to *Yes* or *In home network*, your operator or service provider may charge you for every message you receive. The default setting to receive multimedia messages is generally on.
- *Incoming multimedia messages*. Select *Retrieve* to automatically allow the reception of multimedia messages, *Retrieve manually* to allow the reception of multimedia message only after being prompted or select *Reject*.
- *Configuration settings*. Select *Configuration* and select the default service provider for retrieving multimedia messages. Select *Account* to see the

accounts provided by the service provider. If more than one account is displayed choose the one that you want to use. You may receive the settings as a configuration message from the service provider. To receive the settings as configuration message, see Configuration settings service on page viii. To key in the settings manually see Configuration settings on page 43.

- *Allow adverts* to choose if you allow the reception of messages defined as advertisements. This setting is not shown if *Allow multimedia reception* is set to *No*.

Settings for e-mail application

You may receive the e-mail application settings as a configuration message from the service provider. For receiving the settings as a configuration message, see Configuration settings service on page viii. To key in the settings manually see Configuration settings on page 43.

Select each of the settings individually and key in all the required settings. Contact your e-mail service provider for the settings.

Press **Menu** and select *Messages*, *Message settings*, and *E-mail messages*. Select

English

Menu functions

- **Configuration** and select the set that you would like to activate.
- **Account** to see the accounts provided by the service provider. If more than one account is displayed choose the one that you want to use.
- **My name**. Key in your name or nickname.
- **E-mail address**. Key in e-mail address.
- **Include signature**. You can define a signature that is automatically added to the end of your e-mail, when you write your message.
- **Reply-to address**. Key in the e-mail address to which you want the replies to be sent.
- **SMTP user name**. Key in the name that you want to use for outgoing mails.
- **SMTP password**. Key in the password that you want to use for outgoing mails.
- **Display terminal window**. Select **Yes** to perform manual user authentication for Intranet connections.
- **Incoming server type**. Select either **POP3** or **IMAP4** depending on the type of e-mail system that you are using. If both types are supported, select **IMAP4**.
- **Incoming mail settings**

If you have selected **POP3** as the incoming server type, the following options are shown:

Retrieve e-mails, **POP3 user name**, **POP3 password** and **Display terminal window**.

If you have selected **IMAP4** as the incoming server type, the following options are shown:

Retrieve e-mails, **Retrieval method**, **IMAP4 user name**, **IMAP4 password** and **Display terminal window**.

Common settings

Press **Menu** and select **Messages**, **Message settings**, **Other settings** and **Font size** to select the font size for reading and writing messages.

Message counter

To view how many messages you have sent and received, press **Menu** and select **Messages** and **Message counter**. Select **Sent messages** or **Received messages** or select **Clear counters** to clear the counters.

Call register



The phone registers the phone numbers of missed, received and dialled calls, and the approximate length of your calls.

The phone registers if it is switched on and within the network's service

Menu functions

area, and the network supports these functions.

When you press **Options** in the *Missed calls*, *Received calls* and *Dialled numbers* menus, you can, for example, view the date and the time of the call, edit or delete the phone number from the list, save the number in *Contacts*, or send a message to the number. Select *Delete recent call lists* to delete the recent calls lists.

Counters and timers for calls, data and messages



Note: The actual invoice for calls and services from your service provider may vary, depending upon network features, rounding off for billing, taxes and so forth. Some timers may be reset during service or software upgrades.

Press **Menu**, and select *Call register* and then select *Call duration*, *GPRS data counter* or *GPRS connection timer* for approximate information on your recent communications.

Positioning information

Some networks allow position requests (network service). *Positioning* allows you to view the received position requests from the network operator. Contact your network operator or service provider

to subscribe to and agree upon the delivery of location information.

Press **Menu**, and select *Call register*, *Positioning* and then *Position log* to see a list of received position requests.

■ Contacts



You can save names and phone numbers (Contacts) in the phone's memory and in the SIM card's memory.

- The phone's memory may save names with numbers and text notes about each name. You can also save an image for a certain number of names. Contacts use shared memory, see Shared memory on page vii.
- Names and numbers saved in the SIM card's memory, are indicated by .

In dynamic contacts you can publish your current availability status to communicate to anyone who has access to this service and who is requesting this information. See My presence on page 33.

Selecting settings for contacts

Press **Menu** and select *Contacts* and *Settings*. Select *Memory in use*, *Contacts view*, or *Memory status*.

English

Menu functions

Saving names and phone numbers (Add contact)

Press **Menu** and select *Contacts* and *Add new contact*. Key in the name and the phone number. When the name and number are saved, press **Done**.

Saving multiple numbers or text items or an image per name

You can save different types of phone numbers and short text items per name in the phone's internal memory for contacts.

The first number saved is automatically set as the default number and it is indicated with a frame around the number type indicator, for example . When you select a name from contacts, for example to make a call, the default number is used unless you select another number.

1. Make sure that the memory in use is either *Phone* or *Phone and SIM*.
2. Scroll to the name saved in the phone's internal memory for the contact to which you want to add a new number or text item, and press **Details**.
3. Press **Options** and select *Add number*, *Add detail* or *Add image*.

4. To add a number or detail, select one of the number types or text types, respectively, or select an image from *Gallery*.

If you select the text type *User ID*: select *Search* to search for an ID by a mobile phone number or an e-mail address in the server of the operator or service provider if you have connected to the presence service. See My presence on page 33. If only one ID is found, it is automatically saved. Otherwise, to save the ID, press **Options**, and select *Save*. To key in the ID, select *Enter ID manually*. Key in the ID and press **OK** to save it.

To change the number or text type, select *Change type* in the options list. Note that you cannot change the type of an ID when it is on the *IM contacts* or in the *Subscribed names* list.

To set the selected number as the default number, select *Set as default*.

5. Key in the number or text item and press **OK** to save it.
6. Press **Back** and then **Exit** to return to standby mode.

Searching for a contact

Press **Menu** and select *Contacts* and *Search*, or to quickly find a contact name, press  in standby mode.

You can key in the first characters of

Menu functions

the name you are searching for in the pop-up window.

In addition the following options in the **Contacts** menu may also be available:

- **Add new contact** and **Delete**.
- **Copy** to copy names and phone numbers from the phone's contact directory to the SIM card's memory, or vice versa.
- **Settings** to select how the names and numbers in contacts are displayed. Select **Memory status** to view the free and used memory capacity.
- **Speed dials** to assign a number to a speed dialling key. To activate speed dialling see Call settings on page 40.
- **Service numbers** to call the service numbers of your service provider if the numbers are included on your SIM card (network service).
- **My numbers** to view the phone numbers assigned to your SIM card. Only shown, if the numbers are included on your SIM card.
- **Caller groups** to arrange the names and phone numbers saved in the memory into caller groups with different ringing tone.

Editing or deleting details

Search for the contact that you want to edit or delete and press **Details**.

Scroll to the name, number, text item or image that you want to edit or delete and press **Options**.

- To edit a name, number or text item or to change image, select **Edit name**, **Edit number**, **Edit detail** or **Change image**, respectively.

Note that you cannot edit or delete an ID when it is in **IM contacts** or in the **Subscribed names** list.

- To delete a number or text item, select **Delete number** or **Delete detail**, respectively.
- To delete an image attached to the contact, select **Delete image**. Deleting an image from contacts does not delete it from **Gallery**.

My presence

With the presence service (network service) you can share your presence status with other users, for example your family, friends and colleagues with compatible devices and access to the service. Presence status includes your availability, status message and personal logo. Other users who have access to the service and who are requesting your information are able to see your status. The requested information is shown in **Subscribed names** in the viewers **Contacts** menu. You can personalise the information that you



English

Menu functions

want to share with others and control who can see your status.

Before you can use presence, you need to subscribe to the service. To check the availability, for charging details and to subscribe to the service, contact your service provider, from whom you also receive your unique ID and password and the settings for the service. To set the required settings for the presence service, see Instant messaging settings on page 26. While you have connected to the presence service, you can use the other functions of the phone, and the presence service is active in the background.

Press **Menu** and select **Contacts** and **My presence**. Select

- **Connect to 'My presence' service** (or **Disconnect**).
- **My current presence** to change your presence status. Select
 - **View current presence** and select **Private pres.** or **Public presence**.
 - **My availability** to set your availability status to **Available** indicated by , or to **Busy** indicated by , or to **Not available** indicated by .
 - **My presence message** and key in the text to be shown to other persons or press **Options** and select **Previous**

msgs. and select an old message as the status message.

- **My presence logo** to select your personal logo from the **Graphics** folder in the gallery. If you select the **Default**, the logo is not published.
- **Show to** to select the groups to whom you want to show your presence status or if not to show it at all.

Select **Private and public** and contacts in your private list are able to see all your presence information: availability, status message and logo. Other contacts can see only your availability.

Select **Private viewers** and the contacts in your private list can see all your presence information (availability, status message and logo). Other users will not see any information.

If you select **No one**, no one can see your presence information.

- **Viewers** and select
 - **Current viewers** to view all the persons who have subscribed to your presence information.
 - **Private list** is a list of the persons who are allowed to

view all your presence information, including availability, status message and logo. You can manage your own private list. Other persons who are not in the private list, can see only your availability.

- **Blocked list** to view all the persons you have blocked from viewing your presence information.
- **Settings** and select
 - **Show current presence in idle** to show the current status indicator in standby mode.
 - **Synchronise with profiles** to select whether you want to update your **My presence message** and **My availability** manually or automatically by linking them to the currently active profile. Refer also to Profiles on page 38. Note that you cannot link a personalised status logo to a Profile.
 - **Connection type** to select if the phone connects automatically to the service when the phone is switched on.
 - **IM and my presence settings**, see Instant messaging settings on page 26.

Subscribed names

You can create a list of contacts whose presence status information you want to be aware of. You can view the information if the contacts allow you to view it and if it is not prevented by the contact or network. You can view these subscribed names either by scrolling through the contacts or via the **Subscribed names** menu.

Ensure that the memory in use is either **Phone** or **Phone and SIM**.

To connect to the Presence service, press **Menu** and select **Contacts**, **My presence** and **Connect to 'My presence' service**.

Adding contacts to the subscribed names

1. Press **Menu** and select **Contacts** and **Subscribed names**. If you have not connected to the Presence service, the phone asks if you want to connect now.
2. If you have no contacts on your list, press **Add**. Otherwise, press **Options** and select **Subscribe new**. The list of your contacts is shown.
3. Select a contact from the list and if the contact has an user ID saved, the contact is added to the subscribed names list. If there is more than one ID, select one of them. After subscription of the

Menu functions



contact, *Subscription activated* is shown.

Viewing the subscribed names

Refer also to Searching for a contact on page 32 to view the presence information.

1. Press **Menu** and select *Contacts* and *Subscribed names*.

The status information of the first contact on the subscribed names list is displayed. The information that the person wants to give to others may include text and some of the following icons:

,  or  indicate that the person is either available, discreet or not available.

 indicates that the person's presence information is not available.

2. Press **Details** to view the details of the selected contact, or press **Options** and select
 - *Subscribe new* to add a new contact to the list of subscribed names.
 - *Chat* to start a conversation.
 - *Send message* to send a text message to the selected contact.
 - *Send SMS e-mail* to send an e-mail to the selected contact.

- *Send bus. card* to send a business card to the selected contact.
- *Unsubscribe* to remove the selected contact from the list of subscribed names.

Unsubscribing a contact

- To unsubscribe a contact from the *Contacts* list, press  in standby mode and scroll to the contact that you want to unsubscribe. Press **Details** and **Details** again, select the ID and press **Options**. To unsubscribe, select *Unsubscribe* and press **Yes** to confirm.
- To unsubscribe via the *Subscribed names* menu, see Viewing the subscribed names on page 36.

Sending and receiving a business card

You can send and receive a person's contact information from a compatible device as a business card. When you have received a (MMS) business card, press **Show** (, **Play**) and **Save** to save the business card in the phone's memory. To discard the business card, press **Exit** and then **Yes**.

To send a business card, search for the name and phone number that you want to send from *Contacts*, press **Details** and **Options** and

Menu functions

select *Send bus. card*. Select *Via text message* (network service) or *Via multimedia* (network service) and *Default number* or *All details*.

Speed dials

To assign a number to a speed-dialling key, press **Menu** and select *Contacts* and *Speed dials* and scroll to the speed-dialling key number that you want.

Press **Assign**, or if a number has already been assigned to the key, press **Options** and select *Change*. Press **Search**, and select first the name and then the number that you want to assign. If the *Speed dialling* function is off, the phone asks whether you want to activate it. See also *Speed dialling* in Call settings on page 40.

To make a call using the speed-dialling keys, see Speed dialling a phone number on page 9.

Voice dialling

You can make a phone call by saying a voice tag that has been added to a phone number. Any spoken word(s), such as a person's name(s), can be a voice tag. You can add up to ten voice tags.

Before using voice tags, note that:

- Voice tags are not language-dependent. They are dependent on the speaker's voice.

- You must say the name exactly as you said it when you recorded it.
- Voice tags are sensitive to background noise. Record voice tags and use them in a quiet environment.
- Very short names are not accepted. Use long names and avoid similar names for different numbers.



Note: Using voice tags may be difficult in a noisy environment or during an emergency, so you should not rely solely upon voice dialling in all circumstances.

Adding and managing voice tags

Save or copy in the phone's memory the contacts to which you want to add a voice tag. You can also add voice tags to the names in the SIM card, but if you replace your SIM card with a new one, you first need to delete the old voice tags before you can add new ones.

Voice tags use shared memory, see Shared memory on page vii.

1. In standby mode, press ▼.
2. Scroll to the contact to which you want to add a voice tag and press **Details**. Scroll to the phone number you want and press **Options**.
3. Select *Add voice tag*.

Menu functions

4. Press **Start**, and say clearly the word(s) you want to record as a voice tag. After recording, the phone plays the recorded tag. A symbol  appears after the phone number with a voice tag.

To check the voice tags, press **Menu** and select **Contacts** and **Voice tags**. Scroll to the contact with the voice tag that you want, and press **Select** to see the options to listen to, delete or change the recorded voice tag.

Making a call by using a voice tag

In standby mode, press and hold the right selection key. A short tone is heard and **Speak now** is displayed. Say the voice tag clearly. The phone plays the recognised voice tag and then dials the phone number of the voice tag after 1.5 seconds.

■ Settings



Profiles

Your phone has various setting groups, profiles, for which you can customise the phone tones for different events and environments. Initially, personalise the profiles to your own liking and then you only need to activate a profile to use it. Available profiles are **General**, **Silent**, **Meeting**, **Outdoor**, **My style 1**, and **My style 2**.

Press **Menu**, and select **Settings** and **Profiles**. Scroll to a profile and press **Select**.

- To activate the selected profile, select **Activate**.
- To personalise the profile, select **Personalise**. Select the setting you want to change and make the changes.
- To set the profile to be active until a certain time up to 24 hours, select **Timed** and set the time for the profile setting to end. When the time set for the profile expires, the previous profile that was not timed, becomes active.

Themes

A theme is a package that may include a screen saver, a wallpaper image, a ringing tone and a colour scheme to customise your phone for different events and environments. Themes are stored in **Gallery**.

Press **Menu**, and select **Settings** and **Themes**. To activate a theme, select **Select theme** to view the **Themes** folder in **Gallery**. Open the folder and scroll to a theme. Press **Options** and select **Apply theme**. Refer also to **Gallery** on page 45. To download new themes, select **Theme downloads**. Refer to **Downloading** on page 59.

Tone settings

You can change the settings of the selected active profile.

Press **Menu**, and select *Settings* and *Tone settings*. Select and change *Incoming call alert*, *Ringing tone*, *Ringing volume*, *Vibrating alert*, *Message alert tone*, *Instant message alert tone*, *Keypad tones* and *Warning tones*. You can find the same settings in the *Profiles* menu, see Profiles on page 38.

Select *Alert for* to set the phone to ring only upon calls from phone numbers that belong to a selected caller group. Scroll to the caller group you want to select or choose *All calls* and press **Mark**.

Light settings

Lets you select if different light sequences follow the phone functions. Press **Menu**, and select *Settings*, *Light settings* and *Light sequences* to set the light effects on or off.

Personal shortcuts

With personal shortcuts you get quick access to frequently used phone functions.

Right selection key

Press **Menu**, and select *Settings*, *Personal shortcuts* and *Right selection key* to allocate one phone function from a predefined list to

the right selection key. Refer also to Standby mode on page 6. This menu is not shown in some operator variants.

Go to options

You can allocate phone functions from a predefined list to the left selection key.

Press **Menu**, and select *Settings* and *Personal shortcuts*. Select *Select 'Go to' options* to choose the functions that you want to appear in the shortcut list. Select *Organise 'Go to' options* to rearrange the functions on your personal shortcut list. Refer also to Standby mode on page 6.

Voice commands

You can have phone functions which can be activated by saying a voice tag. Up to five functions can be selected for voice tag.

Press **Menu**, and select *Settings*, *Personal shortcuts* and *Voice commands*. Select the function folder that you want, scroll to the function to which you want to add a voice tag and press **Add**. A voice tag is indicated with .

To add a voice command, refer to the instructions in section Adding and managing voice tags on page 37. To activate a voice command, refer to the instructions in section Making a call by using a voice tag on page 38.

Menu functions

Display settings

Press **Menu**, and select *Settings* and *Display settings*.

- Select *Wallpaper* to set your phone to display a background image, known as wallpaper, when the phone is in standby mode.
- Select *Colour schemes* to change the colour in some display components, for example indicators and signal and battery bars, and the background image that appears when using a menu function.
- Select *Menu view* to set the way the phone displays the main menu.
- Select *Operator logo* to set your phone to display or hide the operator logo.
- Select *Screen saver* and *Select s. saver* to choose an animation or a still image as screen saver from *Gallery*. Select in *Time-out* the time after which the screen saver will be activated. Select *On* to activate the screen saver.
Independent of the screen saver settings, for power saving purposes, a digital clock view will be activated when no function of the phone has been used for a certain time. See Power saving on page 7.

Time and date settings

Press **Menu**, and select *Settings* and *Time and date settings*.



Select *Clock* to set the phone to show the clock in standby mode, adjust the clock and select time zone and the time format.

Select *Date* to set the phone to show the date in standby mode, set the date, and select the date format and date separator.

Select *Auto-update of date & time* (network service) to set the phone to automatically update the time and date according to the current time zone.

Call settings

Press **Menu**, and select *Settings* and *Call settings*. Select

- *Automatic volume control* and the phone will automatically adjust the speaker volume according to the background noise.
- *Call divert* (network service) to divert your incoming calls. For details, contact your service provider.
- *Anykey answer* and *On* and you can answer an incoming call by briefly pressing any key, except , selection keys  and .
- *Automatic redial* and *On* and your phone will make a maximum

Menu functions

- of ten attempts to connect the call after an unsuccessful call attempt.
- **Speed dialling** and **On** and the names and phone numbers assigned to the speed-dialling keys, from **ZABC** to **wxyz**, can be dialled by pressing and holding the corresponding number key.
 - **Call waiting** and **Activate** and the network will notify you of an incoming call while you have a call in progress (network service). See **Call waiting** on page 9.
 - **Summary after call** and **On** and the phone will briefly display the approximate duration and cost (network service) of the call after each call.
 - **Send my caller ID** (network service) and select **Yes** or **Set by network**.
 - **Line for outgoing calls** (network service) to select phone line 1 or 2 for making calls. Only shown if supported by your SIM card.

Phone settings

Press **Menu**, and select **Settings**, **Phone settings**. Select

- **Phone language** to set the display language of your phone. If you select **Automatic** the phone selects the language

according to the information on the SIM card.

- **Memory status** to view how much memory is available in the phone's memory.
- **Automatic keyguard** to set the keypad of your phone to lock automatically after a pre-set time delay when the phone is in standby mode and no function of the phone has been used. Select **On** and you can set the time from 5 seconds to 60 minutes. When the keyguard is on, calls still may be possible to the official emergency number.
- **Cell info display** and **On** to receive information from the network depending on the network cell used (network service).
- **Welcome note** and key in the note you would like to be shown briefly when the phone is switched on. To save the note, press **Save**.
- **Operator selection** and **Automatic** and the phone automatically selects one of the cellular networks available in your area. With **Manual**, you can select a network that has a roaming agreement with your home network operator.
- **Confirm SIM service actions**. See SIM services on page 62.

Menu functions

- **Help text activation** to set the phone to show or not to show the help texts.
- **Start-up tone** to set the phone to play or not to play a start-up tone when the phone is switched on.

Connectivity

You can define the settings for (E)GPRS dial-up connections.

(E)GPRS

GPRS (General Packet Radio Service) is a network service that allows mobile phones to be used for sending and receiving data over an Internet Protocol (IP)-based network. GPRS is a data bearer that enables wireless access to data networks such as the Internet.

EGPRS (Enhanced GPRS), also known as EDGE (Enhanced Data Rates for Global Evolution), is similar to GPRS. EDGE is a radio interface modulation technique which increases GPRS data rates. For more information on the availability of EGPRS and data transfer speed, contact your network operator or service provider.

The applications that may use (E)GPRS are MMS, Instant messaging, browsing sessions, e-mail, remote SyncML, Java application downloading and the PC dial-up (for example, Internet and e-mail).

Before you can use (E)GPRS technology, contact your network operator or service provider for availability of and subscription to the (E)GPRS service and save the (E)GPRS settings for each of the applications used over (E)GPRS. For information on pricing, contact your network operator or service provider.

Note that when you have selected GPRS as a data bearer, the phone uses EGPRS instead of GPRS if this is available in the network. You cannot select between EGPRS and GPRS but for some applications you may be able to select either GPRS or **GSM data** (CSD, Circuit Switched Data).

(E)GPRS connection

Press **Menu**, and select **Settings**, **Connectivity**, **GPRS** and **GPRS connection**.

- Select **Always online** to set the phone to automatically register to a (E)GPRS network when you switch the phone on.
- Select **When needed** and the (E)GPRS registration and connection are established when an application using (E)GPRS needs it and closed when you end the application.

(E)GPRS modem settings

You can connect the phone via a data cable connection to a compatible PC and use the phone as

Menu functions

a modem to enable (E)GPRS connectivity from the PC.

To define the settings for (E)GPRS connections from your PC, press **Menu**, and select *Settings*, *Connectivity*, *GPRS* and *GPRS modem settings*.

- Select *Active access point* and activate the access point that you want to use.
- Select *Edit active access point* to change the access point settings.
 - Select *Alias for access point*. Key in the name that you would like for the activated access point and press **OK**.
 - Select *GPRS access point*. Key in the Access Point Name (APN) to establish a connection to an (E)GPRS network and press **OK**. Contact your network operator or service provider for the APN.

You can also set the (E)GPRS dial-up service settings (Access Point Name) on your PC using the Nokia Modem Options software, see PC Suite on page 63. If you have set the settings both on your PC and on your phone, note that the PC's settings will be used.

Enhancement settings

The enhancement settings menu is shown only if the phone is or has

been connected to a compatible mobile enhancement, chargers and handsfree units, for example.

Press **Menu**, and select *Settings* and *Enhancement settings*. You can select an enhancement menu if the corresponding enhancement is or has been connected to the phone. Depending on the enhancement, you can select some of the following options: *Default profile*, *Automatic answer* and *Lights*.

Configuration settings

Some of the network services need to have the correct configuration settings on your phone. Get the settings from your SIM-card, from a service provider as a configuration message or key in your personal settings manually. Configuration settings from up to ten different service providers can be stored in the phone and can be managed within this menu.

To save the configuration settings received by a configuration message sent by a service provider, see Configuration settings service on page viii.

Press **Menu**, and select *Settings*, *Configuration settings*. Select

- *Default configuration settings* to view the list of service providers stored on the phone (the default service provider is highlighted) and to select

Menu functions

another service provider as default. Scroll to a provider and press **Details** to view the list with supported applications. To delete a service provider from the list, press **Options** and select **Delete**.

- **Activate default in all applications** to set the applications to use the settings from the default service provider.
- **Preferred access point** to select another access point. Normally the access point from your preferred network operator is to be used.

Keying in the settings manually

To enter, view and edit the settings manually, press **Menu**, and select **Settings**, **Configuration settings** and **Personal configuration settings**.

To add a new configuration, press **Add new** or press **Options** and select **Add new**. Choose one of the application types from the list and key in all the necessary settings. To activate the settings, press **Back** and **Options** and select **Activate**.

To view or to edit the user-defined settings select the application that you want to view and select the setting to edit.

Security settings

When calls are restricted, calls still may be possible to the official

emergency number programmed into your device.

Press **Menu**, and select **Settings** and **Security settings**. Select

- **PIN code request** to set the phone to request your PIN code every time the phone is switched on. Some SIM cards do not allow the PIN code request to be turned off.
- **Call barring service** (network service) to restrict incoming calls to and outgoing calls from your phone. A barring password is required.
- **Fixed dialling** to restrict your outgoing calls to selected phone numbers if this function is supported by your SIM card.
- **Closed user group** (network service) to specify the group of people whom you can call and who can call you.
- **Security level**. Select **Phone** and the phone will request the security code whenever a new SIM card is inserted into the phone.
Select **Memory** and the phone will request the security code when the SIM card's memory is selected and you want to change the memory in use.
- **Access codes** to change the security code, PIN code, PIN2 code or barring password.

Menu functions

- *Code in use* to specify whether the UPIN or PIN code should be active.

Restore factory settings

To reset some of the menu settings to their original values, press **Menu**, and select *Settings* and *Restore factory settings*.

Operator menu

This menu lets you access a portal to services provided by your network operator. This menu is operator specific. The name and the icon depend on the operator. For more information, contact your network operator.

The operator can update this menu with a service message. For more information, refer to Service inbox on page 59.

Gallery



In this menu, you can manage graphics, images, video clips, recordings and tones. These files are arranged in folders.

Your phone supports a Digital Rights Management (DRM) system to protect acquired content. A piece of content, for example a ringing tone, can be protected and associated with certain usage rules, for example number of usage times and a certain usage period. The rules are defined in

the content's activation key which can be delivered either together with the content or independently depending on the service provider. You may be able to update these activation keys. Always check the delivery terms of any content and activation key before acquiring them, as they may be subject to a fee.

Copyright protections may prevent some images, ringing tones, and other content from being copied, modified, transferred or forwarded.

1. Press **Menu** and select *Gallery*. A list of folders is shown. *Images*, *Video clips*, *Themes*, *Graphics*, *Tones* and *Recordings* are the original folders on the phone.
2. Scroll to the desired folder and press **Open** to view a list of files in the folder or press **Options** and one of the options may be available:
Downloads, *Delete folder*, *Move*, *Rename folder*, *Details*, *Type of view*, *Sort*, *Add folder*, *Memory status* and *Activation key list*.
3. If you have opened a folder, select the file that you want to view and press **Open**. If *Themes* was selected before, scroll to a theme and press **View** to open the theme package.
Select and open a file, or press **Options** and use one of the

Menu functions

following functions that may be available for the selected file:

Delete, Send, Edit image, Move, Rename, Set as wallpaper, Set as ring tone, Apply theme, Details, Type of view, Sort, Delete all, Open in sequence, Mute audio (Unmute audio), Set contrast, Add folder, Memory status, Activate content and Activation key list.

Media



Camera

You can take photos or record video clips with the phone's built-in camera. The camera produces pictures in JPEG format and the video clips in 3GP format.

The Nokia 3220 device supports an image capture resolution of 640 x 480 pixels. The image resolution in these materials may appear different.

Taking a photo or a video clip

Press **Menu**, and select *Media, Camera*. The live image appears on the display, and you can use the display as a viewfinder. Press **Left Arrow** or **Right Arrow** to change the camera mode: *Standard photo, Portrait photo* or *Video*, or if the lighting is dim for taking photos to *Night mode*. If you want to add the photo to a name or a phone number saved in contacts, select *Portrait photo*.

- To take a photo, press **Capture**. A shutter sound is heard. The phone saves the photo in the *Images* folder of the *Gallery* menu.

If you want to send the photo as a multimedia message, press **Send**.

Or select **Back** to take another photo, or press **Options** and select, for example, an option to rename or zoom the saved photo or to set the contrast, to see the details, or to set the photo as wallpaper, or to open the gallery, or to delete it.



Tip: You can activate the self-timer of the camera for one picture at a time. Put the camera in photo mode, press **Options** and select *Self-timer*. Press **Start**, and after the timeout, the camera takes the photo. While the self-timer is running, a beeping sound is heard.

- To start recording a video clip, press **Record**. When you are recording a video clip, the remaining recording time is shown on the top of the display. To pause the recording, press **Pause** and to resume the recording, press **Continue**. To stop the recording, press **Stop**. The phone saves the recording in the *Video clips* folder of the

Menu functions

Gallery menu. To view the recorded video clip, press **Play**.

Select **Back** to start recording a new video clip, or press **Options** and select, for example, an option to delete or rename the saved video clip, to set the contrast, or to see the details, to send it as a multimedia message, or to open the gallery, or to mute/unmute the microphone.

Camera settings

Press **Menu**, and select **Media**, **Camera**. Press **Options** and depending on the active camera mode the following options may appear: *Change mode*, *Self-timer*, *Mute/Unmute*, *Open gallery*, or *Settings* to adjust the camera settings *Default mode*, *Image quality*, *Video clip length*, *Camera sounds*, *Self-timer lights*, *Default title*.

Voice recorder

You can record pieces of speech, sound or an active call for up to 5 minutes. For example, this is useful when recording a name and phone number for writing down later.

The recorder cannot be used when a data call or GPRS connection is active.

Recording

1. Press **Menu**, select **Media** and **Voice recorder**.

2. To start the recording, select **Record**. To start the recording during a call, press **Options**, and select **Record**. While recording a call, all parties to the call will hear a faint beeping sound every 5 seconds approximately.
3. To end the recording, press **Stop**. The recording will be saved in the **Recordings** folder of the **Gallery** menu.
4. To listen to the latest recording, select **Play last recorded**.
5. To send the latest recording, select **Send last recorded**.

List of recordings

Press **Menu**, and select **Media**, **Voice recorder** and **Recordings list**. The list of folders in the **Gallery** is shown. Open **Recordings** to see the list with recordings.

Organiser



Alarm clock

You can set the phone to alarm at a desired time. Press **Menu**, and select **Organiser** and **Alarm clock**.

To set the alarm, select **Alarm time**, and enter the alarm time. To change the alarm time when the alarm time is set, select **On**. Select **Repeat alarm** to set the phone to alert you on selected days of the week.

Select **Alarm tone** and select the default alarm tone, personalise the

Menu functions

alarm tone by selecting one from the ringing tone list or from Gallery.

When the alarm time expires

The phone will sound an alert tone, and flash **Alarm!** and the current time on the display, even if the phone was switched off. Press **Stop** to stop the alarm. If you let the phone continue to sound the alarm for a minute or press **Snooze**, the alarm stops for about 10 minutes and then resumes.

If the alarm time is reached while the device is switched off, the device switches itself on and starts sounding the alarm tone. If you press **Stop**, the device asks whether you want to activate the device for calls. Press **No** to switch off the device or **Yes** to make and receive calls. Do not press **Yes** when wireless phone use may cause interference or danger.

Calendar

The calendar uses shared memory, see Shared memory on page vii.





Press **Menu**, and select **Organiser** and **Calendar**.

The current day is indicated by a frame. If there are any notes set for the day, the day is in bold type. To view the day notes, press **View**. To view a week, press **Options** and select **Week view**. To view a single note, press **View**.



Other options for the calendar view may be options for creating a note, for deleting, editing, moving and repeating a note and for copying a note to another day, or for sending a note as a note directly to another compatible phone's calendar or as a text message or a multimedia message. In **Settings** you can set the date, time, time zone, date or time format, or the first day of the week. In the **Auto-delete** option you can set the phone to delete old notes automatically after a specified time.

To delete all notes in the calendar, select the month or week view, press **Options** and select **Delete all notes**.

Making a calendar note

Press **Menu**, and select **Organiser** and **Calendar**. Scroll to the date you want, press **Options** and select **Make a note**. Select one of the following note types:  **Meeting**,  **Call**,  **Birthday**,  **Memo** or  **Reminder**.

When the phone sounds an alarm for a note

The phone beeps, and displays the note. With a call note  on the display, you can call the displayed number by pressing . To stop the alarm and to view the note, press **View**. Press **Snooze** and the phone sounds an alarm again after 10 minutes. To stop the alarm without viewing the note, press **Exit**.

To-do list

You can save a note for a task that you have to do, select a priority level for the note and mark it as done when you have completed it. You can sort the notes by priority or by date. The to-do list uses shared memory, see Shared memory on page vii.

Press **Menu**, and select *Organiser* and *To-do list*.

Press **Add note** to make a note. Key in the note and press **Save**. Select the priority for the note. The phone automatically sets the deadline without an alarm for the note. To change the deadline, view the note and select the deadline option.

Or scroll to a note and press **View** or press **Options**. To add a new note, select *Add*. For example, you can also view and delete the selected note and delete all the notes that you have marked as done. You can sort the notes by priority or by deadline, send a note to another phone, save a note as a calendar note, or access the calendar. While viewing a note, you can also, for example, select an option to edit the selected note, edit the deadline or priority for the note, or mark the note as done.

Notes

You can use this application for writing and sending notes to

compatible devices via MMS. The Notes application uses shared memory, see Shared memory on page vii.

Press **Menu** and select *Organiser* and *Notes*. The phone will ask you to set the date and time, if they have not already been set when you start to write a note. To add a note, press **Add note** or press **Options** and select *Make a note*. Key in the note and select *Save*. Or scroll to a note press **View** or press **Options** to see the options for notes.

Synchronisation

Synchronisation allows you to save your calendar and contacts data on a remote Internet server (network service) or on a compatible PC. If you have saved data on the remote Internet server, you can synchronise your phone by starting the synchronisation from your phone. You can also synchronise the data in your phone's contacts, calendar and notes to correspond to the data of your compatible PC by starting the synchronisation from your PC.

The contact data in your SIM card will not be synchronised.

Synchronising from your phone

Before synchronising from your phone, you need to subscribe to a synchronisation service and get the configuration settings from your provider. For more information on

Menu functions

availability and the synchronisation service settings, contact your service provider.

To start the synchronisation from your phone:

1. Activate the connection settings you need for the synchronisation. See Settings for the synchronisation from your phone on page 50.
2. Press **Menu**, select *Organiser*, *Synchronisation*, *Server sync*. Select *Data to be synchronised* and mark the data to be synchronised and press **Done**. Then select *Synchronise*. The marked data of the active set will be synchronised after confirmation.

Settings for the synchronisation from your phone

You may receive the synchronisation settings as a configuration message from the service provider. For more information on availability and the synchronisation service settings, contact your service provider. For receiving the settings as a configuration message, see Configuration settings service on page viii. To key in the settings manually, see Configuration settings on page 43.

Press **Menu**, select *Organiser*, *Synchronisation* and *Server sync* and *Sync settings*. Select

Configuration and scroll to the service provider whose settings you would like to activate and press **Select**. Select *Account* to see the accounts provided by the service provider. If more than one account is displayed choose the one you want to use.

Synchronising from your compatible PC

To synchronise contacts, the calendar and the notes from your PC, use a data cable. You also need the PC Suite software of your phone installed on the PC. Start the synchronisation from the PC using PC suite.

Ensure that the phone is in standby mode and that the time and date are set.

■ Applications



Games and applications

Your phone software may include some games and Java applications specially designed for this Nokia phone.

Launching a game or an application

Press **Menu**, and select *Applications*, then *Games* and *Select game*, or *Collection* and *Select application*. Scroll to a game

or an application and press **Open** or press .

The following options may be available for games and applications: *Delete, Details, Update version, Web page, App. access.*

Game and application downloads

Your phone supports J2ME™ Java applications. Make sure that the application is compatible with your phone before downloading it.

Press **Menu**, and select *Applications, Games* and *Game downloads* or *Collection* and *App. downloads*. The list of available bookmarks is shown. Select *More bookmarks* to access the list of bookmarks in the *Services* menu, see Bookmarks on page 58.

Select a bookmark to connect to the desired service. For the availability of different services, pricing and tariffs, contact your service provider.



Important: Only install and use applications and other software from sources that offer adequate security and protection against harmful software.

Note that when downloading an application, it may be saved in the *Games* menu instead of the *Applications* menu.

Game settings

Press **Menu**, and select *Applications, Games* and *App. settings* to set sounds, lights and shakes for games.

Memory status for games and applications

To view the amount of memory available for game and application installations (third shared memory), press **Menu**, and select *Applications, Games* or *Collection* and then *Memory*.

The games and applications use shared memory, see Shared memory on page vii.

Calculator

The calculator in your phone adds, subtracts, multiplies, divides, calculates the square and the square root and converts currency values.



Note: This calculator has limited accuracy and is designed for simple calculations.

Press **Menu**, and select *Applications, Extras* and *Calculator*. When '0' is displayed on the screen, key in the first number in the calculation, press \diamond # for a decimal point. Press **Options** and select *Add, Subtract, Multiply, Divide, Square, Square root* or *Change sign*. Key in the second number. To get the answer, press **Equals**. To start a new

Menu functions

calculation, first press and hold **Clear**.

Performing a currency conversion

Press **Menu**, and select *Applications, Extras* and *Calculator*. To save the exchange rate, press **Options** and select *Exchange rate*. Select either of the displayed options. Key in the exchange rate, press \diamond # for a decimal point, and press **OK**. The exchange rate remains in the memory until you replace it with another one. To perform the currency conversion, key in the amount to be converted, press **Options** and select *In domestic* or *In foreign*.

Countdown timer

Press **Menu**, and select *Applications, Extras* and *Countdown timer*. Key in the alarm time in hours, minutes and seconds and press **OK**. If you wish, write your own note text which is displayed when the time expires, and press **Start** to start the countdown timer.

To change the countdown time, select *Change time*, or to stop the timer, select *Stop timer*.

If the alarm time is reached when the phone is in standby mode, the phone sounds a tone and flashes the note text if it is set or else *Countdown time up*. Stop the alarm by pressing any key. If no key is pressed, the alarm automatically

stops within 30 seconds. To stop the alarm and to delete the note text, press **Exit**.

Stopwatch

You can measure time, take intermediate times or lap times using the stopwatch. During timing, the other functions of the phone can be used. To set the stopwatch timing in the background, press $\overline{\text{F5}}$.

Using the stopwatch or allowing it to run in the background when using other features increases the demand on battery power and reduces the battery life.

Time observation and time splitting

1. Press **Menu**, and select *Applications, Extras, Stopwatch* and *Split timing*. You can select *Continue* if you have set the timing in the background.
2. Press **Start** to start the time observation. Press **Split** every time you want to take an intermediate time. The intermediate times are listed below the running time on the display. Scroll to view the times.
3. Press **Stop** to stop the time observation.
4. To save the times, press **Save**. Or press **Options** and you can start the time observation again or reset the times without saving it.

Lap times

Press **Menu**, and select *Applications, Extras, Stopwatch* and *Lap timing*. Press **Start** to start the time observation and **Lap** to take a lap time. Press **Stop** to stop the lap timing. To save the times, press **Save** and enter a name. Or press **Options** and you can save or reset the lap times.

Viewing and deleting times

Press **Menu**, and select *Applications, Extras* and *Stopwatch*.

If the stopwatch is not reset, you can select *Show last* to view the most recent measured time. Select *View times* and a list of names or final times of the time sets is shown, select the time set that you want to view.

To delete the saved times, select *Delete times*. Select *Delete all* and press **OK**, or select *One by one*, scroll to the times you want to delete, press **Delete** and press **OK**.

Wallet

In *Wallet* you can save personal information, for example, credit card numbers and addresses. The data that are saved in the wallet can easily be retrieved while browsing to automatically fill in data fields, for example, when making purchases and the service supports wallet functionality. You can also save

access codes to mobile services that request a user name and password.

The data in the wallet are protected with a wallet code that you can define when you access wallet for the first time. At *Create wallet code:* key in the code and press **OK** to confirm it and at *Verify wallet code:* key in the code again and press **OK**. See also Wallet code (4 to 10 digits) on page vii.

If you want to delete all the content of the wallet and the wallet code, key in *#7370925538# (*#res wallet# in letters) in standby mode. You also need the phone's security code, see Access codes on page vii.

To add the content into the wallet menu, and to edit it, access the wallet menu. To use the content of the wallet in a mobile service, access the wallet via the browser, see Services on page 55.

Accessing the wallet menu

To access the wallet menu, press **Menu**, select *Applications, Extras* and *Wallet*. Key in your wallet code and press **OK**, see Wallet settings on page 54.

Select *Wallet profiles* to create card combinations, *Cards* to save personal card information, *Tickets* to save the notifications of e-tickets that you have bought via a mobile service, *Receipts* to save receipts of mobile purchases, *Personal notes* to save all kinds of personal

Menu functions

information that you want to keep protected by the wallet PIN code, or [Settings](#), see Wallet settings on page 54.

Saving card details

Access the wallet and select [Cards](#). Select the card type to save details: [Payment cards](#), [Loyalty cards](#), [Access cards](#), [User info cards](#), or [Address cards](#). If no card is added, press **Add new**, otherwise, press **Options** and select [Add new](#). Fill in the fields for the details and press **Done**.

If supported by your service provider, you can also receive card information to your phone as a configuration message. You will be notified as to which category the card belongs to. For availability of receiving card information as configuration settings, contact the card issuer or service provider.

Personal notes

You can save personal notes, for example, account numbers, passwords, codes or notations.

Access the wallet and select [Personal notes](#). Press **Options** and you can view, add, edit a selected note and sort notes either by name or date or delete notes. When viewing a note, you can edit or delete the selected note. The option [Send via text msg.](#) is for copying the note as a text message and [Copy to calendar](#) is for copying the note to

the calendar as a memo. [Use detail](#) is for extracting numbers, e-mail addresses and web addresses from a note.

Creating a wallet profile

When you have saved your personal card details, you can combine them together into a wallet profile. You can use the profile to retrieve wallet data from different cards while browsing.

1. Access the wallet and select [Wallet profiles](#).
2. To create a new wallet profile if no profile is added, press **Add new**. Otherwise, press **Options** and select [Add new](#).
3. Fill in the following fields and press **Done**. Select [Select payment card next](#), [Select loyalty card next](#), [Select access card next](#), [Select user info card next](#), [Select billing address next](#), [Select shipping address next](#), [Select receipt delivery address next](#), [Select receipt delivery method next](#) and [Wallet profile name](#).

Wallet settings

Access the wallet and select [Settings](#). Select [Change code](#) to change the wallet code. Select [RFID](#) to set the RFID ID with the [RFID code](#) and [RFID type](#). (RFID = Radio Frequency Identification, technology

Menu functions

to securely conduct commercial transactions using your phone).

Guidelines for paying for your purchases with the wallet

- To do your shopping, access the desired service site that supports the wallet. The service needs to support the Electronic Commerce Modeling Language specification. See Making a connection to a service on page 56.

Choose the product that you want to buy and carefully read all information provided before your purchase.

The text may not fit within a single screen. Therefore, make sure to scroll through and read all of the text before your purchase.

- To pay for the items that you wish to buy, the phone asks whether you want to use wallet or not. The phone also asks for your wallet PIN code.
- Select the card that you want to pay with from the Payment cards list. Provided that the data from you receive from the service provider supports the Electronic Commerce Modeling Language specification, the phone automatically fills in the credit card information or the wallet profile from the wallet.

- Approve the purchase, and the information is forwarded.
- You may receive an acknowledgement or a digital receipt of the purchase.
- To close the wallet, select *Close wallet*. If you do not use the wallet for 5 minutes, it will be automatically closed.

A cache is a memory location that is used to store data temporarily. If you have tried to access or have accessed confidential information requiring passwords, empty the cache after each use. The information or services you have accessed is stored in the cache.

To empty the cache, see The cache memory on page 60.

Services



You can access various mobile Internet services with your phone's browser.

Check the availability of these services, pricing and tariffs with your network operator and/or the service provider.

With your phone's browser you can view the services that use Wireless Mark-Up Language (WML) or extensible HyperText Mark-up Language (xHTML) on their pages.

Appearance may vary due to screen size. Note that you may not be able

Menu functions

to view all the details of the Internet pages.



Important: Use only services that you trust and that offer adequate security and protection against harmful software.

Basic steps for accessing and using services

1. Save the service settings that are required to access the service that you want to use. See page 56.
2. Make a connection to the given service. See page 56.
3. Start browsing the pages of the service. See page 57.
4. Once you are finished browsing, end the connection to the service. See page 57.

Setting up the phone for a service

Your phone may have stored some service settings. Additional settings may be received as a configuration message from the service provider that offers the service that you want to use. To receive the service settings as a configuration message, see Configuration settings service on page viii and Configuration settings on page 43.

For more information and for the appropriate settings, contact your service provider.

Making a connection to a service

Make sure that the service settings of the service you want to use are activated. To activate the settings, press **Menu**, and select *Services*, *Settings* and *Configuration settings*. Select *Configuration* and select the configuration set you want to activate.

Make a connection to the service. There are several ways to connect:

- Open the start page, for example, the homepage of the service provider: press **Menu**, and select *Services* and *Home*, or in standby mode press and hold .
- Select a bookmark of the service: press **Menu**, and select *Services*, *Bookmarks*, and select a bookmark. If the bookmark does not work with the current active service settings, activate another set of service settings and try again.
- Select the last URL: press **Menu**, and select *Services*, *Last web addr.*
- Key in the address of the service: press **Menu**, and select *Services* and then *Go to address*. Key in

Menu functions

the address of the service and press **OK**.

- In standby mode, press and hold $\star +$, to connect to Nokia.com.

Browsing the pages of a service

After you have made a connection to the service, you can start browsing its pages. The function of the phone keys may vary in different services. Follow the text guides on the phone display. For more information, contact your service provider.

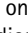
Note that if GPRS is selected as the data bearer, the indicator  is shown on the top left of the display during browsing. If you receive a call or a text message, or make a call during an (E)GPRS connection, the indicator  will be shown on the top left of the display to indicate that the (E)GPRS connection is suspended (on hold). After a call, for example, the phone tries to reconnect the (E)GPRS connection.

Using the phone keys while browsing

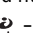
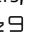
- Use any of the scroll keys to browse through the page.
- To select a highlighted item, press , or press **Options** to select the option for opening the link.
- To enter letters and numbers, press the keys  - .

and to enter special characters, press the key $\star +$.

Options while browsing

Press **Options** and the following options may be available. The service provider may also offer other options. Select *Shortcuts*, *Home*, *Add bookmark*, *Bookmarks*, *History*, *Download links*, *Page options*, *Save to folder*, *Other options*, *Reload*, *Quit*.

A cache is a memory location that is used to store data temporarily. If you have tried to access or have accessed confidential information requiring passwords, empty the cache after each use. The information or services you have accessed is stored in the cache. To empty the cache, see The cache memory on page 60.

Direct calling

The browser supports functions that you can access while browsing. You can make a voice call, send DTMF tones while a voice call is in progress, and save a name and a phone number from a page.

Disconnect from a service

To quit browsing and to end the connection, press **Options** and select *Quit*. When *Quit browsing?* is shown, press **Yes**.

Alternatively, press  twice, or press and hold .

Menu functions

Appearance settings of the browser

While browsing, press **Options** and select *Other options* and *Appearance settings*, or in standby mode, press **Menu**, and select *Services*, *Settings* and *Appearance settings*. Select

- *Text wrapping*. Select *On* and the text continues on the next line. If you select *Off*, the text will be abbreviated.
- Select *Font size* and choose a size.
- *Show images*. Select *No* and any pictures appearing on the page are not shown.
- *Alerts* and select *Alert for unsecure connection* and *Yes* to set the phone to alert when a secure connection changes to an insecure one during browsing. Select *Alert for unsecure items* and *Yes* to set the phone to alert when a secure page contains an insecure item. Note that these alerts do not guarantee a secure connection. For more information, see Browser security on page 60.
- *Character encoding* to select the character set that the phone uses for showing browser pages that do not include that information or to select whether to always use UTF-8 encoding when sending a Web address to a compatible phone.

Cookies

A cookie is data that a site saves in your phone's browser cache memory. The data can be, for example, your user information or your browsing preferences. Cookies will be saved until you clear the cache memory, see The cache memory on page 60.

While browsing, press **Options** and select *Other options*, *Security* and *Cookie settings*, or in standby mode, press **Menu**, and select *Services*, *Settings*, *Security settings* and *Cookies*. Select *Allow* or *Reject* to allow the phone to or prevent the phone from receiving cookies.

Bookmarks

You can save page addresses as bookmarks in the phone's memory.

1. While browsing, press **Options** and select *Bookmarks*, or in standby mode, press **Menu**, and select *Services* and *Bookmarks*.
2. Scroll to the bookmark that you want to use and press **Select** to make a connection to the page associated with the bookmark.
Or select **Options** to view the title and the address of the selected bookmark, edit or delete the selected bookmark, or send it directly to another phone as a bookmark, or as a text message, or create a new bookmark.

Your device may have some bookmarks loaded for sites not affiliated to Nokia. Nokia does not warrant or endorse these sites. If you choose to access them, you should take the same precautions, for security or content, as you would with any Internet site.

Receiving a bookmark

When you have received a bookmark (sent as a bookmark) **1 bookmark received** is displayed. Press **Show** to view the bookmark. To save the bookmark, press **Save**, or press **Options** and select **View** to see the details or **Delete** to discard it.

Downloading

To download more tones, graphics, games, videos, themes or applications to your phone (network service), press **Menu**, and select **Services** and **Download links**. Select **Tone downloads**, **Graphic downloads**, **Game downloads**, **Video downloads**, **Theme downloads** or **App. downloads**.



Important: Only install and use applications and other software from sources that offer adequate security and protection against harmful software.

For the availability of different services, pricing and tariffs, contact your network operator and/or service provider.

Service inbox

The phone is able to receive service messages (pushed messages) sent by your service provider (network service). Service messages are notifications of, for example, news headlines, and they may contain a text message or an address of a service.

To access the **Service inbox** in standby mode, when you have received a service message, press **Show**. If you press **Exit** the message is moved to the **Service inbox**. To access the **Service inbox** later, press **Menu**, and select **Services** and **Service inbox**.

To access the **Service inbox** while browsing, press **Options** and select **Other options** and **Service inbox**. Scroll to the message that you want, press **Retrieve** to activate the browser and download the marked content or press **Options** and select **Details** to display detailed information on the service notification, or select **Delete** to delete it.

Service inbox settings

Press **Menu**, and select **Services**, **Settings** and **Service inbox settings**. Select **Service messages** and **On** (or **Off**) to set the phone to receive (or not to receive) service messages.

Select **Message filter** and **On** to set the phone to receive service messages only from content authors

Menu functions

approved by the service provider. To view the list of the approved content authors, select [Trusted channels](#).

Select [Automatic connection](#). If you have set the phone to receive service messages and select [On](#), the phone will automatically activate the browser from standby mode when the phone has received a service message. If you select [Off](#), the phone will activate the browser only after you have selected [Retrieve](#) when the phone has received a service message.

The cache memory

The information or services that you have accessed are stored in the cache of your phone. A cache is a buffer memory, which is used to store data temporarily. To empty the cache while browsing, press **Options** and select [Other options](#) and [Clear the cache](#), or in standby mode, press **Menu**, and select [Services](#), and [Clear the cache](#).

Browser security

Security features may be required for some services, such as banking services or online shopping. For such connections you need security certificates and possibly a security module which may be available on your SIM card. For more information, contact your service provider.

Security module

The security module can contain certificates as well as private and public keys. The purpose of the security module is to improve security services for applications requiring browser connection, and it allows you to use a digital signature. The certificates are saved in the security module by the service provider.

Press **Menu** and select [Services](#), [Settings](#), [Security settings](#) and [Security module settings](#). Select

- [Security module details](#) to show the security module title, its status, manufacturer and serial number.
- [Module PIN request](#) to set the phone to request the module PIN when using services provided by security module. Key in the code and select [On](#). To disable the module PIN request, select [Off](#).
- [Change module PIN](#) to change the module PIN, if allowed by the security module. Enter the current module PIN code, then enter the new code twice.
- [Change signing PIN](#). Select the signing PIN that you want to change. Enter the current PIN code, then enter the new code twice.

See also Access codes on page vii.

Certificates

There are three kinds of certificates: server certificates, authority certificates and user certificates.

- The phone uses a server certificate to create a connection with improved security to the content server. The phone receives the server certificate from the service provider before the connection is established and its validity is checked using the authority certificates saved in the phone. Server certificates are not saved.

The security indicator  is displayed during a connection if the data transmission between the phone and the content server is encrypted.

The security icon does not indicate that the data transmission between the gateway and the content server (or place where the requested resource is stored) is secure. The service provider secures the data transmission between the gateway and the content server.

- Authority certificates are used by some services, such as banking services, for checking the validity of other certificates. Authority certificates can either be saved in the security module by the service provider, or they can be downloaded from the network, if

the service supports the use of authority certificates.

- User certificates are issued to users by a Certifying Authority. User certificates are required, for example, to create a digital signature and they associate the user with a specific private key in a security module.



Important: Note that even if the use of certificates makes the risks involved in remote connections and software installation considerably smaller, they must be used correctly in order to benefit from increased security. The existence of a certificate does not offer any protection by itself; the certificate manager must contain correct, authentic, or trusted certificates for increased security to be available. Certificates have a restricted lifetime. If Expired certificate or Certificate not valid yet is shown even if the certificate should be valid, check that the current date and time in your device are correct.

Before changing any certificate settings, you must make sure that you really trust the owner of the

Menu functions

certificate and that the certificate really belongs to the listed owner.

Digital signature

You can make digital signatures with your phone if your SIM card has a security module. The signature can be traced back to you via the private key on the security module and the user certificate that was used to perform the signature. Using the digital signature can be the same as signing your name to a paper bill, contract or other document.

To make a digital signature, select a link on a page, for example, the title of the book that you want to buy and its price. The text to sign (possibly including amount, date, etc.) will be shown.

Check that the header text is *Read* and that the digital signature icon  is shown.



Note: If the digital signature icon does not appear, there is a security breach, and you should not enter any personal data such as your signing PIN.

To sign the text, read all of the text first and then you can select **Sign**.

The text may not fit within a single screen. Therefore, make sure to scroll through and read all of the text before signing.

Select the user certificate you want to use. Key in the signing PIN (see

General information on page vi) and press **OK**. The digital signature icon will disappear, and the service may display a confirmation of your purchase.

SIM services



In addition to the functions available on the phone, your SIM card may provide additional services that you can access in this menu which is shown only if it is supported by your SIM card. The name and contents of the menu depend on the SIM card.

For availability, rates and information on using SIM services, contact your SIM card vendor, e.g. network operator, service provider or other vendor.

Depending on the operator you can set the phone to show you the confirmation messages sent between your phone and the network when you are using the SIM services by selecting the option *Yes* within the menu *Confirm SIM service actions*, in *Phone settings*.

Note that accessing these services may involve sending messages or making a phone call for which you may be charged.

6. PC Connectivity

You can send and receive e-mails, and access the Internet when your phone is connected to a compatible PC via a data cable connection. You can use your phone with a variety of PC connectivity and data communications applications. With PC Suite you can, for example, synchronise contacts, calendar and notes between your phone and the compatible PC or a remote Internet server (network service).

You may find more information and downloadable files, for example PC suite, in the support area on the Nokia website, www.nokia-asia.com.

■ PC Suite

PC Suite contains the following applications (in alphabetical order):

- **HTML Help** to support the application usage.
- **Nokia 3220 data modem drivers** enable you to use your phone as a modem.
- **Nokia Application Installer** to install J2ME Java applications from a compatible PC to the phone, for example games and dictionaries.
- **Nokia Connection Manager** to select the connection type between the PC and phone.
- **Nokia Contacts Editor** to edit contacts in your phone.
- **Nokia Content Copier** to back-up and restore personal data between your phone and a compatible PC. Supports also content transfer to another compatible Nokia phone.
- **Nokia Image Converter** to make images in supported formats usable for multimedia messages or wallpaper and to transfer them to your phone. Additionally you can create cut-out covers and print them, see Creating cut-out covers on page 4.
- **Nokia Modem Options** contains settings for HSCSD and GPRS connections.
- **Nokia Multimedia Player** to for playing sounds, images, videos and multimedia messages on the PC. Multimedia Player allows you to view multimedia received on your phone or via e-mail.
- **Nokia PC Sync** to synchronise contacts, calendar and to-do notes between your phone and a compatible PC.
- **Nokia Phone Browser** to view the contents of the Gallery folder of your phone on a compatible PC. You can browse picture and audio files and also modify files

PC Connectivity

in the phone's memory and transfer files between your phone and PC.

- **Nokia Phone Editor** to send text messages and edit the contacts in your phone.
- **Nokia Sound Converter** to optimise polyphonic ringing tones in supported formats to be compatible with your phone and to transfer them to your phone.

Copyright protections may prevent some images, ringing tones, and other content from being copied, modified, transferred or forwarded.

(E)GPRS, HSCSD and CSD

With your phone you can use the (E)GPRS (Enhanced GPRS), GPRS (General Packet Radio Service), HSCSD (High Speed Circuit Switched Data) and CSD (Circuit Switched Data, *GSM data*) data services.

For availability and subscription to data services, contact your network operator or service provider.

Note that the use of HSCSD services consumes the phone's battery faster than normal voice or data calls. You may need to connect the phone to a charger for the duration of the data transfer.

See (E)GPRS modem settings on page 42.

■ Using data communication applications

For information on using a data communication application, refer to the documentation provided with it.

Note that making or answering phone calls during a computer connection is not recommended as it might disrupt the operation.

For better performance during data calls, place the phone on a stationary surface with the keypad facing downward. Do not move the phone by holding it in your hand during a data call.

7. Battery information

■ Charging and Discharging

Your device is powered by a rechargeable battery. The full performance of a new battery is achieved only after two or three complete charge and discharge cycles. The battery can be charged and discharged hundreds of times but it will eventually wear out. When the talk and standby times are noticeably shorter than normal, buy a new battery. Use only Nokia approved batteries, and recharge your battery only with Nokia approved chargers designated for this device.

Unplug the charger from the electrical plug and the device when not in use. Do not leave the battery connected to a charger. Overcharging may shorten its lifetime. If left unused, a fully charged battery will lose its charge over time. Temperature extremes can affect the ability of your battery to charge.

Use the battery only for its intended purpose. Never use any charger or battery that is damaged.

Do not short-circuit the battery. Accidental short-circuiting can occur when a metallic object such as a coin, clip, or pen causes direct

connection of the positive (+) and negative (-) terminals of the battery. (These look like metal strips on the battery.) This might happen, for example, when you carry a spare battery in your pocket or purse. Short-circuiting the terminals may damage the battery or the connecting object.

Leaving the battery in hot or cold places, such as in a closed car in summer or winter conditions, will reduce the capacity and lifetime of the battery. Always try to keep the battery between 15°C and 25°C (59°F and 77°F). A device with a hot or cold battery may not work temporarily, even when the battery is fully charged. Battery performance is particularly limited in temperatures well below freezing.

Do not dispose of batteries in a fire! Dispose of batteries according to local regulations. Please recycle when possible. Do not dispose as household waste.

English

Genuine Enhancements

8. Genuine Enhancements

A new extensive range of enhancements is available for your phone. Select the enhancements which accommodate your specific communication needs.



Some of the enhancements are described in detail below.

For availability of the enhancements, please check with your local dealer. A few practical rules for enhancements operation:

- Keep the enhancements out of small children's reach.
- When you disconnect the power cord of any accessory, grasp and pull the plug, not the cord.
- Check regularly that all mobile phone equipment in a vehicle is mounted and operating properly.

Use only batteries, chargers and enhancements approved by the phone manufacturer. The use of any other types may invalidate any approval or warranty applying to the phone, and may be dangerous.

■ Power

Type	Tech	Talktime*	Standby*
BL-5B	Li-ion	min 2,5 h up to 3.5 h	min 150 h up to 350 h

* Variation in operation times may occur depending on SIM card, network and usage settings, usage style and environments. Use of FM radio and integrated hands-free will affect talktime and standby.

Standard Charger (ACP-7)

Small, lightweight and durable charger ACP-7 provides an easy and convenient way to charge the phone. It is easy to connect to phone or desktop stand.

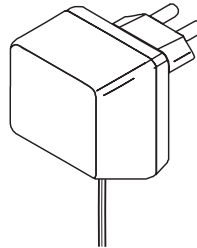

Note: The plug types vary according to different markets.

Travel Charger (ACP-12)

Small, lightweight travel charger with multivoltage (100 - 240V) switcher technology. Provides easy and convenient way to charge the phone.

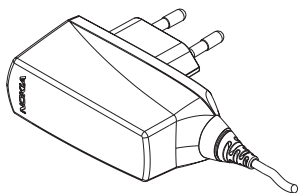

Note: The plug types vary according to different markets.

■ Audio

Boom Headset (HDB-4)

This small and lightweight headset has a beautiful and distinctive Nokia design. Gives you excellent audio quality and you can answer or end calls by pressing the button on the microphone part of the headset.

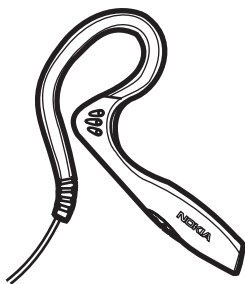

Care and maintenance

9. Care and maintenance

Your device is a product of superior design and craftsmanship and should be treated with care. The suggestions below will help you protect your warranty coverage.

- Keep the device dry. Precipitation, humidity and all types of liquids or moisture can contain minerals that will corrode electronic circuits. If your device does get wet, remove the battery and allow the device to dry completely before replacing it.
- Do not use or store the device in dusty, dirty areas. Its moving parts and electronic components can be damaged.
- Do not store the device in hot areas. High temperatures can shorten the life of electronic devices, damage batteries, and warp or melt certain plastics.
- Do not store the device in cold areas. When the device returns to its normal temperature, moisture can form inside the device and damage electronic circuit boards.
- Do not attempt to open the device other than as instructed in this guide.
- Do not drop, knock, or shake the device. Rough handling can break internal circuit boards and fine mechanics.
- Do not use harsh chemicals, cleaning solvents, or strong detergents to clean the device.
- Do not paint the device. Paint can clog the moving parts and prevent proper operation.
- Use a soft, clean, dry cloth to clean any lenses (such as camera, proximity sensor, and light sensor lenses).
- Use only the supplied or an approved replacement antenna. Unauthorised antennas, modifications, or attachments could damage the device and may violate regulations governing radio devices.
- Use chargers indoors.
- Always create a backup of data you want to keep (such as contacts and calendar notes) before sending your device to a service facility.

All of the above suggestions apply equally to your device, battery, charger, or any enhancement. If any device is not working properly, take it to the nearest authorized service facility for service.

Additional safety information

10. Additional safety information

■ Childrens Safety

Your device and its enhancements may contain small parts. Keep them out of the reach of small children.

■ Traffic Safety

Do not use a hand-held telephone while driving a vehicle. Always secure the phone in its holder; do not place the phone on the passenger seat or where it can break loose in a collision or sudden stop.

Remember road safety always comes first!

■ Operating environment

Remember to follow any special regulations in force in any area and always switch off your device when its use is prohibited or when it may cause interference or danger. Use the device only in its normal operating positions. This device meets RF exposure guidelines when used either in the normal use position against the ear or when positioned at least 2.2 cm away from the body. When a carry case, belt clip or holder is used for body-worn operation, it should not contain metal and should position the device the above-stated distance from your body.

Parts of the device are magnetic. Metallic materials may be attracted to the device, and persons with a hearing aid should not hold the device to the ear with the hearing aid. Always secure the device in its holder, because metallic materials may be attracted by the earpiece. Do not

place credit cards or other magnetic storage media near the device, because information stored on them may be erased.

In order to transmit data files or messages, this device requires a good quality connection to the network. In some cases, transmission of data files or messages may be delayed until such a connection is available. Ensure the above separation distance instructions are followed until the transmission is completed.

■ Medical devices

Operation of any radio transmitting equipment, including wireless phones, may interfere with the functionality of inadequately protected medical devices. Consult a physician or the manufacturer of the medical device to determine if they are adequately shielded from external RF energy or if you have any questions. Switch off your device in health care facilities when any regulations posted in these areas instruct you to do so. Hospitals or health care facilities may be using equipment that could be sensitive to external RF energy.

Pacemakers

Pacemaker manufacturers recommend that a minimum separation of 6 in. (15.3 cm) be maintained between a wireless phone and a pacemaker to avoid potential interference with the pacemaker. These recommendations are consistent with the independent research by and recommendations of Wireless

English

Additional safety information

Technology Research. Persons with pacemakers should:

- always keep the device more than 6 in. (15.3 cm) from their pacemaker when the device is switched on;
- not carry the device in a breast pocket; and
- hold the device to the ear opposite the pacemaker to minimise the potential for interference.

If you have any reason to suspect that interference is taking place, switch off your device immediately.

Hearing aids

Some digital wireless devices may interfere with some hearing aids. If interference occurs, consult your service provider.

Potentially explosive environments

Switch off your device when in any area with a potentially explosive atmosphere and obey all signs and instructions. Potentially explosive atmospheres include areas where you would normally be advised to turn off your vehicle engine. Sparks in such areas could cause an explosion or fire resulting in bodily injury or even death. Switch off the device at refuelling points such as near gas pumps at service stations. Observe restrictions on the use of radio equipment in fuel depots, storage, and distribution areas, chemical plants or where blasting operations are in progress. Areas with a potentially explosive atmosphere are often but not always clearly marked. They include below deck on boats, chemical transfer or

storage facilities, vehicles using liquefied petroleum gas (such as propane or butane), and areas where the air contains chemicals or particles such as grain, dust or metal powders.

Vehicles

RF signals may affect improperly installed or inadequately shielded electronic systems in motor vehicles such as electronic fuel injection systems, electronic antiskid (antilock) braking systems, electronic speed control systems, air bag systems. For more information, check with the manufacturer or its representative of your vehicle or any equipment that has been added.

Only qualified personnel should service the device, or install the device in a vehicle. Faulty installation or service may be dangerous and may invalidate any warranty that may apply to the device. Check regularly that all wireless device equipment in your vehicle is mounted and operating properly. Do not store or carry flammable liquids, gases, or explosive materials in the same compartment as the device, its parts, or enhancements. For vehicles equipped with an air bag, remember that air bags inflate with great force. Do not place objects, including installed or portable wireless equipment in the area over the air bag or in the air bag deployment area. If in-vehicle wireless equipment is improperly installed and the air bag inflates, serious injury could result.

Airplanes

Using your device while flying may be prohibited. Switch off your device before

Additional safety information

boarding an aircraft. The use of wireless teledevices in an aircraft may be dangerous to the operation of the aircraft, disrupt the wireless telephone network, and may be illegal.

■ Emergency calls



Important:



Wireless phones, including this device, operate using radio signals, wireless networks, landline networks, and user-programmed functions. Because of this, connections in all conditions cannot be guaranteed. You should never rely solely on any wireless device for essential communications like medical emergencies.

your service provider for more information.

When making an emergency call, give all the necessary information as accurately as possible. Your wireless device may be the only means of communication at the scene of an accident. Do not end the call until given permission to do so.

English

To make an emergency call:

1. If the device is not on, switch it on. Check for adequate signal strength. Some networks may require that a valid SIM card is properly inserted in the device.
2. Press  as many times as needed to clear the display and ready the device for calls.
3. Key in the official emergency number for your present location. Emergency numbers vary by location.
4. Press the  key.

If certain features are in use, you may first need to turn those features off before you can make an emergency call. If the device is in offline or flight mode you must change the profile to activate the phone function before you can make an emergency call. Consult this guide or

Additional safety information

■ Certification information (SAR)

THIS MODEL PHONE MEETS INTERNATIONAL GUIDELINES FOR EXPOSURE TO RADIO WAVES.

Your mobile phone is a radio transmitter and receiver. It is designed and manufactured not to exceed the limits for exposure to radio frequency (RF) recommended by international guidelines (ICNIRP). These limits are part of comprehensive guidelines and establish permitted levels of RF energy for the general population. The guidelines were developed by independent scientific organisations through periodic and thorough evaluation of scientific studies. The guidelines include a substantial safety margin designed to assure the safety of all persons, regardless of age and health.

The exposure standard for mobile phones employs a unit of measurement known as the Specific Absorption Rate, or SAR. The SAR limit stated in the international guidelines is 2.0 W/kg*. Tests for SAR are conducted using standard operating positions with the phone transmitting at its highest certified power level in all tested frequency bands. Although the SAR is determined at the highest certified power level, the actual SAR of the phone while operating can be well below the maximum value. This is because the phone is designed to operate at multiple power levels so as to use only the power required to reach the network. In general, the closer you are to a base station, the lower the power output of the phone.

The highest SAR value for this model phone when tested for use at the ear is 0.78 W/kg. While there may be differences between the SAR levels of various phones and at various positions, they all meet the relevant international guidelines for RF exposure.

This product meets RF exposure guidelines when used either in the normal use position against the ear or when positioned at least 2.2cm away from the body. When a carry case, belt clip or holder is used for body-worn operation, it should not contain metal and should position the product at least 2.2cm away from your body.

* The SAR limit for mobile phones used by the public is 2.0 watts/kilogram (W/kg) averaged over ten grams of body tissue. The guidelines incorporate a substantial margin of safety to give additional protection for the public and to account for any variations in measurements. SAR values may vary depending on national reporting requirements and the network band. For SAR information in other regions please look under product information at www.nokia-asia.com.

Limited Warranty

Nokia Corporation, represented by its Mobile Phones Division ("Nokia") warrants that this Nokia cellular product and/or genuine Nokia accessory ("Product") is free from defects in material and workmanship, according to the following terms and conditions:

1. The limited warranty for the cellular phone, data product and all genuine Nokia accessories (except battery packs) extends for the first twelve (12) months beginning on the date of purchase of the Product.
2. The limited warranty for genuine Nokia battery packs extends for the first six (6) months beginning on the date of purchase of the Product.
3. The limited warranty extends only to the original consumer purchaser ("Consumer") of the Product and is not assignable or transferable to any subsequent purchaser/end user.
4. The limited warranty extends only to Consumers who purchase the Product in one of the countries (or areas) set forth at the end of this document. The limited warranty is only valid in Nokia's intended country (or area) of sale of the Product.
5. During the limited warranty period, Nokia or its authorized service network will repair or replace, at Nokia's option, any defective Product or parts thereof with new or factory rebuilt replacement items, and return the Product to the Consumer in working condition. No charge will be made to the Consumer for either parts or labor in repairing or replacing the Product. All replaced parts, boards or equipment shall become property of Nokia. The external housing and cosmetic parts shall be free of defects at the time of shipment and, therefore, shall not be covered under these limited warranty terms.
6. Repaired Product will be warranted for the balance of the original warranty period or for ninety (90) days from the date of repair, whichever is longer.
7. Upon request from Nokia or its authorized service center, the Consumer must provide purchase receipt or other information to prove the date and place of purchase.
8. Transportation, delivery and handling charges incurred in the transport of the Product to and from Nokia or its authorized service center will be borne by the Consumer.
9. The Consumer shall have no coverage or benefits under this limited warranty if any of the following conditions are applicable:
 - a) The Product has been subject to: abnormal use, abnormal condition, improper storage, exposure to moisture or dampness, exposure to excessive temperature or other such environmental conditions, unauthorized modifications, unauthorized connections, unauthorized repair including but not limited to use of unauthorized spare parts in repairs, misuse, neglect, abuse, accident, alteration, improper installation, Acts of God, spill of foods or liquids, maladjustment of customer controls or other acts which are beyond of reasonable control of Nokia, including deficiencies in consumable parts such as fuses and breakage or damage to antennas, unless caused directly by defects in materials or workmanship, and normal wear and tear of the Product.
 - b) Nokia was not notified by Consumer of the alleged defect or malfunction of the Product during the applicable limited warranty period.
 - c) The Product serial number or the accessory date code has been removed, defaced or altered.
 - d) The defect or damage was caused by defective function of the cellular system or by inadequate signal reception by the external antenna.
 - e) The Product was used with or connected to accessory not supplied by Nokia, not fit for use with Nokia cellular phones or used in other than its intended use.
 - f) The battery was short circuited or seals of the battery enclosure or cells are broken or show evidence of tampering or the battery was used in equipment other than that for which it has been specified.
10. If a problem develops during the limited warranty period, the Consumer should take the following step-by-step procedure:
 - a) The Consumer shall return the Product to the place of purchase for repair or replacement processing.
 - b) If "a" is not convenient, the Consumer may contact the local Nokia office for the location of the nearest authorized service center.
 - c) The Consumer shall arrange for the Product to be delivered to the authorized service center. Expenses related to removing the Product from an installation are not covered under this limited warranty.
 - d) The Consumer will be billed for any parts or labor charges not covered by this limited warranty. The Consumer shall be responsible for expenses related to reinstallation of the Product.
 - e) In case of certain operator specific features in the Product such as SIM-lock, Nokia reserves the right to refer the Consumer to the relevant cellular operator before service will be provided.
 - f) If the Product is returned to Nokia after the expiration of the warranty period, Nokia's normal service policies shall apply and the Consumer will be charged accordingly.
11. ANY IMPLIED WARRANTY OF MERCHANTABILITY, OR FITNESS FOR A PARTICULAR PURPOSE OR USE, SHALL BE LIMITED TO THE DURATION OF THE FOREGOING WRITTEN WARRANTY. OTHERWISE, THE FOREGOING WARRANTY IS THE PURCHASER'S SOLE AND EXCLUSIVE REMEDY AND IS IN LIEU OF ALL OTHER WARRANTIES, EXPRESS OR IMPLIED. NOKIA SHALL NOT BE LIABLE FOR INCIDENTAL OR CONSEQUENTIAL DAMAGES OR A LOSS OF ANTICIPATED BENEFITS OR PROFITS, LOSS OR IMPAIRMENT OF PRIVACY OF CONVERSATIONS, WORK STOPPAGE OR LOSS OR IMPAIRMENT OF DATA ARISING OUT OF THE USE OR INABILITY TO USE THE PRODUCT.
12. The benefits conferred by this limited warranty are in addition to all other rights and remedies under any applicable mandatory legislation as may be in force from country (area) to country (area).
13. Nokia neither assumes nor authorizes any authorized service center or any person or entity to assume for it any other obligation or liability beyond that which is expressly provided for in this limited warranty.
14. All warranty information, product features and specifications are subject to change without notice.
15. The countries (or areas) in which this limited warranty is in force, subject to clause 4 above, are Hong Kong SAR and Macau SAR.

Index

SYMBOLS

(E)GPRS 42
 (E)GPRS connection 42
 (E)GPRS modem settings 42
 (E)GPRS, HSCSD and CSD 64

A

Accepting or rejecting an invitation 24
 Access codes vii
 Accessing a menu function 13
 Accessing the wallet menu 53
 Adding and managing voice tags 37
 Adding contacts to the subscribed names 35
 Additional safety information 69
 Alarm clock 47
 Answering or rejecting an incoming call 9
 Appearance settings of the browser 58
 Applications 50

B

Basic steps for accessing and using services 56
 Battery 66
 Battery information 65
 type 66
 Blocking and unblocking messages 25
 Bookmarks 58
 Boom Headset (HDB-4) 67
 Browser security 60
 browser security
 security module for WAP applications 60
 Browsing the pages of a service 57

C

Calculator 51
 Calendar 48
 Call functions 9
 Call register 30
 Call settings 40
 Camera 46
 Camera settings 47
 Care and maintenance 68
 Certificates 61
 Certification information (SAR) 72

74

Changing the covers 3
 Changing the cut-out cover 5
 Changing the grips 4
 Charging and Discharging 65
 Charging the battery 2
 Common settings 30
 Configuration settings 43
 Connecting to and disconnect from the instant messaging service 23
 Connectivity 42
 Contacts 31
 Contacts for instant messaging 25
 Cookies 58
 Countdown timer 52
 Counters and timers for calls, data and messages 31
 Creating a wallet profile 54
 Creating cut-out covers 4

D

Deleting e-mails 27
 Digital signature 62
 digital signature 62
 Direct calling 57
 Disconnect from a service 57
 Display settings 40
 Downloading 59
 Downloading e-mails from your e-mail account 27

E

Editing or deleting details 33
 Editing your own settings 24
 E-mail application 26
 Emergency calls 71
 Enhancement settings 43
 Essential indicators 7

F

For your safety iv

G

Gallery 45
 Genuine Enhancements 66
 Groups 25

Guidelines for paying for your purchases with the wallet 55

I

Inbox, Outbox, Saved and Sent items folders 21
Info messages 28
Installing the SIM card and the battery 1
Instant messages (Chat) 21
Instant messaging settings 26

K

Keypad lock (Keyguard) 8
Keys and connectors 6

L

Light settings 39
Limited Warranty 73
List of menu functions 14

M

Making a call 9
Making a call by using a voice tag 38
Making a connection to a service 56
Media 46
Medical devices 69
menu
list of functions 14
Menu functions 16
Message counter 30
Message settings 28
Messages 16
Multimedia messages (MMS) 18
Multimedia messages memory full 21
My presence 33

N

Network services viii
Normal operating position 3
Notes 49

O

Operating environment 69
Operator menu 45
Options during a call 10
Organiser 47
Overview of the functions of the phone vi

P

Participating in a conversation 24
PC Connectivity 63
PC Suite 63
Personal notes 54
Personal shortcuts 39
Phone settings 41
Potentially explosive environments 70
Profiles 38

R

Reading an instant message 24
Reading and replying to a multimedia message 20
Reading and replying to an e-mail 27
Reading and replying to an SMS message or an SMS e-mail 17
Recording 47
Restore factory settings 45

S

SAR value 72
Saved items folder and My folders 18
Saving card details 54
Saving multiple numbers or text items or an image per name 32
Saving names and phone numbers (Add contact) 32
Searching for a contact 32
Security settings 44
security settings
digital signature 62
Selecting settings for contacts 31
Sending and receiving a business card 36
Service commands 28
Service inbox 59
Service inbox settings 59
Services 55
Setting predictive text input on or off 10
Setting up the phone for a service 56
Settings 38
Settings for e-mail application 29
Settings for multimedia messages 28
Settings for text and SMS e-mail messages 28
Settings for the synchronisation from your phone 50
SIM services 62
Speed dialling a phone number 9
Speed dials 37

English

Standby mode 6
Starting an instant messaging
conversation 23
Stopwatch 52
Subscribed names 35
Switching the phone on and off 3
Synchronisation 49
Synchronising from your
compatible PC 50
Synchronising from your phone 49

T

Taking a photo or a video clip 46
Templates 18
Text messages (SMS) 16
The cache memory 60
Themes 38
Time and date settings 40
Tips for writing text 11
To make an emergency call 71
To-do list 49
Tone settings 39
Traffic Safety 69

U

Unsubscribing a contact 36
Using data communication
applications 64
Using predictive text input 10
Using the menu 13
Using traditional text input 11

V

Vehicles 70
Viewing the subscribed names 36
Voice commands 39
Voice dialling 37
Voice messages 27
Voice recorder 47

W

Wallet 53
wallet
 signing documents via WAP 62
Wallet settings 54
WAP services
 security module in SIM 60
 signing documents 62
Writing and sending a multimedia
message 19