

# User's Guide for Nokia 8910i

---

# List of menu functions

## 1. Messages



1. Text messages
  1. Create message
  2. Inbox
  3. Create e-mail
  4. Sent items
  5. Archive
  6. Templates
  7. My folders
  8. Delete messages
2. Multimedia msg.
  1. Create message
  2. Inbox
  3. Outbox
  4. Sent items
  5. Saved items
  6. Delete messages
3. Chat
4. Voice messages
  1. Listen to voice messages
  2. Voice mailbox number
5. Info messages
6. Message settings
  1. Text messages
  2. Multimedia msg.
  3. Other settings
7. Service command editor

## 2. Call register



1. Missed calls
2. Received calls
3. Dialed numbers

## 4. Delete recent call lists

1. All
2. Missed
3. Received
4. Dialed

## 5. Call duration

1. Last call duration
2. Received calls' duration
3. Dialed calls' duration
4. All calls' duration
5. Clear timers

## 6. Call costs

1. Last call units
2. All calls' units
3. Call cost settings

## 7. GPRS data counter

1. Data sent in last session
2. Data received in last session
3. All sent data
4. All received data
5. Clear counters

## 8. GPRS connection timer

1. Duration of last session
2. Duration of all sessions
3. Clear timers

## 9. Message counter

## 3. Profiles



1. General
  1. Activate
  2. Personalise
  3. Timed
2. Silent
3. Discreet
4. Loud
5. My style 1
6. My style 2

## 4. Settings



1. Time and date settings
  1. Clock
  2. Date
  3. Auto-update of date & time
2. Call settings
  1. Call divert
  2. Anykey answer
  3. Automatic redial
  4. Speed dialling
  5. Call waiting
  6. Summary after call
  7. Send my caller identity
  8. Line for outgoing calls
3. Phone settings
  1. Language
  2. Cell info display
  3. Welcome note
  4. Network selection
  5. Confirm SIM service actions
  6. Help text activation
  7. Start-up tone
4. Display settings
  1. Wallpaper
  2. Colour schemes
  3. Operator logo
  4. Screen saver timeout
5. Tones settings
  1. Incoming call alert
  2. Ringing tone
  3. Ringing volume
  4. Vibrating alert
  5. Message alert tone
  6. Keypad tones
  7. Warning tones
  8. Alert for

## 6. Accessory settings<sup>1</sup>

1. Headset
2. Handsfree
3. Loopset

## 7. Security settings

1. PIN code request
2. Call barring service
3. Fixed dialling
4. Closed user group
5. Security level
6. Access codes

## 8. Restore factory settings

## 5. Gallery



1. View folders
2. Add folder
3. Delete folder
4. Rename folder
5. Gallery servs.

## 6. Organiser



1. Alarm clock
2. Calendar
3. To-do list

## 7. Applications



1. Select app.
2. App. services
3. Memory

## 8. Games



1. Select game
2. Game services
3. Memory
4. Settings
  1. Game sounds
  2. Game lights
  3. Shakes

---

1. Shown only when an accessory has been used.

## 9. Extras



1. Calculator
2. Countdown timer
3. Stopwatch

## 10.Connectivity



1. Bluetooth
2. Infrared
3. GPRS
  1. GPRS connection
  2. GPRS modem settings

## 11.Services



1. Home
2. Bookmarks
  1. Send
3. Service inbox
4. Settings
  1. Active service settings
  2. Edit active service settings
  3. Appearance settings
  4. Cookie settings
  5. Certificates
  6. Security module settings
  7. Service inbox settings
5. Go to address
6. Clear the cache

## 12. SIM services<sup>1</sup>



---

1. Only shown if supported by your SIM card. The name and contents vary depending on the SIM card.

## DECLARATION OF CONFORMITY

We, NOKIA CORPORATION, declare under our sole responsibility that the product NHM-4NX is in conformity with the provisions of the following Council Directive: 1999/5/EC.

A copy of the Declaration of Conformity can be found from [http://www.nokia.com/phones/declaration\\_of\\_conformity/](http://www.nokia.com/phones/declaration_of_conformity/).

Copyright © 2003 Nokia. All rights reserved.

Reproduction, transfer, distribution or storage of part or all of the contents in this document in any form without the prior written permission of Nokia is prohibited.

Nokia and Nokia Connecting People are registered trademarks of Nokia Corporation. Other product and company names mentioned herein may be trademarks or tradenames of their respective owners.

Nokia tune is a soundmark of Nokia Corporation.

US Patent No 5818437 and other pending patents. T9 text input software  
Copyright © 1997-2002. Tegic Communications, Inc. All rights reserved.



Includes RSA BSAFE cryptographic or security protocol software from RSA Security.



Java is a trademark of Sun Microsystems, Inc.

Nokia operates a policy of continuous development. Nokia reserves the right to make changes and improvements to any of the products described in this document without prior notice.

Under no circumstances shall Nokia be responsible for any loss of data or income or any special, incidental, consequential or indirect damages howsoever caused.

The contents of this document are provided "as is". Except as required by applicable law, no warranties of any kind, either express or implied, including, but not limited to, the implied warranties of merchantability and fitness for a particular purpose, are made in relation to the accuracy, reliability or contents of this document. Nokia reserves the right to revise this document or withdraw it at any time without prior notice.

The availability of particular accessories may vary by region. Please check with the Nokia dealer nearest to you.

# Table of contents

FOR YOUR SAFETY .....	xi
-----------------------	----

Network Services .....	xii
------------------------	-----

General information .....	xiii
---------------------------	------

Stickers in the sales package .....	xiii
-------------------------------------	------

Access codes .....	xiii
--------------------	------

1. Getting started .....	1
--------------------------	---

Keys and connectors .....	1
---------------------------	---

Standby mode and essential indicators .....	2
---	---

Installing the SIM card and the battery .....	3
---	---

Charging the battery .....	4
----------------------------	---

Switching the phone on and off ..	4
-----------------------------------	---

Keypad lock (Keyguard) .....	5
------------------------------	---

Shared memory .....	6
---------------------	---

Using the menu .....	6
----------------------	---

Accessing a menu function .....	6
---------------------------------	---

2. Call functions and phone book .....	7
--	---

Basic call functions .....	7
----------------------------	---

Making a call .....	7
---------------------	---

Voice mailbox .....	8
---------------------	---

Call register .....	8
---------------------	---

Missed calls and received calls .....	8
---------------------------------------	---

Dialled numbers .....	9
-----------------------	---

Erase recent calls lists .....	9
--------------------------------	---

Call counters and call timers .....	9
-------------------------------------	---

Making a conference call .....	10
--------------------------------	----

Options during a call .....	10
-----------------------------	----

Call settings .....	11
---------------------	----

Voice dialling .....	11
----------------------	----

Adding a voice tag .....	12
--------------------------	----

Making a call using a voice tag .....	12
---------------------------------------	----

Replaying, changing or erasing a voice tag .....	13
--	----

Phone book .....	13
------------------	----

Saving names and phone numbers	
--------------------------------	--

(Add name) .....	13
------------------	----

Searching for a name in the phone book .....	14
--	----

Editing a name, number or text item .....	15
---	----

Erasing names and numbers .....	15
---------------------------------	----

Copying phone books .....	15
---------------------------	----

Sending and receiving a business card .....	15
---	----

Selecting the phone book settings .....	16
---	----

Service numbers .....	16
-----------------------	----

3. Profiles and tones .....	17
-----------------------------	----

Profiles .....	17
----------------	----

Tones .....	18
-------------	----

4. Text and multimedia messages .....	19
---------------------------------------	----

Writing and sending text messages .....	19
---	----

Options for sending text messages .....	20
---	----

Writing text .....	20
--------------------	----

Setting predictive text input on or off .....	20
---	----

Using predictive text input .....	21
-----------------------------------	----

Using traditional text input .....	21
------------------------------------	----

Tips for writing text .....	22
-----------------------------	----

Writing and sending e-mails .....	22
-----------------------------------	----

Templates .....	23
-----------------	----

Inserting a text template into a message or an e-mail .....	23
---	----

Inserting a picture into a text message .....	23
---	----

Reading and replying to a message or an e-mail .....	24
--	----

Inbox and outbox folders .....	25	Tone settings.....	36
My folders and Archive folder.....	25	Accessory settings.....	36
Erasing text messages.....	25	Security settings.....	37
Chat .....	25	Restore factory settings .....	38
Text message settings .....	26	<b>6. WAP services.....</b>	<b>39</b>
Message counter.....	27	Setting up the phone for a WAP	
Info messages .....	27	service.....	39
Service command editor.....	27	Saving the service settings received	
Multimedia messages.....	27	as a text message .....	39
Writing and sending multimedia		Keying in the service settings	
messages .....	28	manually.....	40
Reading and replying to		GPRS connection.....	42
a multimedia message.....	29	GPRS modem settings .....	42
Inbox, Outbox, Saved, and Sent		Making a connection to a WAP	
items folders.....	30	service.....	43
Settings for multimedia		Browsing the pages of a WAP	
messages.....	30	service.....	43
Gallery.....	31	General guidelines for using	
<b>5. Settings.....</b>	<b>33</b>	the phone keys.....	44
Time and date settings.....	33	WAP direct calling.....	45
Clock settings.....	33	Ending a WAP connection .....	45
Date settings.....	33	Appearance settings of the WAP	
Automatic update of date and		browser.....	45
time.....	33	Download settings .....	46
Phone settings.....	33	Bookmarks.....	46
Language.....	33	Receiving a bookmark.....	46
Cell info display.....	33	Service inbox .....	47
Welcome note.....	34	To set the phone to receive service	
Network selection.....	34	messages .....	47
Confirm SIM service actions.....	34	The cache memory .....	47
Help text activation .....	34	Security indicator .....	48
Start-up tone .....	34	Authority certificates .....	48
Display settings .....	34	<b>7. Key features .....</b>	<b>49</b>
Wallpaper.....	34	Bluetooth .....	49
Colour schemes .....	35	Using Bluetooth.....	49
Operator logo .....	35	Bluetooth settings .....	50
Screen saver .....	35		

Infrared .....	51
PC connectivity .....	51
PC Suite .....	52
Using data communication applications .....	53
Calendar .....	53
Making a calendar note .....	54
When the phone alarm activates for a note .....	54
Calculator.....	54
Making a currency conversion .....	55
To-do list .....	55

## 8. Other functions ..... 56

Countdown timer.....	56
Stopwatch.....	56
Timing and time splitting .....	56
Lap times.....	57
Viewing and erasing times.....	57
Alarm clock.....	57
Games .....	58
Starting a game .....	58
Game services and game settings...	58
Applications.....	58
Launching an application.....	58
Downloading an application.....	59
Memory status for applications.....	60
SIM services .....	60

## 9. Battery information ..... 61

Charging and Discharging.....	61
-------------------------------	----

## 10. Genuine Accessories..... 62

Battery .....	62
Indoor.....	62
Travel Charger (ACP-12) .....	62
Desktop Stand (DCV-4) .....	63
HDC-5 Personal Headset Kit.....	63
Vehicle .....	63
LCH-9 Mobile Charger.....	63

## 11. Care and Maintenance ..... 64

## 12. Important Safety Information..... 65

## Index..... 69



# FOR YOUR SAFETY

Read these simple guidelines. Breaking the rules may be dangerous or illegal. Further detailed information is given in this manual.



Do not switch the phone on when wireless phone use is prohibited or when it may cause interference or danger.



## ROAD SAFETY COMES FIRST

Don't use a hand-held phone while driving.



## INTERFERENCE

All wireless phones may get interference, which could affect performance.



## SWITCH OFF IN HOSPITALS

Follow any regulations or rules. Switch the phone off near medical equipment.



## SWITCH OFF IN AIRCRAFT

Wireless devices can cause interference in aircraft.



## SWITCH OFF WHEN REFUELLING

Don't use the phone at a refuelling point. Don't use near fuel or chemicals.



## SWITCH OFF NEAR BLASTING

Don't use the phone where blasting is in progress. Observe restrictions, and follow any regulations or rules.



## USE SENSIBLY

Use only in the normal position. Don't touch the antenna unnecessarily.



## QUALIFIED SERVICE

Only qualified personnel may install or repair phone equipment.



## ACCESSORIES AND BATTERIES

Use only approved accessories and batteries. Do not connect incompatible products.



## BACKUP COPIES

Remember to make backup copies of all important data.



## WATER-RESISTANCE

Your phone is not water-resistant. Keep it dry.





## CONNECTING TO OTHER DEVICES

When connecting to any other device, read its user's guide for detailed safety instructions. Do not connect incompatible products.





## CALLING

Ensure the phone is switched on and in service. Enter the phone number, including the area code, then press . To end a call, press . To answer a call, press .



## EMERGENCY CALLS

Ensure the phone is switched on and in service. Press  as many times as needed (e.g. to exit a call, to exit a menu, etc.) to clear the display. Enter the emergency number, then press . Give your location. Do not end the call until told to do so.

# Network Services

The wireless phone described in this guide is approved for use on the EGSM 900 and GSM 1800 networks.

Dualband is a network dependent feature. Check with your local service provider if you can subscribe to and use this feature.

A number of features included in this guide are called Network Services. These are special services that you arrange through your wireless service provider. Before you can take advantage of any of these Network Services, you must subscribe to them through your service provider and obtain instructions for their use from your service provider.



**Note:** Some networks may not support all language-dependent characters and/or services.

Check the model number of any charger before use with this device. This device is intended for use when supplied with power from ACP-7, ACP-8, LCH-9 and ACP-12.



**Warning:** Use only batteries, chargers and accessories approved by the phone manufacturer for use with this particular phone model. The use of any other types may invalidate any approval or warranty applying to the phone, and may be dangerous.

For availability of approved accessories, please check with your dealer.

When you disconnect the power cord of any accessory, grasp and pull the plug, not the cord.

# General information

## ■ Stickers in the sales package

The stickers contain important information for service and customer support purposes.

Attach the  sticker to Your Details Page of this user's guide.

## ■ Access codes

- **Security code (5 digits):** The security code protects your phone against unauthorised use, and is supplied with the phone. The preset code is 12345. Change the code in the *Settings* menu, see "[Security settings](#)" on page 37. Keep the new code secret and in a safe place separate from your phone.

To set the phone to request the code, see "[Security settings](#)" on page 37.

- **PIN code (4 to 8 digits):** The Personal Identification Number (PIN) code protects your SIM card against unauthorised use. The PIN code is usually supplied with the SIM card.

To set the phone to request the PIN code each time the phone is switched on, see "[Security settings](#)" on page 37.

- **PIN2 code (4 to 8 digits):** The PIN2 code may be supplied with the SIM card and is required to access some functions, such as charging unit counters.
- **PUK and PUK2 codes (8 digits):** The Personal Unblocking Key (PUK) code is required to change a blocked PIN code. The PUK2 code is required to change a blocked PIN2 code.

If the codes are not supplied with the SIM card, contact your local service provider for the codes.

- **Barring password:** The barring password is needed when using the *Call barring service*, see "[Security settings](#)" on page 37. The password is supplied by your service provider.



# 1. Getting started

## ■ Keys and connectors

### 1. Power key,

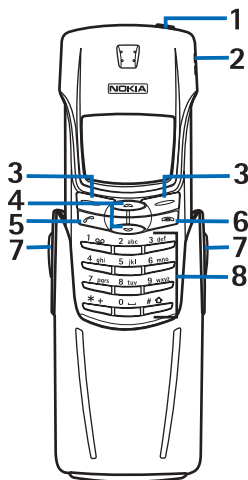

Switches the phone on and off.

While in the phone book or in menu functions, or when the keypad is locked, briefly pressing the power key turns the phone's display lights on for approximately 15 seconds.

### 2. Infrared port

### 3. Selection keys, and

The function of the keys depends on the guiding text shown on the display above the keys, for example **Menu** and **Names** in standby mode.

### 4. Scroll keys, and

Enable scrolling through names, phone numbers, menus or settings. Also adjust the earpiece volume during a call.

### 5. dials phone numbers, and answers calls. In standby mode, it shows the most recently called number.

### 6. ends an active call. Exits from any function.

### 7. Grip release buttons

### 8. **0** - **9 wxyz** enter numbers and characters. Pressing and holding **100** calls your voice mailbox.

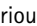
**\*+** and **#**  are used for various purposes in different functions, for example, when locking the keypad.

## ■ Standby mode and essential indicators

When the phone is ready for use and no characters have been entered by the user, the phone is in standby mode.



The selection keys in standby mode are **Menu** and **Names**.

**xxxxxx** Indicates the cellular network in which the phone is currently being used.



Shows the signal strength of the cellular network at your current location. The higher the bar, the stronger the signal.



Shows the battery charge level. The higher the bar, the more power in the battery.



You have received one or several text or picture messages. See ["Text and multimedia messages"](#) on page 19.

You have received one or several multimedia messages. See ["Reading and replying to a multimedia message"](#) on page 29.



You have received one or several voice messages. See ["Voice mailbox"](#) on page 8.



The phone's keypad is locked. See ["Keypad lock \(Keyguard\)"](#) on page 5.



The phone does not ring for an incoming call or text message when *Incoming call alert* is set to *Off* and *Message alert tone* is set to *Off*. See ["Profiles"](#) on page 17.



The alarm clock is set to *On*. See ["Alarm clock"](#) on page 57.



The countdown timer is running. See ["Countdown timer"](#) on page 56.



The stopwatch is running in the background. See ["Stopwatch"](#) on page 56.



All your calls are diverted to another number, *Divert all voice calls*. If you have two phone lines, the divert indicator for the first line is **1+** and for the second line is **2+**. See ["Call settings"](#) on page 11.



Calls are limited to a closed user group (network service). See ["Security settings"](#) on page 37.

## ■ Installing the SIM card and the battery

- Keep all miniature SIM cards out of the reach of small children.
  - The SIM card and its contacts can easily be damaged by scratches or bending, so be careful when handling, inserting or removing the card.
  - Before installing the SIM card, always make sure that the phone is switched off and then remove the battery.
1. Press the release buttons on both sides of the phone to open the grip.

Note that you should always close the phone gently.

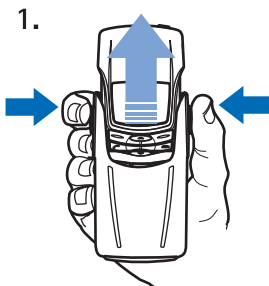

2. With the back of the phone facing you, press the release button with a suitable instrument. Make sure the instrument is not so sharp that it will damage the phone. Slide the

back cover off the phone in the direction of the arrow.

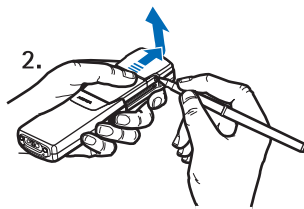

3. Lift the battery out of the phone.

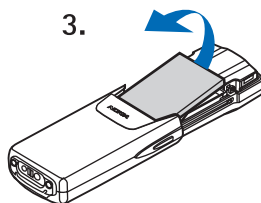

4. Release the SIM card holder by first sliding it to the right and then lifting it. Insert the SIM card into the phone. Make sure that the SIM card is inserted properly and that the golden contact area on the card is facing downwards.

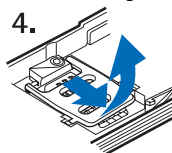

- Lock the SIM card in its place by first putting the card holder cover down over the SIM card and then sliding it to the left.

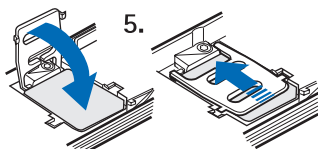

- Replace the battery, and close the back cover by sliding it back over the phone until it locks into place.

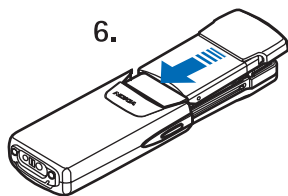

## ■ Charging the battery

- Connect the lead of the charger to the socket on the bottom of your phone.

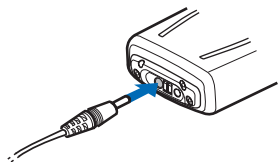

- Connect the charger to an AC wall socket.

The text **Charging** is displayed briefly if the phone is switched on. If the battery is completely flat, it may take a few minutes before the charging indicator appears on the display or any calls can be made.

You can use the phone while the charger is connected.

The charging time depends on the charger and the battery used. For example, charging a BLB-2 battery with the ACP-12 charger takes about 1 hours and 30 minutes.

## ■ Switching the phone on and off

Press and hold the power key, .

Note that if the phone displays **Insert SIM card** even though the SIM card is properly inserted, you should contact your network operator or service provider. Your phone does not support 5 Volt SIM cards and the card may need to be changed.



- If the phone asks for a PIN code, key it in (displayed as \*\*\*\*) and press **OK**.

See also **PIN code request** in "Security settings" on page 37 and "Access codes" on page xiii.



- If the phone asks for a security code, key it in (displayed as \*\*\*\*\*) and press **OK**.

See also "[Access codes](#)" on page [xiii](#).



**Warning:** Do not switch the phone on when wireless phone use is prohibited or when it may cause interference or danger.

#### TIPS ON EFFICIENT OPERATION:

Your phone has a built-in antenna. As with any other radio transmitting device, do not

touch the antenna unnecessarily when the phone is switched on.

Contact with the antenna affects call quality and may cause the phone to operate at a higher power level than otherwise needed. Not touching the antenna area during a phone call optimises the antenna performance and the talktime of your phone.

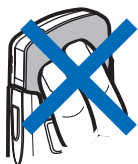

## ■ Keypad lock (Keyguard)

You can lock the keypad to prevent the keys being accidentally pressed, for example, when your phone is in your bag.

- **Locking the keypad**

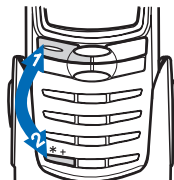

In standby mode, press **Menu** and then **\*+** within 1.5 seconds to lock the keypad.

When the keypad is locked,  appears at the top of the display.

- **Unlocking the keypad**

Press **Unlock** and then **\*+** within 1.5 seconds to unlock the keypad.

- **When the keyguard is on**

To answer a call, press .

During a call, the phone can be operated normally. When you end or reject a call, the keypad will automatically lock.



**Note:** When Keyguard is on, calls may be possible to the emergency number programmed into your phone (e.g. 112 or other official emergency number). Key in the emergency number and press . The number is displayed only after you have keyed in its last digit.

## ■ Shared memory

The following features in your phone may share memory: phone book, text and multimedia messages, images and ringing tones in gallery, calendar, to-do notes, and Java games and applications. Using any such features may reduce the memory available for any features sharing memory. This is especially true with heavy use of any of the features (although some of the features may have a certain amount of memory specially allotted to them in addition to the amount of memory shared with other features). For example, saving many images, bookmarks, java apps, etc. may take all of the shared memory and your phone may display a message that the memory is full. In this case, delete some of the information or entries stored in the shared memory features before continuing.

## ■ Using the menu

The phone offers you an extensive range of functions, which are grouped into menus. Most of the menu functions are provided with a brief help text. To activate the help texts, see "[Help text activation](#)" on page 34. To view the help text, scroll to the menu function you want and wait for 15 seconds. To exit the help text, press **Back**.

## Accessing a menu function

### By scrolling

1. To access the menu, press **Menu**.
2. Scroll through the menu and choose, for example, **Settings** by pressing **Select**.
3. If the menu contains submenus, select the one you want, for example **Call settings**.
4. If the selected submenu contains further submenus, repeat step 3. Select the next submenu, for example **Anykey answer**.
5. Select the setting of your choice.
6. Press **Back** to return to the previous menu level, and **Exit** to exit the menu.

### By shortcuts

The menus, submenus and setting options are numbered and you can access them using their shortcut numbers. The shortcut number is shown on the top right corner of the display.





- To access the menu, press **Menu** and within two seconds key in the index number of the menu function you want to access.

For example, to set the **Anykey answer On**, press **Menu**, **4ghi**, **2abc**, **2abc** and **1aa**.

## 2. Call functions and phone book

### ■ Basic call functions



#### Making a call

1. Key in the phone number, including the area code. To edit the number on the display, press  or  to move the cursor and press **Clear** to delete the character to the left of the cursor. For international calls, press **\*+** twice for the international prefix (the + character replaces the international access code) and then key in the country code, the area code and the phone number.
2. Press  to call the number.
3. Press  or **End call** to end the call (or to cancel the call attempt).



#### Making a call using the phone book



1. See "Searching for a name in the phone book" on page 14.
2. Press  to call the number on the display.

#### Redialling last number

In standby mode, press  once to access a list of the 20 numbers you most recently called or attempted to call. Scroll to the number or name you want, and press  to call the number.

#### Answering or rejecting an incoming call

Press  to answer an incoming call and press  to end a call.

Press  or close the grip to reject an incoming call. Note that after opening the grip you have about 1 second to press , or **Silence** to make the ringing silent without answering the call.

If you press **Silence**, only the ringing tone is muted. Then either answer or reject the call.



**Tip:** If the *Divert if busy* function has been activated to divert calls, for example to your voice mailbox, rejecting an incoming call will also divert the call. See "Call settings" on page 11.

#### Speed dialling

Press **Names** and select *Speed dials*. Scroll to the speed dialling key number you want.



- Press **Assign** and then **Search**. Select the name first and then the number you want to assign to that key.
- If a number has already been assigned to that key, press **Options**, and you can view, change or erase the assigned number.

You can call the assigned speed dialling number in either of the following ways:

- Press the speed dialling key you want and then press .
- If *Speed dialling* is activated, press and hold a speed dialling key until the call is started.

## Call waiting

You can answer an incoming call while you have a call in progress if you have activated the function *Call waiting*, see "*Call settings*" on page 11.

During a call, press  to answer the waiting call. The first call is put on hold. Press  to end the active call.

## Voice mailbox

Voice mailbox is a network service. For more information and for the voice mailbox number, contact your service provider.

If supported by the network,  will indicate new voice messages.

### Setting your voice mailbox number

1. Press **Menu**, select *Messages* and *Voice messages*.
2. Select *Voice mailbox number*.
3. Key in your voice mailbox number and press **OK** to save it.

## Calling your voice mailbox

1. In standby mode, press and hold **100**.
2. If the phone asks for the voice mailbox number, key it in and press **OK**.

## Call register



The phone registers the phone numbers of missed, received and dialled calls, as well as the approximate length and cost of your calls.

The phone only registers missed and received calls if the network supports these functions, and the phone is switched on and within the network's service area.

When you press **Options** in the *Missed calls*, *Received calls*, and *Dialled numbers* menus, you can view the date and the time of the call, edit or erase the phone number from the list, save the number in the phone book, or send a message to the number.

## Missed calls and received calls

To view a list of the ten phone numbers from which somebody has most recently tried to call you (network service), press **Menu**, select *Call register* and *Missed calls*.



**Tip:** When a note about missed calls is displayed, press **List** to access the list of phone numbers. Scroll to the number you would like to call and press .

To view a list of the ten phone numbers from which you have most recently accepted calls (network service), press **Menu**, select *Call register* and *Received calls*.

## Dialled numbers

To view a list of the 20 phone numbers that you have most recently called or attempted to call, press **Menu**, select *Call register* and *Dialled numbers*. See also "Redialling last number" on page 7.

## Erase recent calls lists

To erase the recent calls lists, press **Menu**, select *Call register* and select *Delete recent call lists*. Select whether you want to delete all the phone numbers in the recent calls lists, or only the numbers in the missed calls, received calls or dialled numbers lists. You cannot undo the operation.

## Call counters and call timers



**Note:** The actual invoice for calls and services from your service provider may vary, depending upon network features, rounding-off for billing, taxes and so forth.

Press **Menu** and select *Call register*. Select

- *Call duration* and scroll to view the approximate duration of your incoming and outgoing calls in hours, minutes and seconds. Your security code is needed to clear the timers. Each phone line has its own call timers and the timers of the selected line are displayed. See "Call settings" on page 11.
- *Call costs* (network service) and select *Last call units* or *All calls' units* to check the cost of your last call or all calls.

Select *Call cost settings* and then select *Clear counters* or *Show costs in* to set the phone to show the remaining talk time in terms of charging units, *Units*, or units of currency, *Currency*. Contact your service provider for charging unit prices. Select *Call cost limit* to limit the cost of your calls to a certain amount of charging units or units of currency. The PIN2 code is needed for the call cost settings.



**Note:** When no more charging units or currency units are left, calls may only be possible to the emergency number programmed into your phone (e.g. 112 or other official emergency number).

- **GPRS data counter** and scroll to check the amounts of data that were most recently sent and received, data sent and received in total, and to clear the counters. The counter unit is a byte.
- **GPRS connection timer** and scroll to check the duration of the last GPRS connection or the total duration of the GPRS connection. You can also clear the timers.

## ■ Making a conference call

Conference calling is a network service that allows up to six people to take part in a conference call.

1. Make a call to the first participant.
2. To make a call to a new participant, press **Options** and select **New call**.
3. Key in or search the phone book for the phone number of the new participant and press **Call**. The first call is put on hold.

4. When the new call has been answered, include the first participant in the conference call. Press **Options** and select **Conference**.
5. To add another new participant to the call, repeat steps 2 to 4.
6. To have a private conversation with one of the participants: Press **Options** and select **Private**. Scroll to the desired participant and press **OK**. Once you have finished the private conversation, re-establish the conference call as described in step 4 above.
7. To end the conference call, press .

## ■ Options during a call

Press **Options** during a call for some of the following network service options (if they are available from your service provider and operator for the current call):

*Mute or Unmute, End call, End all calls, Phone book, Menu and Hold or Unhold, New call, Conference, Private, Answer, and Reject.*



**Send DTMF** is used to send DTMF tone strings, for example, passwords or bank account numbers. Key in the DTMF string, or search for it in the phone book, and press **OK**. Note that you can key in the wait character (w) and the pause character (p) by repeatedly pressing **\* +**.

*Swap* is used to switch between the active call and the call on hold.

*Transfer* is used to connect a call on hold to an active call and to disconnect yourself from a call.

## ■ Call settings

Press **Menu**, select *Settings* and *Call settings*. Then select

- *Call divert* to direct your incoming calls to another number. Select the divert option you want and then *Activate*.
- *Anykey answer* to answer an incoming call by briefly pressing any key, except  and .
- *Automatic redial* and your phone will make a maximum of ten attempts to connect the call after an unsuccessful call attempt.
- *Speed dialling* and you can call the phone number assigned to the speed dialling keys, **2abc** to **9wxyz**, by pressing and holding the corresponding number key.
- *Call waiting* and the network will notify you of an incoming call while you have a call in progress (network service).
- *Summary after call* and the phone will briefly display the duration and cost (network service) of the last call.

- *Send my caller identity* and your phone number will be displayed to the person you are calling (network service). If you select *Set by network*, the setting that you have agreed upon with your service provider will be used.
- *Line for outgoing calls* to select phone line 1 or 2 for making calls. This is a network service. If you select *Line 2* and have not subscribed to this network service, you will not be able to make calls. However, calls on both lines can be answered regardless of the selected line.

## ■ Voice dialling

You can make a phone call by saying a voice tag that has been added to a phone number. Any spoken word(s), such as a person's name(s), can be used as a voice tag.

Before using voice dialling, note that:

- Voice tags are not language dependent. They are dependent on the speaker's voice.
- Voice tags are sensitive to background noise. Record them and make calls in a quiet environment.

- When recording a voice tag or making a call by saying a voice tag, hold the phone in the normal position near to your ear.
- Very short names are not accepted. Use long names and avoid similar names for different numbers.





**Note:** You must say the name exactly as you said it when you recorded it. This may be difficult in, for example, a noisy environment or during an emergency, so you should not rely solely upon voice dialling in all circumstances.

## Adding a voice tag

Save or copy the names and phone numbers to which you want to add voice tags in the phone's memory.

You can also add voice tags to the names on the SIM card, but if you replace your SIM card with a new one, you need to delete the old voice tags before you can add new ones.

1. In standby mode, press  or .
2. Scroll to the name to which you want to add a voice tag and press **Details**. Scroll to the phone number you want and press **Options**.

3. Select **Add voice tag**.
4. Press **Start**, and speaking clearly say the word(s) you want to record as a voice tag. Afterwards, the phone plays the recorded tag.
5. When the voice tag has been successfully saved, **Voice tag saved** is displayed, a beep sounds and a symbol  appears after the phone number with the voice tag.

## Making a call using a voice tag

When an application using the GPRS connection is sending or receiving data, you cannot make a call using voice dialling. To make a call using a voice tag, end the application using the GPRS connection.

1. In standby mode, press and hold **Names**. A short tone is heard and **Speak now** is displayed.
2. Say the voice tag clearly.
3. The phone plays the recognised voice tag and then dials the phone number after 1.5 seconds.

If you are using a headset, press and hold the headset key to start the voice dialling.



## Replaying, changing or erasing a voice tag

Press **Names** and select *Voice tags*. Scroll to the name with the voice tag you want, and press **Options**.

- To replay the voice tag, select *Playback*.
- To erase the voice tag, select *Delete* and press **OK**.
- To change the voice tag, select *Change*. Press **Start** to add the new voice tag.

## Phone book



You can save names and phone numbers in the phone's memory (internal phone book) or in the SIM card's memory (SIM phone book).

- The internal phone book can contain a maximum of 500 names with several numbers and text notes for each name. The total number of names that can be saved depends on the number of the names and the phone numbers and text items attached to them.
- The phone supports SIM cards that can save a maximum of 250 names and phone numbers. Names and numbers saved in the SIM card's memory are indicated by .

## Saving names and phone numbers (Add name)

Names and numbers will be saved in the memory currently being used, see Selecting the phone book settings on page 16.

1. Press **Names** and select *Add name*.
2. Key in the name and press **OK**. See "Writing text" on page 20.
3. Key in the phone number and press **OK**. To key in the numbers, see "Making a call" on page 7.
4. When the name and number are saved, press **Done**.





**Tip:** Quick save: In standby mode, key in the phone number. Press **Options** and select *Save*. Key in the name and press **OK**.





## Saving multiple numbers and text items per name





You can save a maximum of five phone numbers and three brief text items for each name in the phone's internal phone book. Text items saved for each name can be, for example, street and e-mail addresses, a note and a web address.

The first number saved is automatically set as the default number, and is indicated by . When you select a name from the phone book, for example, to make a call, the default number is used unless you select another number.

1. Make sure that the memory in use is either *Phone* or *Phone and SIM*, since multiple numbers and text items can only be saved in the phone's memory. See "Selecting the phone book settings" on page 16.
2. To access the list of names and phone numbers, press  or  in standby mode.
3. Scroll to the name saved in the phone's internal phone book to which you want to add a new number or text item and press **Details**. (If the name is not saved on the phone, the phone will ask you if you want to save it there.)
4. Press **Options** and select *Add number* or *Add detail*.
5. Select one of the following number or text types:

 *General* is the default type used when no other number type is set as the default number.



Other number types are  *Mobile*,  *Home*,  *Office* and  *Fax*.

Text types are  *E-mail*,  *Postal addr.*,  *Note* and  *Web address*.

To change the number or text type, select *Change type* in the options list.

6. Key in the number or text item and press **OK** to save it.
7. Press **Back** and then **Exit** to return to standby mode.

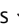

### Changing the default number

Press  or  in standby mode, scroll to the name you want and press **Details**. Scroll to the number you want to set as the default. Press **Options** and select *Set as default*.

### Searching for a name in the phone book

1. Press **Names**, then select *Search*.
2. Press **List** to access the phone book or key in the first character(s) of the name you are searching for and press **Search**. The matches appear with the pop-up window.
3. Scroll to the name you want and press **Details**. Scroll to view the details of the selected name.



**Tip:** To quickly find a name and phone number, press  or  in standby mode. Key in the first letter(s) of the name, and/or scroll to the name you want.

## Editing a name, number or text item

Search for the name (and number) you want to edit and press **Details**. Scroll to the name, number or text item you want to edit and press **Options**. Select *Edit name*, *Edit number* or *Edit detail*, make the changes and press **OK**.

## Erasing names and numbers

Press **Names**, and select *Delete*.

- To delete names and numbers one by one, select *One by one* and scroll to the name (and number) you want to delete. Press **Delete** and press **OK** to confirm.
- To delete all the names and numbers in the phone book at once, select *Delete all*, choose the phone book, *Phone* or *SIM card*, and press **Delete**. Press **OK** and confirm with your security code.

## Copying phone books

You can copy names and phone numbers from the phone's memory to your SIM card's memory and vice versa.

1. Press **Names**, and select *Copy*.
2. Select the copying direction, *From phone to SIM card* or *From SIM card to phone*.

3. Select *One by one*, *All* or *Default nos.*.

- If you select *One by one*, scroll to the name you want to copy and press **Copy**.

*Default nos.* is shown if you copy from the phone to the SIM card. Only the default numbers will be copied since your SIM card may not support multiple numbers stored under one name.

4. To select whether you want to keep or erase the original names and numbers, choose *Keep original* or *Move original*.
  - If you select *All* or *Default nos.*, press **OK** when *Start copying?* or *Start moving?* is displayed.

## Sending and receiving a business card

You can send and receive a person's contact details as a business card as an Over The Air (OTA) message, if supported by the network.

- **Receiving a business card**

When you have received a business card as an Over The Air (OTA) message, press **Show**. Press **Options** and select *Save* to save the business card in the phone's memory, or *Discard* to discard the received business card.

- **Sending a business card**

You can send a person's contact details as a business card to a compatible phone or other compatible handheld device that supports the vCard standard.

1. Search the phone book for the name and phone number you want to send, press **Options** and select *Send bus. card.*
2. To send the business card as an OTA message, select *Via text msg.*, *Via infrared* or *Via Bluetooth.*

## Selecting the phone book settings

1. Press **Names** and then select *Settings.*
2. Select *Memory in use* and select one of the following options:  
*Phone and SIM* to obtain names and numbers from both phone books. The names and numbers will be saved in the phone's memory.  
*Phone* to use the phone's internal phone book.  
*SIM card* to use the SIM card's phone book.

3. Select *Phone book view* and select one of the following options:  
*Name list* to show four names at a time.  
*Name and no.* to show one name and one phone number at a time.  
*Large font* to show only the name.
4. Select *Memory status.* Select *Phone* or *SIM card* to see how many names and phone numbers are currently saved and how many can still be saved in the selected phone book.

## Service numbers

You can call the service numbers of your service provider if the numbers are included on your SIM card.

Press **Names** and select *Service Nos.* Scroll to a service number and press  to call the number.

### 3. Profiles and tones

#### ■ Profiles



Your phone has various setting groups, called profiles, for which you can customise the phone's ringing tones for different events and environments. Firstly, personalise the profiles and then you only need to activate a profile to use it.

Available profiles are *General*, *Silent*, *Discreet*, *Loud*, *My style 1*, and *My style 2*.

Press **Menu** and select *Profiles*. Scroll to a profile and press **Select**.

- To activate the profile, select *Activate*.



**Tip:** To quickly change the profile in standby mode, press the power key , scroll to the profile you want to activate and press **Select**.

- To set the profile to be active for a certain amount of time up to 24 hours, select *Timed* and set the desired time length. When the time set for the profile expires, the previous profile that was not timed becomes active.

- To personalise the profile, select *Personalise*. Select
  - *Incoming call alert* to choose how the phone notifies you of an incoming voice call. The options are *Ringing*, *Ascending*, *Ring once*, *Beep once* and *Off*.
  - *Ringing tone*, *Ringing volume* and *Vibrating alert* for incoming voice calls and incoming messages. The vibrating alert does not work when the phone is connected to a charger, desktop stand or a car kit.
  - *Message alert tone* to set the alert tone for incoming messages, *Keypad tones*, or *Warning tones* to set the phone to sound tones, for example, when the battery is running out of power.

In addition, you can rename a profile, *Profile name*. The *General* profile cannot be renamed.

## ■ Tones

If you receive a traditional ringing tone as an OTA message, you can save it in the ringing tone list. The number of ringing tones you can save in the ringing tone list depends on the size of an individual ringing tone. If there is no free space for new ringing tones, you can replace a previously stored ringing tone with the newly received one. Note that your phone does not support polyphonic ringing tones.

## 4. Text and multimedia messages

You can read, write and send text, picture and multimedia messages and e-mail, or save your messages. All the messages in your phone's message memory are organised in folders.

Before you can send any text or picture messages, you need to save your message centre number, see "Text message settings" on page 26.



**Note:** Your phone must be switched on to use these functions. Do not switch the phone on when wireless phone use is prohibited or when it may cause interference or danger.

### ■ Writing and sending text messages

Your phone is able to send and receive multi-part messages comprised of several ordinary text messages (network service). Invoicing is based on the number of ordinary messages needed for a multi-part message.

The number of available characters and the current part number of a multi-part message are shown on the top right of the display.

1. Press **Menu**, and select *Messages, Text messages* and *Create message*.

2. Key in a message. See "Writing text" on page 20.

See also "Templates" on page 23.

3. To send the message, press **Options** and select *Send*.

4. Enter the recipient's phone number, or search for it in the phone book, and press **OK** to send the message.



**Note:** When sending messages via the SMS network service, your phone may display the words "Message Sent". This is an indication that the message has been sent by your phone to the message centre number programmed into your phone. This is not an indication that the message has been received at the intended destination. For more details about SMS services, check with your service provider.

## Options for sending text messages

After you have written a message, press **Options**, and select *Sending options*.



- To send a message to several recipients, select *Send to many*. When you have sent the message to everyone you want to send it to, press **Done**.
- To send a message using a message profile, select *Sending profile* and then the message profile you want to use.

For example, if you select a profile that you have defined for sending e-mail messages, key in or search the phone book for the recipient's e-mail address and press **OK**. Key in the e-mail service number and select *Accept* to send the message.

To define a message profile, see "Text message settings" on page 26.

## ■ Writing text

You can key in text, for example, when writing messages, using the traditional method, or another method called predictive text input.

When you are writing text, predictive text input is indicated by  and traditional text input by  at the top left of the display. The character case is indicated by **Abc**, **abc**, or **ABC** next to the text input indicator, and you can change the character case by pressing **# ⇧**. The number mode is indicated by **123**, and you can switch between letter and number modes by pressing and holding **# ⇧**.

## Setting predictive text input on or off

When writing text, press **Options** and select *Dictionary*.

- To set the predictive text input on, select a language from the dictionary options list. Predictive text input is only available for the languages in the list.
- To change back to traditional text input, select *Dictionary off*.



**Tip:** To quickly set predictive text input on or off when writing text, press **# ⇧** twice, or press and hold **Options**.



## Using predictive text input

You can key in any letter from A to Z with a single keypress. Predictive text input is based on a built-in dictionary to which you can also add new words.

1. Start writing a word by using the keys **2 abc** to **9 wxyz**. Press each key only once for one letter. The word changes after each keystroke.

For example, to write **Nokia** when the English dictionary is selected, press **6 mno** once for N, **6 mno** once for o, **5 jkl** once for k, **4 ghi** once for i and **2 abc** once for a:



To insert a number while in letter mode, press and hold the desired number key.

For more instructions on writing text, see "[Tips for writing text](#)" on page 22.

2. When you have finished writing the word and it is correct, confirm the word by pressing  or adding a space with **0**.

If the word is not correct, you have the following options:



- Press **\* +** repeatedly until the word you want appears and then confirm it.

- Press **Options** and select *Matches*.

If the ? character is displayed after the word, the word you intended to write is not in the dictionary. To add the word to the dictionary, press **Spell**, key in the word (traditional text input is used) and press **Save**. When the dictionary becomes full, the new word replaces the oldest one that was added.

3. Start writing the next word.



## Writing compound words

Key in the first part of the word and confirm it by pressing . Write the last part of the word and confirm it by pressing **0** or .

## Using traditional text input

Press a number key, **2 abc** to **9 wxyz**, repeatedly until the character you want appears. Not all of the characters available under a number key are printed on the key. The characters available depend on the language selected in the *Language* menu, see "[Language](#)" on page 33.



To insert a number while in letter mode, press and hold the desired number key.

- If the next letter you want is located on the same key as the present one, wait until the cursor appears, or press  or  and then key in the letter.
- The most common punctuation marks and special characters are available under the number key **1** .

For more instructions on writing text, see "[Tips for writing text](#)" below.

## Tips for writing text

You can also use the following keys for writing text:

- To insert a space, press **0** .
- To move the cursor to the right or left, press  or , respectively.
- To delete a character to the left of the cursor, press **Clear**. Press and hold **Clear** to delete the characters more quickly.
- To insert a special character when using traditional text input, press **\*+**, or when using predictive text input, press and hold **\*+**, or press **Options** and select *Insert symbol*.

Scroll through the list of characters and press **Use** to select a character.

To scroll through the list more quickly, press **2abc**, **4ghi**, **6mno** or **8tuv**, and press **5jkl** to select a character.

- To insert a number while in letter mode, press **Options** and select *Insert number*. Key in the numbers you want and press **OK**.
- To insert a name or a phone number by searching for it in the phone book, press **Options** and select *Insert name* or *Insert number*.
- To insert a word when using predictive text input, press **Options** and select *Insert word*. Write the word using traditional text input and press **Save**. The word is also added to the dictionary.

## ■ Writing and sending e-mails

Before you can send any e-mails via SMS you need to save the settings for e-mail sending, see "[Text message settings](#)" on page 26. For availability and subscription to the e-mail service, contact your network operator or service provider. To save an e-mail address in the phone book, see "[Saving multiple numbers and text items per name](#)" on page 13.

1. Press **Menu**, and select *Messages, Text messages* and *Create e-mail*.



2. Key in the recipient's e-mail address or search for it in the phone book and press **OK**.
3. You can key in a subject for the e-mail if you want and press **OK**.
4. Key in the e-mail message. See "Writing text" on page 20. The number of characters you can key in is shown on the top right of the display. The e-mail address and subject are included in the total number of characters.  
See also "Templates" on page 23. Inserting a picture is not possible.
5. To send the e-mail, press **Options** and select *Send e-mail*. If you have not saved the settings for sending e-mails, the phone asks for the e-mail server number.

Press **OK** to send the e-mail.



**Note:** When sending e-mails via the SMS network service, your phone may display the words *Message sent*. This is an indication that the e-mail has been sent by your phone to the e-mail server. This is not an indication that the e-mail has been received at the intended destination. For more details about e-mail services, check with your service provider.

## ■ Templates

Your phone includes text templates, indicated by , and picture templates, indicated by .

To access the template list, press **Menu** and select *Messages*, *Text messages* and *Templates*.

### Inserting a text template into a message or an e-mail

When you are writing or replying to a message, or an e-mail, press **Options**. Select *Use template* and select the template you want to insert.

### Inserting a picture into a text message

Your phone includes picture message templates. You can also save new pictures into the *Templates* folder. More pictures can be found on the Nokia website, <http://www.club.nokia.com>.



**Note:** This function can be used only if it is supported by your network operator or service provider. Only phones that offer picture message features can receive and display picture messages.

- Each picture message is made up of several text messages. Therefore, sending one picture message may cost more than sending one text message.
- Since picture messages are saved in the phone's memory, you cannot view them if you use your SIM card with another phone.

When you are writing or replying to a message, press **Options**. Select *Insert picture* and select a picture to view it. Press *Attach* to insert the picture into your message. The  indicator on the header of the message indicates that a picture has been attached. The number of characters that you can enter in a message depends on the size of the picture.

To view the text and the picture together before sending the message, press **Options** and select *Preview*.

## ■ Reading and replying to a message or an e-mail



When you have received a text message or an e-mail, the indicator  and the number of new messages followed by *messages received* are shown.

The blinking  indicates that the message memory is full. Before you can receive new messages, delete some of your old messages.

1. Press **Show** to view the message, or press **Exit** to view it later.

### Reading the message later:

Press **Menu**, and select *Messages, Text messages*, and *Inbox*.

2. If more than one message has been received, select the message you want to read. An unread text message is indicated by  in front of it and an unviewed picture message by .
3. While reading or viewing the message, press **Options**.

You can select, for example, an option to delete, forward, or edit the message as a text message or an e-mail, move, or rename the message you are reading.

Select *Copy to calend.* to copy text from the beginning of the message to your phone's calendar as a reminder note for the current day.

Select *Message details* to view the sender's name and phone number, the message centre used, and the date and time of receipt.

Select *Use detail* to extract numbers, e-mail addresses, and website addresses from the current message.

When viewing a picture message, select *Save picture* to save the picture in the *Templates* folder.

4. Select *Reply* to reply to a message. Select *Original text* to include the original message in the reply, or select a standard answer to be included in the reply, or select *Empty screen*.

When replying to an e-mail, confirm or edit the e-mail address and subject first. Then write your reply message.

5. Press **Options**, select *Send*, and press **OK** to send the message to the displayed number.

## ■ Inbox and outbox folders

After you have read a new text or picture message, the phone saves the message in the *Inbox* folder of the *Text messages* menu.

You can save messages that you want to send later in the *Sent items* or *Archive* folder.

## ■ My folders and Archive folder

To organise your messages, you can create new folders and then move messages to them or to the *Archive* folder.

To add or delete a folder, press **Menu**, select *Messages*, *Text messages* and *My folders*.

- To add a folder, press **Options** and select *Add folder*.
- To delete a folder, scroll to the folder you want to delete, press **Options** and select *Delete folder*.

To move a message to another folder, press **Options** while reading the message you want to move. Select *Move*, scroll to the folder to which you want to move the message and press **OK**.

## ■ Erasing text messages

Press **Menu**, select *Messages*, *Text messages* and select *Delete messages*.

To delete all messages in a folder, scroll to the folder and press **Select**. Then press **OK** when *Delete all messages?* is displayed.

## ■ Chat

You can have a conversation with other people using this faster text message service. Messages sent or received during a chat session are not saved.

1. To start a chat, press **Menu**, select *Messages* and *Chat*. Key in or search the phone book for the phone number of the person with whom you want to chat and press **OK**.

**Another way to start a chat:**

When you have received a message, press **Show** to read it. To start a chat, press **Options** and select **Chat**.

2. Key in your nickname for the chat and press **OK**.
3. Write your chat message, see "Writing text" on page 20.
4. To send the message, press **Options** and select **Send**.
5. The reply message from the other person is shown above your original message. To reply to the message, press **OK** and repeat step 3.

To view the most recent messages of the current chat session, press **Options** and select **Chat history**. The messages you sent are indicated by "<" and your nickname, and the messages you received by ">" and the sender's nickname. Press **Back** to return to the message you are writing.

To edit your nickname, select the option **Chat name**.

**■ Text message settings**

Text message settings affect the sending of messages.

Press **Menu**, select **Messages**, **Message settings**, and **Text messages**. If more than one message profile set is supported by your SIM card, select the message profile set that you want to change. Select

- **Message centre number** to save the phone number of the message centre. You need the message centre number to send text and picture messages. You will receive the number from your service provider.
- **Messages sent as** to select the message format.
- **Message validity** to set the length of time that the network will attempt to send you a message, for example, when your phone is turned off.
- **Default recipient number** to save a default number for sending messages for this message profile.
- **Delivery reports** to ask the network to send delivery reports about your messages (network service).

- *Use GPRS* to set GPRS as the preferred SMS bearer.
- *Reply via same centre* to allow the recipient of your message to send you a reply via your message centre (network service)
- *Rename sending profile* to change the name of the selected message profile.

## ■ Message counter

Press **Menu**, select *Call register* and *Message counter* to see the number of sent and received text and picture messages, chat messages and e-mails. Note that for example picture messages are formed by several text messages, and the message counter counts these text messages separately. Follow the instructions on the phone display.

## ■ Info messages

With the info message network service, you can receive messages on various topics, for example weather or traffic conditions, from your service provider. For available topics and relevant topic numbers, contact your service provider.

If the *GPRS connection* is set to *Always online*, the info messages may not be received. In that case, set the *GPRS connection* to *When needed*, see "Setting up the phone for a WAP service" on page 39.

## ■ Service command editor

Press **Menu**, select *Messages* and *Service command editor*. Key in and send service requests (also known as USSD commands), such as activation commands for network services, to your service provider.

## ■ Multimedia messages



**Note:** This function can be used only if it is supported by your network operator or service provider. Only phones that offer multimedia message features can receive and display multimedia messages.

A multimedia message can contain text, picture and sound. Note that your phone does not support polyphonic ringing tones and your phone cannot play them. The phone supports multimedia messages of size up to 45 KB. If that maximum size is exceeded, the phone may not be able to receive the message. Depending on the network, you may receive a text message including an Internet address where you can view the multimedia message.

If the message contains pictures, the phone scales them down to fit the display area.



**Note:** If *Allow multimedia reception* is set to *Yes* or *Home network*, your operator or service provider may charge you for every message you receive.

Multimedia messaging supports the following formats:

- Picture: JPEG, GIF, PNG, and BMP.

If a received message contains any unsupported elements, they may be replaced with the file name and the text *Object format not supported*

Note that you are not able to receive any multimedia messages if you have a call in progress, a game or another Java application running, or an active WAP connection over GSM data (see *"Keying in the service settings manually"* on page 40). Because delivery of multimedia messages can fail for a variety of reasons, do not rely solely upon them for essential communications.

## Writing and sending multimedia messages

To set the settings needed for multimedia messaging, see *"Settings for multimedia messages"* on page 30. For availability and subscription to the multimedia messaging service, contact your network operator or service provider.

1. Press **Menu**, and select *Messages, Multimedia msg.*, and *Create message*.
2. Key in a message. See *"Writing text"* on page 20.

You can insert one picture into a multimedia message. To insert a picture, press **Options** and select *Insert image*. The list of available folders in the *Gallery* is shown. To open the desired folder, select it and then select the desired picture. The  indicator on the header of the message indicates that a picture has been attached.

To insert a name from the phone book, press **Options**, and select *More options* and *Insert name*. Scroll to the desired name, press **Options** and select *Insert name*.

To insert a number, press **Options**, and select *More options* and *Insert number*. Key in the number or search for it in the phone book, and press **OK**.

3. To view the message before sending it, press **Options** and select *Preview*.
4. To send the message, press **Options** and select *Send to number* (or *Send to e-mail*).





5. Enter the recipient's phone number (or e-mail address) or search for it in the phone book. Press **OK** and the message is moved to the *Outbox* folder for sending.

It takes longer to send a multimedia message than a text message. While the message is being sent, the animated indicator  is displayed and you can use other functions on the phone. If the sending is interrupted, the phone tries to resend it a few times. If this fails, the message remains in the *Outbox* folder and you can try to resend it later.

The sent messages will be saved in the *Sent items* folder if the setting *Save sent messages* is set to *Yes*. See "[Settings for multimedia messages](#)" on page 30.

## Reading and replying to a multimedia message

When your phone is receiving a multimedia message, the animated indicator  is displayed. When the message has been received, the indicator  and the text *Multimedia message received* are shown.

- The blinking  indicates that the memory for multimedia messages is full, and *Memory full, view waiting multimedia* is shown. Before you can receive new messages, delete some of your old messages.

1. Press **Show** to view the message. Press **Exit** to view it later.

**Reading the message later:** Press **Menu** and select *Messages*, *Multimedia msg.*, and *Inbox*.

2. Scroll to view the message. Press **Options** and some of the following options may be available.

- *Delete message* to delete a saved message.
- *Reply* to reply to the message. To send the reply message, press **Options** and select *Send*. The sender's phone number (or e-mail address) is used as the default value.
- *Forward to no.* or *Fwd. to e-mail* to forward the message to a phone number or an e-mail address.

- *Edit* to edit a message. You can only edit messages you have written. See "[Writing and sending multimedia messages](#)" on page 28.
- *Message details* to view the message subject, size and class.
- *Save image* to save a picture in the *Gallery*.

## Inbox, Outbox, Saved, and Sent items folders

The phone saves the received multimedia messages in the *Inbox* folder of the *Multimedia msg.* submenu.

Multimedia messages to be sent are moved to the *Outbox* folder of the *Multimedia msg.* submenu.

The multimedia messages you want to send later can be saved in the *Saved items* folder of the *Multimedia msg.* submenu.

The sent multimedia messages are saved in the *Sent items* folder of the *Multimedia msg.* submenu.

## ■ Settings for multimedia messages

Press **Menu** and select *Messages*, *Message settings*, and *Multimedia msg.* Select

- *Save sent messages*. Select *Yes* to set the phone to save sent multimedia messages in the *Sent items* folder. If you select *No*, the sent messages are not saved.
- *Allow multimedia reception*. Choose *No*, *Yes* or *Home network* to use multimedia services. If you choose *Home network*, you cannot receive multimedia messages when outside your home network.
- *Incoming multimedia messages*. Select *Retrieve* to set the phone to automatically fetch new multimedia messages, or select *Reject* if you do not wish to receive multimedia messages.
- *Connection settings*. Define WAP connection settings for retrieving multimedia messages. Activate the set where you want to save the connection settings and then edit the settings. Refer also to "[Keying in the service settings manually](#)" on page 40.

- **Settings' name.** Key in the new name for the connection set and press **OK**.
- **Homepage.** Key in the homepage address of the WAP service that you want to use, press **100** for a dot, and press **OK**.
- **Session mode.** Select *Permanent* or *Temporary*.
- **Data bearer.** Select *GPRS*.
- **GPRS access point.** Key in the access point name and press **OK**. An access point name is needed to establish a connection with a GPRS network. You can obtain the access point name from your network operator or service provider.
- **IP address.** Key in the address, press **\*+** for a dot, and press **OK**. You can obtain the IP address from your network operator or service provider.
- **Authentication type.** Select *Secure* or *Normal*.
- **User name.** Key in the user name and press **OK**.
- **Password.** Key in the password and press **OK**.
- **Allow adverts.** You can receive or reject adverts.

## To receive multimedia connection settings as a text message

You may receive the service settings as a text message from the network operator or service provider that offers the WAP service that you want to use. For more information, contact your network operator or service provider, or visit Club Nokia's website ([www.club.nokia.com](http://www.club.nokia.com)).

## ■ Gallery



You can save pictures and ringing tones, for example, received in a multimedia message, in the folders of the gallery, see ["Reading and replying to a multimedia message"](#) on page 29.

1. Press **Menu** and select *Gallery*. A list of options is shown.
2. Select *View folders* to open the list of folders.

Other available options are:

- **Delete folder** to select a folder you want to delete. You cannot delete the original folders in the phone.
- **Rename folder** to select a folder you want to rename. You cannot rename the original folders in the phone.

- *Add folder* to add a new folder. Key in a name for the folder and press **OK**.
  - *Gallery servs.* to download images and tones. Select *Image services or Tones*, respective. The phone tries to connect to the WAP page of Club Nokia using the currently active set of service settings. If the connection fails, you may not be able to access Club Nokia from the WAP service whose connection settings are currently active. In this case, enter the *Services* menu, activate another set of service settings, see "*Making a connection to a WAP service*" on page 43. Try again to connect to Club Nokia.  
  
Contact your network operator and/or the WAP service provider for the availability of different WAP services, pricing and tariffs.
3. Select the desired folder and a list of files in the folder is shown. *Graphics* and *Ringing tones* are the original folders in the phone.
  4. Select the desired file. Press **Options** and some of the following options are available:
    - *Open* to open the selected file.
    - *Delete* to delete the selected file.
    - *Set as wallpaper*. to set the selected file as wallpaper.
    - *Move* to move a file to another folder.
    - *Rename* to give a new name to the file.
    - *Details* to see the details of the file.
    - *Sort* to sort the files and folders by date, type, name, or size.

## 5. Settings

### ■ Time and date settings

#### Clock settings

Press **Menu**, select *Settings, Time and date settings* and *Clock*. Select

- *Show clock (Hide clock)* and the time is shown on the top right of the display when the phone is in standby mode.
- *Set the time*, key in the correct time and press **OK**.
- *Time format* and select the 12-hour or 24-hour time format.

The clock is also used for the following functions: *Messages, Call register, Alarm clock*, timed *Profiles* and *Calendar*.

If the battery is removed from the phone for more than a few minutes, you may need to set the time again.

#### Date settings

Press **Menu**, select *Settings, Time and date settings*, and *Date*. Select

- *Set the date* to set the current date.
- *Date format* to choose how the date is displayed on the screen.

### Automatic update of date and time

Select *Auto-update of date & time* and *On* to set the phone to automatically update the time and date according to the current time zone. To set the phone to ask for confirmation before updating, select *Confirm first*.

### ■ Phone settings

#### Language

Press **Menu**, select *Settings, Phone settings* and *Language*. Select the language for the display texts. If *Automatic* is selected, the phone selects the language according to the information on the SIM card.

#### Cell info display

Press **Menu**, select *Settings, Phone settings*, and *Cell info display*.

Select *On* to set the phone to indicate when it is used in a cellular network based on Micro Cellular Network (MCN) technology.

If the *GPRS connection* is set to *Always online*, the info messages may not be received. In that case, set the *GPRS connection* to *When needed*, see "[Setting up the phone for a WAP service](#)" on page 39.

## Welcome note

Press **Menu**, select *Settings*, *Phone settings*, and *Welcome note*. Key in the note you would like to be shown briefly when the phone is switched on. To save the note, press **Options** and select *Save*.

## Network selection

The cellular network to which your phone is connected can be selected either manually or automatically.

Press **Menu**, select *Settings*, *Phone settings*, and *Network selection*. Select *Automatic* and the phone automatically selects one of the cellular networks available in your area.

If you select *Manual*, the phone shows a list of the available networks and you can select a network that has a roaming agreement with your home network operator. Otherwise, *No access* will be displayed and you must select another network. The phone stays in manual mode until the automatic mode is selected or another SIM card is inserted into the phone.

## Confirm SIM service actions

See "[SIM services](#)" on page 60.

## Help text activation

To set the phone to show or not to show help texts, press **Menu**, select *Settings*, *Phone settings*, and *Help text activation*.

See also "[Using the menu](#)" on page 6.

## Start-up tone

To set the phone to play or not to play a start-up tone when the phone is switched on, press **Menu**, select *Settings*, *Phone settings*, and *Start-up tone*.

If you have activated a welcome note, a start-up tone will not be played, see "[Welcome note](#)" on page 34.

## ■ Display settings

### Wallpaper

You can set your phone to display a background picture, called wallpaper, when the phone is in standby mode. Some pictures are pre-saved in the *Gallery* menu. You can also receive pictures via multimedia messages, download them from WAP pages or use PC Suite to transfer them from your PC and then save them in *Gallery*. Your phone supports JPEG, GIF and PNG formats.

### To select a wallpaper picture

1. Press **Menu** and select *Settings*, *Display settings*, and *Wallpaper*.
2. Select *Change image* and the folder list in the *Gallery* menu will be shown.
3. Select the folder and scroll to the desired picture.
4. To set the picture as wallpaper, press **Options** and select *Set as wallpaper*.

Note that if you delete the selected wallpaper picture from the gallery, it will still be used as wallpaper until you replace it with another picture.

Note that the wallpaper is not displayed when the phone activates the screen saver.

### To activate or deactivate the wallpaper

Press **Menu** and select *Settings*, *Display settings* and *Wallpaper*. To activate/deactivate the wallpaper, select *On* or *Off*, respectively.

## Colour schemes

You can change the colour of some display components, for example, indicators and signal bars.

Press **Menu** and select *Settings*, *Display settings*, and *Colour schemes*. Select the desired colour scheme.

## Operator logo

To set your phone to display or hide the operator logo, press **Menu** and select *Settings*, *Display settings*, and *Operator logo*.

Note that the operator logo is not displayed when the phone activates the screen saver.

## Screen saver

A digital clock screen saver is used for power saving in standby mode. It activates when no function of the phone has been used for a certain length of time. Press any key to deactivate the screen saver. The screen saver is also deactivated when the phone is out of the network coverage area.

Press **Menu** and select *Settings*, *Display settings*, and *Screen saver timeout*. Select the length of time after which the digital clock display will be activated. The timeout can vary from 5 seconds to 60 minutes.

Note that the screen saver overrides all graphics and texts that are on the display in standby mode.

## ■ Tone settings

Press **Menu**, and select *Settings* and then *Tone settings*. You can find the same settings in the *Profiles* menu, see "Profiles" on page 17. Note that the settings you make, change the settings in the active profile.

Select *Incoming call alert* to select how the phone notifies you of an incoming voice call. The options are *Ringing*, *Ascending*, *Ring once*, *Beep once* and *Off*.

Select *Ringing tone* for incoming voice calls. To select ringing tones that have been saved in the *Gallery*, select *Open gallery* from the ringing tone list.

Select *Ringing volume* and *Vibrating alert* for incoming voice calls and messages. The vibrating alert does not work when the phone is connected to a charger, a desktop stand, or a car kit.



**Tip:** If you receive a ringing tone via OTA or by downloading, you can save the ringing tone in the *Gallery*. Note that your phone does not support polyphonic ringing tones.

Select *Message alert tone* to set the alert tone for the incoming messages, *Keypad tones*, or *Warning tones* to set the phone to sound tones for example, when the battery is running out of power.

Select *Alert for* to set the phone to ring only upon calls from phone numbers that belong to a selected caller group. Scroll to the caller group you want or *All calls* and press *Mark*.

## ■ Accessory settings

The accessory settings menu is only shown if the phone is or has been connected to one of the following accessories: headset HDC-5, loopset LPS-3, or handsfree car kits PPH-1 or CARK 125.

Press **Menu**, select *Settings* and *Accessory settings*. Select *Headset*, *Handsfree* or *Loopset*.

- Select *Default profile* to select the profile you want to automatically activate when you connect the selected accessory. You can select another profile while the accessory is connected.
- Select *Automatic answer* to set the phone to automatically answer an incoming call after five seconds. If the *Incoming call alert* is set to *Beep once* or *Off*, automatic answer will not be used.
- Select *Lights* and then *On* to set the lights permanently on. Select *Automatic* to switch the lights on for 15 seconds after a keypress. The *Lights* option is only available when *Handsfree* is selected.



- Select *Use loopset* and then *Yes* to use the loopset instead of the headset. *Use loopset* is only available when *Loopset* is selected.

## ■ Security settings



**Note:** When security features, which restrict calls, are in use (call barring, closed user group and fixed dialling), calls may be possible to certain emergency numbers in some networks (e.g. 112 or other official emergency number).

Press **Menu**, select *Settings* and *Security settings*. Select

- *PIN code request* to set the phone to ask for your PIN code every time the phone is switched on. Some SIM cards do not allow the PIN code request to be turned off.
- *Call barring service* (network service) to restrict incoming calls to and outgoing calls from your phone. A barring password is required.
- *Fixed dialling* to restrict your outgoing calls to selected phone numbers, if this function is supported by your SIM card. The PIN2 code is required.

- *Closed user group*. Closed user group is a network service that specifies a group of people whom you can call and who can call you. For more information, contact your network operator or service provider.

- *Security level*. Select *Phone* and the phone will ask for the security code whenever a new SIM card is inserted into the phone.

Select *Memory* and the phone will ask for the security code whenever you want to select the phone's internal memory or to copy from one memory to another. Note that the selected memory has to be the SIM card memory. See "[Selecting the phone book settings](#)" on page 16 and "[Copying phone books](#)" on page 15.

- *Access codes* and you can change the security code, the PIN code, the PIN2 code or the barring password. Codes can only include numbers from 0 to 9.

Note that you should avoid using access codes similar to emergency numbers, such as 112, to prevent accidental dialling of an emergency number.

## ■ Restore factory settings

To reset some of the menu settings to their original values, press **Menu**, select *Settings* and *Restore factory settings*. Key in the security code and press **OK**. The names and phone numbers saved in the phone book are not deleted.

## 6. WAP services

You can access various WAP services such as news, weather reports, entertainment, cinema, and online games. These services are specially designed for mobile phones and they are maintained by WAP service providers.

The WAP services use Wireless Mark-Up Language (WML) on their WAP pages. Web pages using the Hyper Text Mark-Up Language (HTML) cannot be viewed on your phone.

Check the availability of WAP services, pricing and tariffs with your network operator and/or the service provider whose services you wish to use. Service providers will also give you instructions on how to use their services.



**Note:** The phone must be switched on to use this function. Do not switch on the phone when the use of a wireless phone is prohibited or when it may cause interference or danger.

### ■ Setting up the phone for a WAP service

You may receive the service settings on your phone directly from the network operator or service provider that offers the WAP service that you want to use. For more information, contact your network operator or service provider, or visit Club Nokia's Web site ([www.club.nokia.com](http://www.club.nokia.com)).

You can also key in the settings manually. For the correct settings, contact your network operator or service provider. The WAP settings may be available, for example, on the web site of the network operator or service provider.

### Saving the service settings received as a text message

When you receive the service settings as a text message, *Service settings received* is displayed.

- To save and activate the received settings, press **Options** and select *Save*.

If no settings are saved in *Active service settings*, the settings are saved in the first free connection set and are also activated.

- To discard the received settings, press **Options** and select *Discard*.
- To view the received settings first, press **Options** and select *View*. To save the settings, press **Save**.

## Keying in the service settings manually

1. Press **Menu**, select *Services* and *Settings*.
2. Select *Active service settings*.  
You need to activate the set in the place where you want to save the service settings. A set is a collection of settings needed to make a connection to a WAP service.
3. Scroll to the set you want to activate and press **Activate**.
4. Select *Edit active service settings*.

Select each of the service settings one by one and key in all the required settings.

- *Settings' name* - Key in a new name for the connection set and press **OK**.

- *Homepage* - Key in the homepage address of the WAP service that you want to use, press **1**  for a dot and press **OK**.
- *Session mode* - Select *Permanent* or *Temporary*.
- *Connection security* - Select *On* or *Off*.

When the connection security is set to *On*, the phone tries to use a secure connection to the WAP service. If a secure connection is not available, the connection will not be made. If you wish to connect anyway, with a non-secure connection, you must set the connection security to *Off*.

- *Data bearer* - Select *GSM data* or *GPRS*. For settings for the selected bearer, see "*Settings when GSM data is the selected data bearer*" and "*Settings when GPRS is the selected data bearer*" below.

For pricing, connection speed, and other information, contact your network operator or service provider.

## Settings when GSM data is the selected data bearer

- *Dial-up number* - Key in the phone number and press **OK**.
- *IP address* - Key in the address, press \*+ for a dot and press **OK**. You can obtain the IP address from your network operator or service provider.
- *Authentication type* - Select *Secure* or *Normal*.
- *Data call type* - Select *Analogue* or *ISDN*.
- *Data call speed* - Select the speed you want to use, or select *Automatic*. *Automatic* is only available if the currently selected data call type is *Analogue*. The actual data call speed depends on the service provider.
- *Login type* - Select *Manual* or *Automatic*. If you select *Automatic*, the login type uses the user name and password keyed in for the following settings. If you select *Manual*, the login information must be entered when establishing a connection.
- *User name* - Key in the user name and press **OK**.
- *Password* - Key in the password and press **OK**.

## Settings when GPRS is the selected data bearer

- *GPRS connection* - Select *Always online* or *When needed*.  
If you select *Always online*, the phone automatically registers with a GPRS network when you switch the phone on. Starting a WAP application creates the connection between your phone and the network, making data transfers possible. When you end the application, the GPRS connection ends but the registration to the GPRS network remains.  
If you select *When needed*, the GPRS connection is established when you connect to a WAP service and is closed when you end the WAP connection.
- *GPRS access point* - Key in the access point name and press **OK**.  
An access point name is needed to establish a connection to a GPRS network. You can obtain the access point name from your network operator or service provider.
- *IP address* - Key in the address, press \*+ for a dot and press **OK**. You can obtain the IP address from your network operator or service provider.
- *Authentication type* - Select *Secure* or *Normal*.

- *Login type* – Select *Manual* or *Automatic*. If you select *Manual* when the *GPRS connection* is set to *Always online*, the *Always online* connection will be disabled.
- *User name* – Key in the user name and press **OK**.
- *Password* – Key in the password and press **OK**.

## GPRS connection

You can set the phone to automatically register to a GPRS network when you switch the phone on. Press **Menu**, and select *Connectivity, GPRS* and *GPRS connection*. Select *Always online* or *When needed*.

If you select *Always online*, the phone automatically registers with a GPRS network when you switch the phone on. Starting a WAP or PC-dial-up application, or sending/receiving multimedia messages, creates the connection between your phone and the network and data transfer is possible. When you end the application, the GPRS connection is ended but the registration to the GPRS network remains.

If you select *When needed*, the GPRS connection is established when an application needs it and closed when you end the application.

## GPRS modem settings

You can connect the phone via infrared or Bluetooth connection to a compatible PC and use the phone as a modem to enable GPRS connectivity from the PC.

Press **Menu**, and select *Connectivity, GPRS* and *GPRS modem settings*. Select *Active access point* and activate the access point you want to use. Select *Edit active access point* to change the access point settings.

- Scroll to *Alias for access point* and press **Select**. Key in the name you would like for the activated access point and press **OK**.
- Scroll to *GPRS access point* and press **Select**. Key in the Access Point Name (APN) and press **OK**.

An access point name is needed to establish a connection to a GPRS network. You can obtain the Access Point Name from your network operator or service provider.

You can also set the GPRS dial-up service settings (Access Point Name) on your PC by using the Nokia Modem Options software, see "[PC Suite](#)" on page 52. If you have set the settings both on your PC and on your phone, note that the settings set on the PC will be used.

## ■ Making a connection to a WAP service

Firstly, make sure that the service settings of the WAP service you want to use have been activated. To activate the settings:

- Press **Menu**, select **Services** and **Settings**. Select **Active service settings** and scroll to the set you want to activate and press **Activate**.

Secondly, make a connection to the WAP service. There are three ways to connect:

- Open the homepage of the WAP service:

Press **Menu**, select **Services** and **Home**.



**Tip:** To quickly open the homepage of a WAP service: press and hold **0** in standby mode.

OR

- Select a bookmark for the WAP service:

Press **Menu**, select **Services**, **Bookmarks** and select a bookmark.

If the bookmark does not work with the currently active service settings, activate another set of service settings and try again.

OR

- Key in the address of the WAP service:

Press **Menu**, select **Services** and then **Go to address**. Key in the address of the WAP service, press **\* +** for special characters and press **OK**.



Note that it is not necessary to add the prefix **http://** in front of the address since it will be added automatically.

## ■ Browsing the pages of a WAP service

After you have made a connection to the WAP service, you can start browsing its WAP pages. The function of the phone keys may vary for different WAP services. Follow the text guides on the phone's display. For more information, contact your WAP service provider.

Note that if GPRS is selected as the data bearer, the indicator is shown on the top left of the display during browsing. If there is an incoming (or outgoing) call during a GPRS connection, the indicator is shown on the top right of the display. The GPRS connection is suspended.

## General guidelines for using the phone keys

- Use the scroll keys  or  to browse WAP pages.
- To select a highlighted item, press .
- To enter letters and numbers, press the keys **0-9** - **9wxyz** and to enter special characters, press the **\* +** key.
- Some or all of the following options are available while a WAP connection is in progress. Press **Options** and select the option you want.

*Home* - to return to the homepage of the WAP service

*Bookmarks* - to display the list of bookmarks. For details, see "[Bookmarks](#)" on page 46.

*Edit/Open row/Open link/Open list* - to key in text or select a highlighted item on the WAP page.

*Add bookmark* - to add the current WAP page to your bookmarks list.

*Go to address* - to key in the address of the WAP service you wish to connect to.

*Service inbox* - a list of service messages is displayed, see "[Service inbox](#)" on page 47.

*Appear. sett.* - see "[Appearance settings of the WAP browser](#)" on page 45.

*Cookie settings* - see "[Download settings](#)" on page 46.

*Use number* - to copy a number from the current WAP page for saving or calling (this will end the WAP connection). If the WAP page contains several numbers, you may select the desired one.

*Reload* - to reload and update the current WAP page.

*Clear the cache* - see "[The cache memory](#)" on page 47.

*Security info* - to view security information about the current WAP connection and the server.

*Quit* - to quit browsing and end the call.

The options may also include links provided by the service provider.



## WAP direct calling



Certain WAP pages support functions that you can access while browsing. This is indicated on the WAP page. You may, for example, be able to

- make a voice call while you are on a WAP page.
- send DTMF tones while a voice call is in progress.
- save a name and a phone number from a WAP page in the phone book.

The phone asks for a confirmation before carrying out any of these functions.

## Ending a WAP connection

When you are using a WAP service, press **Options** and select *Quit*. When *Quit browsing?* is shown, press **Yes**.

Alternatively, press  once to end the connection (GPRS or GSM data). Press  once more to exit the WAP menu.

## Appearance settings of the WAP browser

1. When no WAP connection is in progress

- Press **Menu**, select *Services*, *Settings* and *Appearance settings*.

When a WAP connection is in progress

- Press **Options** and select *Appear. sett.*

2. Select *Text wrapping* or *Show images*.
3. Select *On* or *Off* for *Text wrapping* and *Yes* or *No* for *Show images*.

When *Text wrapping* is set to *On*, the text continues onto the next line if it cannot be shown on one line.

When *Show images* is set to *No*, the pictures that appear on the WAP page are not shown. This can speed up the browsing of WAP pages that contain a lot of pictures.

## ■ Download settings

You can set the phone to allow or prevent the phone receiving cookies.

A cookie is data that a WAP site saves in your phone's browser cache memory. The data can be, for example, your user information or your browsing preferences. Cookies will be saved until you clear the cache memory, see "[The cache memory](#)" on page 47.

1. When no WAP connection is in progress
  - Press **Menu**, select *Services*, *Settings* and *Cookie settings*.

When a WAP connection is in progress

- Press **Options** and select *Cookie settings*.
2. Select *Cookies* and select *Allow* or *Reject* to allow or prevent the phone receiving cookies.

## ■ Bookmarks

You can save a maximum of 50 WAP page addresses as bookmarks in the phone's memory.

1. When no WAP connection is in progress
  - Press **Menu**, select *Services* and then *Bookmarks*.

When a WAP connection is in progress

- Press **Options** and select *Bookmarks*.

2. Scroll to the bookmark you want to use and press **Options**.
3. Select one of the following options:

*Go to* to make a connection to the WAP page associated with the bookmark.

*Edit* or *Delete* to modify or delete the selected bookmark.

*Send* to send the selected bookmark to another phone via SMS.

*New bookmark* to create a new bookmark without connecting to a WAP service. Key in the address and the title of the WAP page and press **OK**.



Note that your phone may have some pre-installed bookmarks for sites not affiliated with Nokia. Nokia does not warrant or endorse these sites. If you choose to access them, you should take the same precautions, for security or content, as you would with any site.

## Receiving a bookmark

When you have received a bookmark from a compatible phone, press **Options** and select *View* to view the bookmark, *Save* to save the bookmark, or *Discard* to discard it.

## ■ Service inbox

The phone can receive service messages (pushed messages) sent by your service provider. Service messages are notifications of, for example, news headlines, and they may contain the address of a WAP service.

1. To access the service inbox when no WAP connection is in progress

When you have received a service message, *1 service message received* will be displayed. Press **View** to access the *Service inbox*.

If you press **Exit**, the message is moved to the *Service inbox*. To access the *Service inbox* later, press **Menu**, select *Services*, and then *Service inbox*.

When a WAP connection is in progress

Press **Options** and select *Service inbox*.

2. Scroll to the message you want and press **Options**.  
Select *Retrieve* to activate the browser and download the contents of the service message.  
Select *Details* to display detailed information about the service notification.  
Select *Delete* to delete the selected service notification.

## To set the phone to receive service messages

Press **Menu**, select *Services*, *Settings*, *Service inbox settings*, and *Service messages*. To set the phone to receive service messages, select *On*. If you select *Off*, the phone will not receive service messages.

## ■ The cache memory



**Note:** The information or services you have accessed are stored in the cache of your phone. A cache is a buffer memory, which is used to store data temporarily. If you have tried to access or have accessed confidential information requiring passwords (for example, your bank account), empty the cache of your phone after each use.

To clear the cache memory when no WAP connection is in progress

- Press **Menu**, select *Services* and *Clear the cache*.

To clear the cache memory when a WAP connection is in progress

- Press **Options** and select *Clear the cache*.

## ■ Security indicator

If the security indicator  is displayed during a WAP connection, the data transmission between the phone and the WAP gateway or WAP server (identified by the *IP address* setting in the *Edit active service settings* menu) is encrypted.

However, the security indicator does not indicate that the data transmission between the gateway and the content server (the location where the requested resource is stored) is secure. It is up to the service provider to secure the data transmission between the gateway and the content server.

## ■ Authority certificates

Authority certificates are used by some WAP services, such as banking services, for checking signatures, server certificates (used to determine the identity of the WAP server) or other authority certificates.

You can download the certificate from a WAP page, if the WAP service supports the use of authority certificates. After the download, you can view the certificate and then save or delete it. If you save the certificate, it is added to the certificate list on the phone.

## 7. Key features



**Note:** Your phone must be switched on to use these functions. Do not switch the phone on when wireless phone use is prohibited or when it may cause interference or danger.

### ■ Bluetooth

Bluetooth technology allows wireless connections between electronic devices. Since Bluetooth devices communicate using radio waves, your phone and the other Bluetooth device do not need to be in line of sight. The two devices only need to be within a maximum of 10 meters of each other, although the connection can be subject to interference from obstructions such as walls or other electronic devices.

There may be restrictions on using Bluetooth devices. Check with your local authorities.

You can use the Bluetooth to connect wirelessly to compatible Bluetooth accessories or computers with Bluetooth ability. In the Bluetooth menu, you can manage connections and define settings.

### Using Bluetooth

1. To activate Bluetooth, press **Menu**, select *Connectivity*, *Bluetooth* and *On*. The indicator  is displayed.

Using Bluetooth consumes the battery and the phone's operating time will be reduced. Take this into account when performing other operations with your phone.

2. The first time you use Bluetooth, the phone asks for a name for your phone. Accept the default name or change it. The name helps you to distinguish one Bluetooth device or accessory from another.
3. Press **Menu**, select *Connectivity*, *Bluetooth* and *Search for audio accessories* to start looking for a Bluetooth accessory to connect to. The found devices appear on a list of Bluetooth accessories one by one starting from the device which was found first. To end the inquiry, press **Stop**.

4. Scroll to the device you want and press **Select**. When the connection has been established, the device shows *Connected to* followed by the device's name, and the indicator (📶). You can have only one active Bluetooth connection at a time.

- If your phone requests a pairing, you should give a passcode. The passcode is fixed for accessories and supplied with the accessory, but with other devices you can create your own passcode. For pairing, both Bluetooth devices must use the same passcode. Note that you can use a different passcode each time you make a connection.

5. To view the currently active device and close the connection to it, press **Menu**, select *Bluetooth* and *View active device*.

## Bluetooth settings

Press **Menu**, select *Connectivity*, *Bluetooth* and *Bluetooth settings*. Select

- *My phone's visibility*, to change the way the phone is visible to other Bluetooth devices. *Hidden* makes your phone respond only to devices it has been paired with.

- *My phone's name* to change your phone's Bluetooth device name, which is shown to other Bluetooth equipment.

## Pairing settings

To view the list of paired devices, press **Menu**, select *Connectivity*, *Bluetooth* and *View paired devices*. The oldest pairing is at the top of the list. When you press **Options**, some of the following options may be available, depending on the status of the device or connection:

- *Connect* to connect to the indicated accessory.
- *Assign short name*, to give a name (visible to you only) to the paired device.
- *Delete pairing* to remove the selected device from the list.
- *Request conn. authorisation* to define whether the connection from the paired device is established automatically (*No*) or whether the phone asks permission before connecting (*Yes*).

## ■ Infrared

You can set up the phone to receive data through its infrared (IR) port. To use an IR connection, the device with which you want to establish a connection must be IrDA compliant. You can send or receive data such as business cards and calendar notes to or from a compatible phone or data device (for example, a computer) via the IR port of your phone.



Do not point the IR (infrared) beam at anyone's eye or allow it to interfere with other IR devices. This device is a Class 1 Laser product.

### Sending and receiving data via IR

- Ensure that the IR ports of the sending and receiving devices are pointing at each other and that there are no obstructions between the devices. The preferable distance between the two devices in an infrared connection is one metre at most.
- To activate the IR port of your phone to receive data via IR, press **Menu**, **Connectivity**, and select **Infrared**.
- The user of the sending phone selects the desired IR function to start data transfer.

If data transfer is not started within two minutes after the activation of the IR port, the connection is cancelled and has to be started again.

### IR connection indicator

- When  is shown continuously, the IR connection is activated and your phone is ready to send or receive data via its IR port.
- When  blinks, your phone is trying to connect to the other device or a connection has been lost.

## ■ PC connectivity

You can send and receive e-mails, and access the Internet when your phone is connected to a compatible PC via an IR connection or bluetooth. You can use your phone with a variety of PC connectivity and data communications applications. With the PC suite you can, for example, send text and picture messages, synchronise contacts, calendar and to-do notes between your phone and the PC and manage your WAP bookmarks and connection sets.

You may find more information and downloadable files on the Nokia website, [www.nokia.com/support/phones/8910i](http://www.nokia.com/support/phones/8910i).

## PC Suite

The PC Suite contains the following applications:

- **Nokia Application Installer** to install Java applications from the PC to the phone.
- **Nokia Image Converter** to make images usable for multimedia messages, for wallpaper or operator logos and to transfer them to your phone.
- **Nokia PC Composer** to create monophonic ringing tones for previous compatible Nokia phone models, for example, the Nokia 8310.
- **Nokia Content Copier** to copy data or back-up data from your phone to a PC or to another Nokia phone.
- **Nokia PC WAP Manager** to edit and send your WAP bookmarks or update the connection sets to your phone.
- **Nokia Phone Editor** to send text messages and edit the phone book, profiles and message settings of your phone.
- **Nokia PC Sync** to synchronise the phone book, calendar and to-do notes between your phone and PC.

- **Nokia PC Graphics** to create and edit picture messages for previous compatible Nokia phone models, for example, the Nokia 8310.
- **Nokia 8910i data modem drivers** enable you to use your phone as a modem.
- **Nokia Modem Options** contains settings for HSCSD and GPRS connections.
- **Nokia Connection Manager** to select the connection type between the PC and the phone.

## GPRS and HSCSD

With your phone you can use GPRS (General Packet Radio Service) and HSCSD (High Speed Circuit Switched Data) high-speed data services.

For availability and subscription to high-speed data services, contact your network operator or service provider.

Note that the use of HSCSD service consumes the phone's battery faster than normal voice or data calls. You may need to connect the phone to a charger for the duration of data transfer.



## Using data communication applications

For information on using a data communication application, refer to the documentation provided with it.

1. If you use an IR connection:  
Activate the IR connection in the phone, see "[Infrared](#)" on page 51. Make sure that the connection is active in your PC.
2. Start using the data communications application on the computer.

Note that making or answering phone calls during a computer connection is not recommended as it might disrupt the operation.

For better performance during data calls, place the phone on a stationary surface with the keypad facing downward. Do not move the phone by holding it in your hand during a data call.

## Calendar

The calendar helps you to keep track of reminders, calls that you need to make and birthdays. The phone will sound an alarm tone when the set date for an event has been reached if you have set an alarm for the note.

Press **Menu**, select *Organiser* and *Calendar*. Scroll to the day you want. If you want to see the day's notes, press **Options** and select *Day notes*. The note indicator is shown on the first line. You can view an individual note by scrolling to it in day view, then pressing **Options** and *View*. The week view shows four weeks at a time.





### Other options for the calendar views may include:

- Options for making a note or for sending a note directly to another phone's calendar or as a text message.
- Options for erasing, editing, moving, and repeating a note, and for copying a note to another day.
- *Settings* to set, for example the date, time, date format or time format. In the *Auto-delete* option, you can set the phone to automatically delete old notes after a specified time. However, the repeat notes, for example, birthday notes, will not be deleted.

## Making a calendar note

For keying in letters and numbers, see "Writing text" on page 20.

Press **Menu**, select *Organiser* and *Calendar*. Scroll to the date you want, press **Options** and select *Make a note*. Select one of the following note types:

-  *Meeting* - Key in the subject, or search for the name in the phone book, and press **Options** and *Save*. Then key in the location for the meeting and press **Options** and *Save*. If you wish, select *With tone* to set an alarm for the meeting.
-  *Memo* - Key in the note, press **Options** and select *Save*. Key in the end day for the note and press **OK**. To set the alarm for the note, select *With tone* or *Silent* (no alarm tone) and then set the alarm time.
-  *Reminder* - Key in the note, press **Options** and *Save*. Choose whether you want an alarm to sound as a reminder, and enter the time if you wish.
-  *Call* - Key in the phone number, and press **Options** and *Save*. You can also search for the number in the phone book by pressing **Options** and *Search*. Then key in a time for the call and press **OK**. If you wish, select *With tone* to set an alarm for the note and a time for the alarm.

-  *Birthday* - Key in the person's name (or search for it in the phone book by pressing **Options** and *Search*), press **Options** and *Save*. Then key in the year of birth and press **OK**. If you key in the year, the note shows the person's age after their name. If you wish, select *With tone* to set an alarm for the note, and a time for the alarm.

When a tone alert has been set, the indicator  is displayed when you view the notes.

## When the phone alarm activates for a note

The phone beeps and displays the note. When a call note is on the display, you can call the displayed number by pressing . To stop the alarm and view the note, press **View**. To stop the alarm without viewing the note, press **Exit**.

## Calculator

The calculator on your phone adds, subtracts, multiplies, divides, calculates the square and the square root and converts currency values.

This calculator has a limited accuracy and rounding errors may occur, especially in long divisions.

1. Press **Menu**, select *Extras* and *Calculator*.

- When '0' is displayed on the screen, key in the first number of the calculation, press **#** **⇨** for a decimal point.
  - Press **Options** and select *Add, Subtract, Multiply, Divide, Square, Square root, or Change sign*.
-  **Tip:** Alternatively, press **\*** **+** once to add, twice to subtract, three times to multiply or four times to divide.
- Key in the second number.
  - For the total, press **Options** and select *Equals*. Repeat steps 3 to 5 as many times as is necessary.
  - To start a new calculation, press and hold **Clear** first.

## Making a currency conversion

- Press **Menu**, select *Extras* and *Calculator*.
- To save the exchange rate, press **Options** and select *Exchange rate*. Select either of the displayed options. Key in the exchange rate, press **#** **⇨** for a decimal point and press **OK**. The exchange rate remains in the memory until you replace it with another one.
- To make the currency conversion, key in the amount to be converted, press **Options** and select *In domestic* or *In foreign*.

You can also make the currency conversion in standby mode. Key in the amount to be converted, press **Options** and select *In domestic* or *In foreign*.

## ■ To-do list

You can save a note for a task you have to do. The notes can be saved in priority order. You may be able to save up to 30 notes, but this depends on how long the notes are.

Press **Menu** and select *Organiser* and *To-do list*. Press **Options**, or scroll to the note you want and then press **Options**.

- Select *Add* to add a new note. Key in the subject for the note, press **Options** and select *Save*. Select the priority for the note, *High (1)*, *Medium (2)*, or *Low (3)*. The notes are listed first in priority order and then in alphabetical order. *Dictionary*, refer to "Using predictive text input" on page 21.
- The other options are erasing, editing, changing the priority level of the note (*Edit priority*), viewing, saving the note to the calendar or sending it as a text message. *Go to priority* lets you view the notes of a certain priority level.

## 8. Other functions



**Note:** Your phone must be switched on to use these functions. Do not switch the phone on when wireless phone use is prohibited or when it may cause interference or danger.

### ■ Countdown timer

Press **Menu**, select *Extras* and *Countdown timer*. Key in the alarm time in hours and minutes and press **OK** to start the countdown timer. If you like, you can write a note, which will be displayed when the time is reached, and press **OK**. When the timer is running, the indicator  is shown in standby mode.

If the alarm time is reached when the phone is in standby mode, the phone sounds a tone and flashes the note, or if a note has not been set, *Countdown time up*. Stop the alarm by pressing **OK**. If no key is pressed, the alarm stops after 30 seconds. Press **OK** to erase the note.

**To stop the countdown timer or to change the countdown time:**

Press **Menu**, select *Extras* and *Countdown timer*. Select *Change time* to set the timer again, or *Stop timer* to stop the timer.

### ■ Stopwatch

You can measure time and take intermediate times or lap times using the stopwatch. During timing, the other functions of the phone can be used.

Using the stopwatch consumes the battery and the phone's operating time will be reduced. Be careful not to let it run in the background when performing other operations with your phone.

### Timing and time splitting

1. Press **Menu**, select *Extras*, *Stopwatch*, and *Split timing*.

You can select *Continue* if the stopwatch was running in the background, for example, because of an incoming call.

2. Press **Start** to start timing. Press **Split** every time you want to take an intermediate time. The intermediate times are listed below the running time on the display. Scroll to view the times.
3. Press **Stop** to stop timing.
4. Press **Options** and select
  - *Start* to start the stopwatch again. The new time is added to the previous time.

- **Save** to save the time. Key in a name for the measured time and press **OK**. If no name is keyed in, the total time is used as the title.
- **Reset** to reset the time without saving it.

## Lap times

Press **Menu**, select *Extras*, *Stopwatch*, and *Lap timing*. Press **Start** to start the stopwatch and **Lap** to take a lap time. Press **Stop** to stop timing. Press **Options** and you can save or reset the lap times. Refer to "*Timing and time splitting*" on page 56.

## Viewing and erasing times

Press **Menu**, select *Extras* and *Stopwatch*.

If the stopwatch has not been reset, you can select *Show last* to view the most recently measured time. Select *View times* and a list of names or the final times of the time sets is shown. Select the time set you want to view.

To delete the saved times, press **Options** and select *Delete times*. Select *All at once* and press **OK**, or select *One by one* and scroll to the times you want to delete. Press **Delete** and press **OK**.

## Alarm clock

The alarm clock uses the time format set for the clock. The alarm clock works even when the phone is switched off.

Press **Menu**, select *Organiser* and *Alarm clock*. Key in the alarm time and press **OK**. To change the time after the alarm time has been set, select *On*.

Note that after you have set the alarm, you can switch off the phone, and it will still sound an alarm at the set time.

### When the alarm time expires

The phone will sound an alert tone, and *Alarm!* and the alarm time will flash on the display.

Press **Stop** to stop the alarm. If you let the alarm continue for a minute or press **Snooze**, the alarm stops for a few minutes and then resumes.

If the alarm time is reached while the phone is switched off, the phone switches itself on and starts sounding the alarm tone. If you press **Stop**, the phone asks whether you want to activate the phone for calls. Press **No** to switch off the phone or **Yes** to make and receive calls.



**Note:** Do not press **Yes** when wireless phone use is prohibited or when it may cause interference or danger.

## ■ Games

### Starting a game

Press **Menu**, select *Games* and *Select game*. Select the game you would like to play. If available for the game, select the game type and then *New game*.

You can read instructions on how to use the keys and how the game works by selecting *Instructions* from the submenu.

### Game services and game settings

Press **Menu**, select *Games* and *Game services* or *Settings*. Select

- *Game services* and the phone will try to connect to the WAP pages of Club Nokia using the currently active service settings.

If the connection fails, you may not be able to access Club Nokia from the WAP service whose connection settings are currently active. In this case, enter the *Services* menu and activate another set of service settings, see "[Making a connection to a WAP service](#)" on page 43. Try again to connect to Club Nokia.

For the availability of different WAP services, pricing and tariffs, contact your network operator and/or WAP service provider.

- *Settings* to set sounds, lights and vibrator, *Shakes*, for the game.

## ■ Applications



This menu allows you to manage the Java applications installed on your phone. Your phone software includes some Java applications specially designed for this Nokia phone. Various service providers offer other applications via WAP services. Before you can use one of these applications you have to download it to your phone.

### Launching an application

1. Press **Menu**, select *Applications* and *Select app*.
2. Scroll to an application or an application set (the name depends on the application).
3. Press **Options** and select *Open* or press . If the selection is a single application it will be launched.

Otherwise, a list of applications in the selected application set is displayed. To launch a single application, scroll to the desired application, press **Options** and select *Open*, or press .



**Tip:** If an application uses the entire display area, no selection key names will be displayed. Press the selection key  or  to view the options list. Then select one of the options or press **Back** to continue with the application.

### Other options available for an application or application set

- **Delete** to delete the application or application set from the phone.
- **Web access** to restrict the application from accessing the network. Select **Ask first** and the phone will ask for net access, **Allowed** to allow net access, or **Not allowed** not to allow net access.
- **Check version** to check if a new version of the application is available for download from the WAP service.
- **Web page** to provide further information or additional data for the application from an Internet page. This feature must be supported by the network. It is only shown if an Internet address has been included with the application.
- **Details** to give additional information about the application.

## Downloading an application

You can download new Java applications in different ways:

- Press **Menu**, select **Applications** and **App. services** and the list of WAP bookmarks is shown. For example, you may find an appropriate Java application on the Club Nokia WAP pages, see **"Bookmarks"** on page 46.
- Press **Menu** and select **Services** to find a WAP page from which to download an appropriate Java application. See **"Browsing the pages of a WAP service"** on page 43.
- Use the game download functionality, see **"Game services and game settings"** on page 58.
- Use the Java Application installer included in the PC Suite to download the applications to your phone.



Note that Nokia does not warrant for applications from non-Nokia sites. If you choose to download Java applications from them, you should take the same precautions, for security or content, as you would with any site.

Note that when downloading a game or an application, it may be saved in the **Games** menu instead of in the **Applications** menu.

## Memory status for applications

To view the amount of memory available for game and application installations, press **Menu**, select *Applications* and *Memory*. Note that the contents of the *Gallery* may affect the amount of memory available for applications.

## ■ SIM services

In addition to the functions available on the phone, your SIM card may provide additional services that you can access in Menu 12. Menu 12 is only shown if it is supported by your SIM card. The name and contents of the menu depend entirely on the service available.



**Note:** For availability, rates and information on using SIM services, contact your SIM card vendor, e.g. network operator, service provider or other vendor.

You can set the phone to show you the confirmation messages sent between your phone and the network when you are using SIM services by selecting the option *Yes* within the menu 4-3-5, *Confirm SIM service actions*.

Note that accessing these services may involve sending a text message or making a phone call for which you may be charged.



## 9. Battery information

### ■ Charging and Discharging

Your phone is powered by a rechargeable battery.

Note that a new battery's full performance is achieved only after two or three complete charge and discharge cycles!

The battery can be charged and discharged hundreds of times but it will eventually wear out. When the operating time (talk-time and standby time) is noticeably shorter than normal, it is time to buy a new battery.

Use only batteries approved by the phone manufacturer and recharge your battery only with the chargers approved by the manufacturer. Unplug the charger when not in use. Do not leave the battery connected to a charger for longer than a week, since overcharging may shorten its lifetime. If left unused a fully charged battery will discharge itself over time.

Temperature extremes can affect the ability of your battery to charge.

Use the battery only for its intended purpose.

Never use any charger or battery which is damaged.

Do not short-circuit the battery. Accidental short-circuiting can occur when a metallic object (coin, clip or pen) causes direct connection of the + and - terminals of the battery (metal strips on the battery) for example when you carry a spare battery in your pocket or purse. Short circuiting the terminals may damage the battery or the connecting object.

Leaving the battery in hot or cold places, such as in a closed car in summer or winter conditions, will reduce the capacity and lifetime of the battery. Always try to keep the battery between 15° C and 25° C. A phone with a hot or cold battery may temporarily not work, even when the battery is fully charged. Batteries' performance is particularly limited in temperatures well below freezing.

Do not dispose of batteries in a fire!

Dispose of batteries according to local regulations (e.g. recycling). Do not dispose of as household waste.

## 10. Genuine Accessories

A new extensive range of accessories are available for your phone. You can select the accessories that accomodates your specific communication needs.

Some of the accessories are described in detail below.

For availability of the accessories, please check with your local dealer. A few practical rules for accessories operation:

- Keep the accessories out of small children's reach.
- When you disconnect the power cord of any accessory, grasp and pull the plug, not the cord.
- Check regularly that all cellular phone equipment in a vehicle is mounted and operating properly.

Use only batteries, chargers and accessories approved by the phone manufacturer. The use of any other types may invalidate any approval or warranty applying to the phone, and may be dangerous.



### Battery

Type	Tech	Capacity	Talktime*	Standby*
BLB-2	Li-Ion	830 mAh	2 hrs 30 mins - 4 hrs 30 mins	150 hrs - 300 hrs

\* Variation in operation times may occur depending on SIM card, network and usage settings, usage style and environments.

### Indoor

#### Travel Charger (ACP-12)

Small, lightweight travel charger with multivoltage (100 - 240V) switcher technology. Provides easy and convenient way to charge the phone.

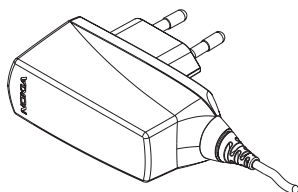

Note: The plug types vary according to different markets.

## Desktop Stand (DCV-4)

This Desktop Stand provides you with an ideal solution to charge your phone battery and keep the phone in a ready to use, ergonomic position. To charge, simply plug your charger into the stand and the wall outlet.



## HDC-5 Personal Headset Kit

The compact and functional personal Headset Kit with Remote Control. By using the remote control option, you can answer and end calls by pressing the button on the microphone part of the Personal Handsfree. A cost effective handsfree solution for indoor or outdoor use.



## Vehicle

### LCH-9 Mobile Charger

The multivoltage LCH-9 Mobile Charger, ensure your phone is always ready for use whenever you travel. This small charger's functional design fits most car lighters and interiors.

The charging time for the BLB-2 battery is about 1 hour 30 minutes, and you can use your phone freely during charging.

A green light indicates that the Mobile Charger is ready for charging. Check the charging status on the phone display. The input voltage can be 12 or 24 V DC, negative grounding.

Avoid prolonged charging with the Mobile Charger when the car engine is not running; this may cause the battery of your car to drain. Note also that in some cars the cigarette lighter plug is not provided with electricity if the ignition is switched off. Verify that the green LED light is on.

## 11. Care and Maintenance

Your phone is a product of superior design and craftsmanship and should be treated with care. The suggestions below will help you to fulfil any warranty obligations and to enjoy this product for many years.

- Keep the phone and all its parts and accessories out of the reach of small children.
- Keep the phone dry. Precipitation, humidity and all types of liquids or moisture can contain minerals that will corrode electronic circuits.
- Do not use or store the phone in dusty, dirty areas. Its moving parts can be damaged.
- Do not store the phone in hot areas. High temperatures can shorten the life of electronic devices, damage batteries, and warp or melt certain plastics.
- Do not store the phone in cold areas. When it warms up (to its normal temperature), moisture can form inside, which may damage electronic circuit boards.
- Do not attempt to open the phone. Non-expert handling may damage it.
- Do not drop, knock or shake the phone. Rough handling can break internal circuit boards.

- Do not use harsh chemicals, cleaning solvents, or strong detergents to clean the phone.
- Do not paint the phone. Paint can clog the moving parts and prevent proper operation.
- Use only the supplied or an approved replacement antenna. Unauthorised antennas, modifications or attachments could damage the phone and may violate regulations governing radio devices.

All of the above suggestions apply equally to your phone, battery, charger or any accessory. If any of them is not working properly, take it to your nearest qualified service facility. The personnel there will assist you and, if necessary, arrange for service.

## 12. Important Safety Information

### ■ Traffic Safety

Do not use a hand-held telephone while driving a vehicle. Always secure the phone in its holder; do not place the phone on the passenger seat or where it can break loose in a collision or sudden stop.

Remember road safety always comes first!

### ■ Operating environment

Remember to follow any special regulations in force in any area and always switch off your phone whenever it is forbidden to use it, or when it may cause interference or danger.

Use the phone only in its normal operating positions.

Parts of the phone are magnetic. Metallic materials may be attracted to the phone, and persons with a hearing aid should not hold the phone to the ear with the hearing aid. Always secure the phone in its holder, because metallic materials may be attracted by the earpiece. Do not place credit cards or other magnetic storage media near the phone, because information stored on them may be erased.

### ■ Electronic devices

Most modern electronic equipment is shielded from radio frequency (RF) signals. However, certain electronic equipment may not be shielded against the RF signals from your wireless phone.

#### Pacemakers

Pacemaker manufacturers recommend that a minimum separation of 20 cm (6 inches) be maintained between a handheld wireless phone and a pacemaker to avoid potential interference with the pacemaker. These recommendations are consistent with the independent research by and recommendations of Wireless Technology Research. Persons with pacemakers:

- Should always keep the phone more than 20 cm (6 inches) from their pacemaker when the phone is switched on;
- Should not carry the phone in a breast pocket;
- Should use the ear opposite the pacemaker to minimise the potential for interference.
- If you have any reason to suspect that interference is taking place, switch off your phone immediately.

### Hearing aids

Some digital wireless phones may interfere with some hearing aids. In the event of such interference, you may want to consult your service provider.

### Other medical devices

Operation of any radio transmitting equipment, including cellular phones, may interfere with the functionality of inadequately protected medical devices. Consult a physician or the manufacturer of the medical device to determine if they are adequately shielded from external RF energy or if you have any questions. Switch off your phone in health care facilities when any regulations posted in these areas instruct you to do so. Hospitals or health care facilities may be using equipment that could be sensitive to external RF energy.

### Vehicles

RF signals may affect improperly installed or inadequately shielded electronic systems in motor vehicles (e.g. electronic fuel injection systems, electronic anti-skid (anti-lock) braking systems, electronic speed control systems, air-bag systems). Check with the manufacturer or its representative regarding your vehicle. You should also consult the manufacturer of any equipment that has been added to your vehicle.

### Posted facilities

Switch your phone off in any facility where posted notices so require.

### Potentially explosive atmospheres

Switch off your phone when in any area with a potentially explosive atmosphere and obey all signs and instructions. Sparks in such areas could cause an explosion or fire resulting in bodily injury or even death.

Users are advised to switch off the phone when at a refuelling point (service station). Users are reminded of the need to observe restrictions on the use of radio equipment in fuel depots (fuel storage and distribution areas), chemical plants or where blasting operations are in progress.

Areas with a potentially explosive atmosphere are often but not always clearly marked. They include below deck on boats; chemical transfer or storage facilities; vehicles using liquified petroleum gas (such as propane or butane); areas where the air contains chemicals or particles, such as grain, dust or metal powders; and any other area where you would normally be advised to turn off your vehicle engine.

### Vehicles

Only qualified personnel should service the phone, or install the phone in a vehicle. Faulty installation or service may be dangerous and may invalidate any warranty which may apply to the unit.

Check regularly that all wireless phone equipment in your vehicle is mounted and operating properly.

Do not store or carry flammable liquids, gases or explosive materials in the same compartment as the phone, its parts or accessories.

For vehicles equipped with an air bag, remember that an air bag inflates with great force. Do not place objects, including both installed or portable wireless equipment in the area over the air bag or in the air bag deployment area. If in-vehicle wireless equipment is improperly installed and the air bag inflates, serious injury could result.

Using your phone while in the air is prohibited. Switch off your phone before boarding an aircraft. The use of wireless telephones in an aircraft may be dangerous to the operation of the aircraft, disrupt the wireless telephone network and may be illegal.

Failure to observe these instructions may lead to suspension or denial of telephone services to the offender, or legal action or both.

## ■ Emergency calls





### Important:

This phone, like any wireless phone, operates using radio signals, wireless and landline networks as well as user-programmed functions. Because of this, connections in all conditions can not be guaranteed. Therefore, you should never rely solely upon any wireless phone for essential communications (e.g. medical emergencies).

Emergency calls may not be possible on all wireless phone networks or when certain network services and/or phone features are in use. Check with local service providers.

### To make an emergency call:

1. If the phone is not on, switch it on.  
Check for adequate signal strength.  
Some networks may require that a valid SIM card is properly inserted in the phone.
2. Press  as many times as needed (e.g. to exit a call, to exit a menu, etc.) to clear the display and ready the phone for calls.
3. Key in the emergency number for your present location (e.g. 112 or other official emergency number).  
Emergency numbers vary by location.
4. Press the  key.

If certain features are in use, you may first need to turn those features off before you can make an emergency call. Consult this guide and your local cellular service provider.

When making an emergency call, remember to give all the necessary information as accurately as possible. Remember that your wireless phone may be the only means of communication at the scene of an accident – do not cut off the call until given permission to do so.

### ■ Certification information (SAR)

#### THIS MODEL PHONE MEETS REQUIREMENTS FOR EXPOSURE TO RADIO WAVES

Your mobile phone is a radio transmitter and receiver. It is designed and manufactured not to exceed the limits for exposure to radio frequency (RF) recommended by international guidelines (ICNIRP). These limits are part of comprehensive guidelines and establish permitted levels of RF energy for the general population. The guidelines were developed by independent scientific organisations through periodic and thorough evaluation of scientific studies. The guidelines include a substantial safety margin designed to assure the safety of all persons, regardless of age and health.

The exposure standard for mobile phones employs a unit of measurement known as the Specific Absorption Rate, or SAR. The SAR limit stated in the international guidelines is 2.0 W/kg\*. Tests for SAR are conducted using standard operating positions with the phone transmitting at its highest certified power level in all tested frequency bands. Although the SAR is determined at the highest certified power level, the actual SAR of the phone while operating can be well below the maximum value. This is because the phone is designed to operate at multiple power levels so as to use only the power required to reach the network. In general, the closer you are to a base station, the lower the power output of the phone.

The highest SAR value for this model phone when tested for use at the ear is 0.43 W/kg. While there may be differences between the SAR levels of various phones and at various positions, they all meet the relevant international guidelines for RF exposure.

\* The SAR limit for mobile phones used by the public is 2.0 watts/kilogram (W/kg) averaged over ten grams of body tissue. The guidelines incorporate a substantial margin of safety to give additional protection for the public and to account for any variations in measurements. SAR values may vary depending on national reporting requirements and the network band. For SAR information in other regions please look under product information at [www.nokia.com](http://www.nokia.com).



# Index

## A

- Access codes xiii
  - Barring password xiii
  - PIN code xiii
  - PIN2 code xiii
  - PUK and PUK2 codes xiii
  - Security code xiii
- Accessory settings 36
- Alarm clock 57
- answering a call 7
- Appearance settings of the WAP browser 45
- Applications 58
  - Downloading an application 59
  - Launching an application 58
  - Memory status for applications 60
- archive 25
- Authority certificates 48

## B

- Battery 62
  - Indoor 62
  - Vehicle 63
- Battery information 61
- Bluetooth 49
  - Bluetooth settings 50
  - Using Bluetooth 49
- Bookmarks 46
- Browsing the pages of a WAP service 43
  - General guidelines for using the phone keys 44
- business cards
  - sending and receiving 15

## C

- cache memory 47
- Calculator 54
  - currency conversion 55
- Calendar 53
  - Making a calendar note 54

- When the phone alarm activates for a note 54
- call functions 7
  - answering or rejecting an incoming call 7
  - conference call 10
  - options during a call 10
- Call register 8
  - Call counters and call timers 9
  - Dialled numbers 9
  - Erase recent calls lists 9
  - Missed calls and received calls 8
- call settings 11
- Call waiting 8
- Care and Maintenance 64
- Certification information (SAR) 68
- Charging and Discharging 61
- Charging the battery 4
- Chat 25
- conference call 10
- Copying phone books 15
- Countdown timer 56

## D

- Display settings 34
  - Colour schemes 35
  - Operator logo 35
  - Screen saver 35
  - Wallpaper 34
- Download settings 46
  - applications 59
  - games 58

## E

- Editing a name, number or text item 15
- e-mail
  - reading and replying 24
  - writing and sending 22
- Emergency calls 67
- Ending a WAP connection 45
- Erasing names and numbers 15
- Erasing text messages 25

## G

- Gallery 31
- Games 58
  - Game services and game settings 58
  - Starting a game 58
- Genuine Accessories 62

## H

- HDC-5 63

## I

- Important Safety Information 65
- Inbox and outbox folders 25
- Inbox, Outbox, Saved, and Sent items folders 30
- indicators 2
- Indoor 62
- Info messages 27
- Infrared 51
  - Sending and receiving data via IR 51
- Installing the SIM card and the battery 3

## K

- Key features 49
- Keypad lock (Keyguard) 5
- keys and connectors 1

## L

- LCH-9 63
- list of menu functions iv

## M

- Making a call 7
  - Making a call using the phone book 7
- Making a connection to a WAP service 43
- menu functions iv
- Message counter 27
- multimedia messages 27
  - inbox, outbox, saved and sent items folders 30
  - reading and replying 29
  - settings 30
  - writing and sending 28
- My folders and Archive folder 25

## O

- operator logo 35

## P

- Pairing settings 50
- PC connectivity 51
  - GPRS and HSCSD 52
  - PC Suite 52
  - Using data communication applications 53
- phone book 13
  - copying 15
  - editing a name, number or text item 15
  - erasing names and numbers 15
  - searching a name 14
  - settings 16
- Phone settings 33
  - Cell info display 33
  - Help text activation 34
  - Language 33
  - Network selection 34
  - Start-up tone 34
  - Welcome note 34
- predictive text input 20
- Profiles 17

## R

- Reading and replying to a message or an e-mail 24
- Redialling last number 7
- rejecting a call 7
- Restore factory settings 38

## S

- SAR value 68
- Saving names and phone numbers (Add name) 13
  - Saving multiple numbers and text items per name 13
- Searching for a name in the phone book 14
- Security indicator 48
- Security settings 37
- Sending and receiving a business card 15

- Service command editor 27
- Service inbox 47
- Service numbers 16
- services menu 39
- Setting up the phone for a WAP service 39
  - Keying in the service settings manually 40
  - Saving the service settings received as a text message 39
- settings
  - accessory settings 36
  - multimedia messages 30
  - security settings 37
  - text messages 26
- Settings for multimedia messages 30
- Shared memory 6
- SIM services 60
- Speed dialling 7
- Standby mode and essential indicators 2
- Stopwatch 56
  - Lap times 57
  - Timing and time splitting 56
- Switching the phone on and off 4

## T

- Templates 23
  - Inserting a picture into a text message 23
  - Inserting a text template into a message or an e-mail 23
- Text and multimedia messages 19
- Text message settings 26
- text messages
  - erasing 25
  - my folders and archive folder 25
  - predictive text input 20
  - reading and replying 24
  - settings 26
  - traditional text input 21
  - writing and sending 19
- Time and date settings 33
- To-do list 55
- Tones 18
- traditional text input 21

## U

- Using the menu 6

## V

- Vehicle 63
- Voice dialling 11
  - Adding a voice tag 12
  - Making a call using a voice tag 12
  - Replaying, changing or erasing a voice tag 13
- Voice mailbox 8

## W

- WAP 39
  - bookmarks 46
  - browser appearance settings 45
  - browsing 43
  - cache memory 47
  - connecting to a WAP service 43
  - download settings 46
  - ending connection 45
  - service inbox 47
  - service settings 39
  - setting up the phone 39
  - using the phone keys 44
- WAP services 39
- Writing and sending e-mails 22
- Writing and sending text messages 19
  - Options for sending text messages 20
- Writing compound words 21
- Writing text 20
  - predictive text input 21
  - Setting predictive text input on or off 20
  - Tips for writing text 22
  - traditional text input 21