

User's Guide for Nokia 7370

DECLARATION OF CONFORMITY

We, NOKIA CORPORATION declare under our sole responsibility that the product RM-70 is in conformity with the provisions of the following Council Directive: 1999/5/EC.

A copy of the Declaration of Conformity can be found from
http://www.nokia.com/phones/declaration_of_conformity/.

CE 434

Copyright © 2005 Nokia. All rights reserved.

Reproduction, transfer, distribution or storage of part or all of the contents in this document in any form without the prior written permission of Nokia is prohibited.

Nokia, Visual Radio, Nokia Connecting People, Xpress-on, and Pop-Port are trademarks or registered trademarks of Nokia Corporation. Other product and company names mentioned herein may be trademarks or tradenames of their respective owners.

Nokia tune is a sound mark of Nokia Corporation.

Bluetooth is a registered trademark of Bluetooth SIG, Inc.



Includes RSA BSAFE cryptographic or security protocol software from RSA Security.



Java is a trademark of Sun Microsystems, Inc.

This product is licensed under the MPEG-4 Visual Patent Portfolio License (i) for personal and noncommercial use in connection with information which has been encoded in compliance with the MPEG-4 Visual Standard by a consumer engaged in a personal and noncommercial activity and (ii) for use in connection with

MPEG-4 video provided by a licensed video provider. No license is granted or shall be implied for any other use. Additional information including that relating to promotional, internal and commercial uses may be obtained from MPEG LA, LLC. See <<http://www.mpegla.com>>.

Nokia operates a policy of continuous development. Nokia reserves the right to make changes and improvements to any of the products described in this document without prior notice.

Under no circumstances shall Nokia be responsible for any loss of data or income or any special, incidental, consequential or indirect damages howsoever caused.

The contents of this document are provided "as is". Except as required by applicable law, no warranties of any kind, either express or implied, including, but not limited to, the implied warranties of merchantability and fitness for a particular purpose, are made in relation to the accuracy, reliability or contents of this document. Nokia reserves the right to revise this document or withdraw it at any time without prior notice.

The availability of particular products may vary by region. Please check with the Nokia dealer nearest to you.

This device may contain commodities, technology or software subject to export laws and regulations from the US and other countries. Diversion contrary to law is prohibited.

Issue 2

Contents

For your safety	8	Make a call	22
General information	11	Speed dialing	22
Overview of functions	11	Enhanced voice dialing	22
Access codes.....	11	Answer or reject a call	23
Security code	11	Call waiting.....	23
PIN codes	11	Options during a call	23
PUK codes	12	4. Write text	25
Barring password	12	Predictive text input.....	25
Configuration settings		Traditional text input	26
service	12	5. Navigate the menus	27
Download content and		6. Messaging	28
applications	12	Text messages (SMS).....	28
Nokia support and contact		Write and send a SMS message..	28
information.....	13	Read and reply to an SMS	
1. Get started	14	message.....	29
Install SIM card and battery....	14	SIM messages.....	29
Charge the battery	14	Multimedia messages (MMS)...	30
Open and close the phone.....	15	Write and send a MMS message	30
Switch the phone on and off...	16	Message sending	31
Set the time, time zone,		Cancel message sending.....	31
and date	16	Read and reply to a MMS	
Plug and play service.....	16	message.....	32
Antenna	16	Memory full.....	32
Phone strap.....	17	Folders	32
2. Your phone	18	Flash messages.....	33
Keys and parts	18	Write a flash message.....	33
Standby mode	19	Receive a flash message.....	33
Display	19	Nokia Xpress audio	
Active standby.....	19	messaging.....	33
Shortcuts in the standby mode...	20	Create an audio message	34
Indicators.....	20	Receive an audio message.....	34
Keypad lock (keyguard)	21	Instant messaging (IM).....	34
3. Call functions	22	Access the IM menu	35
		Connect to the IM service.....	35

Start an IM session.....	35	Settings	49
Accept or reject an invitation	36	Groups	49
Read a received instant message	37	Speed dials	49
Participate in a conversation.....	37	Info, service, and my numbers	50
Edit your availability status	37	8. Call log	51
Contacts for IM	38	9. Settings	52
Block and unblock messages	38	Profiles.....	52
Groups.....	38	Themes.....	52
E-mail application	39	Tones	52
Write and send an e-mail.....	39	Display	53
Download e-mail.....	39	Standby mode settings.....	53
Read and reply to e-mail	40	Screen saver	53
Inbox and Other folders	40	Power saver	53
Delete e-mail messages	40	Font size	53
Voice messages.....	40	Time and date.....	54
Info messages	41	My shortcuts.....	54
Service commands.....	41	Left selection key.....	54
Delete messages.....	41	Right selection key.....	54
Message settings	41	Navigation key.....	54
General settings	41	Enabling active standby.....	55
Text messages.....	42	Voice commands.....	55
Multimedia messages	42	Connectivity.....	55
E-mail messages.....	43	Bluetooth wireless technology....	55
7. Contacts	45	Set up a Bluetooth connection....	56
Search for a contact	45	Bluetooth wireless connection....	56
Save names and phone numbers.....	45	Bluetooth settings	57
Save details	45	Packet data (GPRS).....	57
Copy contacts.....	46	Modem settings.....	57
Edit contact details	46	Data transfer	58
Delete contacts	46	Data transfer with a compatible device	58
My presence	46	Synchronize from a compatible PC.....	59
Subscribed names.....	47	Synchronize from a server.....	59
Add contacts to the subscribed names	47	USB data cable	59
View the subscribed names.....	48	Call.....	60
Unsubscribe a contact.....	48	Phone	60
Business cards.....	48		

Enhancements	61	Download an application	75
Configuration	62	15. Web	77
Security	62	Set up browsing	77
Restore factory settings	63	Connect to a service	77
10. Operator menu	64	Browse pages	78
11. Gallery	65	Browse with phone keys	78
12. Media	66	Options while browsing	78
Camera	66	Direct calling	78
Take a snapshot	66	Bookmarks	79
Take a photo	66	Receive a bookmark	79
Record a video clip	67	Appearance settings	79
Camera filters	67	Security settings	80
Camera settings	67	Cookies	80
Media player	67	Scripts over secure connection ...	80
Configuration for a streaming		Download settings	80
service	67	Service inbox	80
Radio	68	Service inbox settings	81
Save radio frequencies	68	Cache memory	81
Listen to the radio	68	Browser security	81
Voice recorder	69	Security module	81
Record sound	69	Certificates	82
Stereo widening	70	Digital signature	82
13. Organizer	71	16. SIM services	84
Alarm clock	71	17. PC connectivity	85
Stop the alarm	71	Nokia PC Suite	85
Calendar	71	EGPRS, HSCSD, and CSD	85
Make a calendar note	72	Data communication	
Note alarm	72	applications	85
To-do list	72	18. Battery information	86
Notes	72	Charging and discharging	86
Countdown timer	73	Nokia battery authentication	
Stopwatch	73	guidelines	87
14. Applications	75	19. Genuine Enhancements	89
Launch a game	75	Power	89
Launch an application	75	Nokia Compact Charger AC-3	89
Some application options	75		

Audio	89
Fashion Stereo Headset HS-31	89
20. Care and maintenance ...	90
21. Additional safety	
information	91
Index	95

For your safety

Read these simple guidelines. Not following them may be dangerous or illegal. Read the complete user guide for further information.



SWITCH ON SAFELY

Do not switch the phone on when wireless phone use is prohibited or when it may cause interference or danger.



ROAD SAFETY COMES FIRST

Obey all local laws. Always keep your hands free to operate the vehicle while driving. Your first consideration while driving should be road safety.



INTERFERENCE

All wireless phones may be susceptible to interference, which could affect performance.



SWITCH OFF IN HOSPITALS

Follow any restrictions. Switch the phone off near medical equipment.



SWITCH OFF IN AIRCRAFT

Follow any restrictions. Wireless devices can cause interference in aircraft.



SWITCH OFF WHEN REFUELLING

Do not use the phone at a refuelling point. Do not use near fuel or chemicals.



SWITCH OFF NEAR BLASTING

Follow any restrictions. Do not use the phone where blasting is in progress.



USE SENSIBLY

Use only in the normal position as explained in the product documentation. Do not touch the antenna unnecessarily.



QUALIFIED SERVICE

Only qualified personnel may install or repair this product.



ENHANCEMENTS AND BATTERIES

Use only approved enhancements and batteries. Do not connect incompatible products.



WATER-RESISTANCE

Your phone is not water-resistant. Keep it dry.



BACK-UP COPIES

Remember to make back-up copies or keep a written record of all important information stored in your phone.



CONNECTING TO OTHER DEVICES

When connecting to any other device, read its user guide for detailed safety instructions. Do not connect incompatible products.



EMERGENCY CALLS

Ensure the phone is switched on and in service. Press the end key as many times as needed to clear the display and return to the start screen. Enter the emergency number, then press the call key. Give your location. Do not end the call until given permission to do so.



Warning: To use any features in this device, other than the alarm clock, the device must be switched on. Do not switch the device on when wireless device use may cause interference or danger.

■ Network services

To use the phone you must have service from a wireless service provider. Many of the features in this device depend on features in the wireless network to function. These network services may not be available on all networks or you may have to make specific arrangements with your service provider before you can utilize network services. Your service provider may need to give you additional instructions for their use and explain what charges will apply. Some networks may have limitations that affect how you can use network services. For instance, some networks may not support all language-dependent characters and services. Your service provider may have requested that certain features be disabled or not activated in your device. If so, they will not appear on your device menu. Your device may also have been specially configured for your network provider. This configuration may include changes in menu names, menu order and icons. Contact your service provider for more information.

■ About your device

The wireless device described in this guide is approved for use on the EGSM 900 and GSM 1800 and 1900 networks. Contact your service provider for more information about networks.

When using the features in this device, obey all laws and respect the privacy and legitimate rights of others.

When taking and using images or video clips, obey all laws and respect local customs as well as privacy and legitimate rights of others.

This device supports WAP 2.0 protocols (HTTP and SSL) that run on TCP/IP protocols. Some features of this device, such as multimedia messaging (MMS), browsing, e-mail application, instant messaging, presence enhanced contacts, remote synchronization, and content downloading using the browser or MMS, require network support for these technologies.

■ Shared memory

The following features in this device may share memory: gallery, contacts, text messages, multimedia messages, and instant messages, e-mail, calendar, to-do notes, Java™ games and applications, and note application. Use of one or more of these features may reduce the memory available for the remaining features sharing memory. For example, saving many Java applications may use all of the available memory. Your device may display a message that the memory is full when you try to use a shared memory feature. In this case, delete some of the information or entries stored in the shared memory features before continuing. Some of the features, such as text messages, may have a certain amount of memory specially allotted to them in addition to the memory shared with other features.

■ Enhancements

A few practical rules about accessories and enhancements

- Keep all accessories and enhancements out of the reach of small children.
- When you disconnect the power cord of any accessory or enhancement, grasp and pull the plug, not the cord.
- Check regularly that enhancements installed in a vehicle are mounted and are operating properly.
- Installation of any complex car enhancements must be made by qualified personnel only.

General information

■ Overview of functions

Your phone provides many functions that are practical for daily use, such as a text and multimedia messaging, a calendar, a clock, an alarm clock, a radio, and a built-in camera. Your phone also supports the following functions:

- Plug and play online service to get the configuration settings. See ["Plug and play service"](#) p. 16, and ["Configuration"](#) p. 62.
- Active standby. See ["Active standby"](#) p. 19.
- Audio messaging. See ["Nokia Xpress audio messaging"](#) p. 33.
- Instant messaging. See ["Instant messaging \(IM\)"](#) p. 34.
- E-mail application. See ["E-mail application"](#) p. 39.
- Enhanced voice dialing. See ["Enhanced voice dialing"](#) p. 22 and ["Voice commands"](#) p. 55.
- Presence-enhanced contacts. See ["My presence"](#) p. 46.
- Java 2 Platform, Micro Edition (J2ME™). See ["Applications"](#) p. 75.

■ Access codes

Security code

The security code (5 to 10 digits) helps to protect your phone against unauthorized use. The preset code is 12345. To change the code, and to set the phone to request the code, see ["Security"](#) p. 62.

PIN codes

The personal identification number (PIN) code and the universal personal identification number (UPIN) code (4 to 8 digits) help to protect your SIM card against unauthorized use. See ["Security"](#) p. 62.

The PIN2 code (4 to 8 digits) may be supplied with the SIM card and is required for some functions.

The module PIN is required to access the information in the security module. See ["Security module"](#) p. 81.

The signing PIN is required for the digital signature. See ["Digital signature"](#) p. 82.

PUK codes

The personal unblocking key (PUK) code and the universal personal unblocking key (UPUK) code (8 digits) is required to change a blocked PIN code and UPIN code, respectively. The PUK2 code (8 digits) is required to change a blocked PIN2 code. If the codes are not supplied with the SIM card, contact your local service provider for the codes.

Barring password

The barring password (4 digits) is required when using the *Call barring service*. See "Security" p. 62.

■ Configuration settings service

To use some of the network services, such as mobile Internet services, MMS, Nokia Xpress audio messaging, or remote Internet server synchronization, your phone needs the correct configuration settings. You may be able to receive the settings directly as a configuration message. After receiving the settings you need to save them on your phone. The service provider may provide a PIN that is needed to save the settings. For more

information on availability, contact your network operator, service provider, nearest authorized Nokia dealer, or visit the support area on the Nokia Web site, www.nokia-asia.com/support.

When you have received the settings as a configuration message, and the settings are not automatically saved and activated, *Configuration settings received* is displayed.

To save the settings, select **Show > Save**. If the phone requests *Enter settings' PIN*;, enter the PIN code for the settings, and select **OK**. To receive the PIN code, contact the service provider that supplies the settings. If no settings are saved yet, these settings are saved and set as default configuration settings. Otherwise, the phone asks *Activate saved configuration settings?*

To discard the received settings, select **Exit** or **Show > Discard**.

■ Download content and applications

You may be able to download new content (for example, themes) to the phone (network service). Select the download function (for example, in the *Gallery* menu). To

access the download function, see the respective menu descriptions. For the availability of different services, pricing, and tariffs, contact your service provider.



Important: Use only services that you trust and that offer adequate security and protection against harmful software.

■ **Nokia support and contact information**

For the latest version of this guide, downloads, services and additional information related to your Nokia product, please visit www.nokia-asia.com/support or your local Nokia web site. You may also download free configuration settings such as MMS, GPRS, e-mail, and other services for your phone model at www.nokia-asia.com/phonesettings.

Should you still require assistance, please refer to www.nokia-asia.com/contactus.

To check for the nearest Nokia care center location for maintenance services, you may like to visit www.nokia-asia.com/repair.

1. Get started

■ Install SIM card and battery

Always switch the device off and disconnect the charger before removing the battery.

Keep all SIM cards out of the reach of small children.

For availability and information on using SIM card services, contact your SIM card vendor. This may be the service provider, network operator, or other vendor.

This device is intended for use with BL-4B battery.

The SIM card and its contacts can easily be damaged by scratches or bending, so be careful when handling, inserting, or removing the card.

To remove the back cover of the phone, press and slide the cover (1).

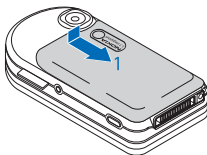

Remove the battery as shown (2). Slide (3) and open (4) the SIM card holder.

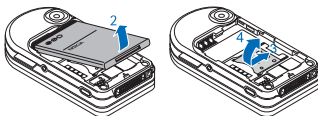

Insert the SIM card properly into the holder (5). Close the SIM card holder (6) and slide the holder to lock it (7).

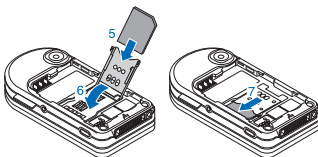

Replace the battery (8). Observe the battery contacts. Always use original Nokia batteries. See ["Nokia battery authentication guidelines"](#) p. 87. Slide the back cover into its place (9, 10).

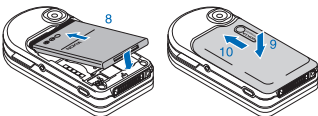

■ Charge the battery

Check the model number of any charger before use with this device. This device is intended for

use when supplied with power from an AC-3.



Warning: Use only batteries, chargers, and enhancements approved by Nokia for use with this particular model. The use of any other types may invalidate any approval or warranty, and may be dangerous.

For availability of approved enhancements, please check with your dealer. When you disconnect the power cord of any enhancement, grasp and pull the plug, not the cord.

1. Connect the charger to a wall socket.

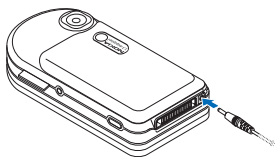

2. Connect the lead from the charger to the socket on the bottom of your phone.

If the battery is completely discharged, it may take a few minutes before the charging indicator appears on the display or before any calls can be made.

The charging time depends on the charger used. Charging a BL-4B

battery with the AC-3 charger takes approximately 2 hours and 20 minutes while the phone is in the standby mode.

■ Open and close the phone

To open the phone rotate the upper part to the right (1) or to the left until it snaps into place.

To close the phone, rotate the upper part down in the opposite direction (2).

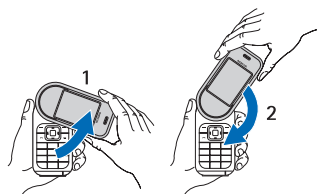

Important: When you open the phone, rotate the upper part 180 degrees to the left or right. Do not rotate the upper part more than 180 degrees. If you force the upper part more than 180 degrees in either direction, the phone will be damaged.

To switch off a tone that sounds when you open and close the phone, see ["Tones" p. 52](#).

■ Switch the phone on and off



Warning: Do not switch the phone on when wireless phone use is prohibited or when it may cause interference or danger.

Press and hold the power key. See "[Keys and parts](#)" p. 18.

If the phone asks for a PIN or a UPIN code, enter the code (displayed as ****), and select **OK**.

Set the time, time zone, and date

Enter the local time, select the time zone of your location in terms of the time difference with respect to Greenwich Mean Time (GMT), and enter the date. See "[Time and date](#)" p. 54.

Plug and play service

When you switch on your phone for the first time, and the phone is in the standby mode, you are asked to get the configuration settings from your service provider (network service). Confirm or decline the query. See "[Connect to serv. support](#)," p. 62, and "[Configuration settings service](#)" p. 12.

■ Antenna

Your device has an internal antenna.



Note: As with any other radio transmitting device, do not touch the antenna unnecessarily when the device is switched on. Contact with the antenna affects call quality and may cause the device to operate at a higher power level than otherwise needed. Avoiding contact with the antenna area when operating the device optimizes the antenna performance and the battery life.

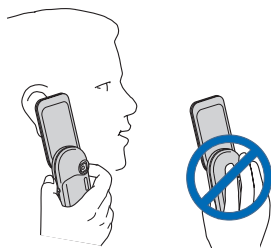

■ Phone strap

Thread the strap through the eyelet of the phone as shown in the picture and tighten it.

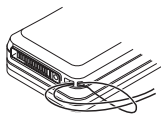

2. Your phone

■ Keys and parts

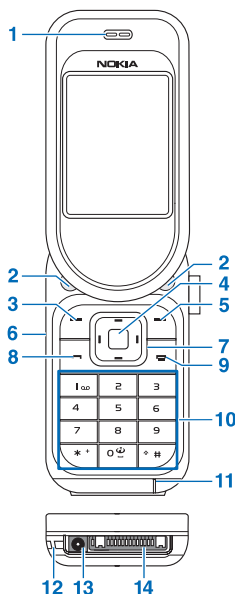

Note: The keymat may vary according to different markets.

- 1 Earpiece
- 2 Twin stereo speakers
- 3 Left selection key
- 4 Middle selection key
- 5 Right selection key
- 6 Volume key and zoom key

- 7 4-way navigation key
- 8 Call key
- 9 End key
- 10 Keypad
- 11 Microphone
- 12 Phone strap eyelet
- 13 Charger connector
- 14 Pop-Port™ connector
- 15 Camera lens
- 16 Power key
- 17 Camera key

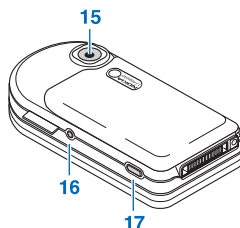

■ Standby mode

When the phone is ready for use, and you have not entered any characters, the phone is in the standby mode.

Display

- 1 Signal strength of the cellular network

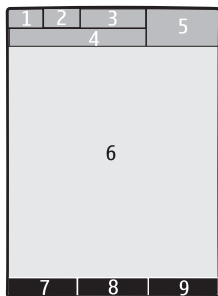

- 2 Battery charge status
- 3 Indicators
- 4 Name of the network or the operator logo
- 5 Clock
- 6 Main screen
- 7 Left selection key is **Go to** or a shortcut to another function. See "[Left selection key](#)" p. 54.
- 8 Middle selection key is **Menu**
- 9 Right selection key is **Names** or a shortcut to another function. See "[Right selection key](#)" p. 54. Operator variants may have an

operator-specific name to access an operator-specific Web site.

Active standby

In active standby mode you will have a list of selected phone features and information on the screen that you can directly access in the standby mode. To switch on the mode, select **Menu** > **Settings** > **Display** > **Standby mode settings** > **Active standby** > **My active standby**. In standby mode, scroll up or down to activate the navigation in the list. To start the feature, select **Select** or to display the information, select **View**. Left and right arrows at the beginning and end of a line indicate that further information is available by scrolling left or right. To end the active standby navigation mode, press **Exit**.

To organize and change the active standby mode, activate the navigation mode and select **Options** > **Active standby** > **My active standby** > **Options** and the following options:

Personalise – to assign or change phone features in the standby mode

Organise – to move the position of features in the standby mode

Enabling active standby— select keys to activate the standby navigation mode. To change the settings, see "*Enabling active standby*" p. 55.

To switch off the active standby mode select **Options** > *Active standby* > **Off** or **Menu** > *Settings* > *Display* > *Standby mode settings* > *Active standby* > **Off**.

Shortcuts in the standby mode

- To access the list of dialed numbers, press the call key once. Scroll to the number or name that you want; and to call the number, press the call key.
- To open the web browser, press and hold 0.
- To call your voice mailbox, press and hold 1.
- Use the navigation key as a shortcut. See "*My shortcuts*" p. 54.

Indicators



You have unread messages in the *Inbox* folder.



You have unsent, canceled or failed messages in the *Outbox* folder.



The phone registered a missed call.



Your phone is connected to the instant messaging service, and the availability status is online/offline.



You received one or several instant messages, and you are connected to the instant messaging service.



The keypad is locked.



The phone does not ring for an incoming call or text message.



The alarm clock is set to *On*.



The countdown timer is running.



The stopwatch is running in the background.



The phone is registered to the GPRS or EGPRS network.





A GPRS or EGPRS connection is established.

 The GPRS or EGPRS connection is suspended (on hold), for example, if there is an incoming or outgoing call during an EGPRS dial-up connection.

 A Bluetooth connection is active.



2 If you have two phone lines, the second phone line is selected.

 All incoming calls are diverted to another number.

 The loudspeakers are activated, or the music stand is connected to the phone.

 Calls are limited to a closed user group.

 The timed profile is selected.

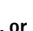
 ,  ,  , or  A headset, handsfree, loopset, or music stand enhancement is connected to the phone.

■ Keypad lock (keyguard)

To prevent the keys from being accidentally pressed, select **Menu**, and press * within 3.5 seconds to lock the keypad.

To unlock the keypad, select **Unlock**, and press * within 1.5 seconds. If the *Security keyguard* is set *On*, enter the security code if requested.

To answer a call when the keyguard is on, press the call key. When you end or reject the call, the keypad automatically locks.

For *Automatic keyguard* and *Security keyguard*, see "Phone" p. 60.

When the keyguard is on, calls still may be possible to the official emergency number programmed into your device.

3. Call functions

■ Make a call

1. Enter the phone number, including the area code.
For international calls, press * twice for the international prefix (the + character replaces the international access code), enter the country code, the area code without the leading 0, if necessary, and the phone number.
2. To call the number, press the call key.
3. To end the call or to cancel the call attempt, press the end key, or close the phone.

To search for a name or phone number that you have saved in *Contacts*, see "Search for a contact" p. 45. Press the call key to call the number.

To access the list of dialled numbers, press the call key once in the standby mode. To call the number, select a number or name, and press the call key.

Speed dialling

Assign a phone number to one of the speed-dialling keys, 2 to 9. See "Speed dials" p. 49. Call the

number in either of the following ways:

- Press a speed-dialling key, then the call key.
- If *Speed dialling* is set to *On*, press and hold a speed-dialling key until the call begins. See *Speed dialling* in "Call" p. 60.

Enhanced voice dialling

You can make a phone call by saying the name that is saved in the contact list of the phone. A voice command is added automatically to all entries in the contact list of the phone.

If an application is sending or receiving data using a packet data connection, end the application before you use voice dialling.

Voice commands are language-dependent. To set the language, see *Voice playback language* in "Phone" p. 60.



Note: Using voice tags may be difficult in a noisy environment or during an emergency, so you should not rely solely upon voice dialling in all circumstances.

1. In the standby mode, press and hold the right selection key. A short tone is played, and *Speak now* is displayed.

If you are using a compatible headset with the headset key, press and hold the headset key to start the voice dialing.

2. Say the voice command clearly. If the voice recognition was successful, a list with matches is shown. The phone plays the voice command of the match on the top of the list. After about 1.5 seconds, the phone dials the number; or if the result is not the correct one, scroll to another entry, and select to dial the entry.

Using voice commands to carry out a selected phone function is similar to voice dialing. See *Voice commands* in "My shortcuts" p. 54.

■ Answer or reject a call

To answer an incoming call, press the call key, or open the phone. To end the call, press the end key, or close the phone.

To reject an incoming call if the phone is open, press the end key or close the phone. To reject an

incoming call when the phone is closed, press the power key.

To mute the ringing tone, press the volume key, or select **Silence**.



Tip: If the *Divert if busy* function is activated to divert the calls (for example, to your voice mailbox), rejecting an incoming call also diverts the call. See "Call" p. 60.

If a compatible headset supplied with the headset key is connected to the phone, to answer and end a call, press the headset key.

Call waiting

To answer the waiting call during an active call, press the call key. The first call is put on hold. To end the active call, press the end key.

To activate the *Call waiting* function, see "Call" p. 60.

■ Options during a call

Many of the options that you can use during a call are network services. For availability, contact your network operator or service provider.

During a call, select **Options** and from the following options:

Call options are *Mute* or *Unmute*, *Contacts*, *Menu*, *Lock keypad*, *Record*, *Loudspeaker* or *Handset*.

Network services options are *Answer* and *Reject*, *Hold* or *Unhold*, *New call*, *Add to conference*, *End call*, *End all calls*, and the following:

Send DTMF — to send tone strings

Swap — to switch between the active call and the call on hold

Transfer — to connect a call on hold to an active call and disconnect yourself



Conference — to make a conference call that allows up to five persons to take part in a conference call



Private call — to discuss privately in a conference call



Warning: Do not hold the device near your ear when the loudspeaker is in use, because the volume may be extremely loud.

4. Write text

You can enter text (for example, when writing messages) using traditional or predictive text input. When you write text, text input indicators appear at the top of the display.  indicates traditional text input.  indicates predictive text input. Predictive text input allows you to write text quickly using the phone keypad and a built-in dictionary. You can enter a letter with a single keypress.  indicates predictive text input with *Word suggestions*. The phone predicts and completes the word before you enter all the characters.

 ,  , or  appears next to the text input indicator, indicating the character case. To change the character case, press #.

 indicates number mode. To change from the letter to number mode, press and hold #, and select *Number mode*.

To set the writing language while writing text, select **Options** > *Writing language*.

■ Predictive text input

To set predictive text input on, select **Options** > *Prediction settings* > *Prediction* > *On*.



Tip: To quickly set predictive text input on or off when writing text, press # twice, or select and hold **Options**.

To select the prediction input type, select **Options** > *Prediction settings* > *Prediction type* > *Normal* or *Word suggestions*.

1. Start writing a word using the 2 to 9 keys. Press each key only once for one letter. The phone displays * or the letter if it separately has a meaning as a word. The entered letters are displayed underlined.

If you selected *Word suggestions* as prediction type, the phone starts to predict the word you are writing. After you enter a few letters, and if these entered letters are not a word, the phone tries to predict longer words. Only the entered letters are displayed underlined.

To insert a special character, press and hold *, or select **Options** > *Insert symbol*. Scroll to a character, and select **Use**.

To write compound words, enter the first part of the word and confirm it by pressing the navigation key right. Write the next part of the word and confirm the word.

To enter a full stop, press 1.

2. When you finish writing the word and it is correct, to confirm it, press 0 to add space.

If the word is not correct, press * repeatedly, or select

Options > *Matches*. When the word that you want appears, select **Use**.

If the ? character is displayed after the word, the word you intended to write is not in the dictionary. To add the word to the dictionary, select **Spell**. Complete the word (traditional text input is used), and select **Save**.

Press a number key, 1 to 9, repeatedly until the desired character appears. Not all characters available under a number key are printed on the key. The characters available depend on the selected writing language.

If the next letter you want is located on the same key as the present one, wait until the cursor appears, or briefly press any of the navigation keys and enter the letter.

The most common punctuation marks and special characters are available under the 1 key. For more characters, press *.

■ Traditional text input

To set traditional text input on, select **Options** > *Prediction settings* > *Prediction* > *Off*.

5. Navigate the menus

The phone offers you an extensive range of functions, which are grouped into menus.

1. To access the menu, select **Menu**.

To change the menu view, select **Options** > *Main menu view* > *List*, *Grid*, *Grid with labels*, or *Tab*.

To rearrange the menu, scroll to the menu you want to move, and select **Options** > *Organise* > **Move**. Scroll to where you want to move the menu, and select **OK**. To save the change, select **Done** > **Yes**.

2. Scroll through the menu, and select an option (for example, *Settings*).
3. If the selected menu contains further submenus, select the one that you want (for example, *Call*).
4. If the selected menu contains further submenus, repeat step 3.
5. Select the setting of your choice.
6. To return to the previous menu level, select **Back**. To exit the menu, select **Exit**.

6. Messaging



You can read, write, send, and save text, multimedia, e-mail, audio, and flash messages. All messages are organized into folders.

■ Text messages (SMS)

With the short message service (SMS) you can send and receive text messages, and receive messages that can contain pictures (network service).

Before you can send any text or SMS e-mail message, you must save your message center number. See "Message settings" p. 41.

To check SMS e-mail service availability and to subscribe to the service, contact your service provider. To save an e-mail address in *Contacts*, see "Save details" p. 45.

Your device supports the sending of text messages beyond the character limit for a single message. Longer messages will be sent as a series of two or more messages. Your service provider may charge accordingly. Characters that use accents or other marks, and characters from some language options like

Chinese, take up more space limiting the number of characters that can be sent in a single message.

The message length indicator at the top of the display shows the total number of characters left and the number of messages needed for sending. For example, 673/2 means that there are 673 characters left and that the message will be sent as a series of two messages.

Write and send a SMS message

1. Select **Menu** > *Messaging* > *Create message* > *Text message*.
2. Enter the recipient's phone number in the *To:* field. To retrieve a phone number from *Contacts*, select **Add** > *Contact*. To send the message to multiple recipients, add the desired contacts one by one. To send the message to persons in a group, select *Contact group* and the desired group. To retrieve the contacts to which

you recently sent messages, select **Add** > *Recently used*.

3. Scroll down, and write your message in the *Message:* field. See "Write text" p. 25.

To insert a template into the message, select **Options** > *Use template*.

To see how the message will look to the recipient, select **Options** > *Preview*.

4. To send the message, select **Send**. See "Message sending" p. 31.

Read and reply to an SMS message

When you have received a message, *1 message received* or the number of new messages with *_ messages received* are shown.

1. To view a new message, select **Show**. To view it later, select **Exit**.

To read the message later, select **Menu** > *Messaging* > *Inbox*. If more than one message is received, select the message you want to read.  is shown if you have unread messages in *Inbox*.

2. To view the list of available options while reading a message, select **Options**.

3. To reply to a message, select **Reply** > *Text message*, *Multimedia*, *Flash message*, or *Audio message*.

To send a text message to an e-mail address, enter the e-mail address in the *To:* field.

Scroll down, and write your message in the *Message:* field. See "Write text" p. 25.

If you want to change the message type for your reply message, select **Options** > *Change message type*.

4. To send the message, select **Send**.

■ SIM messages

SIM messages are text messages that are saved to your SIM card. You can copy or move those messages to the phone memory, but not vice versa. Received messages are saved to the phone memory.

To read SIM messages, select **Menu** > *Messaging* > **Options** > *SIM messages*.

■ Multimedia messages (MMS)



Note: Only devices that have compatible features can receive and display multimedia messages. The appearance of a message may vary depending on the receiving device.

To check availability and to subscribe to the multimedia messaging network service, contact your service provider. See "[Multimedia messages](#)" p. 42.

A multimedia message can contain text, sound, pictures, video clips, a business card, and a calendar note. If the message is too large, the phone may not be able to receive it. Some networks allow text messages that include an Internet address where you can view the multimedia message.

You cannot receive multimedia messages during a call, or an active browsing session over GSM data. Because delivery of multimedia messages can fail for various reasons, do not rely solely upon them for essential communications.

Write and send a MMS message

The wireless network may limit the size of MMS messages. If the inserted picture exceeds this limit, the device may make it smaller so that it can be sent by MMS.

1. Select **Menu** > *Messaging* > *Create message* > *Multimedia*.
2. Enter your message.
Your phone supports multimedia messages that contain several pages (slides). A message can contain a calendar note and a business card as attachments. A slide can contain text, one image, and one sound clip; or text and a video clip. To insert a slide in the message, select **New**; or select **Options** > *Insert* > *Slide*.
To insert a file in the message, select **Insert**; or **Options** > *Insert*.
3. To view the message before sending it, select **Options** > *Preview*.
4. To send the message, select **Send**. See "[Message sending](#)" p. 31.
5. Enter the recipient's phone number in the *To:* field. To retrieve a phone number from

Contacts, select **Add** > *Contact*. To send the message to multiple recipients, add the desired contacts one by one. To send the message to persons in a group, select *Contact group* and the desired group. To retrieve the contacts to which you recently sent messages, select **Add** > *Recently used*.

Message sending

Copyright protections may prevent some images, music (including ringing tones), and other content from being copied, modified, transferred or forwarded.

When you finish writing your message, to send the message, select **Send**. The phone saves the message in the *Outbox* folder, and the sending starts. If you select *Save sent messages* > *Yes*, the sent message is saved in the *Sent items* folder. See "General settings" p. 41.



Note: When the phone is sending the message, the animated  is shown. This is an indication that the message has been sent by your device to the message center number programmed into your device. This is not an indication that the message has been received at the intended destination. For more details about messaging services, check with your service provider.

It takes more time to send a multimedia message than to send a text message. While the message is being sent, you can use other functions on the phone. If an interruption occurs while the message is being sent, the phone tries to resend the message a few times. If these attempts fail, the message remains in the *Outbox* folder. You can try to resend it later.

Cancel message sending

To cancel the sending of the messages in the *Outbox* folder, scroll to the desired message, and select **Options** > *Cancel sending*.

Read and reply to a MMS message



Important: Exercise caution when opening messages. Multimedia message objects may contain malicious software or otherwise be harmful to your device or PC.

When you receive a new multimedia message, *Multimedia message received* or the number of new messages with *_ messages received* is shown.

1. To read the message, select **Show**. To view it later, select **Exit**.
To read the message later, select **Menu** > *Messaging* > *Inbox*. Scroll to the message that you want to view, and select it.  is shown if you have unread messages in *Inbox*.
2. To view the whole message if the received message contains a presentation, select **Play**.
To view the files in the presentation or the attachments, select **Options** > *Objects* or *Attachments*.
3. To reply to the message, select **Options** > *Reply* > *Text*

message, *Multimedia*, *Flash message*, or *Audio message*. Write the reply message.

If you want to change the message type for your reply message, select **Options** > *Change message type*. The new message type may not support all the content that you have added.

4. To send the message, select **Send**. See "Message sending" p. 31.

■ Memory full

When you receive a message, and the memory for the messages is full, *Memory full. Unable to receive messages.* is shown. To first delete old messages, select **OK** > **Yes** and the folder. Scroll to the desired message, and select **Delete**. If one or more messages are marked, select **Mark**. Mark all the messages you want to delete, and select **Options** > *Delete marked*.

■ Folders

The phone saves received messages in the *Inbox* folder. Messages that have not yet been sent are saved in the *Outbox* folder.

To set the phone to save the sent messages in the *Sent items* folder, see *Save sent messages* in "General settings" p. 41.

To edit and send messages that you have written and saved in the *Drafts* folder, select **Menu** > *Messaging* > *Drafts*.

You can move your messages to the *Saved items* folder. To organize your *Saved items* subfolders, select **Menu** > *Messaging* > *Saved items*. To add a folder, select **Options** > *Add folder*. To delete or rename a folder, scroll to the desired folder, and select **Options** > *Delete folder* or *Rename folder*.

Your phone has templates. To create a new template, save a message as a template. To access the template list, select **Menu** > *Messaging* > *Saved items* > *Templates*.

■ Flash messages

Flash messages are text messages that are instantly displayed upon reception. Flash messages are not automatically saved.

Write a flash message

Select **Menu** > *Messaging* > *Create message* > *Flash message*.

Write your message. The maximum length of a flash message is 70 characters. To insert a blinking text into the message, select **Options** > *Insert blink character* to set a marker. The text behind the marker blinks until a second marker is inserted.

Receive a flash message

A received flash message is indicated with the text *Message:* and a few words from the beginning of the message. To read the message, select **Read**. To extract phone numbers, e-mail addresses, and Web site addresses from the current message, select **Options** > *Use detail*. To save the message, select **Save** and the folder in which you want to save it.

■ Nokia Xpress audio messaging

You can use the multimedia message service to create and send an audio message in a convenient way. Multimedia messaging service must be activated before you can use audio messages.

Create an audio message

1. Select **Menu** > *Messaging* > *Create message* > *Audio message*. The recorder opens. To use the recorder, see "*Voice recorder*" p. 69.
2. Speak your message.
3. Enter the recipient's phone number in the *To:* field. To retrieve a phone number from *Contacts*, select **Add** > *Contact*. To send the message to multiple recipients, add the desired contacts one by one. To send the message to persons in a group, select *Contact group* and the desired group. To retrieve the contacts to which you recently sent messages, select **Add** > *Recently used*.
4. To send the message, select **Send**.

Receive an audio message

When your phone receives an audio message, *1 audio message received* is displayed. To open the message, select **Play**; or if more than one message is received, select **Show** > **Play**. To listen to the message later, select **Exit**. To see the available options, select **Options**.

Instant messaging (IM)

Instant messaging (network service) is a way to send short, simple text messages to online users, delivered over TCP/IP protocols.

Before you can use instant messaging, you must subscribe to the service. To check the availability and costs, and to subscribe to the service, contact your network operator or service provider, from whom you also receive your unique ID, password, and settings.

To set the required settings for the instant messaging service, see *Connection settings* in "*Access the IM menu*" p. 35. The icons and texts on the display may vary, depending on the instant messaging service.

While you are connected to the instant messaging service, you can use the other functions of the phone, and the instant messaging conversation remains active in the background. Depending on the network, the active instant messaging conversation may consume the phone battery faster, and you may need to connect the phone to a charger.

Access the IM menu

To access the *Instant messages* menu while still offline, select **Menu** > *Messaging* > *Instant messages*. If more than one set of connection settings for instant messaging service is available, select the desired one. If there is only one set defined, it is selected automatically.

The following options are shown:

Login – to connect to the instant messaging service. To set the phone to automatically connect to the instant messaging service when you switch the phone on, select **Menu** > *Messaging* > *Instant messages*, connect to the instant messaging service, and select *My settings* > *Automatic login* > *On phone start-up*.

Saved conversations – to view, erase, or rename the conversations that you saved during an instant messaging session

Connection settings – to edit the settings needed for messaging and presence connection

Connect to the IM service

To connect to the instant messaging service, access the *Instant messages* menu, and select the desired instant



messaging service if needed and *Login*. When the phone has successfully connected, *Logged in* is displayed.



To disconnect from the instant messaging service, select *Logout*.

Start an IM session

Open the *Instant messages* menu, and connect to the service. Start the service in different ways:

- Select *Conversations* to view the list of new and read instant messages or invitations for instant messaging during the active conversation. Scroll to a message or an invitation, and select **Open**.

 indicates new and  read instant messages.

 indicates new and  read group messages.

 indicates invitations.

The icons and texts on the display may vary, depending on the instant messaging service.

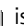
- Select *IM contacts* to view the contacts that you have added. Scroll to the contact with whom you would like to chat, and select **Chat**, or if  is shown next to a contact, select **Open**.

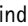
 indicates an online contact and  an offline contact in the contact memory of the phone.

 indicates a blocked contact. See ["Block and unblock messages"](#) p. 38.

 indicates that you have received a new message from a contact.

You can add contacts to the list. See ["Contacts for IM"](#) p. 38.

- Select [Groups](#) > [Public groups](#) (dimmed if groups are not supported by the network) to view the list of bookmarks to public groups provided by the network operator or service provider. To start a conversation, scroll to a group, and select **Join**. Enter the screen name that you want to use as a nickname in the conversation. When you have successfully joined the group conversation, you can start a group conversation. You can also create a private group. See ["Groups"](#) p. 38.
- Select [Search](#) > [Users](#) or [Groups](#) to search for other instant messaging users or public groups on the network by phone number, screen name,

e-mail address, or name. If you select [Groups](#), you can search for a group by a member in the group or by group name, topic, or ID.

To start the conversation when you have found the user or the group that you want, select [Options](#) > [Chat](#) or [Join group](#).

- Start a conversation from [Contacts](#). See ["View the subscribed names"](#) p. 48.

Accept or reject an invitation

In the standby mode, when you are connected to the instant messaging service and you receive a new invitation, [New invitation received](#) is displayed. To read it, select **Read**. If more than one invitation is received, scroll to an invitation, and select **Open**.

To join the private group conversation, select **Accept**. Enter the screen name that you want to use as a nickname in the conversation.

To reject or delete the invitation, select [Options](#) > [Reject](#) or [Delete](#). You can write an explanation for the rejection.

Read a received instant message

In the standby mode, when you are connected to the instant messaging service and you receive a new message that is not a message associated with an active conversation, *New instant message* is displayed. To read it, select **Read**.

If more than one message is received, the number of messages, followed by *_ new instant messages*, is displayed. Select **Read**, scroll to a message, and select **Open**.

New messages received during an active conversation are held in *Instant messages > Conversations*. If you receive a message from someone who is not in *IM contacts*, the sender ID is displayed. If the sender is in the phone memory and the phone recognizes it, the name of the person is displayed. To save a new contact that is not in the phone memory, select **Options > Save contact**.

Participate in a conversation

To join or start a conversation, select **Write** or start writing.



Write your message. To send it, select **Send**, or press the call key. The message stays on the display, and the reply message appears below your message.

Edit your availability status

1. Open the *Instant messages* menu, and connect to the instant messaging service.
2. To view and edit your own availability information or screen name, select *My settings*.
3. To allow all the other instant messaging users to see when you are online, select *Availability > Available for all*.

To allow only the contacts on your instant messaging contact list to see when you are online, select *Availability > Available for contacts*.

To appear as being offline, select *Availability > Appear offline*.

When you are connected to the instant messaging service,  indicates that you are online and  that you are not visible to others.

Contacts for IM

To add contacts to the instant messaging contacts list, connect to the instant messaging service, and select **IM contacts**. To add a contact to the list, select

Options > **Add contact** or **Add** (if you have no contacts added) > *Enter ID manually, Search from server, Copy from server, or By mobile number.*

Scroll to a contact. To start a conversation, select **Chat** or **Options** and from the available options.

Block and unblock messages

To block messages, connect to the instant messaging service, and select **Conversations** > **IM contacts**, or join or start a conversation. Scroll to the contact from whom you want to block incoming messages, and select **Options** > **Block contact** > **OK**.

To unblock messages, connect to the instant messaging service, and select **Blocked list**. Scroll to the contact from whom you want to unblock the messages, and select **Unblock**.

Groups

You can create your own private groups for an instant messaging conversation, or use the public groups provided by the service provider. The private groups exist only during an instant messaging conversation. The groups are saved on the server of the service provider. If the server you are logged into does not support group services, all group-related menus are dimmed.

Public groups

You can bookmark public groups that your service provider may maintain. Connect to the instant messaging service, and select **Groups** > **Public groups**. Scroll to a group with which you want to chat, and select **Join**. If you are not in the group, write your screen name as your nickname for the group. To delete a group from your group list, select **Options** > **Delete group**.

To search for a group, select **Groups** > **Search groups**. You can search for a group by a member in the group or by group name, topic, or ID.

Create a private group

Connect to the instant messaging service, and select **Groups** > **Create group**. Enter the name for

the group and the screen name that you want to use. Mark the private group members in the contacts list, and write an invitation.

■ E-mail application

The e-mail application uses EGPRS (network service) to allow you to access your e-mail account from your phone when you are not in the office or at home. This e-mail application is different from the SMS e-mail function. To use the e-mail function on your phone, you need a compatible e-mail system.

Your phone supports POP3, IMAP4, and SMTP e-mail servers. Before you can send and retrieve any e-mail, you may need to do the following:

- Obtain a new e-mail account or use your current account. For availability of your e-mail account, contact your e-mail service provider.
- For the settings required for e-mail, contact your e-mail service provider. You may receive the e-mail configuration settings as a configuration message. See "[Configuration settings service](#)" p. 12. You can also

enter the settings manually. See "[Configuration](#)" p. 62.

To activate the e-mail settings, select **Menu** > *Messaging* > *Message settings* > *E-mail messages*. See "[E-mail messages](#)" p. 43.

This application does not support keypad tones.

Write and send an e-mail

1. Select **Menu** > *Messaging* > *E-mail* > *Create e-mail*.
2. Enter the recipient's e-mail address, a subject, and the e-mail message.

To attach a file to the e-mail, select **Options** > *Attach* and the file in *Gallery*.

3. Select **Send** > *Send now*.

Download e-mail

1. To access the e-mail application, select **Menu** > *Messaging* > *E-mail*.
2. To download e-mail messages that have been sent to your e-mail account, select *Retrieve*.

To download new e-mail messages and to send e-mail that has been saved in the *Outbox* folder, select **Options** > *Retrieve and send*.

To first download the headings of the new e-mail messages that have been sent to your e-mail account, select **Options** > *Check new e-mail*. Then, to download the selected e-mail, mark the desired ones, and select **Options** > *Retrieve*.

3. Select the new message in *Inbox*. To view it later, select **Back**.  indicates an unread message.

Read and reply to e-mail



Important: Exercise caution when opening messages. E-mail messages may contain malicious software or otherwise be harmful to your device or PC.

1. Select **Menu** > *Messaging* > *E-mail* > *Inbox* and the desired message.
2. To reply to an e-mail, select **Reply** > *Empty screen* or *Original text*. To reply to many, select **Options** > *Reply to all*. Confirm or edit the e-mail address and subject; then write your reply.
3. To send the message, select **Send** > *Send now*.

Inbox and Other folders

Your phone saves e-mail that you have downloaded from your e-mail account in the *Inbox* folder. *Other folders* contains the following folders: *Drafts* for saving unfinished e-mail, *Archive* for organizing and saving your e-mail, *Outbox* for saving e-mail that has not been sent, and *Sent items* for saving e-mail that has been sent.

To manage the folders and their e-mail content, select **Options** > *Manage folder*.

Delete e-mail messages

Select **Menu** > *Messaging* > *E-mail* > **Options** > *Manage folder* and the desired folder. Mark the messages that you want to delete, and select **Options** > *Delete*.

Deleting an e-mail from your phone does not delete it from the e-mail server. To set the phone to delete the e-mail also from the e-mail server, select **Menu** > *Messaging* > *E-mail* > **Options** > *Extra settings* > *Leave copy:* > *Delete retrieved msgs*.

Voice messages

The voice mailbox is a network service and you may need to

subscribe to it. For more information and for your voice mailbox number, contact your service provider.

To call your voice mailbox, select **Menu** > *Messaging* > *Voice messages* > *Listen to voice messages*. To enter, search for, or edit your voice mailbox number, select *Voice mailbox number*.

If supported by the network,  indicates new voice messages. To call your voice mailbox number, select **Listen**.

■ Info messages

With the *Info messages* network service, you can receive messages on various topics from your service provider. To check availability, topics, and the relevant topic numbers, contact your service provider.

■ Service commands

Select **Menu** > *Messaging* > *Service commands*. Write and send service requests (also known as USSD commands), such as activation commands for network services, to your service provider.

■ Delete messages

To delete messages, select **Menu** > *Messaging* > *Delete messages* > *By message* to delete single messages, *By folder* to delete all messages from a folder, or *All messages*. If a folder contains unread messages, the phone asks whether you want to delete them also.

■ Message settings

General settings

General settings are common for text and multimedia messages.

Select **Menu** > *Messaging* > *Message settings* > *General settings* and from the following options:

Save sent messages > *Yes* — to set the phone to save the sent messages in the *Sent items* folder

Overwriting in Sent items > *Allowed* — to set the phone to overwrite the old sent messages with the new ones when the message memory is full. This setting is shown only if you set *Save sent messages* > *Yes*.

Font size — to select the font size used in messages

Graphical smileys > *Yes* — to set the phone to replace character-based smileys with graphical ones

Text messages

The text message settings affect the sending, receiving, and viewing of text and SMS e-mail messages.

Select **Menu** > *Messaging* > *Message settings* > *Text messages* and from the following options:

Delivery reports > *Yes* — to ask the network to send delivery reports about your messages (network service)

Message centres > *Add centre* — to set the phone number and name of the message center that is required for sending text messages. You receive this number from your service provider.

Message centre in use — to select the message center in use

E-mail message centres > *Add centre* — to set the phone numbers and name of the e-mail center for sending SMS e-mails.

E-mail centre in use — to select the SMS e-mail message center in use

Message validity — to select the length of time for which the

network attempts to deliver your message

Messages sent via — to select the format of the messages to be sent: *Text*, *Paging*, or *Fax* (network service)

Use packet data > *Yes* — to set GPRS as the preferred SMS bearer

Character support > *Full* — to select all characters in the messages to be sent as viewed. If you select *Reduced*, characters with accents and other marks may be converted to other characters. When writing a message, you can check how the message will look to the recipient by previewing the message. See ["Write and send a SMS message"](#) p. 28.

Reply via same centre > *Yes* — to allow the recipient of your message to send you a reply using your message center (network service)

Multimedia messages

The message settings affect the sending, receiving, and viewing of multimedia messages.

You may receive the configuration settings for multimedia messaging as a configuration message. See ["Configuration settings service"](#) p. 12. You can also enter the

settings manually. See ["Configuration"](#) p. 62.

Select **Menu** > *Messaging* > *Message settings* > *Multimedia messages* and from the following options:

Delivery reports > *Yes* — to ask the network to send delivery reports about your messages (network service)

Default slide timing — to define the default time between slides in multimedia messages

Allow multimedia receipt. — to receive or block the multimedia message, select *Yes* or *No*. If you select *In home network*, you cannot receive multimedia messages when outside your home network. The default setting of the multimedia message service is generally *In home network*. The availability of this menu depends on your phone.

Incoming multim. msgs. — to allow the reception of multimedia messages automatically, manually after being prompted, or to reject the reception. This setting is not shown if *Allow multimedia receipt.* is set to *No*.

Allow adverts — to receive or reject advertisements. This setting is not shown if *Allow multimedia*

receipt. is set to *No*, or *Incoming multim. msgs.* is set to *Reject*.

Configuration settings > *Configuration* — only the configurations that support multimedia messaging are shown. Select a service provider, *Default*, or *Personal configuration* for multimedia messaging. Select *Account* and a multimedia messaging service account contained in the active configuration settings.

E-mail messages

The settings affect the sending, receiving, and viewing of e-mail.

You may receive the configuration settings for the e-mail application as a configuration message. See ["Configuration settings service"](#) p. 12. You can also enter the settings manually. See ["Configuration"](#) p. 62.

To activate the settings for the e-mail application, select **Menu** > *Messaging* > *Message settings* > *E-mail messages* and from the following options:

Configuration — Select the set that you want to activate.

Account — Select an account provided by the service provider.

My name — Enter your name or nickname.

E-mail address — Enter your e-mail address.

Include signature — You can define a signature that is automatically added to the end of your e-mail when you write your message.

Reply-to address — Enter the e-mail address to which you want the replies to be sent.

SMTP user name — Enter the name that you want to use for outgoing mail.

SMTP password — Enter the password that you want to use for outgoing mail.

Display terminal window — Select *Yes* to perform manual user authentication for intranet connections.

Incoming server type — Select *POP3* or *IMAP4*, depending on the type of e-mail system that you are using. If both types are supported, select *IMAP4*.

Incoming mail settings — Select available options for *POP3* or *IMAP4*.

7. Contacts



You can save names and phone numbers (contacts) in the phone memory and in the SIM card memory.

The phone memory may save contacts with additional details, such as various phone numbers and text items. You can also save an image for a limited number of contacts.

The SIM card memory can save names with one phone number attached to them. The contacts saved in the SIM card memory are indicated by .

■ Search for a contact

Select **Menu** > **Contacts** > **Names**. Scroll through the list of contacts, or enter the first characters of the name you are searching for.

■ Save names and phone numbers

Names and numbers are saved in the used memory. To save a name and phone number, select **Menu** > **Contacts** > **Names** > **Options** > **Add new contact**. Enter the last

name, first name, and the phone number.

■ Save details

In the phone memory for contacts you can save different types of phone numbers, and short text items per name. You can also select a tone or a video clip for a contact.

The first number you save is automatically set as the default number, and it is indicated with a frame around the number type indicator (for example, ). When you select a name from contacts (for example, to make a call), the default number is used unless you select another number.

1. Make sure that the memory in use is **Phone** or **Phone and SIM**. See "**Settings**" p. 49.
2. Search for the contact to which you want to add a detail, and select **Details** > **Options** > **Add detail**. Select from the options available.

To search for an ID from the server of your service provider if you have connected to the

presence service, select *User ID* > *Search*. See "My presence" p. 46. If only one ID is found, it is automatically saved. Otherwise, to save the ID, select **Options** > *Save*. To enter the ID, select *Enter ID manually*. Enter the ID, and select **OK** to save it.

■ Copy contacts

Search for the contact you want to copy, and select **Options** > *Copy*. You can copy names and phone numbers from the phone contact memory to the SIM card memory, or vice versa. The SIM card memory can save names with one phone number attached to them.

■ Edit contact details

Search for the contact you want to edit, and select **Details**. To edit a name, number, text item, or to change the image, select **Options** > *Edit*. To change the number type, scroll to the desired number, and select **Options** > *Change type*. To set the selected number as the default number, select *Set as default*. You cannot edit an ID when it is on the *IM contacts* or *Subscribed names* list.

■ Delete contacts

To delete all the contacts and the details attached to them from the phone or SIM card memory, select **Menu** > *Contacts* > *Delete all contacts* > *From phone memory* or *From SIM card*. Confirm with the security code.

To delete a contact, search for the desired contact, and select **Options** > *Delete contact*.

To delete a number, text item, or an image attached to the contact, search for the contact, and select **Details**. Scroll to the desired detail, and select **Options** > *Delete* and from the options available. Deleting an image or video clip from contacts does not delete it from *Gallery*.

■ My presence

With the presence service (network service) you can share your presence status with other users with compatible devices and access to the service, such as your family, friends, and colleagues. Presence status includes your availability, status message, and personal logo. Other users who have access to the service and who request your information are able to see your status. The requested information is shown in

Subscribed names in the viewers' *Contacts* menu. You can personalize the information that you want to share with others and control who can see your status.

Before you can use presence, you must subscribe to the service. To check the availability and costs, and to subscribe to the service, contact your network operator or service provider, from whom you also receive your unique ID, password, and the settings for the service. See "*Configuration*" p. 62.

While you are connected to the presence service, you can use the other functions of the phone, and the presence service is active in the background. If you disconnect from the service, your presence status is shown for a certain amount of time to viewers, depending on the service provider.

Select **Menu** > *Contacts* > *My presence* and from the following options:

Connect to 'My presence' or *Disconnect from service* — to connect to or disconnect from the service

View my presence > *Private presence* or *Public presence* — to view your presence status

Edit my presence > *My availability*, *My presence*

message, *My presence logo*, or *Show to* — to change your presence status

My viewers > *Current viewers*, *Private list*, or *Blocked list* — to view the persons who are subscribed to or blocked from your presence information

Settings > *Show pres. in standby*, *Connection type*, or *IM and my presence sett.*

■ Subscribed names

You can create a list of contacts whose presence status information you want to be aware of. You can view the information if it is allowed by the contacts and the network. To view these subscribed names, scroll through the contacts, or use the *Subscribed names* menu.

Ensure that the memory in use is *Phone* or *Phone and SIM*. See "*Settings*" page 49.

To connect to the presence service, select **Menu** > *Contacts* > *My presence* > *Connect to 'My presence'*.

Add contacts to the subscribed names

1. Select **Menu** > *Contacts* > *Subscribed names*. If you have

not connected to the presence service, the phone asks if you want to connect now.

2. If you have no contacts on your list, select **Add**. Otherwise, select **Options** > *Subscribe new*. Your list of contacts is shown.
3. Select a contact from the list. If the contact has a saved ID, the contact is added to the subscribed names list. If there is more than one ID, select one of them. After subscription to the contact, *Subscription activated* is shown.



Tip: To subscribe to a contact from the *Contacts* list, search for the contact you want, and select **Details** > **Options** > *Request presence* > *As subscription*.



If you only want to view the presence information but not to subscribe to a contact, select *Request presence* > *One time only*.

View the subscribed names

To view the presence information, see also "[Search for a contact](#)" p. 45.

1. Select **Menu** > *Contacts* > *Subscribed names*.

The status information of the first contact on the subscribed names list is displayed. The information that the person wants to make available to others may include text and an icon.

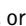
 ,  , or  indicates that the person is available, not visible to others, or not available.

 indicates that the person's presence information is not available.

2. Select **Options** > *View details* to view the details of the selected contact or **Options** > *Subscribe new*, *Send message*, *Send business card*, or *Unsubscribe*.

Unsubscribe a contact

To unsubscribe a contact from the *Contacts* list, select the contact and **Options** > *Unsubscribe* > **OK**.

To unsubscribe from the *Subscribed names* menu, see "[View the subscribed names](#)" p. 48.

Business cards

You can send and receive a person's contact information from

a compatible device that supports the vCard standard as a business card.

To send a business card, search for the contact whose information you want to send, and select

Details > **Options** > *Send business card* > *Via multimedia*, *Via text message*, or *Via Bluetooth*.

When you have received a business card, select **Show** > **Save** to save the business card in the phone memory. To discard the business card, select **Exit** > **Yes**.

■ Settings

Select **Menu** > *Contacts* > *Settings* and from the following options:

Memory in use — to select the SIM card or phone memory for your contacts. Select *Phone and SIM* to recall names and number from both memories. In that case, when you save names and numbers, they are saved in the phone memory.

Contacts view — to select how the names and numbers in *Contacts* are displayed

Name display — to select whether the contact's first or last name is displayed first

Font size — to set the font size for the list of contacts

Memory status — to view the free and used memory capacity

■ Groups

Select **Menu** > *Contacts* > *Groups* to arrange the names and phone numbers saved in the memory into caller groups with different ringing tones and group images.

■ Speed dials

To assign a number to a speed-dialing key, select **Menu** > *Contacts* > *Speed dials*, and scroll to the speed-dialing number that you want.

Select **Assign**, or if a number has already been assigned to the key, select **Options** > *Change*. Select **Search** and the contact you want to assign. If the *Speed dialling* function is off, the phone asks whether you want to activate it. See also *Speed dialling* in "Call" p. 60.

To make a call using the speed-dialing keys, see "Speed dialing" p. 22.

■ Info, service, and my numbers

Select **Menu** > *Contacts* and from one of these submenus:

Info numbers — to call the information numbers of your service provider if the numbers are included on your SIM card (network service)

Service numbers — to call the service numbers of your service provider if the numbers are included on your SIM card (network service)

My numbers — to view the phone numbers assigned to your SIM card, if the numbers are included on your SIM card

8. Call log



The phone registers your missed, received, and dialed calls if the network supports it and the phone is switched on and within the network service area.

To view the information on your calls, select **Menu** > *Log* > *Missed calls*, *Received calls*, or *Dialed numbers*. To view your recent missed and received calls and the dialed numbers chronologically, select *Call log*. To view the contacts to whom you most recently sent messages, select *Message recipients*.

To view the approximate information on your recent communications, select **Menu** > *Log* > *Call duration*, *Packet data counter*, or *Packet data timer*.

To view how many text and multimedia messages you have sent and received, select **Menu** > *Log* > *Message counter*.



Note: The actual invoice for calls and services from your service provider may vary, depending on network features, rounding off for billing, taxes, and so forth.

Some timers may be reset during service or software upgrades.

9. Settings



■ Profiles

Your phone has various setting groups, called profiles, for which you can customize the phone tones for different events and environments.

Select **Menu** > *Settings* > *Profiles*, the desired profile and from the following options:

Activate — to activate the selected profile

Personalise — to personalize the profile. Select the setting you want to change, and make the changes.

Timed — to set the profile to be active until a certain time up to 24 hours, and set the end time. When the time set for the profile expires, the previous profile that was not timed becomes active.

■ Themes

A theme contains many elements for personalizing your phone, such as wallpaper, screen saver, color scheme, and a ringing tone.

Select **Menu** > *Settings* > *Themes* from the following options:

Select theme — to set a theme in your phone. A list of folders in *Gallery* opens. Open the *Themes* folder, and select a theme.

Theme downloads — to open a list of links to download more themes.

■ Tones

You can change the settings of the selected active profile.

Select **Menu** > *Settings* > *Tones*. You can find the same settings in the *Profiles* menu. See "Profiles" p. 52.

To set the phone to ring only for calls from phone numbers that belong to a selected caller group, select *Alert for*. Scroll to the caller group you want or *All calls*, and select **Mark**.

Select **Options** > *Save* to save the settings or *Cancel* to leave the settings unchanged.

If you select the highest ringing tone level, the ringing tone reaches its highest level after a few seconds.

A theme may contain a tone that sounds when you open and close the phone. To switch off the tone,

change the setting in *Other tones*. Please note that this setting also switches off the warning tones.

■ Display

With display settings you can personalize your phone display view.

Standby mode settings

Select **Menu** > *Settings* > *Display* > *Standby mode settings* and from the following options:

Active standby — to switch the active standby mode on or off and to organize and personalize the active standby mode. See "*Active standby*" p. 19.

Wallpaper — to add the background image to the display in standby mode

Swivel animation — to set your phone to display an animation when you open and close the phone

Standby font colour — to select the color for the texts on the display in the standby mode

Operator logo — to set your phone to display or hide the operator logo. The menu is dimmed, if you have not saved the operator logo. For more information on

availability of an operator logo, contact your network operator.

Cell info display > *On* — to display the cell identity, if available from the network

Screen saver

To select a screen saver from *Gallery*, select **Menu** > *Settings* > *Display* > *Screen saver* > *Screen savers* > *Image*, *Slide set*, *Video clip*, or *Open camera*. To download more screen savers, select *Graphic downloads*. To select the time after which the screen saver is activated, select *Time-out*. To activate the screen saver, select *On*.

Power saver

To save some battery power, select **Menu** > *Settings* > *Display* > *Power saver*. The date and a digital clock are displayed when no function of the phone is used for a certain time.

Font size

To set the font size for reading and writing messages, and viewing contacts and web pages, select **Menu** > *Settings* > *Display* > *Font size*.

■ Time and date

To change the time, time zone, and date settings, select **Menu** > *Settings* > *Time and date* > *Clock*, *Date*, or *Auto-update of date/time* (network service).

When traveling to a different time zone, select **Menu** > *Settings* > *Time and date* > *Clock* > *Time zone* and the time zone of your location in terms of the time difference with respect to Greenwich Mean Time (GMT) or Universal Time Coordinated (UTC). The time and date are set according to the time zone and enable your phone to display the correct sending time of received text or multimedia messages. For example, GMT -5 denotes the time zone for New York (USA), 5 hours west of Greenwich/London (UK).

Use for India (New Delhi)
GMT +5.5, for Thailand/Indonesia/
Vietnam GMT +7, for Singapore/
Malaysia/Philippines GMT +8, for
Australia (Sydney) GMT +10, and
for New Zealand GMT+12.

■ My shortcuts

With personal shortcuts you get quick access to often used functions of the phone.

Left selection key

To select a function from the list for the left selection key, select **Menu** > *Settings* > *My shortcuts* > *Left selection key*. See also "*Standby mode*" p. 19.

If the left selection key is **Go to** to activate a function, select **Go to** and the desired function on your personal shortcut list. Select **Options** and from the following options:

Select options — to add a function to the shortcut list, or to remove one. Scroll to the function, and select **Mark** or **Unmark**.

Organise — to rearrange the functions on your personal shortcut list. Scroll to the function you want to move, and select **Move**. Scroll to where you want to move the function, and select **OK**.

Right selection key

To select a function from the list for the right selection key, select **Menu** > *Settings* > *My shortcuts* > *Right selection key*. See also "*Standby mode*" p. 19.

Navigation key

To select shortcut functions for the navigation keys, select **Menu** > *Settings* > *My*

shortcuts > *Navigation key*. Scroll to the desired key, select **Change** and a function from the list. To remove a shortcut function from the key, select *(empty)*. To reassign a function for the key, select **Assign**. See "Shortcuts in the standby mode" p. 20.

Enabling active standby

To select the key to activate the active standby navigation mode, select **Menu** > *Settings* > *My shortcuts* > *Enabling active standby* > *Navigation key up*, *Navigation key down*, or *Navigation key up/down*.

Voice commands

You can call contacts and carry out phone functions by saying voice commands. Voice commands are language-dependent. To set the language, see *Voice playback language* in "Phone" p. 60.

To select the phone functions to activate with a voice commands, select **Menu** > *Settings* > *My shortcuts* > *Voice commands* and a folder. Scroll to a function.  indicates that the voice tag is activated. To activate the voice tag, select **Add**. To play the activated voice command, select

Play. To use voice commands, see "Enhanced voice dialing" p. 22.

To manage the voice commands, scroll to a phone function, and select from the following options:

Edit or *Remove* — to change or deactivate the voice command of the selected function

Add all or *Remove all* — to activate or deactivate voice commands to all functions in the voice commands list.

Connectivity

You can connect the phone to a compatible device using a Bluetooth wireless technology or a USB data cable connection. You can also define the settings for GPRS dial-up connections.

Bluetooth wireless technology

This device is compliant with Bluetooth Specification 2.0 supporting the following profiles: generic access, generic object exchange, hands-free, headset, object push, file transfer, dial-up networking, SIM access, and serial port. To ensure interoperability between other devices supporting Bluetooth technology, use Nokia approved enhancements for this

model. Check with the manufacturers of other devices to determine their compatibility with this device.

There may be restrictions on using Bluetooth technology in some locations. Check with your local authorities or service provider.

Features using Bluetooth technology, or allowing such features to run in the background while using other features, increase the demand on battery power and reduce the battery life.

Bluetooth technology allows you to connect the phone to a compatible Bluetooth device within 10 meters (32 feet). Since devices using Bluetooth technology communicate using radio waves, your phone and the other devices do not need to be in direct line-of-sight, although the connection can be subject to interference from obstructions such as walls or from other electronic devices.

Set up a Bluetooth connection

Select **Menu** > *Settings* > *Connectivity* > *Bluetooth* and from the following options: *Bluetooth* > *On* or *Off* – to activate or deactivate the

Bluetooth function.  indicates an active Bluetooth connection.

Search for audio enhanc. – to search for compatible Bluetooth audio devices. Select the device that you want to connect to the phone.

Paired devices – to search for any Bluetooth device in range. Select **New** to list any Bluetooth device in range. Scroll to a device, and select **Pair**. Enter an agreed Bluetooth passcode of the device (up to 16 characters) to associate (pair) the device to your phone. You must only give this passcode when you connect to the device for the first time. Your phone connects to the device, and you can start data transfer.

Bluetooth wireless connection

Select **Menu** > *Settings* > *Connectivity* > *Bluetooth*. To check which Bluetooth connection is currently active, select *Active devices*. To view a list of Bluetooth devices that are currently paired with the phone, select *Paired devices*.

Select **Options** to access available options depending on the status of the device and the Bluetooth connection.

Bluetooth settings

To define how your phone is shown to other Bluetooth devices, select

Menu > **Settings** > **Connectivity** > **Bluetooth** > **Bluetooth settings** > **My phone's visibility** or **My phone's name**.

If you are concerned about security, turn off the Bluetooth function or set **My phone's visibility** to **Hidden**. Always accept only Bluetooth communication from others with whom you agree.

Packet data (GPRS)

General packet radio service (GPRS) is a network service that allows mobile phones to send and receive data over an Internet protocol (IP)based network. It enables wireless access to data networks such as the Internet.

The applications that may use packet data are MMS, video streaming, browsing sessions, e-mail, remote SyncML, Java application downloading, and the PC dial-up.

To define how to use the service, select **Menu** > **Settings** > **Connectivity** > **Packet data** > **Packet data connection**. Select from the following options:

When needed — to set the packet data connection to established when an application needs it. The connection will be closed when the application is terminated.

Always online — to set the phone to automatically connect to a packet data network when you switch the phone on. **G** or **E** indicates that the GPRS or EGPRS service is available. If you receive a call or a text message, or make a call during a packet data connection, **G** or **E** indicates that the GPRS or EGPRS connection is suspended (on hold).

Modem settings

You can connect the phone using Bluetooth wireless technology or USB data cable connection to a compatible PC and use the phone as a modem to enable EGPRS connectivity from the PC.

To define the settings for EGPRS connections from your PC, select **Menu** > **Settings** > **Connectivity** > **Packet data** > **Packet data settings** > **Active access point**, and activate the access point you want to use. Select **Edit active access point** > **Alias for access point**, enter a name to change the access point settings, and select **OK**. Select

Packet data access point, enter the access point name (APN) to establish a connection to an EGPRS network, and select **OK**.

You can also set the EGPRS dial-up service settings (access point name) on your PC using the Nokia Modem Options software. See "Nokia PC Suite" p. 85. If you have set the settings both on your PC and on your phone, the PC settings are used.

Data transfer

Synchronize your calendar, contacts data, and notes with another compatible device (for example, a mobile phone), a compatible PC, or a remote Internet server (network service).

Your phone allows data transfer with a compatible PC or another compatible device when using the phone without a SIM card. Note that when you use the phone without a SIM card, some functions appear dimmed in the menus and cannot be used.

Synchronizing with a remote Internet server is not possible without a SIM card.

Partner list

To copy or synchronize data from your phone, the name of the device and the settings must be in

the list of partners in transfer contacts. If you receive data from another device (for example, a compatible mobile phone), the partner is automatically added to the list, using the contact data from the other device. *Server synchronisation* and *PC synchronisation* are the original items in the list.

To add a new partner to the list (for example a new device), select **Menu > Settings > Connectivity > Data transfer > Options > Add transfer contact > Phone synchronisation** or **Phone copy**, and enter the settings according to the transfer type.

To edit the copy and synchronize settings, select a contact from the partner list and **Options > Edit**.

To delete a partner, select a contact from the partner list and **Options > Delete**, and confirm *Delete transfer contact?*. You cannot delete *Server synchronisation* or *PC synchronisation*.

Data transfer with a compatible device

For synchronization, Bluetooth wireless technology or a cable connection is used. The other device is in the standby mode.

To start data transfer, select **Menu > Settings > Connectivity > Data transfer** and the transfer partner from the list, other than *Server synchronisation* or *PC synchronisation*. According to the settings, the selected data is copied or synchronized. The other device also must be activated for receiving data.

Synchronize from a compatible PC

Before you synchronize data from calendar, notes, and contacts from a compatible PC, you must install the Nokia PC Suite software of your phone on the PC. Use Bluetooth wireless technology or a USB data cable for the synchronization, and start the synchronization from the PC.

Synchronize from a server

To use a remote Internet server, you must subscribe to a synchronization service. For more information and the settings required for this service, contact your service provider. You may receive the settings as a configuration message. See ["Configuration settings service"](#) p. 12 and ["Configuration"](#) p. 62.

If you have saved data on the remote Internet server, to synchronize your phone, start the synchronization from your phone.

Select **Menu > Settings > Connectivity > Data transfer > Server synchronisation**. Depending on the settings, select *Initialising synchronisation* or *Initialising copy*.

Synchronizing for the first time or after an interrupted synchronization may take up to 30 minutes to complete, if the contacts or calendar are full.

USB data cable

You can use the USB data cable to transfer data between the phone and a compatible PC or a printer supporting PictBridge. You can also use the USB data cable with Nokia PC Suite.

To activate the phone for data transfer or picture printing, connect the data cable; when the phone displays *USB data cable connected. Select mode.*, select **OK**. Select from the following modes:

Default mode — to use the cable for PC Suite

Printing — to print pictures directly from the phone using a compatible printer

To change the USB mode, select **Menu** > *Settings* >

Connectivity > *USB data cable* > *Default mode*, *Printing*, or *Data storage*.

■ Call

Select **Menu** > *Settings* > *Call* and from the following options:

Call divert — to divert your incoming calls (network service). You may not be able to divert your calls if some call barring functions are active. See *Call barring service* in "Security" p. 62.

Anykey answer > *On* — to answer an incoming call by briefly pressing any key, except the power key, the camera key, the left and right selection keys, or the end key

Automatic redial > *On* — to make a maximum of 10 attempts to connect the call after an unsuccessful call attempt

Speed dialling > *On* — to dial the names and phone numbers assigned to the speed-dialling keys 2 to 9 by pressing and holding the corresponding number key

Call waiting > *Activate* — to have the network notify you of an

incoming call while you have a call in progress (network service). See "Call waiting" p. 23.

Summary after call > *On* — to briefly display the approximate duration and cost (network service) of the call after each call

Send my caller ID > *Yes* — to show your phone number to the person you are calling (network service). To use the setting agreed upon with your service provider, select *Set by network*.

Line for outgoing calls — to select the phone line 1 or 2 for making calls if supported by your SIM card (network service).

Swivel call handling — to set the phone to answer calls when you open the phone and to end calls when you close the phone

■ Phone

Select **Menu** > *Settings* > *Phone* and from the following options:

Language settings — to set the display language of your phone, select *Phone language*. If you select *Automatic*, the phone selects the language according to the information on the SIM card.

To select the USIM card language, select *SIM language*.

To set a language for the voice playback, select *Voice playback language*. See "Enhanced voice dialing" p. 22 and *Voice commands* in "My shortcuts" p. 54.

Security keyguard — to set the phone to ask for the security code when you unlock the keyguard. Enter the security code, and select *On*.

Automatic keyguard — to set the keypad of your phone to lock automatically after a preset time delay when the phone is in the standby mode and no function of the phone has been used. Select *On*, and set the time.

When the keyguard is on, calls still may be possible to the official emergency number programmed into your device.

Welcome note — to write the note you would like to be shown briefly when the phone is switched on

Operator selection > Automatic — to set the phone to automatically select one of the cellular networks available in your area. With *Manual* you can select a network that has a roaming agreement with your home network operator.

Confirm SIM serv. actions — See "SIM services" p. 84.

Help text activation — to select whether the phone shows help texts

Start-up tone — to select whether the phone plays a tone when the phone is switched on

Switch off tone — to select whether the phone plays a tone when the phone is switched off. The availability of this menu depends on your phone.

■ Enhancements

This menu or the following options are shown only if the phone is or has been connected to a compatible mobile enhancement.

Select **Menu > Settings > Enhancements**. Depending on the enhancement, select from the following options:

Default profile — to select the profile that you want to be automatically activated when you connect to the selected enhancement

Automatic answer — to set the phone to answer an incoming call automatically after 5 seconds. If *Incoming call alert* is set to *Beep once* or *Off*, automatic answer is off.

Text phone > Use text phone > Yes — to use the text phone

settings instead of headset or loopset settings

■ Configuration

You can configure your phone with settings that are required for certain services to function correctly. The services are multimedia messaging, instant messaging, synchronization, e-mail application, streaming, and browser. Your service provider may also send you these settings. See "[Configuration settings service](#)" p. 12.

Select **Menu** > **Settings** > **Configuration** and from the following options:

Default config. settings — to view the service providers saved in the phone. Scroll to a service provider, and select **Details** to view the applications that the configuration settings of this service provider support. To set the configuration settings of the service provider as default settings, select **Options** > **Set as default**. To delete configuration settings, select **Delete**.

Activ. default in all apps. — to activate the default configuration settings for supported applications

Preferred access point — to view the saved access points. Scroll to

an access point, and select **Options** > **Details** to view the name of the service provider, data bearer, and packet data access point or GSM dial-up number.

Connect to serv. support — to download the configuration settings from your service provider

Personal config. settings — to add new personal accounts for various services manually, and to activate or delete them. To add a new personal account if you have not added any, select **Add**; otherwise, select **Options** > **Add new**. Select the service type, and select and enter each of the required parameters. The parameters differ according to the selected service type. To delete or activate a personal account, scroll to it, and select **Options** > **Delete** or **Activate**.

■ Security

When security features that restrict calls are in use (such as call barring, closed user group, and fixed dialing) calls still may be possible to the official emergency number programmed into your device.

Select **Menu** > **Settings** > **Security** and from the following options:

PIN code request and *UPIN code request* — to set the phone to ask for your PIN or UPIN code every time the phone is switched on. Some SIM cards do not allow the code request to be turned off.

PIN2 code request — to select whether the PIN2 code is required when using a specific phone feature which is protected by the PIN2 code. Some SIM cards do not allow the code request to be turned off.

Call barring service — to restrict incoming calls to and outgoing calls from your phone (network service). A barring password is required.

Fixed dialling — to restrict your outgoing calls to selected phone numbers if this function is supported by your SIM card

Closed user group — to specify a group of people whom you can call and who can call you (network service)

Security level > Phone — to set the phone to ask for the security code whenever a new SIM card is inserted into the phone. If you select *Memory*, the phone asks for the security code when the SIM card memory is selected, and you want to change the memory in use.

Access codes — to change the security code, PIN code, UPIN code, PIN2 code, or barring password

Code in use — to select whether the PIN code or UPIN code should be active

Authority certificates or *User certificates* — to view the list of the authority or user certificates downloaded into your phone. See "*Certificates*" p. 82.

Security module settings — to view *Security module details*, activate *Module PIN request*, or change the module PIN and signing PIN. See also "*Access codes*" p. 11.

■ Restore factory settings

To reset some of the menu settings to their original values, select **Menu > Settings > Restore factory sett.** Enter the security code. The data you have entered or downloaded, such as names and phone numbers saved in *Contacts*, are not deleted.

10. Operator menu

This menu lets you access a portal to services provided by your network operator. The name and the icon depend on the operator. For more information contact your network operator. If this menu is not shown the following menu numbers change accordingly.

The operator can update this menu with a service message. For more information, see "[Service inbox](#)" p. 80.

11. Gallery



In this menu you can manage images, video clips, music files, themes, graphics, tones, recordings, and received files. These files are arranged in folders.

Your phone supports an activation key system to protect acquired content. Always check the delivery terms of any content and activation key before acquiring them, as they may be subject to a fee.

Copyright protections may prevent some images, music (including ringing tones), and other content from being copied, modified, transferred or forwarded.

To see the list of folders, select **Menu** > **Gallery**.

To see the available options of a folder, select a folder > **Options**.

To view the list of files in a folder, select a folder > **Open**.

To see the available options of a file, select a file > **Options**.

12. Media



When taking and using images or video clips, obey all laws and respect local customs as well as privacy and legitimate rights of others.

■ Camera

You can take photos or record video clips with the built-in camera.

Take a snapshot



Hold the phone in a horizontal position. To start the camera in the still image mode , press the camera key (1); or to start in the video mode , press and hold the camera key. Use the volume key (2) to zoom in and out. To take a photo, or to start and pause a video record, press the camera key. To stop the camera, press the power key. The phone saves a

photo in *Gallery > Images* and a video record in *Video clips*.



Take a photo

To start the camera, press the camera key or select **Menu** > *Media* > *Camera*.

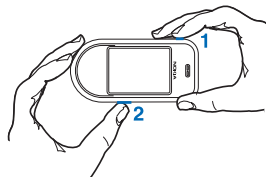
To use the camera, hold the phone in a horizontal position. Press in this position the navigation key left or right to change between camera (still image) and video mode. In the camera mode to zoom in and out, press the navigation key up and down, or the volume key.

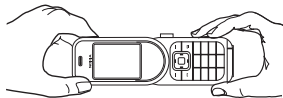

To take a photo select **Capture** or press the camera key. The phone saves the photo in *Gallery > Images*. To take another photo,

select **Back**; to send the photo as a multimedia message, select **Options** > *Send*.

Select **Options** to set *Night mode on* if the lighting is dim, *Self-timer on* to activate the self-timer, *Img. sequence on* to take photos in a fast sequence. With the highest image size setting 3 photos are taken in a sequence, with other size settings 5 photos are taken.

Your device supports an image capture resolution of 1280 x 960 pixels. The image resolution in these materials may appear different.

Record a video clip

To select the video mode, scroll left or right in horizontal position, or select **Options** > *Video*. To start the video recording, select **Record**. To pause the recording, select **Pause**; to resume the recording, select **Continue**. To stop the recording, select **Stop**. The phone saves the recording in *Gallery* > *Video clips*.

Camera filters

To use a filter with the camera, select **Options** > *Effects* > *False colours*, *Greyscale*, *Sepia*, *Negative*, or *Solarise*.

Camera settings

To change the camera settings, select **Options** > *Settings*.

Media player

With the media player you can view, play, and download files, such as images, audio, video, and animated images. You can also view compatible streaming videos from a network server (network service).

Select **Menu** > *Media* > *Media player* > *Open gallery*, *Bookmarks*, *Go to address*, or *Media downloads*.

Configuration for a streaming service

You may receive the configuration settings required for streaming as a configuration message from the service provider. See "[Configuration settings service](#)" p. 12. You can also enter the settings manually. See "[Configuration](#)" p. 62.

To activate the settings, do the following:

1. Select **Menu** > *Media* > *Media player* > *Streaming settings*.
2. Select *Configuration*. Only the configurations that support streaming are shown. Select a

service provider, *Default*, or *Personal configuration* for streaming.

3. Select *Account* and a streaming service account contained in the active configuration settings.

■ Radio

The FM radio depends on an antenna other than the wireless device's antenna. A compatible headset or enhancement needs to be attached to the device for the FM radio to function properly.



Warning: Listen to music at a moderate level.

Continuous exposure to high volume may damage your hearing. Do not hold the device near your ear when the loudspeaker is in use, because the volume may be extremely loud.

Select **Menu** > *Media* > *Radio*.

To use the graphical keys ▲, ▼, ◀, or ▶ on the display, scroll left or right to the desired key, and select it.

Save radio frequencies

1. To start the search, select and hold ◀ or ▶. To change the

radio frequency in 0.05 MHz steps, briefly press ◀ or ▶.

2. To save a frequency to a memory location, 1 to 9, press and hold the corresponding number key. To save a frequency to a memory location from 10 to 20, press briefly 1 or 2, and press and hold the desired number key, 0 to 9.
3. Enter the name of the radio station.

Listen to the radio

Select **Menu** > *Media* > *Radio*. To scroll to the desired frequency, select ▲ or ▼, or press the headset key. To select a radio station, briefly press the corresponding number keys. To adjust the volume, press the volume key.

Select from the following options:

Switch off — to turn off the radio

Save station — to save a new radio station

Visual Radio — to set whether the Visual Radio application is used (network service). To check the availability and costs, contact your network operator or service provider. Some radio stations may send text or graphical information

that you can view using the Visual Radio application.

Visual Radio settings — to select the options for **Visual Radio**. To set whether the application starts automatically when you turn on the radio, select **Enable visual service** > **Automatically**. To access a Web site with a list of radio stations, select **Station directory**. If available, their visual radio ID is shown.

Stations — to select the list of saved stations. To delete or rename a station, scroll to the desired station, and select **Options** > **Delete station** or **Rename**.

Mono output or **Stereo output** — to listen to the radio in monophonic sound or in stereo

Loudspeaker or **Headset** — to listen to the radio using the loudspeakers or headset. Keep the headset connected to the phone. The lead of the headset functions as the radio antenna.

Set frequency — to enter the frequency of the desired radio station

You can normally make a call or answer an incoming call while listening to the radio. During the call, the volume of the radio is muted.

When an application using a packet data or HSCSD connection is sending or receiving data, it may interfere with the radio.



Voice recorder



You can record pieces of speech, sound, or an active call, and save them in **Gallery**. This is useful when recording a name and phone number to write down later.

The recorder cannot be used when a data call or GPRS connection is active.

Record sound

1. Select **Menu** > **Media** > **Voice recorder**.

To use the graphical keys , , or  on the display, scroll left or right to the desired key, and select it.

2. To start the recording, select . To start the recording during a call, select **Options** > **Record**. While recording a call, all parties to the call hear a faint beeping sound. When recording a call, hold the phone in the normal position near to your ear. To pause the recording, select .

3. To end the recording, select . The recording is saved in *Gallery > Recordings*.

To listen to the latest recording, select **Options** > *Play last recorded*.

To send the last recording, select **Options** > *Send last recorded*.

To see the list of recordings in *Gallery*, select **Options** > *Recordings list > Recordings*.

■ Stereo widening

Stereo widening enhances the phone's audio output by enabling a wider stereo sound effect. To change the setting, select **Menu** > *Media > Stereo widening*.

13. Organizer



■ Alarm clock

You can set the phone to alarm at a desired time. Select **Menu** > *Organiser* > *Alarm clock*.

To set the alarm, select *Alarm time* and enter the alarm time. To change the alarm time when the alarm time is set, select *On*.

To set the phone to alert you on selected days of the week, select *Repeat alarm*.

To select the alarm tone or set the radio as the alarm tone, select *Alarm tone*. If you select the radio as an alarm tone, connect the headset to the phone. The phone uses the last radio station you listened to as the alarm, and the alarm plays through the loudspeakers. If you remove the headset or switch off the phone, the default alarm tone replaces the radio.

To set a snooze time-out, select *Snooze time-out* and the time.

Stop the alarm

The phone sounds an alert tone, and flashes *Alarm!* and the current time on the display, even if

the phone was switched off. To stop the alarm, select **Stop**. If you let the phone continue to sound the alarm for a minute or select **Snooze**, the alarm stops for the time you set in *Snooze time-out*, and then resumes.

If the alarm time is reached while the device is switched off, the device switches itself on and starts sounding the alarm tone. If you select **Stop**, the device asks whether you want to activate the device for calls. Select **No** to switch off the device or **Yes** to make and receive calls. Do not select **Yes** when wireless phone use may cause interference or danger.

■ Calendar

Select **Menu** > *Organiser* > *Calendar*.





The current day is indicated by a frame. If there are any notes set for the day, the day is in bold type, and the beginning of the note is shown below the calendar. To view the day notes, select **View**. To view a week, select **Options** > *Week view*. To delete all notes in the

calendar, select the month or week view, and select **Options** > *Delete all notes*.

Other options for the day view may be to make a note; delete, edit, move, or repeat a note; copy a note to another day; send a note with Bluetooth technology; or send a note to the calendar of another compatible phone as a text message or multimedia message. In *Settings* you can set the date, time, time zone, date or time format, date separator, default view, or the first day of the week. In *Auto-delete notes* you can set the phone to delete old notes automatically after a specified time.

Make a calendar note

Select **Menu** > *Organiser* > *Calendar*. Scroll to the date, and select **Options** > *Make a note* and one of the following note types:

 *Meeting*,  *Call*,  *Birthday*,  *Memo*, or  *Reminder*. Fill in the fields.

Note alarm

The phone displays the note and if set, sounds a tone. With a call note  on the display, to call the displayed number, press the call key. To stop the alarm and to view

the note, select **View**. To stop the alarm for 10 minutes, select **Snooze**.

To stop the alarm without viewing the note, select **Exit**.

To-do list

To save a note for a task that you must do, select **Menu** > *Organiser* > *To-do list*.

To make a note if no note is added, select **Add**; otherwise, select **Options** > *Add*. Fill in the fields, and select **Save**.

To view a note, scroll to it, and select **View**. While viewing a note, you can also select an option to edit the attributes.

You can also select an option to delete the selected note and delete all the notes that you have marked as done. You can sort the notes by priority or by deadline, send a note to another phone as a text message or a multimedia message, save a note as a calendar note, or access the calendar.

Notes

To write and send notes, select **Menu** > *Organiser* > *Notes*.

To make a note if no note is added, select **Add**; otherwise, select

Options > *Make a note*. Write the note, and select **Save**.

Other options include deleting and editing a note. While editing a note, you can also exit the text editor without saving the changes. You can send the note to compatible devices through Bluetooth wireless technology, text message, or a multimedia message.

■ Countdown timer

Select **Menu** > *Organiser* > *Countdown timer*. Enter the alarm time in hours, minutes, and seconds, and select **OK**. If you wish, write your own note text that is displayed when the time expires. To start the countdown timer, select **Start**. To change the countdown time, select *Change time*. To stop the timer, select *Stop timer*.

If the alarm time is reached when the phone is in the standby mode, the phone sounds a tone and flashes the note text if it is set or *Countdown time up*. To stop the alarm, press any key. If no key is pressed, the alarm automatically stops within 60 seconds. To stop the alarm and delete the note text, select **Exit**. To restart the countdown timer, select **Restart**.

■ Stopwatch

You can measure time, take intermediate times, or take lap times using the stopwatch. During timing, the other functions of the phone can be used. To set the stopwatch timing in the background, press the end key.

Using the stopwatch or allowing it to run in the background when using other features increases the demand on battery power and reduces the battery life.

Select **Menu** > *Organiser* > *Stopwatch* and from the following options:

Split timing — to take intermediate times. To start the time observation, select **Start**. Select **Split** every time that you want to take an intermediate time. To stop the time observation, select **Stop**.

To save the measured time, select **Save**.

To start the time observation again, select **Options** > *Start*. The new time is added to the previous time. To reset the time without saving it, select *Reset*.

Lap timing — to take lap times
Continue — to view the timing that you have set in the background

Show last — to view the most recently measured time if the stopwatch is not reset

View times or *Delete times* — to view or delete the saved times

14. Applications



■ Launch a game

Your phone software includes some games.

Select **Menu** > *Applications* > *Games*. Scroll to the desired game, and select **Open**.

To set sounds, lights, and shakes for the game, select **Menu** > *Applications* > **Options** > *Application settings*.

For more options related to a game, see "*Some application options*" p. 75.

■ Launch an application

Your phone software includes some Java applications.

Select **Menu** > *Applications* > *Collection*. Scroll to an application, and select **Open**.

■ Some application options

Delete — to delete the application from the phone

Details — to give additional information about the application

Update version — to check if a new version of the application is available for download from *Web* (network service)

Application access — to restrict the application from accessing the network. Different categories are shown. Select in each category one of the available permissions.

Web page — to provide further information or additional data for the application from an Internet page (network service). It is only shown if an Internet address has been provided with the application.

■ Download an application

Your phone supports J2ME Java applications. Make sure that the application is compatible with your phone before downloading it.



Important: Only install and use applications and other software from sources that offer adequate security and protection against harmful software.

You can download new Java applications and games in different ways.

Use the Nokia Application Installer from PC Suite to download the applications to your phone, or select **Menu** > *Applications* > **Options** > *Downloads* > *Application downloads*; the list of available bookmarks is shown. See ["Bookmarks"](#) p. 79.

For the availability of different services, pricing, and tariffs, contact your service provider.

Your device may have some bookmarks loaded for sites not affiliated with Nokia. Nokia does not warrant or endorse these sites. If you choose to access them, you should take the same precautions, for security or content, as you would with any Internet site.

15. Web



You can access various mobile Internet services with your phone browser.



Important: Use only services that you trust and that offer adequate security and protection against harmful software.

Check the availability of these services, pricing, tariffs, and instructions with your service provider.

With the phone browser you can view the services that use wireless markup language (WML) or extensible hypertext markup language (XHTML) on their pages. Appearance may vary due to screen size. You may not be able to view all details of the Internet pages.

■ Set up browsing

You may receive the configuration settings required for browsing as a configuration message from the service provider that offers the service that you want to use. See "[Configuration settings service](#)" p. 12. You can also enter all the

configuration settings manually. See "[Configuration](#)" p. 62.

■ Connect to a service

Ensure that the correct configuration settings of the service are activated.

1. To select the settings for connecting to the service, select **Menu** > **Web** > **Settings** > **Configuration settings**.
2. Select **Configuration**. Only the configurations that support browsing service are shown. Select a service provider, **Default**, or **Personal configuration** for browsing. See "[Set up browsing](#)" p. 77.
3. Select **Account** and a browsing service account contained in the active configuration settings.
4. Select **Display terminal window** > **Yes** to perform manual user authentication for intranet connections.

Make a connection to the service in one of the following ways:

- Select **Menu** > *Web* > *Home*; or in the standby mode, press and hold 0.
- To select a bookmark of the service, select **Menu** > *Web* > *Bookmarks*.
- To select the last URL, select **Menu** > *Web* > *Last web address*.
- To enter the address of the service, select **Menu** > *Web* > *Go to address*. Enter the address of the service, and select **OK**.

■ Browse pages

After you make a connection to the service, you can start browsing its pages. The function of the phone keys may vary in different services. Follow the text guides on the phone display. For more information, contact your service provider.

Browse with phone keys

To browse through the page, scroll in any direction.

To select a highlighted item, press the call key, or select **Select**.

To enter letters and numbers, press the 0 to 9 keys. To enter special characters, press *.

Options while browsing

Select from the following options:

Home — to return to your start page

Shortcuts — to open a new list of options that are specific to the page. This option is only available if the page contains shortcuts.

Add bookmark — to save the page as a bookmark

Bookmarks — to access the list of bookmarks. See "[Bookmarks](#)" p. 79.

Page options — to show the list of options for the active page

History — to get a list showing the last visited URLs

Downloads — to show the list of bookmarks for downloading

Other options — to show a list of other options

Reload — to reload and update the current page

The service provider may also offer other options.

Direct calling

While browsing, you can make a phone call, and save a name and a phone number from a page.

■ Bookmarks

You can save page addresses as bookmarks in the phone memory.

1. While browsing, select **Options** > *Bookmarks*; or in the standby mode, select **Menu** > *Web* > *Bookmarks*.
2. Scroll to a bookmark, and select it, or press the call key to make a connection to the page associated with the bookmark.
3. Select **Options** to view, edit, delete, or send the bookmark; to create a new bookmark; or to save the bookmark to a folder.

Your device may have some bookmarks loaded for sites not affiliated with Nokia. Nokia does not warrant or endorse these sites. If you choose to access them, you should take the same precautions, for security or content, as you would with any Internet site.

Receive a bookmark

When you have bookmark that is sent as a bookmark, *1 bookmark received* is displayed. To view the bookmark, select **Show**.

■ Appearance settings

While browsing, select **Options** > *Other options* > *Appearance*

settings; or in the standby mode, select **Menu** > *Web* > *Settings* > *Appearance settings* and from the following options:

Text wrapping > *On* — to set the text to continue on the next line on the display. If you select *Off*, the text is abbreviated.

Font size — to set the font size

Show images > *No* — to hide pictures on the page. This can speed up the browsing of pages that contain a lot of pictures.

Alerts > *Alert for unsecure conn.* > *Yes* — to set the phone to alert when a secure connection changes to an unsecure one during browsing

Alerts > *Alert for unsecure items* > *Yes* — to set the phone to alert when a secure page contains an unsecure item. These alerts do not guarantee a secure connection. For more information, see "Browser security" p. 81.

Character encoding > *Content encoding* — to select the encoding for the browser page content

Character encoding > *Unicode (UTF-8) web add.* > *On* — to set the phone to send a URL as a UTF-8 encoding. You may need this setting when you access a Web page created in foreign language.

Screen size > *Full* or *Small*— to set the screen layout

JavaScript > *Enable* — to enable the Java scripts

■ Security settings

Cookies

A cookie is data that a site saves in the cache memory of your phone. Cookies are saved until you clear the cache memory. See "[Cache memory](#)" p. 81.

While browsing, select **Options** > *Other options* > *Security* > *Cookie settings*; or in the standby mode, select **Menu** > *Web* > *Settings* > *Security settings* > *Cookies*. To allow or prevent the phone from receiving cookies, select *Allow* or *Reject*.

Scripts over secure connection

You can select whether to allow the running of scripts from a secure page. The phone supports WML scripts.

While browsing, to allow the scripts, select **Options** > *Other options* > *Security* > *WMLScript settings*; or in the standby mode, select **Menu** > *Web* > *Settings* >

Security settings > *WMLScripts in sec. conn.* > *Allow*.

■ Download settings

To automatically save all downloaded files in *Gallery*, select **Menu** > *Web* > *Settings* > *Downloading settings* > *Automatic saving* > *On*.

■ Service inbox

The phone is able to receive service messages sent by your service provider (network service). Service messages are notifications (for example, news headlines), and they may contain a text message or an address of a service.

To access the *Service inbox* in the standby mode, when you have received a service message, select **Show**. If you select **Exit**, the message is moved to the *Service inbox*. To access the *Service inbox* later, select **Menu** > *Web* > *Service inbox*.

To access the *Service inbox* while browsing, select **Options** > *Other options* > *Service inbox*. Scroll to the message you want, and to activate the browser and download the marked content, select **Retrieve**. To display detailed information on the service notification or to delete

the message, select **Options** > *Details* or *Delete*.

Service inbox settings

Select **Menu** > *Web* > *Settings* > *Service inbox settings*.

To set whether you want to receive service messages, select *Service messages* > *On* or *Off*.

To set the phone to receive service messages only from content authors approved by the service provider, select *Message filter* > *On*. To view the list of the approved content authors, select *Trusted channels*.

To set the phone to automatically activate the browser from the standby mode when the phone has received a service message, select *Automatic connection* > *On*. If you select *Off*, the phone activates the browser only after you select **Retrieve** when the phone has received a service message.

Cache memory

A cache is a memory location that is used to store data temporarily. If you have tried to access or have accessed confidential information requiring passwords, empty the cache after each use. The

information or services you have accessed is stored in the cache.

To empty the cache while browsing, select **Options** > *Other options* > *Clear the cache*; in the standby mode, select **Menu** > *Web* > *Clear the cache*.

Browser security

Security features may be required for some services, such as online banking or shopping. For such connections you need security certificates and possibly a security module, which may be available on your SIM card. For more information, contact your service provider.

Security module

The security module improves security services for applications requiring a browser connection, and allows you to use a digital signature. The security module may contain certificates as well as private and public keys. The certificates are saved in the security module by the service provider.

To view or change the security module settings, select **Menu** > *Settings* > *Security* > *Security module settings*.

Certificates



Important: Even if the use of certificates makes the risks involved in remote connections and software installation considerably smaller, they must be used correctly in order to benefit from increased security. The existence of a certificate does not offer any protection by itself; the certificate manager must contain correct, authentic, or trusted certificates for increased security to be available. Certificates have a restricted lifetime. If Expired certificate or Certificate not valid yet is shown even if the certificate should be valid, check that the current date and time in your device are correct.

Before changing any certificate settings, you must make sure that you really trust the owner of the certificate and that the certificate really belongs to the listed owner.

There are three kinds of certificates: server certificates, authority certificates, and user certificates. You may receive these certificates from your service provider. Authority certificates and user certificates may also be saved in the security module by the service provider.

To view the list of the authority or user certificates downloaded into your phone, select **Menu > Settings > Security > Authority certificates** or **User certificates**.

 is displayed during a connection, if the data transmission between the phone and the content server is encrypted.

The security icon does not indicate that the data transmission between the gateway and the content server (or place where the requested resource is stored) is secure. The service provider secures the data transmission between the gateway and the content server.

Digital signature

You can make digital signatures with your phone if your SIM card has a security module. Using the digital signature can be the same

as signing your name to a paper bill, contract, or other document.

To make a digital signature, select a link on a page, for example, the title of the book you want to buy and its price. The text to sign, which may include the amount and date, is shown.

Check that the header text is *Read* and that the digital signature icon  is shown.

If the digital signature icon does not appear, there is a security breach, and you should not enter any personal data such as your signing PIN.

To sign the text, read all of the text first, and select *Sign*.

The text may not fit within a single screen. Therefore, make sure to scroll through and read all of the text before signing.

Select the user certificate you want to use. Enter the signing PIN (see "*Access codes*" p. 11), and select *OK*. The digital signature icon disappears, and the service may display a confirmation of your purchase.

16. SIM services



Your SIM card may provide additional services. You can access this menu only if it is supported by your SIM card. The name and contents of the menu depend on the available services.

For availability and information on using SIM card services, contact your SIM card vendor. This may be the service provider, network operator, or other vendor.

To set the phone to show you the confirmation messages sent between your phone and the network when you are using the SIM services, select **Menu** > *Settings* > *Phone* > *Confirm SIM serv. actions* > *Yes*.

Accessing these services may involve sending messages or making a phone call for which you may be charged.

17. PC connectivity

You can send and receive e-mail, and access the Internet when your phone is connected to a compatible PC through a Bluetooth or a data cable connection. You can use your phone with a variety of PC connectivity and data communications applications.

■ Nokia PC Suite

With Nokia PC Suite you can synchronize contacts, calendar, notes, and to-do notes between your phone and the compatible PC or a remote Internet server (network service). You may find more information and PC Suite on the Nokia Web site at www.nokia-asia.com/support.

■ EGPRS, HSCSD, and CSD

With your phone you can use the enhanced GPRS (EGPRS), general packet radio service (GPRS), high speed circuit switched data (HSCSD), and circuit switched data (CSD, *GSM data*) data services.

For availability and subscription to data services, contact your

network operator or service provider.

The use of HSCSD services consumes the phone battery faster than normal voice or data calls. You may need to connect the phone to a charger for the duration of data transfer.

See "Modem settings" p. 57.

■ Data communication applications

For information on using a data communication application, refer to the documentation provided with it.

Making or answering phone calls during a computer connection is not recommended, as it might disrupt the operation.

For better performance during data calls, place the phone on a stationary surface with the keypad facing downward. Do not move the phone by holding it in your hand during a data call.

18. Battery information

■ Charging and discharging

Your device is powered by a rechargeable battery. The full performance of a new battery is achieved only after two or three complete charge and discharge cycles. The battery can be charged and discharged hundreds of times, but it will eventually wear out. When the talk and standby times are noticeably shorter than normal, replace the battery. Use only Nokia approved batteries, and recharge your battery only with Nokia approved chargers designated for this device.

If a replacement battery is being used for the first time or if the battery has not been used for a prolonged period, it may be necessary to connect the charger and then disconnect and reconnect it to start the charging.

Unplug the charger from the electrical plug and the device when not in use. Do not leave fully charged battery connected to a charger, since overcharging may shorten its lifetime. If left unused, a fully charged battery will lose its charge over time.

If the battery is completely discharged, it may take a few minutes before the charging indicator appears on the display or before any calls can be made.

Use the battery only for its intended purpose. Never use any charger or battery that is damaged.

Do not short-circuit the battery. Accidental short-circuiting can occur when a metallic object such as a coin, clip, or pen causes direct connection of the positive (+) and negative (-) terminals of the battery. (These look like metal strips on the battery.) This might happen, for example, when you carry a spare battery in your pocket or purse. Short-circuiting the terminals may damage the battery or the connecting object.

Leaving the battery in hot or cold places, such as in a closed car in summer or winter conditions, will reduce the capacity and lifetime of the battery. Always try to keep the battery between 15°C and 25°C (59°F and 77°F). A device with a hot or cold battery may not work temporarily, even when the battery is fully charged. Battery

performance is particularly limited in temperatures well below freezing.

Do not dispose of batteries in a fire as they may explode. Batteries may also explode if damaged. Dispose of batteries according to local regulations. Please recycle when possible. Do not dispose as household waste.

Nokia battery authentication guidelines

Always use original Nokia batteries for your safety. To check that you are getting an original Nokia battery, purchase it from an authorized Nokia dealer, look for the Nokia Original Enhancements logo on the packaging and inspect the hologram label using the following steps:

Successful completion of the four steps is not a total assurance of the authenticity of the battery. If you have any reason to believe that your battery is not an authentic original Nokia battery, you should refrain from using it, and take it to the nearest authorized Nokia service point or dealer for assistance. Your authorized Nokia service point or dealer will inspect the battery for

authenticity. If authenticity cannot be verified, return the battery to the place of purchase.

Authenticate hologram

1. When looking at the hologram on the label, you should see the Nokia connecting hands symbol from one angle and the Nokia Original Enhancements logo when looking from another angle.



2. When you angle the hologram left, right, down, and up, you should see 1, 2, 3, and 4 dots on each side respectively.



3. Scratch the side of the label to reveal a 20-digit code, for example, 12345678919876543210. Turn the battery so that the numbers are facing upwards. The 20-digit code reads

starting from the number at the top row followed by the bottom row.



4. Confirm that the 20-digit code is valid by following the instructions at www.nokiaoriginals.com/ check.



To create a text message enter the 20-digit code, for example, 12345678919876543210, and send to +44 7786 200276.

To create a text message,

- For countries in Asia Pacific, excluding India: Enter the 20-digit code, for example, 12345678919876543210, and send to +61 427151515.
- For India only: Enter Battery followed by the 20-digit battery code, for example, Battery

12345678919876543210,
and send to 5555.

National and international operator charges will apply.

You should receive a message indicating whether the code can be authenticated.

If you need assistance confirming the battery code, contact your local Nokia Care Centres listed at www.nokia-asia.com/carecentrelocator.

What if your battery is not authentic?

If you cannot confirm that your Nokia battery with the hologram on the label is an authentic Nokia battery, please do not use the battery. Take it to the nearest authorized Nokia service point or dealer for assistance. The use of a battery that is not approved by the manufacturer may be dangerous and may result in poor performance and damage to your device and its enhancements. It may also invalidate any approval or warranty applying to the device.

To find out more about original Nokia batteries, visit www.nokiaoriginals.com/battery.

19. Genuine Enhancements

A new extensive range of enhancements is available for your phone. Select the enhancements which accommodate your specific communication needs.



Some of the enhancements are described in detail below.

For availability of the enhancements, please check with your local dealer. A few practical rules for enhancements operation:

- Keep the enhancements out of small children's reach.
- When you disconnect the power cord of any enhancement, grasp and pull the plug, not the cord.
- Check regularly that all mobile phone equipment in a vehicle is mounted and operating properly.

Use only batteries, chargers and enhancements approved by the phone manufacturer. The use of any other types may invalidate any approval or warranty applying to the phone, and may be dangerous.

■ Power

Type	Tech	Talk-time*	Standby*
BL-4B	Li-Ion	Up to 3.4 - 3.6 hrs	Up to 7 - 12 days

* Variation in operation times may occur depending on SIM card, network and usage settings, usage style and environments. Use of FM radio and integrated hands-free will affect talktime and standby.

Nokia Compact Charger AC-3

Compact and lightweight charger with smaller charging plug.

■ Audio

Fashion Stereo Headset HS-31

Jazz up your style with the Nokia Fashion Headset.

20. Care and maintenance

Your device is a product of superior design and craftsmanship and should be treated with care. The suggestions below will help you protect your warranty coverage.

- Keep the device dry. Precipitation, humidity and all types of liquids or moisture can contain minerals that will corrode electronic circuits. If your device does get wet, remove the battery and allow the device to dry completely before replacing it.
- Do not use or store the device in dusty, dirty areas. Its moving parts and electronic components can be damaged.
- Do not store the device in hot areas. High temperatures can shorten the life of electronic devices, damage batteries, and warp or melt certain plastics.
- Do not store the device in cold areas. When the device returns to its normal temperature, moisture can form inside the device and damage electronic circuit boards.
- Do not attempt to open the device other than as instructed in this guide.
- Do not drop, knock, or shake the device. Rough handling can break internal circuit boards and fine mechanics.

- Do not use harsh chemicals, cleaning solvents, or strong detergents to clean the device.
- Do not paint the device. Paint can clog the moving parts and prevent proper operation.
- Use a soft, clean, dry cloth to clean any lenses (such as camera, proximity sensor, and light sensor lenses).
- Use only the supplied or an approved replacement antenna. Unauthorized antennas, modifications, or attachments could damage the device and may violate regulations governing radio devices.
- Use chargers indoors.
- Always create a backup of data you want to keep (such as contacts and calendar notes) before sending your device to a service facility.

All of the above suggestions apply equally to your device, battery, charger, or any enhancement. If any device is not working properly, take it to the nearest authorized service facility for service.

21. Additional safety information

Your device and its enhancements may contain small parts. Keep them out of the reach of small children.

■ Operating environment

Remember to follow any special regulations in force in any area, and always switch off your device when its use is prohibited or when it may cause interference or danger. Use the device only in its normal operating positions. This device meets RF exposure guidelines when used either in the normal use position against the ear or when positioned at least

2.2centimeters (7/8 inches) away from the body. When a carry case, belt clip or holder is used for body-worn operation, it should not contain metal and should position the device the above-stated distance from your body.

In order to transmit data files or messages, this device requires a good quality connection to the network. In some cases, transmission of data files or messages may be delayed until such a connection is available. Ensure the above separation distance instructions are followed until the transmission is completed.

Parts of the device are magnetic. Metallic materials may be attracted to the device. Do not place credit cards or other magnetic storage media near the device, because information stored on them may be erased.

■ Medical devices

Operation of any radio transmitting equipment, including wireless phones, may interfere with the functionality of inadequately protected medical devices. Consult a physician or the manufacturer of the medical device to determine if they are adequately shielded from external RF energy or if you have any questions. Switch off your device in health care facilities when any regulations posted in these areas instruct you to do so. Hospitals or health care facilities may be using equipment that could be sensitive to external RF energy.

Pacemakers

Pacemaker manufacturers recommend that a minimum separation of 15.3 centimeters (6 inches) be maintained between a wireless phone and a pacemaker to avoid potential interference with the pacemaker. These recommendations are consistent with the independent research by and recommendations of Wireless Technology Research. Persons with pacemakers should do the following:

- Always keep the device more than 15.3 centimeters (6 inches) from the pacemaker
- Not carry the device in a breast pocket

- Hold the device to the ear opposite the pacemaker to minimize the potential for interference.

If you suspect interference, switch off your device, and move the device away.

Hearing aids

Some digital wireless devices may interfere with some hearing aids. If interference occurs, consult your service provider.

■ Vehicles

RF signals may affect improperly installed or inadequately shielded electronic systems in motor vehicles such as electronic fuel injection systems, electronic antiskid (antilock) braking systems, electronic speed control systems, and air bag systems. For more information, check with the manufacturer or its representative of your vehicle or any equipment that has been added.

Only qualified personnel should service the device, or install the device in a vehicle. Faulty installation or service may be dangerous and may invalidate any warranty that may apply to the device. Check regularly that all wireless device equipment in your vehicle is mounted and operating properly. Do not store or carry flammable liquids, gases, or explosive materials in the same compartment as the device, its parts, or enhancements. For vehicles equipped with an air bag, remember that air bags inflate with great force. Do not place objects,

including installed or portable wireless equipment in the area over the air bag or in the air bag deployment area. If in-vehicle wireless equipment is improperly installed and the air bag inflates, serious injury could result.

Using your device while flying in aircraft is prohibited. Switch off your device before boarding an aircraft. The use of wireless teledevices in an aircraft may be dangerous to the operation of the aircraft, disrupt the wireless telephone network, and may be illegal.

■ Potentially explosive environments

Switch off your device when in any area with a potentially explosive atmosphere and obey all signs and instructions. Potentially explosive atmospheres include areas where you would normally be advised to turn off your vehicle engine. Sparks in such areas could cause an explosion or fire resulting in bodily injury or even death. Switch off the device at refueling points such as near gas pumps at service stations. Observe restrictions on the use of radio equipment in fuel depots, storage, and distribution areas; chemical plants; or where blasting operations are in progress. Areas with a potentially explosive atmosphere are often but not always clearly marked. They include below deck on boats, chemical transfer or storage facilities, vehicles using liquefied petroleum gas (such as propane or butane), and areas where the air contains chemicals or

particles such as grain, dust, or metal powders.

device may be the only means of communication at the scene of an accident. Do not end the call until given permission to do so.

■ Emergency calls



Important: Wireless phones, including this device, operate using radio signals, wireless networks, landline networks, and user-programmed functions. Because of this, connections in all conditions cannot be guaranteed. You should never rely solely on any wireless device for essential communications like medical emergencies.

To make an emergency call:

1. If the device is not on, switch it on. Check for adequate signal strength. Some networks may require that a valid SIM card is properly inserted in the device.
2. Press the end key as many times as needed to clear the display and ready the device for calls.
3. Enter the official emergency number for your present location. Emergency numbers vary by location.
4. Press the call key.

If certain features are in use, you may first need to turn those features off before you can make an emergency call. Consult this guide or your service provider for more information.

When making an emergency call, give all the necessary information as accurately as possible. Your wireless

■ Certification information (SAR)

THIS DEVICE MEETS INTERNATIONAL GUIDELINES FOR EXPOSURE TO RADIO WAVES

Your mobile device is a radio transmitter and receiver. It is designed and manufactured not to exceed the limits for exposure to radio frequency (RF) recommended by international guidelines (ICNIRP). These limits are part of comprehensive guidelines and establish permitted levels of RF energy for the general population. The guidelines were developed by independent scientific organizations through periodic and thorough evaluation of scientific studies. The guidelines include a substantial safety margin designed to assure the safety of all persons, regardless of age and health.

The exposure standard for mobile devices employs a unit of measurement known as the Specific Absorption Rate, or SAR. The SAR limit stated in the international guidelines is 2.0 watts/kilogram (W/kg)*. Tests for SAR are conducted using standard operating positions with the device transmitting at its highest certified power level in all tested frequency bands. Although the SAR is determined at the highest certified power level, the actual SAR of the device while operating can be well below the maximum value. This is because the device is designed to operate at multiple power levels so as to use only

the power required to reach the network. In general, the closer you are to a base station, the lower the power output of the device.

The highest SAR value for this device when tested for use at the ear is 0.66 W/kg.

SAR values may vary depending on national reporting and testing requirements and the network band. Use of device accessories and enhancements may result in different SAR values. Additional SAR information may be provided under product information at www.nokia-asia.com.

* The SAR limit for mobile devices used by the public is 2.0 W/kg averaged over 10 grams of body tissue. The guidelines incorporate a substantial margin of safety to give additional protection for the public and to account for any variations in measurements. SAR values may vary depending on national reporting requirements and the network band. For SAR information in other regions, please look under product information at www.nokia.com.

Index

A

- access codes 11
- accessories. See enhancements.
- active standby 19, 53
 - enabling 55
- alarm clock 71
- antenna 16
- applications 75
 - collection 75
 - download 12
- audio messages 33

B

- barring password 12
- Battery 89
- battery
 - charging 14, 86
 - discharging 86
 - installation 14
- Battery information
 - type 89
- Bluetooth 55
- bookmarks 79
- browser 77
 - appearance settings 79
 - bookmarks 79
 - browsing pages 78
 - cache memory 81
 - certificates 82
 - cookies 80
 - digital signature 82
 - security 80
 - security module 81
 - set up 77
- business cards 48

C

- cache memory 81
- calendar 71
 - note 72
 - note alarm 72
- call
 - functions 22
 - key 18

- log 51
 - options 23
 - register. See call log.
 - settings 60
 - waiting 23
- Call log 51
- call waiting 23
- calls
 - answer 23
 - international 22
 - making of 22
 - reject 23
 - speed dialling 22
 - voice dialling 22
- camera 66
 - key 18
 - record a video clip 67
 - settings 67
 - take a photo 66
- care 90
- certificates 82
- character case 25
- charge the battery 14
- circuit switched data 85
- clock settings 54
- codes 11, 12
- configuration 62
 - setting service 12
 - settings 16
- contact information 13
- contacts
 - copy 46
 - delete 46
 - edit 46
 - groups 49
 - my numbers 50
 - my presence 46
 - save 45
 - search 45
 - service numbers 50
 - settings 49
 - speed dialing 49
 - subscribed names 47
- cookies 80
- countdown timer 73
- CSD 85

customer service 13

D

- data
 - communication 85
 - transfer 58
- data cable 59
- date settings 54
- delete
 - e-mail 40
 - messages 41
- digital signature 82
- display 19
- display settings 53
- downloads
 - applications 12
 - content 12
 - settings 80

E

- earpiece 18
- e-mail
 - application 39
 - IMAP4 39
 - POP3 39
 - SMTP 39
- emergency calls 93
- end
 - call 22
 - key 18
- enhancements 10, 61
- explosive environments 92

F

- factory settings 63
- filter 67
- flash messages 33
- FM radio 68
- folders 40
- font size 53

G

- gallery 65
- games 75
- Genuine Enhancements 89
- GPRS, EGPRS 57

H

- handsfree. See loudspeaker.
- hearing aids 92
- high-speed circuit switched data 85
- HSCSD 85

I

- IM. See instant messaging.
- IMAP4 39, 44
- indicators 20
- info messages 41
- installation
 - battery 14
 - SIM card 14
- instant messaging 34
 - accept invitation 36
 - availability 37
 - block 38
 - contacts 38
 - groups 38
 - read 37
 - reject invitation 36
 - service 35
 - start session 35
 - unblock 38
- Internet 77

K

- keyguard 21
- keypad 18
- keypad lock 21
- keys 18
 - call key 18
 - end key 18
 - keyguard 21
 - keypad 18
 - keypad lock 21
 - navigation key 18
 - power on/off 18
 - selection keys 18, 19

L

- language settings 60
- log 51
- loudspeaker 18, 23

M

- maintenance 90
- media player 67
- medical devices 91
- memory 32
- menu operation 27
- message
 - folder 32
- message center number 28
- message settings
 - e-mail 43
 - general settings 41
 - multimedia messages 42
- messages
 - cancel sending 31
 - delete 41
 - info messages 41
 - length indicator 28
 - message settings 41
 - sending 31
 - service commands 41
 - text 28
 - write text message 28
- microphone 18
- MMS. See multimedia messages.
- multimedia messages 30
 - create 30
 - read 32
 - reply 32
 - send 30
 - write 30

N

- navigation key 18, 54
- network
 - name on display 19
 - services 9
- Nokia battery authentication guidelines 87
- Nokia contact information 13
- notes 72
 - calendar 72
- numbers 50

O

- operator menu 64
- organiser 71
- overview functions 11

P

- pacemakers 91
- packet data 57, 85
- parts 18
- PC connectivity 85
- PC Suite 85
- phone
 - care 90
 - configuration 62
 - keys 18
 - open 15
 - parts 18
 - settings 60
- phone lock. See keypad lock.
- phone maintenance 90
- photo 66
- PictBridge 59
- PIN codes 11, 16
- plug and play service 16
- POP3 39, 44
- Pop-Port 18
- power key 18
- power saver 53
- predictive text input 25
- presence 46
- profiles 52
- PUK codes 12
- pushed messages 80

R

- radio 68
- record sound 69
- recorder 69
- repair service 13
- ringing tones 52

S

- safety
 - additional information 91
 - emergency calls 93
 - explosive environments 92
 - guidelines 8
 - hearing aids 92
 - medical devices 91
 - operating environment 91
 - pacemakers 91
 - vehicles 92
- screen saver 53

- scroll key. See navigation key.
- security
 - codes 11
 - module 81
 - settings 62
- selection keys 18, 19
- service
 - commands 41
 - inbox 80
 - messages 80
 - numbers 50
- services 77
- Set the time, time zone, and date 16
- settings
 - call 60
 - camera 67
 - clock 54
 - configuration 62
 - connectivity 55
 - data transfer 58
 - date 54
 - display 53
 - downloads 80
 - enhancements 61
 - GPRS, EGPRS 57
 - messages 41
 - my shortcuts 54
 - phone 60
 - profiles 52
 - restore factory settings 63
 - security 62
 - service inbox 81
 - standby mode 53
 - themes 52
 - time 54
 - tones 52
 - USB data cable 59
- shared memory 10
- shortcuts 20, 54
- signal strength 19
- SIM
 - card installation 14
 - messages 29
 - services 84
- SMS. See text messages
- SMTP 39
- snapshot 66
- speed dialing 22, 49
- standby mode 19, 54
- status indicators 19

- stereo widening 70
- stopwatch 73
- strap 17
- subscribed names 47
- support 13
- switch on and off 16
- swivel 53
- synchronisation 58

T

- take a photo 66
- text
 - character case 25
 - predictive text input 25
 - traditional text input 26
 - writing 25
- text message 28
- themes 52
- time settings 54
- to-do list 72
- tones 52
- traditional text input 26

U

- unlock keypad 21
- UPIN 16

V

- vehicles 92
- video clip 67
- voice
 - commands 55
 - dialing 22
 - messages 40
 - recorder 69
- volume key 18

W

- wallpaper 53
- Web 77
 - bookmarks 79
 - connect 77
- wireless markup language 77
- wrist strap 17
- write text 25

X

XHTML 77

Z

zoom 66

zoom key 18