

User's Guide for Nokia 3200

DECLARATION OF CONFORMITY

We, NOKIA CORPORATION declare under our sole responsibility that the product RH-30 is in conformity with the provisions of the following Council Directive: 1999/5/EC.

A copy of the Declaration of Conformity can be found from
http://www.nokia.com/phones/declaration_of_conformity/.

CE 168

Copyright © 2004 Nokia. All rights reserved.

Reproduction, transfer, distribution or storage of part or all of the contents in this document in any form without the prior written permission of Nokia is prohibited.

Nokia, Nokia Connecting People, Xpress-on and Pop-Port are trademarks or registered trademarks of Nokia Corporation. Other product and company names mentioned herein may be trademarks or tradenames of their respective owners.

Nokia tune is a sound mark of Nokia Corporation.



Java is a trademark of Sun Microsystems, Inc.

US Patent No 5818437 and other pending patents. T9 text input software Copyright (C) 1997-2004. Tegic Communications, Inc. All rights reserved.



Includes RSA BSAFE cryptographic or security protocol software from RSA Security.

Nokia operates a policy of continuous development. Nokia reserves the right to make changes and improvements to any of the products described in this document without prior notice.

Under no circumstances shall Nokia be responsible for any loss of data or income or any special, incidental, consequential or indirect damages howsoever caused.

The contents of this document are provided "as is". Except as required by applicable law, no warranties of any kind, either express or implied, including, but not limited to, the implied warranties of merchantability and fitness for a particular purpose, are made in relation to the accuracy, reliability or contents of this document. Nokia reserves the right to revise this document or withdraw it at any time without prior notice.

The availability of particular products may vary by region. Please check with the Nokia dealer nearest to you.

Contents

FOR YOUR SAFETY.....	vi	Writing text.....	9
Network services.....	viii	Predictive text input.....	9
About accessories	viii	Using traditional text input.....	10
General information	ix	General instructions on writing text.....	11
Stickers in the sales package	ix	4. Using the menu	12
Nokia PC Suite software.....	ix	Accessing a menu function.....	12
Access codes	ix	List of menu functions	13
Shared memory.....	x	5. Menu functions.....	16
Downloading content and applications.....	x	Messages (Menu 1).....	16
(E)GPRS.....	xi	Text and picture messages (SMS)	16
1. Your phone	1	Multimedia messages (MMS).....	19
Keys	1	Deleting messages.....	22
Connectors, flashlight and camera....	1	Voice messages.....	22
Standby mode and display indicators	1	Info messages	22
Flashlight	2	Message settings.....	23
2. Getting started	3	Service commands.....	24
Installing the SIM card and the battery.....	3	Call register (Menu 2).....	24
Changing the covers.....	4	Missed, received and dialled calls....	24
Charging the battery	5	Call counters and call timers.....	25
Switching the phone on and off.....	5	Contacts (Menu 3).....	25
3. Basic functions	7	Alternative ways to access the functions in this menu	25
Making a call	7	Selecting the settings for contacts..	26
Answering or rejecting an incoming call	8	Saving names and phone numbers..	26
Functions available during a call	8	Adding an image to a saved name or number.....	27
Keypad lock (Keyguard)	9	Searching for a name in the contacts.....	27
Using the loudspeaker.....	9	Deleting contacts.....	27
		Editing a name, number or text item.....	27
		Copying contacts	28
		Other functions related to the contacts list.....	28

Settings (Menu 4).....	29	6. Battery information	53
Profiles	29	Charging and Discharging.....	53
Tone settings.....	29	7. Genuine Enhancements	54
Display settings	30	Battery	54
Time and date settings.....	31	Indoor.....	54
Personal shortcuts.....	32	Travel Charger (ACP-12)	54
Connectivity	32	Indoor and Vehicle.....	55
Call settings.....	33	Boom Headset (HDB-4).....	55
Phone settings.....	34	Stereo Headset (HDS-3).....	55
Enhancement settings.....	35	Vehicle.....	55
Security settings	36	Mobile Charger (LCH-9).....	55
Restore factory settings.....	37	8. Care and Maintenance.....	56
Gallery (Menu 5).....	37	9. Important Safety	
Options for the files in the gallery...	38	Information.....	57
Media (Menu 6)	39	Index.....	61
Camera.....	39		
Radio.....	40		
Voice recorder.....	41		
Organiser (Menu 7)	42		
Alarm clock.....	42		
Calendar	42		
Calculator.....	44		
Applications (Menu 8).....	44		
Games.....	45		
Collection	45		
Services (Menu 9).....	46		
Basic steps for accessing and using			
browser services.....	47		
Setting up the phone for			
a browser service	47		
Making a connection to			
a browser service	48		
Browsing the pages of a service.....	49		
Disconnecting from			
a browser service	49		
Bookmarks.....	50		
Service inbox.....	50		
Emptying the cache memory.....	51		
Browser security.....	51		
Go to (Menu 10)	52		
SIM services (Menu 11).....	52		

FOR YOUR SAFETY

Read these simple guidelines. Breaking the rules may be dangerous or illegal. Further detailed information is given in this manual.



Do not switch the phone on when wireless phone use is prohibited or when it may cause interference or danger.



ROAD SAFETY COMES FIRST

Don't use a hand-held phone while driving.



INTERFERENCE

All wireless phones may get interference, which could affect performance.



SWITCH OFF IN HOSPITALS

Follow any regulations or rules. Switch the phone off near medical equipment.



SWITCH OFF IN AIRCRAFT

Wireless devices can cause interference in aircraft.



SWITCH OFF WHEN REFUELLING

Don't use the phone at a refuelling point. Don't use near fuel or chemicals.



SWITCH OFF NEAR BLASTING

Don't use the phone where blasting is in progress. Observe restrictions, and follow any regulations or rules.



USE SENSIBLY

Use only in the normal position. Don't touch the antenna unnecessarily.



QUALIFIED SERVICE

Only qualified personnel may install or repair phone equipment.



ACCESSORIES AND BATTERIES

Use only approved accessories and batteries. Do not connect incompatible products.



CONNECTING TO OTHER DEVICES

When connecting to any other device, read its user's guide for detailed safety instructions. Do not connect incompatible products.



BACKUP COPIES

Remember to make backup copies of all important data.





WATER-RESISTANCE

Your phone is not water-resistant. Keep it dry.





CALLING

Ensure the phone is switched on and in service. Enter the phone number, including the area code, then press . To end a call, press . To answer a call, press .



EMERGENCY CALLS

Ensure the phone is switched on and in service. Press  as many times as needed (e.g. to exit a call, to exit a menu, etc.) to clear the display. Enter the emergency number, then press . Give your location. Do not end the call until told to do so.

When using the features in this device, obey all laws and honor privacy and legitimate rights of others.

Network services

The wireless phone described in this guide is approved for use on the EGSM 900, GSM 1800 and GSM 1900 network.

Triband is a network dependent feature. Check with your local service provider if you can subscribe to and use this feature.

This wireless phone is a 3GPP GSM Release 99 terminal supporting (E)GPRS service, and is designed to support also Release 97 GPRS networks. However, proper functionality in all Release 97 GPRS networks cannot be guaranteed. For more information, contact your service provider or local Nokia dealer.

A number of features included in this guide are called Network Services. These are special services that you arrange through your wireless service provider. Before you can take advantage of any of these Network Services, you must subscribe to them through your service provider and obtain instructions for their use from your service provider.



Note: Some networks may not support all language-dependent characters and/or services.

About accessories

Check the model number of any charger before use with this device. This device is intended for use when supplied with power from ACP-7, ACP-12 and LCH-12.



Warning: Use only batteries, chargers and accessories approved by the phone manufacturer for use with this particular phone model. The use of any other types may invalidate any approval or warranty applying to the phone, and may be dangerous.

For availability of approved accessories, please check with your dealer.

When you disconnect the power cord of any accessory, grasp and pull the plug, not the cord.

General information

■ Stickers in the sales package

The stickers contain important information for service and customer support purposes. Keep these stickers in a safe place.

■ Nokia PC Suite software

With the Nokia PC Suite software you can, for example, manage the photos captured with the phone's camera and create new ringing tones and wallpapers. You can also create new cut-out covers from your photos. Nokia PC Suite is available on Nokia's Web site at www.nokia.com.

■ Access codes

- **Security code:** This code is supplied with your phone. The security code protects your phone against unauthorised use. The preset code is 12345.

Change the code and set the phone to request it using the *Access codes* and *Security level* functions in the *Security settings* menu. Keep the new code secret and in a safe place separate from your phone.

- **PIN code:** The PIN (Personal Identification Number) code may be supplied with the SIM card. It protects the SIM card against unauthorised use. If you activate the *PIN code request* function in the *Security settings* menu, the code is requested each time the phone is switched on.

If you enter an incorrect PIN code three times in succession, the SIM card is blocked. Key in the PUK code and press **OK**. Key in a new PIN code and press **OK**. Key in the new code again and press **OK**.

- **PIN2 code:** This code may be supplied with the SIM card and is required to access some functions, such as charging unit counters.
- **PUK and PUK2 codes:** These codes may be supplied with the SIM card. If this is not the case, contact your service provider.
- **Barring password:** This code is needed when using the *Call barring service* function in the *Security settings* menu.

■ Shared memory

The following features in this phone may share memory: contacts list; text and multimedia messages; images and ringing tones in the *Gallery* menu; voice recorder; calendar notes, and Java™ games and applications. Using any such features may reduce the memory available for any features sharing memory. This is especially true with heavy use of any of the features.

For example, saving many images may take all of the shared memory and your phone may display a message that the memory is full. In this case, delete some of the information or entries stored in the shared memory features before continuing.

You can check the amount of free and used shared memory with the *Memory status* function in the *Phone settings* menu, see page 34.

■ Downloading content and applications

You may be able to download new content (for example images and ringing tones) and Java applications from Internet sites into the phone (network service).

1. Select the download function in the *Applications* or *Gallery* menu. To access the download function, see the respective menu descriptions.

A list of bookmarks is shown. Select *More bookmarks* if you want to view the bookmarks available in the *Services* menu.

2. Select the bookmark of the browser page you want to access. If the connection fails, change the active set of the connection settings in the *Services* menu and try the connection again. Follow the instructions provided by the service.

For the availability of different browser services, pricing and tariffs, contact your network operator and/or the service provider.



Note that Nokia does not warrant for applications from non-Nokia sites. If you choose to download Java applications from them, you should take the same precautions, for security or content, as you would with any site.

■ (E)GPRS

GPRS (General Packet Radio Service) is a network service that allows mobile phones to be used for sending and receiving data over an Internet Protocol (IP) -based network. Via a GPRS connection you can, for example, send and receive multimedia messages (network service).

EGPRS (Enhanced GPRS) is similar to GPRS but enables faster connections.

To use the (E)GPRS service, subscribe to it from your network operator or service provider and save the GPRS settings for the functions that you want to use over the (E)GPRS network. For information on pricing, availability and data transfer speed, contact your network operator or service provider.

Note that when you have selected GPRS as a data bearer, the phone uses EGPRS instead of GPRS if this is available in the network. You cannot choose between EGPRS and GPRS but for some applications, such as browsing WAP or xHTML pages, you may be able to select either GPRS or *GSM data* (CSD, Circuit Switched Data).

For information on the indicators shown during a (E)GPRS connection, see page 33.

1. Your phone

■ Keys

1. Power key

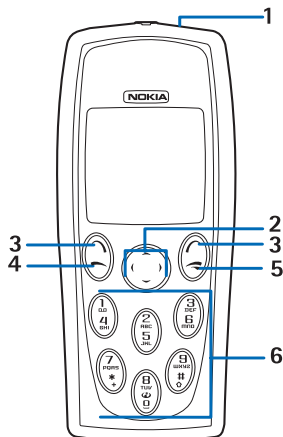

Switches the phone on and off.

2. 4-way scroll keys (, , and)

3. Selection keys

Each key performs the function displayed above it.

4. dials a phone number, and answers a call. Pressing this key in standby mode shows the most recently dialled numbers.

5. ends an active call or rejects a call. Exits from any function.

6. - enter numbers and characters.

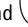
 and  are used for various purposes in different functions.

■ Connectors, flashlight and camera

1. Charger connector

2. Flashlight

3. Pop-Port™ connector for attaching a compatible enhancement to the phone

4. Infrared port for wireless connection with a compatible device

5. Camera lens.

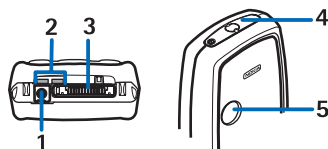

■ Standby mode and display indicators

When the phone is ready for use, and you have not keyed in any characters, the phone is in standby mode. The indicators related to different phone functions are described throughout this guide.

1. Shows the name of the network in which the phone is being used, or the operator logo.

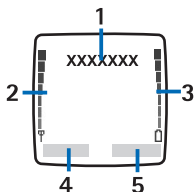

2. Shows the signal strength of the cellular network at your current location. The higher the bar, the stronger the signal.
3. Shows the battery charge level. The higher the bar, the more power in the battery.
4. The left selection key is **Menu**.
5. The right selection key can be **Contacts** or the function (for example **Go to**) that you have selected with the *Right selection key* setting in the *Personal shortcuts* menu (see page 32), or it may have a name or logo specific to a network operator.
 - **Contacts** opens the *Contacts* menu.
 - **Go to** shows the functions defined with the *Select Go to options* function in the *Personal shortcuts* menu.
 - Operator-specific key opens the operator's homepage.

Flashlight

There is a flashlight at the bottom of your phone. To switch the flashlight on or off in standby mode (when the keypad is not locked), press and hold  in standby mode, when you have not keyed in any characters.

2. Getting started

■ Installing the SIM card and the battery

- Keep all miniature SIM cards out of the reach of small children.

The SIM card and its contacts can easily be damaged by scratches or bending, so be careful when handling, inserting or removing the card.

Before installing the SIM card, always make sure that the phone is switched off and disconnected from any enhancement and then remove the battery.

1. To remove the back cover:

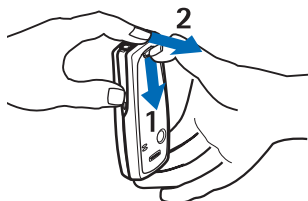

Push the back cover release button (1) towards the top of the phone and lift the cover from the phone (2).

2. Remove the battery by lifting it from the finger grip (3).

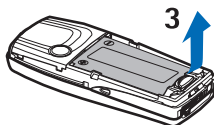

3. To release the SIM card holder, slide the card holder backwards (4) and open it by lifting (5).

Insert the SIM card into the SIM card holder (6) so that the card's bevelled corner points to the camera lens. Make sure that the card's golden contact area is facing downwards and that the card is properly in place.

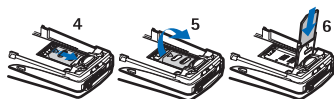

4. Close the SIM card holder (7) and slide it forwards to lock it (8).

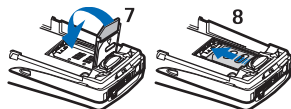

5. Replace the battery (9).

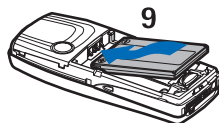

- To replace the back cover:

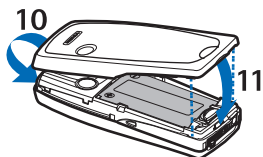

Place the top of the back cover over the top of the phone (10). Press the bottom of the back cover towards the phone until the cover is locked into place (11).

■ Changing the covers

Before changing the cover, always switch off the power and disconnect the phone from the charger or any other device. Avoid touching electronic components while changing the covers. Always store and use the phone with the covers attached.

The phone is supplied with some cut-out covers made and approved by Nokia that you can use to quickly change the look of your phone. You can also make the covers by yourself.



Note: Use only normal, plain paper used in standard printers (whose weight is 60–135 g/m²) that is not thicker than 0.3 mm. Colors or ink used in the paper must not contain any metal particles.

- Remove the back cover as described on page 3.
- To remove the front cover, gently pull the top of the cover from the phone (1) and lift the cover.

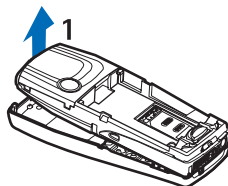

- Remove the old cut-out cover from the back cover and the old cut-out cover and keymat from the front cover.
- Place the new cut-out cover on the front cover (2).

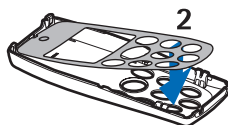

- Place the keymat on the cut-out cover (3). Make sure that the keymat is properly in place.

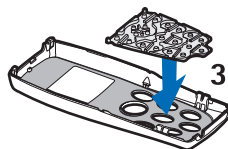

- To replace the front cover, align the top of the phone with the top of the cover (4) and press the bottom of the phone towards the cover until it locks into place (5).

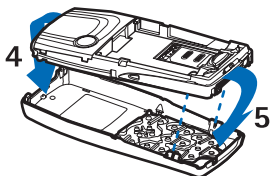

- Place the cut-out cover into the back cover by sliding the cut-out cover under the two guides in the middle and at the bottom of the back cover (6).

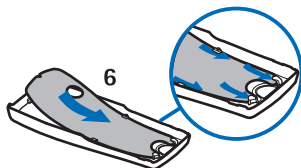

- Replace the back cover as described in step 6 in "Installing the SIM card and the battery" on page 3. Make sure that the back cover is properly in place.

■ Charging the battery

- Connect the lead from the charger to the socket on the bottom of your phone.

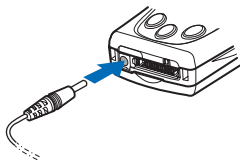

- Connect the charger to an AC wall socket.

The charging indicator bar starts scrolling. If the battery is completely empty, it may take a few minutes before the charging indicator appears on the display. You can use the phone during charging.

- Charging the BLD-3 battery supplied with the phone takes about two hours and 40 minutes with the ACP-7 charger while charging with the ACP-12 charger takes about one hour and 15 minutes.
- When the battery is fully charged, the charging indicator bar stops scrolling. Disconnect the charger from the AC wall outlet and from the phone.

■ Switching the phone on and off



Warning: Do not switch the phone on when wireless phone use is prohibited or when it may cause interference or danger.

Press and hold the power key .

- If the phone asks for a PIN code or security code, key in the code and press **OK**.



- If the phone displays *Insert SIM card* even though the SIM card is properly inserted, or *SIM card not supported*, contact your network operator or service provider. Your phone does not support 5 Volt SIM cards and the card may need to be changed.

TIPS ON EFFICIENT

OPERATION: Your

phone has a built-in antenna. As with any other radio transmitting device, do not touch the



antenna (blue area in picture) unnecessarily when the phone is switched on. Contact with the antenna affects call quality and may cause the phone to operate at a higher power level than otherwise needed. Not touching the antenna area during a phone call optimises the antenna performance and the talktime of your phone.

3. Basic functions

■ Making a call

1. Key in the phone number, including the area code. If you key in an incorrect character, press **(or)** to move the cursor and **Clear** to delete the character to the left of the cursor.

To make an international call:

Press ***** twice for the + character and key in the country code, area code (omit the leading zero, if necessary) and phone number.

2. Press **(hook)** to call the number.

To adjust the volume: Use **(up)** to increase or **(down)** to decrease the volume.

To use the phone hands free: See "Using the loudspeaker" on page 9.

3. Press **(hook)** to end the call or to cancel the call attempt.

See also "Functions available during a call" on page 8.

■ Making a call using the contacts list

Press **(hook)** in standby mode. Key in the first letter(s) of the name saved with the phone number. Scroll to the name with **(up)** or **(down)**. Press **(hook)** to make the call.

■ Calling a recently dialled number

In standby mode, press **(hook)** once to view up to ten numbers you have last called or attempted to call. Scroll to the desired number or name, and press **(hook)** to call the number.

To call the last dialled number, press **(hook)** twice in standby mode.

■ Calling your voice mailbox

To call your voice mailbox (network service) in standby mode, press and hold **(100)**, or press **(100)** and **(hook)**. See also "Voice messages" on page 22.

When you have received a voice message, **00** may be shown at the top of the display (network service). Press **Listen** to call your voice mailbox.



■ Speed dialling a phone number

If you have assigned a phone number to one of the keys **(2 mic)** to **(9 voice)** (see "Speed dials" on page 28), you can call the phone number as follows:

- In standby mode, press the desired number key and **(hook)**. **OR:**
- If the **Speed dialling** function (see page 34) is set on, press and hold the number key in standby mode until the call is started.

Making another call during a call (network service)

During a call, press **Options** and select *New call*. Key in the phone number, or search for it in the contacts, and press **Call** or . The first call is put on hold.

- To switch between the two calls, press **Swap** or . To end the active call, press , or press **Options** and select *End call*. To end both calls, press **Options** and select *End all calls*.
- To join the two calls into a conference call (network service), press **Options** and select *Conference*. To have a private conversation with one of the participants, select *Private* and the participant. To rejoin the call, select *Conference*. To end the call, press .

■ Answering or rejecting an incoming call

Press  to answer the call. If you want to mute the ringing tone, press **Silence**.

To reject the call, press , or press **Options** and select *Reject*. The rejected call will be diverted if you have activated a call divert option such as *Divert if busy*.

Call waiting

You can answer a call while you have another call in progress if you have activated the *Call waiting* function in the *Call settings* menu (network service). To answer the waiting call, press **Answer** or . The first call is put on hold.

■ Functions available during a call

You can press **Options** for some of the following functions during a call:



Mute or *Unmute*, *End call*, *End all calls*, *Contacts*, *Menu*, *Hold* or *Unhold*, *New call* (network service), *Conference* (network service), *Private* (network service), *Answer*, *Reject*, *Swap* (network service), *Send DTMF*, *Loudspeaker* or *Handset*, *Lock keypad*, *Transfer* (network service), *Headset*, *Handsfree*, *Record*, *Auto volume on* or *Auto volume off*.

Select

- *Auto volume on* / *Auto volume off* to set the automatic volume control on or off. See "Call settings" on page 33.
- *Transfer* to connect the held call to the active call and to disconnect yourself from the call.
- *Headset* or *Handsfree* to switch the active call to the respective compatible accessory when the accessory is connected to the phone.

■ Keypad lock (Keyguard)

You can lock the keypad to prevent the keys being accidentally pressed, for example, when your phone is in your handbag.

To lock the keypad, press **Menu** in standby mode and then  within 1.5 seconds. When the keypad is locked,  is shown at the top of the display.

To unlock the keypad, press **Unlock** and  within 1.5 seconds.

When the keypad is locked, you can answer a call by pressing . During a call, the phone can be operated normally. When you end or reject the call, the keypad will automatically be locked.

You can also set the keypad to lock automatically after a certain length of time. See *Automatic keyguard* on page 35.



Note: When Keyguard is on, calls may be possible to the emergency number programmed into your phone (e.g. 112, 911 or other official emergency number). Key in the emergency number and press . The number is displayed only after you have keyed in its last digit.

■ Using the loudspeaker

The phone has a loudspeaker that allows you to use the phone hands free during a call. Do not hold the phone to your ear during loudspeaker operation as the volume may be extremely loud.

To activate the loudspeaker: Press **Options** during a call and select *Loudspeaker*, or press **Loudsp.** if available. When the loudspeaker is active,  is shown in standby mode.

To deactivate the loudspeaker: Press **Options** and select *Handset*, or press **Handset** if available.

■ Writing text

You can key in text, for example messages or calendar notes, using predictive or traditional text input.

Predictive text input

In predictive text input, you can key in characters by pressing a letter key once for each character. This input method uses a dictionary built into the phone.

Setting predictive text input on or off

When writing text, press **Options** and select *Dictionary*.

- To set predictive text input on, select the language you want from the dictionary list.

- To revert to traditional text input, select *Dictionary off*.

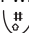

Tip: To quickly set predictive text input on or off when writing text, press  twice, or press and hold **Options**.

Using predictive text input

Check that  is shown at the top of the display.

1. Write a word by using the keys to . Press each key only once for one letter. The word may change after each keypress. For general instructions on writing text, see page 11.
 - To insert a common punctuation mark, press and then repeatedly. **OR:** Press and hold , scroll to the desired character and press **Use** or .
 - To insert a special character: Press and hold , scroll to the desired character and press **Use** or .
2. If the displayed word is the one you want, confirm it by adding a space with , and write the next word.
 - If the word is not the one you want, press **Options**, select *Matches* and the desired word, and press **Use**. **OR:** Press repeatedly until the word appears.

- If the ? character is shown after the word, no words in the dictionary correspond to your keypresses. To add a word to the dictionary: Press **Spell**, key in the word and press **Save**.

3. When using predictive text input, pressing **Options** can also allow access to the following functions:



- *Insert word / Edit word:* You can add a word into the dictionary using traditional text input. *Insert word* is shown when no word is underlined, that is, selected for editing. *Edit word* is shown when a word is underlined.
- *Insert symbol:* You can select a special character from a list.

Writing compound words



Key in the first part of the word and confirm it by pressing . Repeat this with the last part of the word.

Using traditional text input

Check that  is shown at the top of the display. Press a key one or more times until the desired character is displayed. Not all available characters are printed on the keys. The characters available depend on the *Phone language* setting in the *Phone settings* menu, see page 34.

- If the next letter you want is located on the same key as the present one, wait until the cursor is shown and key in the letter.
- To add a common punctuation mark or special character, press  repeatedly. **OR:** Press , scroll to the character and press **Use**.

General instructions on writing text

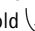
- To insert a space, press .
- To move the cursor, press a scroll key.
- To delete the character to the left of the cursor, press **Clear**. Press and hold **Clear** to delete several characters.
- To change the character case, press  repeatedly and check the indicator, for example **Abc**, at the top of the display.
- To insert a number, press and hold the desired key. To insert several numbers, press and hold  and key in the numbers. To continue writing text, press and hold .

4. Using the menu

Your phone offers a wide range of functions that are grouped in menus.

Most of the menu functions are provided with a brief help text. To view the help text, scroll to the desired menu function and wait for about 15 seconds.

The help text can be set to on or off using the *Help text activation* function in the *Phone settings* menu, see page 34.

■ Accessing a menu function

By scrolling

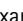
1. Press **Menu** in standby mode.
2. Scroll with  or  to a main menu, for example *Settings*, and press **Select** to open it.

When the menu view is *Grid*, you can use any of the scroll keys for scrolling the main menus. To change the menu view, see *Menu view* in "Display settings" on page 30.

3. Scroll to a submenu, for example *Call settings*, and press **Select**.



If the submenu contains further submenus, for example *Speed dialling*, repeat this step.

4. Scroll to a setting option, for example *Off*, and press **Select**.

Press **Back** to return to the previous menu level, or press **Exit** or  to exit to standby mode.

By using a shortcut number

The menus, submenus and setting options are numbered. This shortcut number is shown at the top right of the display.

Press **Menu** in standby mode. Within two seconds, key in the shortcut number of the main menu you want to open. Repeat this for the submenu and setting option. To access menu 1, press **Menu** and key in  and .

■ List of menu functions

1. Messages

1. Text messages
 1. Create message
 2. Inbox
 3. Create SMS e-mail
 4. Sent items
 5. Archive
 6. Templates
 7. My folders
 8. Delete messages
2. Multimedia msgs.
 1. Create message
 2. Inbox
 3. Outbox
 4. Sent items
 5. Saved items
 6. Delete messages
3. Voice messages
 1. Listen to voice messages
 2. Voice mailbox number
4. Info messages
 1. Info service
 2. Topics
 3. Language
 4. Info topics saved on SIM card¹
 5. Read²
5. Message settings
 1. Text messages
 2. Multimedia msgs.
 3. Other settings
6. Service commands

2. Call register

1. Missed calls
2. Received calls
3. Dialed numbers
4. Delete recent call lists
 1. All
 2. Missed
 3. Received
 4. Dialed
5. Call duration
 1. Last call duration
 2. Received calls' duration
 3. Dialed calls' duration
 4. All calls' duration
 5. Clear timers
6. GPRS data counter
 1. Data sent in last session
 2. Data received in last session
 3. All sent data
 4. All received data
 5. Clear counters
7. GPRS connection timer
 1. Duration of last session
 2. Duration of all sessions
 3. Clear timers

3. Contacts

1. Search
2. Add contact
3. Delete
4. Copy

1. Shown only if info message topics can be saved to the SIM card.

2. Shown only if info messages have been received.

- 5. Settings
 - 1. Memory in use
 - 2. Contacts view
 - 3. Memory status
- 6. Speed dials
- 7. Info numbers¹
- 8. Service numbers¹
- 9. My numbers
- 10. Caller groups
- 4. Settings**
 - 1. Profiles
 - 2. Tone settings
 - 1. Incoming call alert
 - 2. Ringing tone
 - 3. Ringing volume
 - 4. Vibrating alert
 - 5. Message alert tone
 - 6. Keypad tones
 - 7. Warning tones
 - 8. Alert for
 - 3. Display settings
 - 1. Wallpaper
 - 2. Colour schemes
 - 3. Operator logo
 - 4. Screen saver timeout
 - 5. Display brightness
 - 6. Menu view
 - 4. Time and date settings
 - 1. Clock
 - 2. Date
 - 3. Auto-update of date & time
 - 5. Personal shortcuts
 - 1. Right selection key
 - 2. Select Go to options
 - 3. Organise Go to options
 - 6. Connectivity
 - 1. Infrared
 - 2. GPRS
 - 7. Call settings
 - 1. Call divert
 - 2. Automatic volume control
 - 3. Anykey answer
 - 4. Automatic redial
 - 5. Speed dialling
 - 6. Call waiting
 - 7. Summary after call
 - 8. Send my caller identity
 - 9. Line for outgoing calls²
 - 8. Phone settings
 - 1. Phone language
 - 2. Memory status
 - 3. Automatic keyguard
 - 4. Cell info display
 - 5. Welcome note
 - 6. Network selection
 - 7. Confirm SIM service actions
 - 8. Help text activation
 - 9. Start-up tone
 - 9. Enhancement settings³
 - 10. Security settings
 - 1. PIN code request
 - 2. Call barring service
 - 3. Fixed dialling
 - 4. Closed user group
 - 5. Security level
 - 6. Access codes
 - 11. Restore factory settings

1. Shown if supported by your SIM card. For availability, contact your network operator or service provider.

2. For availability, contact your network operator or service provider.

3. Shown only if the phone is or has been connected to a compatible enhancement.

5. Gallery

1. View folders
2. Add folder
3. Delete folder
4. Rename folder
5. Activation key list
6. Gallery downloads

6. Media

1. Camera
 1. Standard photo
 2. Portrait photo
 3. Night mode
 4. Self-timer
 5. Settings
2. Radio
3. Voice recorder

7. Organiser

1. Alarm clock
2. Calendar
3. Calculator

8. Applications

1. Games
2. Collection

9. Services

1. Home
2. Bookmarks
3. Service inbox
4. Download links
5. Settings
6. Go to address
7. Clear the cache

10. Go to**11. SIM services¹**

1. Only shown if supported by your SIM card. The name and contents vary depending on the SIM card.

5. Menu functions

■ Messages (Menu 1)



You can read, write, send and save text, multimedia and e-mail messages. The messages are organised into folders.

Text and picture messages (SMS)

Using the SMS service (Short Message Service) your phone can send and receive multi-part messages, which consist of several ordinary text messages (network service). This may affect the invoicing of the messages.

Text messages can contain pictures. Each picture message is made up of several text messages. Therefore, sending one picture message may cost more than sending one text message.

Before you can send text or picture messages, you need to save your message centre number, see "[Message settings](#)" on page 23.



Note: Picture message function can be used only if it is supported by your network operator or service provider. Only phones that offer picture message features can receive and display picture messages.

Writing and sending a message

1. Press **Menu** in standby mode and select *Messages*, *Text messages* and *Create message*. **OR:** Press **[Left Arrow]** in standby mode.
2. Key in a message. See "[Writing text](#)" on page 9.

The number of available characters and the current part number of a multi-part message are shown on the top right of the display, for example 120/2. Special (Unicode) characters, such as á, may take up more space in the message than other characters.

- To insert a picture into the message, press **Options** and select *Insert picture*. Scroll to the desired picture, and press **View** and **Insert**.
- To view the text and picture together, press **Options** and select *Preview*. To change the picture or to delete it from the message, press **Options** and select the desired function.
- To use a predefined text as a base for the message, press **Options** and select *Use template* and the desired template.
- To insert a phone number from the contacts list, press **Options** and select *Insert number*. Press **Search** or **[Up Arrow]** and select the number from the contacts list.

- To insert a name from the contacts list, press **Options**, select *Insert contact*, scroll to the desired name and press **Options**. Select *Insert contact*, or select *View details* if you want to insert a number or text item saved with the name.
 - To save the message in the *Archive* or *Templates* folder or in a folder that you have created inside the *My folders* folder, press **Options** and select *Save message*.
3. To send the message, press , or press **Options** and select *Send*, key in the recipient's phone number or search for it in the contacts list, and press **OK**.

Alternatively: Press **Options** and select *Sending options*. Select

- *Send to many* to send the message to several recipients. Scroll to the desired recipient and press **Send**. When you have sent the message to everyone you want, press **Done**.
- *Sending profile* to send the message using the settings that you have defined earlier. See "Message settings" on page 23.

The sent message is saved in the *Sent items* folder.



Note: When sending messages via the SMS network service, your phone may display the words *Message sent*. This is an indication that the message has been sent by your phone to the message centre number programmed into your phone. This is not an indication that the message has been received at the intended destination. For more details about SMS services, check with your service provider.

Writing and sending an e-mail message

Before you can send e-mail messages via SMS, you need to save the required settings, for example *Messages sent via* and *E-mail server*. See "Message settings" on page 23 for details.

For availability and subscription to the e-mail service, contact your network operator or service provider. To save an e-mail address in the phone book, see "Saving multiple numbers and text items per name" on page 26.

1. Press **Menu**, and select *Messages*, *Text messages* and *Create SMS e-mail*.
2. Key in the recipient's e-mail address or search for it in the contacts list and press **OK**.

3. If you wish, key in the subject for the message and press **OK**.
4. Key in the e-mail message.
5. To send the message, press **Options**, select *Send SMS e-mail* and press **OK**.



Note: When sending e-mail messages via the SMS network service, your phone may display the words *Message sent*. This is an indication that the e-mail has been sent by your phone to the e-mail server. This is not an indication that the e-mail has been received at the intended destination. For more details about e-mail services, check with your service provider.

Reading and replying to a text, picture or e-mail message

When you receive a message, the  indicator and the number of new messages followed by *... messages received* are shown.

If the  indicator blinks, the text message memory is full. Before you can receive new messages, you need to delete some old ones. See page 22. Text messages use shared memory, see page x.

1. Press **Show** to view the new message, or press **Exit** to view it later.

Viewing the message later: Press **Menu** in standby mode, and select *Messages, Text messages* and *Inbox*.

2. If more than one message has been received, select the one that you want to read and scroll through the message. An unread message is indicated by .
3. To reply to the displayed message, press **Options** and select *Reply*. Select
 - *Empty screen* if you want to write a message from scratch.
 - *Original text* if you want to include the original message in the reply.
 - *Template* or a standard answer such as *Thank you* if you want to use a preset text as a base for the new message. For information on the templates, see "Folders for text and picture messages" on page 19.

When replying to an e-mail message, confirm or edit the e-mail address and subject and then write your reply.
4. To send your reply, press **Options**, select *Send*, and press **OK**. OR: Press  twice.

Other functions accessible with the Options key



While reading a message, pressing **Options** also allows access to the following functions: *Delete*, *Use detail*, *Forward*, *Edit* (for text messages) / *Edit text* (for picture messages), *Move*, *Rename*, *Copy to calendar*, *Save picture* (for picture messages), *Message details*.

Select

- *Use detail* to extract a phone number, e-mail address or Web address from the message.
- *Copy to calendar* to copy the message text to your phone's calendar as a memo.
- *Save picture* to save the picture included in a picture message in the *Templates* folder.

Folders for text and picture messages

To open a folder, press **Menu** in standby mode, and select *Messages*, *Text messages* and then *Inbox*, *Sent items*, *Archive*, *Templates* or *My folders*.

- In *Templates* you can save text messages that you want to use as a base for new messages. Text templates are indicated by  and picture templates by .

To edit or delete a template, select the desired template, press **Options**, and select the desired function.

- In *My folders* you can create new folders for your messages.

To add a folder, press **Add** (if the folder list is empty) or press **Options** and select *Add folder*. To delete or rename a folder, press **Options** and select the desired function.

Multimedia messages (MMS)

A multimedia message can contain text, one image and one sound clip. The phone can send and receive multimedia messages of up to 100 kilobytes.



Note: This function can be used only if it is supported by your network operator or service provider. Only phones that offer compatible multimedia message features can receive and display multimedia messages.

If *Allow multimedia reception* is set to *Yes* or *In home network*, your operator or service provider may charge you for every message you receive.

Note that multimedia messages cannot be received during a call, while using a game or another Java application or when you have an active browsing session using the GSM data bearer (see "[Keying in the service settings manually](#)" on page 47).

Because delivery of multimedia messages can fail for a variety of reasons, do not rely solely upon them for essential communications.

Sent and received multimedia messages use shared memory, see page x.

Writing and sending a multimedia message

Before you can use the multimedia messaging service, you need to define its settings, see page 23. For the settings, availability and subscription to this service, contact your network operator or service provider.

Before sending a multimedia message, read the notes on page 21.

1. Press **Menu** in standby mode, and select *Messages*, *Multimedia msgs.* and *Create message*.
 2. Key in a message. See "Writing text" on page 9.
- To insert an image or a sound clip, press **Options** and select *Insert* and the desired option.

The list of folders in the *Gallery* menu is shown. Open a specific folder, scroll to the desired image or sound, press **Options** and select *Insert*. Copyright protections may prevent some images, ringing tones and other content from being copied, modified, transferred or forwarded.

- Your phone supports the sending and receiving of multimedia messages that contain several pages ('slides'). To add a new slide to the message, press **Options** and select *Insert* and *Slide*. Each slide can contain text, one image and one sound clip.

If the message contains several slides, you can open the desired one by pressing **Options** and selecting *Previous slide*, *Next slide* or *Slide list*.

To define how long each slide is shown, press **Options** and select *Slide timing*.

To move the text part to the top or bottom of the message, press **Options** and select *Text on top* or *Text on bottom*.

- To insert a business card or a calendar note for sending it to a compatible device, press **Options** and select *Insert* and the desired option.
- To insert a name from the contacts list, press **Options** and select *More options*, *Insert contact* and the desired name.
- To insert a number from the contacts list, press **Options** and select *More options* and *Insert number*.
- To delete an image, slide or sound clip from the message, press **Options** and select *Delete* and the desired function.

- To save the message in the *Saved items* folder, press **Options** and select *Save message*.
 - To add a subject to the message, press **Options** and select *More options* and *Edit subject*.
 - To view for example the size or recipient of the message, press **Options** and select *More options* and *Message details*.
 - To view the message or slide presentation before sending it, press **Options** and select *Preview*.
3. To send the message, press **Options** and select *Send to number* (or *Send to e-mail* or *Send to many*).



Tip: You can send the message to a phone number also by pressing .

4. Key in the recipient's phone number or e-mail address, or search for it in the contacts list. Press **OK** to send the message.
- If you selected *Send to many* in step 3, press **Options**, select *Search number* or *Search e-mail*, and select the recipients one by one from the contacts list. To send the message, press , or press **Done** and **Options** and select *Send*.



The message is saved in the *Outbox* folder until it is sent. The sent messages are saved in the *Sent items* folder if the *Save sent messages* setting is *Yes*. See "[Settings for multimedia messages](#)" on page 23.

Notes for sending a multimedia message

- It may take more time to send a multimedia message than a text message. During sending, the animated  indicator is displayed and you can use other functions of the phone.

If the sending is interrupted, the phone tries to re-send the message a few times. If the sending fails, the message remains in the *Outbox* folder where you can try to re-send it later.

Reading and replying to a multimedia message

When the phone is receiving a multimedia message, the animated  indicator is displayed. When the message has been received, the  indicator and the text *Multimedia message received* are shown.

If the  indicator blinks, the memory for multimedia messages is full. Before you can receive new messages, you need to delete some old ones, see page 22.

1. Press **Show** to view the received message right away or press **Exit** to view it later.

Viewing the message later: Press **Menu** in standby mode, and select *Messages, Multimedia msgs.* and *Inbox*. Select the desired message from the list. An unread message is indicated by .

2. Scroll through the message. If the message contains a slide presentation, the presentation is played automatically.

You can press **Options** for example for the following functions: *Delete message*, *Reply / Reply to all*, *Forward to no.* / *Forward to e-mail / Forward to many*, *Message details*, *Play presentation*, *Continue present.*, *View text*, *Open image*, *Open sound clip*. Select

- *View text* to view the text part of the message.
- *Open image* to view the image included in the message. Press **Options** to zoom the image, save it in the *Gallery* menu, set its contrast or view its details.
- *Open sound clip* and press **Options** to play the sound clip, save it in the *Gallery* menu or view its details.

Copyright protections may prevent some images, ringing tones, and other content from being copied, modified, transferred or forwarded.

Deleting messages

To delete a text or multimedia message that you are reading or viewing, press **Options** and select the desired function.

To delete all messages from a folder or all the folders:

1. Press **Menu** in standby mode and select *Messages*, *Text messages* or *Multimedia msgs.*, and *Delete messages*.
2. To delete all the messages from a folder, select the desired folder and press **OK**.

To delete all the messages from all the text message folders, select *All messages* and press **OK**.

Voice messages

Voice mailbox is a network service and you may need to subscribe to it first.

Press **Menu** in standby mode, and select *Messages* and *Voice messages*. Select *Voice mailbox number* to save the number of your voice mailbox or *Listen to voice messages* to call it.



Tip: To quickly call your voice mailbox, press and hold

Info messages

This network service allows you to receive messages on various topics from your service provider.

Press **Menu** in standby mode, and select *Messages* and *Info messages*. For available topics and the relevant topic numbers, contact your service provider.

Message settings

Settings for text and e-mail messages

Press **Menu** in standby mode, and select *Messages*, *Message settings*, *Text messages* and *Sending profile*. Select the group of settings ('sending profile') whose settings you want to change. Next, select

- *Message centre number* to save the phone number needed for sending text and picture messages. You obtain this number from your service provider.
- *Messages sent via* to choose the message type *Text*, *E-mail*, *Paging* or *Fax* (network service).
- *Message validity* to choose how long the network should attempt to deliver your message to its recipient (network service).
- *Default recipient number* to save a phone number where messages are sent by default when this sending profile is used. This setting is shown when the *Messages sent via* setting is *Text*.

If the *Messages sent via* setting is *E-mail*, this setting is *E-mail server* that allows you to save the phone number of the e-mail server.

- *Delivery reports* to request the network to send delivery reports on your messages (network service).

- *Use GPRS* and *Yes* to set the phone to send text messages over (E)GPRS connection if this is possible. Also, set the *GPRS connection* to *Always online*, see "GPRS" on page 33.
- *Reply via same centre* to allow the recipient of your message to send you a reply message via your message centre (network service).
- *Rename sending profile* to change the name of the sending profile. The name of the default profile cannot be changed.

Overwriting settings

You can set the phone to automatically replace old messages with new ones. Press **Menu** in standby mode, and select *Messages*, *Message settings*, *Text messages* and *Overwriting in sent items* or *Overwriting in inbox*. Select *Allowed* to set the phone to replace the old text messages with new ones in the *Sent items* or *Inbox* folder, respectively.

Settings for multimedia messages

Press **Menu**, and select *Messages*, *Message settings* and *Multimedia msgs..* Select

- *Save sent messages* and *Yes* to set the phone to save sent multimedia messages in the *Sent items* folder. If you select *No*, the sent messages are not saved.

- *Delivery reports* to request the network to send delivery reports on your messages (network service).
- *Default slide timing* to define how long each slide in your presentations is shown by default.
- *Allow multimedia reception* to allow (*Yes*) or prevent (*No*) the reception of multimedia messages or to allow it only in your home network (*In home network*).
- *Incoming multimedia messages* to set the phone to automatically retrieve received multimedia messages (*Retrieve*), or select *Reject* if you do not want to receive multimedia messages.

This setting is not shown if *Allow multimedia reception* is set to *No*.

- *Connection settings* to define the browser settings for retrieving newly received multimedia messages. Activate the connection set where you want to save the settings and then edit them. See also "Keying in the service settings manually" on page 47.

For proper settings, contact your network operator or service provider.

- *Allow adverts* to allow or prevent the reception of advertisements. This setting is not shown if *Allow multimedia reception* is set to *No* or *Incoming multimedia messages* is set to *Reject*.

Font size setting

To select the font size for reading and writing messages, press **Menu**, and select *Messages*, *Message settings*, *Other settings* and *Font size*.

Service commands

You can send service requests to your service provider (network service). To access this menu, press **Menu** in standby mode, and select *Messages* and *Service commands*. Key in the desired characters and press **Send**.

■ Call register (Menu 2)



In this menu you can view the phone numbers of missed, received and dialled calls, and the approximate length of your calls.

Missed, received and dialled calls

To view the phone numbers of missed, received and dialled calls, press **Menu** in standby mode and select *Call register*. Select

- *Missed calls* to view up to ten phone numbers from which somebody has most recently tried to call you with no success (network service).
- *Received calls* to view up to ten phone numbers from which you have most recently accepted calls (network service).

- *Dialled numbers* to view up to ten phone numbers that you have most recently called or attempted to call. See also "Calling a recently dialled number" on page 7.
- *Delete recent call lists* to clear the lists of missed, received, and dialled calls.
- *GPRS data counter* to view the amount of data that has been sent and received during the (E)GPRS connections.
- *GPRS connection timer* to view the duration of (E)GPRS connections.

Notes about missed, received and dialled calls

- The phone registers missed and received calls only if the network supports these functions and the phone is switched on and within the network's service area.
- If you press **Options** in the *Missed calls*, *Received calls* or *Dialled numbers* menu, you can, for example, view the date and time of the call, call the registered phone number, save it in the contacts list or send a message to the number.

Call counters and call timers



Note: The actual invoice for calls and services from your service provider may vary, depending upon network features, rounding-off for billing, taxes and so forth.

Press **Menu** in standby mode and select *Call register*. Select

- *Call duration* to view the approximate duration of your incoming and outgoing calls.

■ Contacts (Menu 3)



You can save names and phone numbers (contacts) in the phone's memory and in the SIM card's memory.

To access this menu: Press **Menu** in standby mode and select *Contacts*.

The number of names that can be saved depends on their length, and the number and length of related phone numbers and text items. The phone supports SIM cards that can save up to 250 names and phone numbers.

Contacts saved in the phone's memory use shared memory, see page x.

Alternative ways to access the functions in this menu

You can access the functions also by pressing **Contacts** in standby mode (or by pressing **Go to** and selecting *Contacts*).

Some of the functions can also be accessed as follows: Press **▼** in standby mode, scroll to the name you want, press **Details**, scroll to a number or text item, press **Options** and select the desired function.

To access the contacts during a call, press **Options** and select *Contacts*.

Selecting the settings for contacts

Press **Menu** in standby mode and select **Contacts** and **Settings**. Select

- **Memory in use** to select the contact memory you want to use. If you want to search for names and phone numbers in both memories, select **Phone and SIM**. In this case, the names and numbers will be saved in the phone's memory.
- **Contacts view** to select how the names, numbers and images are displayed in the contacts list. For example, select **Name and image** to view the names with the attached images.
- **Memory status** to view how much free memory is available in each contact memory.

Saving names and phone numbers

1. Press **Menu** in standby mode and select **Contacts** and **Add contact**.
2. Key in the name and press **OK** to save it.
3. Key in the phone number, including the area code, and press **OK** to save it.
- To use the phone number while abroad, press  twice (for the + character) and key in the country code, area code (omit the leading zero, if necessary) and phone number.

4. When the name and number are saved, press **Done**.



Tip: To quickly save a name and phone number, key in the phone number in standby mode, press **Options** and select **Save**.

Saving multiple numbers and text items per name

You can save different types of numbers and text items per name in the phone's contact memory.

The first phone number that you save with the name is the default number. It is indicated with a frame around the number type indicator, for example . When you select a name from the contacts list, for example to make a call, the default number is used unless you select another number.

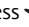
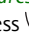
1. Make sure that the selected memory is **Phone** or **Phone and SIM**.
2. Press  in standby mode.
3. Scroll to the name to which you want to add a number or text item, and press **Details**.
4. Press **Options**, and select **Add number**, **Add detail** or **Change type**.
 - To add a phone number, select **Add number** and a number type. Key in the number, and press **OK** to save it.
 - To add a text item, select **Add detail** and a text type, for example **E-mail address**. To add a special character, press .

- To change the type of the selected number or text item, select *Change type* and the desired type.
5. Press **Back** and then **Exit** to return to standby mode.

Changing the default number

Press  in standby mode, scroll to the desired name and press **Details**. Scroll to the number you want to set as the default number. Press **Options** and select *Set as default*.

Adding an image to a saved name or number

You can add an image to a name or number saved in the phone's memory. The image is shown when you receive a call from the given phone number.

Press  in standby mode, scroll to the name (and number) to which you want to add an image and press **Details**. Press **Options** and select *Add image*. The list of folders in the *Gallery* menu is shown. Scroll to the desired image, press **Options** and select *Save to contacts*.

Searching for a name in the contacts

1. Press **Menu** in standby mode and select *Contacts* and *Search*. **OR:** Press  in standby mode.
2. Key in the first letter(s) of the desired name, if you want.

3. Scroll to the desired name, and press **Details**. If the name is saved on the SIM card,  is shown at the top of the display.
4. Scroll through the phone numbers and text items added to the name.

Deleting contacts

Press **Menu** in standby mode and select *Contacts* and *Delete*. Select *One by one* or *Delete all*.

Deleting a name and number will also delete the additional numbers, text items and image added to it. Deleting an image from the contacts does not delete it from the *Gallery* menu.

Deleting a number, text item or image added to a name

Press  in standby mode, scroll to the desired name (and number) and press **Details**. Scroll to the number, text item or image you want to delete, press **Options**, select the appropriate function, and press **OK**.

Editing a name, number or text item

Press  in standby mode, scroll to the desired name and press **Details**. Scroll to the desired name, number or text item and press **Options**. Select the desired function, for example *Edit detail* to edit a text item.

Copying contacts

You can copy names and phone numbers from the phone to the SIM card and vice versa. Text items or images saved in the phone will not be copied to the SIM card.

Press **Menu** in standby mode and select **Contacts** and **Copy**. Select the copying direction. Select **One by one**, **All** or **Default numbers** (shown when you copy from the phone). Select whether you want to keep the original names and numbers (**Keep original**) or delete them (**Move original**).

Other functions related to the contacts list

To access the following functions, press **Menu** in standby mode and select **Contacts**. Select

- **Info numbers** to call the information numbers of your service provider if they are available on your SIM card (network service).
- **Service numbers** to call the service numbers of your service provider if they are available on your SIM card (network service).
- **My numbers** to view the phone numbers assigned to your SIM card if this is allowed by the card.
- **Caller groups** to arrange the names and phone numbers saved in the **Contacts** menu into caller groups. For each group, you can select a ringing tone and a logo that is

shown when you receive a call from an identified phone number that belongs to the given group.

You can select from the following functions: **Group name**, **Group ringing tone**, **Group logo**, **Group members**.

If you selected **Group members**, press **Add** (or press **Options** and select **Add contact**) to add a name to the group. To delete a name from the group, press **Options** and select **Remove contact**.

See also **Alert for** in "Tone settings" on page 29.

Speed dials

You can set the keys $\left(\begin{smallmatrix} 2 \\ ABC \end{smallmatrix}\right)$ to $\left(\begin{smallmatrix} 9 \\ WXYZ \end{smallmatrix}\right)$ to work as speed dialling keys. To make a call using speed dialling, see page 7.

Assigning a phone number to a speed dialling key

Press **Menu** in standby mode and select **Contacts** and **Speed dials**. Scroll to the desired key and press **Assign**. Press **Search** and select the name and number you want to assign to the selected key.

If a phone number is already assigned to the key, you can view or change the number or delete the assignment by pressing **Options** and selecting the desired function.

Business cards

You can send or receive a person's contact information as a business card.

To send a business card to a compatible phone or other device that supports the vCard standard: Press **⌵** in standby mode, scroll to the desired name, and press **Details**. Press **Options** and select *Send bus. card*. Select *Via infrared* or *Via text message* (network service).

When you receive a business card, press **Show** and **Save** to save the business card in the phone's memory. To discard the business card, press **Exit** and **OK**.

■ Settings (Menu 4)



In this menu you can change various settings of the phone. You can also reset some menu settings to their default values.

To access this menu: Press **Menu** in standby mode and select *Settings*.

Profiles

Your phone has several setting groups, 'profiles', for which you can customise the phone tones for different events and environments.

To access this menu: Press **Menu** in standby mode and select *Settings* and *Profiles*.

1. Select a profile that you want to activate or whose settings you want to change.
2. Select *Activate*, *Personalise* or *Timed*.

- To activate the selected profile, select *Activate*.
- To activate the profile for a certain amount of time, select *Timed* and set the end time. When this time expires, the previous profile that was not timed, becomes active.
- To change the profile settings, select *Personalise*. Select the setting you want to change and make the change.

For information on the settings, see "*Tone settings*" on page 29. With *Profile name* you can rename the selected profile. The *General* profile cannot be renamed.

The name of the currently active profile is shown in standby mode, except when the *General* profile is active. If the profile is timed, **⌚** is shown in front of its name.



Tip: To change the profile quickly in standby mode, press the power key **⏻** and select the profile you want to activate.

Tone settings

You can change the tone and vibrator settings of the currently selected profile. The same settings can also be found in the *Profiles* menu, see page 29.

To access this menu: Press **Menu** in standby mode, and select *Settings* and *Tone settings*. Select

- *Incoming call alert* to choose how the phone notifies you of an incoming voice call. The options are *Ringing*, *Ascending*, *Ring once*, *Beep once* and *Off*.

- *Ringing tone* to select the tone that rings when you receive a voice call. To select a ringing tone from the *Gallery* menu, select *Open gallery*.

A sound clip recorded with the *Voice recorder* function (see page 41) can also be set as a ringing tone.

- *Ringing volume* to select the volume level for the ringing tones and message alert tones.
- *Vibrating alert* to set the phone to vibrate when you receive a call or message. The vibrating alert does not work when the phone is connected to a charger, desktop stand or car kit.
- *Message alert tone* to select the tone you hear when you receive a message. To select the tone from the ringing tone list, select *Ringing tone* and the desired tone.
- *Keypad tones* to select the volume for keypad tones.
- *Warning tones* to set the phone to sound tones, for example, when the battery is running out of power.

- *Alert for* to set the phone to ring only upon calls from phone numbers that belong to a certain caller group. Scroll to the caller group you want or *All calls* and press **Mark**. See also the *Caller groups* setting in the *Contacts* menu.

When *Incoming call alert* is set to *Off* and *Message alert tone* is set to *Off*,  is shown in standby mode.

Adding new tones to your phone

For availability of tones via the text messaging (SMS), multimedia messaging (MMS) or browser service, contact your network operator or service provider. The tones are saved in the *Gallery* menu.

Display settings

To access this menu: Press **Menu** in standby mode, and select *Settings* and *Display settings*. Select

- *Wallpaper* to set the phone to show a background image, 'wallpaper', when the phone is in standby mode.

The wallpaper images can be found in the *Gallery* menu. You can save new images, for example, from multimedia messages. Also photos taken with the phone's camera can be used as the wallpaper.

To set an image as the wallpaper:

- To select the wallpaper image for the first time or to change the image, select **Select wallpaper**. Scroll to the folder you want, press **Open** and scroll to the desired image. Press **Options** and select **Set as wallpaper**.
- If you have previously used the wallpaper but have then selected **Off**, select **On**.
- **Colour schemes** to select the colour for some parts of the phone display, such as the signal strength indicator.
- **Operator logo** to set the phone to display or hide the operator logo saved in the phone. If there is no operator logo available in the phone, this function is dimmed. For availability of operator logos, contact your network operator or service provider.
- **Screen saver timeout** to set the time after which the screen saver feature is activated. The screen saver is a power saving feature which becomes active if the phone is not used for a certain length of time in standby mode. You can deactivate the screen saver by pressing any key.
- **Display brightness** to change the brightness level. Press **(◀)** to decrease or increase the level, and press **OK** to accept it.

- **Menu view** to set the way the phone displays the main menu. If you select **List**, the menus are shown as a list. If you select **Grid**, the menus are shown as a grid. In the grid view, the menu name is shown at the top of the display.

Time and date settings

To access this menu: Press **Menu** in standby mode, and select **Settings** and **Time and date settings**. Select

- **Clock** to set the time, show (or hide) the time in standby mode or select the 12-hour or 24-hour time format and the time zone. If the battery is removed from the phone for a long time, you may need to set the time again.

The clock settings apply to several functions such as **Messages**, **Call register**, **Alarm clock** and **Calendar**.

- **Date** to show (or hide) the date in standby mode, set the date or select the date format or date separator. If the battery is removed from the phone for a long time, you may need to set the date again.
- **Auto-update of date & time** to set the phone to automatically update the time and date according to the current time zone (network service).

Automatic update of date and time does not change the time you have set for the alarm clock, calendar or alarm notes.

Personal shortcuts

You can select the function for the right selection key shown in standby mode and the functions ('personal shortcuts') that can be accessed by pressing **Go to** in standby mode or by entering the *Go to* menu.

See also "[Standby mode and display indicators](#)" on page 1 and "[Go to \(Menu 10\)](#)" on page 52.

To access this menu: Press **Menu** in standby mode, and select *Settings* and *Personal shortcuts*. Select

- *Right selection key* to select the function for the right selection key.
- *Select Go to options* to select the functions for your shortcut list. Scroll to a function and press **Mark** to add it to the list. To remove a function from the list, press **Unmark**. To save the changes, press **Done** and **Yes**.
- *Organise Go to options* to change the order of the functions on the list. Scroll to the desired function, press **Move** and select where you want to move the function to.

Connectivity

In this menu you can connect the phone to a compatible device via an infrared connection and define when the phone connects to the (E)GPRS network.

Infrared

The phone has an infrared port for connecting it to another IrDA compliant device, for example to send business cards or calendar notes.



To activate the infrared port: Press **Menu** in standby mode, and select *Settings*, *Connectivity* and *Infrared*.

Do not point the IR (infrared) beam at anyone's eye or allow it to interfere with other IR devices. This device is a Class 1 Laser product.

Sending and receiving data via IR

- Ensure that the infrared ports of your phone and the other device are pointing at each other and that there are no obstructions between the devices. The preferable distance between the two devices in an infrared connection is one metre at the most.
- To receive data, activate the infrared port by accessing this menu. If data transfer is not started within two minutes, the connection is cancelled and has to be started again.
- To send data from your phone, select the function from which you want to send data over the infrared connection.

Checking the status of the infrared connection

- When  is shown continuously, the infrared connection is active and your phone is ready to send or receive data via its infrared port.
- When  blinks, your phone is trying to connect to the other device or the connection has been lost.

GPRS

In this menu you can define when the phone connects to the (E)GPRS network (network service). For general information about the (E)GPRS service, see page xi.

To access this menu: Press **Menu** in standby mode, and select *Settings*, *Connectivity* and *GPRS*.

Select *GPRS connection* and *Always online* or *When needed*.

- If you select *Always online*, the phone automatically registers to a (E)GPRS network when you switch the phone on, if the (E)GPRS network is available in your location.

If you select *When needed*, the phone registers and connects to the (E)GPRS network only if you use a function that needs the (E)GPRS service. In this case, establishing the connection may take longer than when *Always online* is selected.

GPRS indicators

When the selected (E)GPRS connection mode is *Always online* and the (E)GPRS service is available,  is shown on the display.

When you start a function that uses the (E)GPRS service, the phone connects to the (E)GPRS network,  is shown and data transfer is possible.

If you receive a call or a text message, or make a call, during a (E)GPRS connection,  is shown to indicate that the connection is suspended (on hold). The phone tries to re-establish the connection after the call.

Call settings





To access this menu: Press **Menu** in standby mode, and select *Settings* and *Call settings*. Select

- *Call divert* to direct your incoming calls to your voice mailbox or to another phone number (network service). Divert options that are not supported by your SIM card or your network operator may not be shown.

Select the desired divert option, for example, *Divert if busy* to divert voice calls when your number is busy or when you reject an incoming call. Set the divert option on (*Activate*) or off (*Cancel*), or check whether the option is activated (*Check status*).

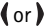
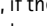
- If you selected *Activate*, select where the calls are to be diverted to. For some divert options you can also select the time after which the call is diverted.

Several divert options can be active at the same time. When all calls are diverted,  is shown in standby mode.

- *Automatic volume control* and *On* to set the phone to automatically keep the earpiece volume at the level that you select with  (or ) during a call. For example, if the environment is noisy, the phone increases the volume.
- *Anykey answer* and *On* if you want to answer an incoming call by briefly pressing any key, except the power key , selection keys, and .
- *Automatic redial* to set the phone to make up to ten attempts to connect the call after an unsuccessful call attempt.
- *Speed dialling* and *On* if you want to call the names and phone numbers assigned to the speed dial keys  to  by pressing and holding the corresponding key.
- *Call waiting* and *Activate* to request the network to notify you when you receive a new call during a call (network service).

- *Summary after call* and *On* to set the phone to briefly display the duration of the last call.
- *Send my caller identity* to show (*Yes*) your phone number to the person you are calling or to hide it (*No*). If you select *Set by network*, the setting agreed upon with your service provider is used. This is a network service.
- *Line for outgoing calls* to select the phone line 1 or 2 for making calls (network service). Calls on both lines can be answered regardless of the selected line.

If you select *Line 2* and have not subscribed to this network service, you will not be able to make calls. When line 2 is selected, 2 is shown in standby mode.

If supported by your SIM card, you can prevent the line selection by selecting the option *Lock*.

Phone settings

To access this menu: Press **Menu** in standby mode, and select *Settings* and *Phone settings*. Select

- *Phone language* to select the language for the display texts. If you select *Automatic*, the phone selects the language according to the information on the SIM card.

- **Memory status** to view the total amount of free and used shared memory and the amount of memory used by different functions.
- **Automatic keyguard** to set the keypad to lock automatically after a certain length of time when the phone is in standby mode. See also "Keypad lock (Keyguard)" on page 9.

To activate the automatic keyguard, select **On** and set the time after which the keypad is locked. To deactivate the automatic keyguard, select **Off**.



Note: When Keyguard is on, calls may be possible to the emergency number programmed into your phone (e.g. 112, 911 or other official emergency number). Key in the emergency number and press . The number is displayed only after you have keyed in its last digit.

- **Cell info display** to set the phone to indicate when it is used in a cellular network based on the Micro Cellular Network (MCN) technology (network service).
- **Welcome note** to define a note that is shown briefly when the phone is switched on. To save the note, press **Options** and select **Save**.

- **Network selection** to set the phone to automatically select a cellular network that is available in your area (**Automatic**) or to select the desired network from a list (**Manual**).

The selected network must have a roaming agreement with your home operator's network. If **No network access** is displayed, select another network.

The phone stays in manual mode until automatic mode is selected or another SIM card is inserted into the phone.

- **Confirm SIM service actions** and **Yes** to set the phone to show confirmation messages when you use SIM card services.
- **Help text activation** to set the phone to show help texts that guide you in using the menu functions.
- **Start-up tone** to set the phone to play a tone when the phone is switched on.

Enhancement settings



You can define the settings that the phone uses by default when it is connected to a compatible enhancement.

To access this menu: Press **Menu** in standby mode, and select **Settings** and **Enhancement settings**.

Select the desired enhancement, for example *Headset* or *Handsfree*. Depending on the enhancement, you can select some of the following functions:

- *Default profile* to select the profile that is automatically activated when you connect the selected enhancement to the phone.
- *Automatic answer* to set the phone to automatically answer an incoming call after five seconds. If the *Incoming call alert* is set to *Beep once* or *Off*, automatic answer cannot be used.
- *Lights* to set the lights permanently on (*On*) or to remain on for 15 seconds after a keypress (*Automatic*).
- *Ignition detector* and *On* to set the phone to automatically switch off about 20 seconds after the car's ignition is turned off. This function is shown if the phone is or has been connected to the full car kit.
- *Use text phone* and *Yes* to use the text phone settings instead of headset or loopset settings with a text phone.

Enhancement indicators in standby mode

When a compatible enhancement is connected to the phone, the corresponding indicator (for example  or ) is shown in standby mode.

Security settings

To access this menu: Press **Menu** in standby mode, and select *Settings* and *Security settings*.



Note: When security features that restrict calls are in use (call barring, closed user group and fixed dialling), calls may be possible to certain emergency numbers in some networks (e.g. 112, 911 or other official emergency numbers).

Select

- *PIN code request* to set the phone to ask for your PIN code every time the phone is switched on. Some SIM cards do not allow this setting to be changed.
- *Call barring service* to restrict the calls that can be made or received with the phone (network service).
- *Fixed dialling* to restrict calls and text messages from your phone to selected phone numbers, if allowed by your SIM card (network service).

When the fixed dialling is on, (E)GPRS connections can only be used for sending text messages. The recipient's phone number and the message centre number have to be included on the fixed dialling list.

- **Closed user group** to specify a group of people whom you can call and who can call you (network service). When you use a closed user group, the group number and  are shown in standby mode.
- **Security level** to define when the phone asks for the security code.
If you select **Phone**, the phone asks for the security code when a new SIM card is inserted into the phone.
If you select **Memory**, the security code is requested when the memory in use is **SIM card** and you want to change the memory to **Phone** or **Phone and SIM** or when you want to copy names and numbers from one contacts list to another.
When you change this setting, the numbers in the menus **Missed calls**, **Received calls** and **Dialled numbers** are deleted.
- **Access codes** to change the security code, PIN code, PIN2 code or barring password. Codes can only include numbers from 0 to 9.

Restore factory settings

You can reset some of the menu settings to their original values.

Press **Menu** in standby mode, and select **Settings** and **Restore factory settings**. Key in the security code and press **OK**. Note that this function does not delete the information you have saved or downloaded to the phone.

Gallery (Menu 5)



In this menu you can manage graphics, images, recordings and tones that you have saved, for example, from multimedia messages. These files are arranged in folders.



Note: Your phone must be switched on to use this function. Do not switch the phone on when wireless phone use is prohibited or when it may cause interference or danger.

Your phone supports a Digital Rights Management (DRM) system to protect content that you have acquired to the phone. A piece of content, such as a ringing tone, can be protected and associated with certain usage rules, for example the number of usage times and a certain usage period. The rules are defined in the content's activation key that can be delivered with the content or separately, depending on the service provider. You may be able to update these activation keys. Always check the delivery terms of any content and activation key before acquiring them, as they may be subject to a fee.

The gallery uses shared memory, see page [x](#).

1. Press **Menu** and select **Gallery**. The list of options is shown.

2. Select *View folders* to open the list of folders.

Other options are:

- *Add folder, Delete folder, Rename folder*: You can add a new folder or delete or rename the folder that you select. The preset folders cannot be deleted or renamed.
 - *Activation key list*: You can view the list of available activation keys. Scroll to the desired file and press **Options**. Select *Details* to view the activation keys.
 - *Gallery downloads*: You can download images and tones (network service). See "[Downloading content and applications](#)" on page x.
3. To open a folder, scroll to the desired folder and press **Open**. The files in the folder are shown.

Pressing **Options** allows access to some of the functions described in "[Options for the files in the gallery](#)" on page 38.

4. To view an image or listen to a sound, scroll to the desired image or sound file, press **Options** and select *Open*.

Options for the files in the gallery

When you have selected or opened a file, you can press **Options** for the following functions: *Open, Delete, Send, Edit image, Move, Rename, Set as wallpaper, Set as ring tone, Details, Sort, Activation key list*. Select

- *Send* to send the file as a multimedia message or via infrared connection.

- *Edit image* to add text, frames and clip-arts to the selected image or to crop the image. Press **Options** and select the desired function.

If you selected *Insert text*, key in the text you want, press **OK** and move the text with the scroll keys. If you press **Options**, you can select the style, size and colour of the text font and rotate the text. To confirm the changes, press **Options** and select *OK*.

If you selected *Insert frame* or *Insert clip-art*, scroll to the desired image, press **Options** and select *Insert*. Move the inserted image with the scroll keys and press **OK**.

To save the modified image in GIF format, press **Options**, select *Save*, edit the image's name, press **OK** and select the desired folder.

- *Details* to view, for example, the size of the file.
- *Sort* to sort the files and folders by name, date, format or size.
- *Activation key list* to update the activation key of the selected file. This option is only shown if the activation key of the file can be updated.

Copyright protections may prevent some images, ringing tones and other content from being copied, modified, transferred or forwarded.

Media (Menu 6)



In this menu you can use the phone's built-in camera, FM radio and voice recorder.

To access this menu: Press **Menu** in standby mode and select *Media*.



Note: Your phone must be switched on to use the functions in the *Media* menu. Do not switch the phone on when wireless phone use is prohibited or when it may cause interference or danger.

Camera

You can take photos with the phone's built-in camera. The camera lens is on the back of the phone. The photos are saved in JPEG format in shared memory, see page x.

To access this menu: Press **Menu** in standby mode, and select *Media* and *Camera*.



Note: Obey all local laws governing the taking of pictures. Do not use this feature illegally.

If there is not enough memory to take a new photo, delete old photos or other files in the *Gallery* menu.

Taking a photo



1. In the *Camera* menu, select the camera mode *Standard photo*, *Portrait photo* or *Night mode*. Select
 - *Portrait photo* if you want to add the photo to a name or phone number saved in the contacts list.
 - *Night mode* if the lighting is dim for taking photos.



Tip: To quickly activate the camera in standby mode, press .

2. Use the display as a viewfinder.

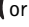

Tip: To quickly change the camera mode, press and hold  (or ) when the live image is shown on the display.

3. To take a photo, press **Capture**. The photo is saved in the *Images* folder of the *Gallery* menu.

4. Select **Back** to take another photo, or press **Options**, for example, to zoom, delete or rename the photo, send it in a multimedia message, or attach it to a name or phone number in the contacts list.



Tip: You can set the camera to automatically take a photo after 10 seconds. In the *Camera* menu, select *Self-timer* and the desired camera mode. Press **Start**. While the self-timer is running, a beeping sound is heard.

Adjusting the camera settings

In the *Camera* menu, select *Settings* and

- *Image quality* to select how much a photo will be compressed when the phone saves it. Select *High*, *Normal* or *Basic*. *High* provides the best image quality but takes more memory.
- *Camera sounds* to set the shutter and self-timer sounds on or off.
- *Default title* to define a default name for photos. If you want to use the preset title, select *Automatic*. If you want to define your own title, select *My title*.

Radio

You can listen to the phone's FM radio via the built-in loudspeaker, the Music Stand DT-1 or a compatible headset. When using the loudspeaker, keep the headset plugged into the phone. The lead of the headset functions as the radio antenna, so let it hang freely.

You can make or answer a call while listening to the radio. Sending or receiving data over a (E)GPRS or HSCSD connection may interfere with the radio.

To access this menu: Press **Menu** in standby mode, and select *Media* and *Radio*.

Note that the quality of the radio broadcast depends on the radio station's coverage in your area.





1. To switch on the radio, press **Menu** in standby mode and select *Media* and *Radio*.
2. If you have previously saved radio channels, scroll to the channel you want to listen to, or select the memory location of the channel by pressing the corresponding key ($\left(\frac{1}{\text{FM}}\right)$ to $\left(\frac{9}{\text{HSCSD}}\right)$).

If the compatible headset you are using has a headset key, you can scroll through the saved channels by pressing this key.

3. To turn the radio off, press **Options** and select *Switch off* in the *Radio* menu. **OR:** Press and hold $\left(\frac{\text{END}}{\text{CALL}}\right)$ in any function or standby mode.

Tuning and saving a radio channel

When the radio is on, you can search for a radio channel in the following ways in the *Radio* menu and then save the desired channel for later use:

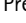
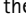
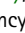
- Automatic search: Press and hold  or  to start the search. Searching stops when a channel is found. **OR:** Press **Options**, select *Automatic tuning* and press  or  to start the search.
- Manual search: Press **Options** and select *Manual tuning*, or press . Press  or  to browse through the radio frequencies or press and hold either of these keys to quickly search for a channel.
- Keying in a frequency: Press **Options** and select *Set frequency*, or press . Key in the frequency of the channel you want to listen to and press **OK**.

To save the channel: Press **Options** and select *Save channel*.

Other options related to the radio

Pressing **Options** in the *Radio* menu also allows access to the following functions: *Delete channel*, *Rename*, *Loudspeaker / Headset* or *Mono output / Stereo output*.

Select *Rename* to change the name of a channel. Select *Loudspeaker* (or *Headset*) to listen to the radio using the loudspeaker (or headset).

Voice recorder

You can record, for example, a name and a phone number and write them down later.

To access this menu: Press **Menu** in standby mode, and select *Media* and *Voice recorder*.



Note: Obey all local laws governing recording of calls. Do not use this feature illegally.

- To start the recording, select *Record* (or press **Options** and select *Record* during a call). Hold the phone in the normal position near to your ear.

To stop the recording, press **Stop**. The recording is saved in the *Recordings* folder of the *Gallery* menu.

- To listen to the latest recording, select *Replay last*.
- To listen to or manage previous recordings, select *Recordings list*. The list of folders in the *Gallery* menu is shown. Open *Recordings*, press **Options** and select the function you want to use.
- To send the most recent recording as a multimedia message or via infrared connection to a compatible phone, select *Send*.

■ **Organiser** (Menu 7)



In this menu you can use the phone's built-in alarm clock, calendar and calculator.

To access this menu: Press **Menu** in standby mode and select *Organiser*.



Note: Your phone must be switched on to use the functions in the *Organiser* menu. Do not switch the phone on when wireless phone use is prohibited or when it may cause interference or danger.

Alarm clock

You can set the phone to alarm at the desired time.

To access this menu: Press **Menu** in standby mode and select *Organiser* and *Alarm clock*.

To set an alarm, select *Alarm time* and *On*, key in the alarm time and press **OK**. To change the alarm time, select *On*.

To set a tone for the alarm, select *Alarm tone* and the desired tone. You can also select the radio as an alarm tone.

When the alarm clock is on,  is shown in standby mode.

When the alarm time expires

The phone will sound an alert tone and flash *Alarm!* and the current time on the display. Press **Stop** to stop the alarm. If you let the phone alarm for a minute or press **Snooze**, the alarm stops for about ten minutes and then resumes.

If the alarm time is reached while the phone is switched off, the phone switches itself on and starts sounding the alarm tone. If you press **Stop**, the phone asks whether you want to activate the phone for calls, *Switch the phone on?* Press **No** to switch off the phone or **Yes** to make and receive calls.



Note: Do not press **Yes** when wireless phone use is prohibited or when it may cause interference or danger.

Calendar

The calendar helps you to keep track of reminders, calls that you need to make, meetings, and birthdays. The calendar uses shared memory, see page x.

To access this menu: Press **Menu** in standby mode and select *Organiser* and *Calendar*. The month view is shown. You can scroll through the days, weeks and months with the scroll keys.



Tip: To quickly open the calendar in standby mode, press **⏏**.

Using the different calendar views

- **Month view:** This view shows the weeks of a month. The current day is indicated by a frame around it. If there are notes for the day, the day is shown in bold. To view the notes set for a day ('day view'), scroll to the desired day, press **Options** and select *Day notes*.

Pressing **Options** also allows access to the following functions: *Week view, Make a note, Go to date, Settings*. Select

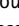
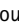
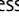
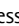
- *Settings* to set the date and time or to select their format, the separator character (for example -) or the first day of the week (*Week starts on*). With *Auto-delete* you can set the phone to delete old notes automatically after a certain length of time.
- **Day view:** This view shows the notes set for the selected day. You can scroll through the notes by pressing  or  and through the days by pressing  or . Press **Options** and select *View* to open the selected note ('note view').

Pressing **Options** also allows access to the following functions: *Make a note, Delete, Edit, Move, Repeat, Go to date, Send note, Copy, Settings*. Select

- *Repeat* to select the interval at which the note is repeated.

- **Note view:** This view shows the note that you opened in the day view.

You can press **Options** for the following functions: *Edit, Delete, Move, Repeat, Send note, Copy, Settings*.

Making a calendar note

You can create a new note in the month, week or day view.

In the month or week view, scroll to the desired day, press **Options** and select *Make a note*. In the day view, press **Options** and select *Make a note*.



Select one of the following note types:

 *Meeting*,  *Call*,  *Birthday*,
 *Memo*,  *Reminder*.

Make a note and save it. For example, to save a note for a meeting with an alarm, do as follows:

Key in the subject for the meeting, press **Options** and select *Save*. Key in the location, press **Options** and select *Save*. Key in the start time and press **OK**. Key in the end time and press **OK**. To set the alarm for the note, select *With tone* or *Silent* (no alarm tone) and set the alarm time.

When the phone sounds an alarm for a note

The phone beeps and displays the note. When a call note  is displayed, you can call the number by pressing .

To stop the alarm and view the note, press **View**. If you press **Snooze** when the note is shown, the alarm stops for about ten minutes and then resumes.

To stop the alarm without viewing the note, press **Exit**.

Calculator

The phone includes a calculator that can also be used for approximate currency conversions.

To access this menu: Press **Menu** in standby mode, and select **Organiser** and **Calculator**.

This calculator has a limited accuracy and rounding errors may occur, especially in long divisions.

1. Key in the first number in the calculation. Press $\frac{\text{#}}{\text{.}}$ for a decimal point.
2. Press **Options** and select **Add**, **Subtract**, **Multiply**, **Divide**, **Square**, **Square root** or **Change sign**. **OR:** Press $\frac{+}{-}$ once to add, twice to subtract, three times to multiply or four times to divide.
3. Key in the second number, if needed in the calculation.
4. For a total, press **Options** and select **Equals**.
5. Press and hold **Clear** for a new calculation.

Making a currency conversion

1. To save the exchange rate, press **Options** and select **Exchange rate**. Select either of the available conversion options. Key in the exchange rate (press $\frac{\text{#}}{\text{.}}$ for a decimal point) and press **OK**.
2. To make the conversion, key in the desired amount, press **Options** and select **In domestic** or **In foreign**.



Tip: To make a currency conversion in standby mode, key in the amount, press **Options** and select **In domestic** or **In foreign**.

■ Applications (Menu 8)



In this menu you can use and manage the Java games and applications installed in the phone.

To access this menu: Press **Menu** in standby mode and select **Applications**.

The phone supports Java 2 Micro Edition (J2ME™) which is a version of Java technology specifically designed for small consumer electronics products.

Before you can use a Java application you have to transfer it to your phone. Java applications use shared memory, see page [x](#).



Note: Your phone must be switched on to use the functions in the *Applications* menu. Do not switch the phone on when wireless phone use is prohibited or when it may cause interference or danger.

Games

In this menu you can play the Java games installed in the phone.

To access this menu: Press **Menu** in standby mode and select *Applications* and *Games*.

Game settings: Select *Settings* to set sounds, lights and vibrations (*Shakes*) for the games. When the *Vibrating alert* function in the *Tone settings* menu is off, the phone does not vibrate even if you set *Shakes* on.

To start a game, select *Select game*, scroll to the desired game and press , or press **Options** and select *Open*. You can press **Options** for the same functions as in the *Collection* menu. Note that running some games may consume the phone's battery faster (and you may need to connect the phone to the charger).

To view the amount of memory available for games, select *Memory*.

To download a game to the phone, select *Game downloads* and see "*Downloading content and applications*" on page x. When downloading a game, it may be saved in the *Collection* menu instead of the *Games* menu.

Collection

In this menu you can use and manage the Java applications installed in the phone.

To access this menu: Press **Menu** in standby mode and select *Applications* and *Collection*.

To launch an application, select *Select application*. Scroll to the application or application set that you want to use. Press **Options** and select *Open*, or press , to launch the application or to open the application set.

Note that running some applications may consume the phone's battery faster (and you may need to connect the phone to the charger).

Other options available for an application or application set

You can access the functions below by pressing **Options** in the applications list. Select

- *Delete* to delete the selected application or application set from the phone.

- *Web access* to restrict the application from accessing the network. Select *Ask first* to set the phone to ask for the access, *Allowed* to allow the access, or *Not allowed* not to allow the access.
- *Update version* to look for a new version of the application from an Internet service (network service).
- *Web page* to access an Internet page related to the application. This option is shown only if the application contains the Internet address of the page.
- *Connect via* to set the phone to use specific service settings if the application needs them. The phone uses as default the service settings for the browser.
- *Details* to view additional information about the application.

Downloading a Java application

You can download new Java applications in the following ways:

- In the *Collection* menu, select *App. downloads*. For details, see "Downloading content and applications" on page x.
- Press **Menu** in standby mode and select *Services* to access a browser page from which you can download the Java application you want.
- Use the *Game downloads* function in the *Games* menu.

- Use the Nokia Application Installer included in the Nokia PC Suite software to transfer new applications from a compatible PC to your phone.



Note that Nokia does not warrant for applications from non-Nokia sites. If you choose to download Java applications from them, you should take the same precautions, for security or content, as you would with any site.

When downloading a game or an application, it may be saved in the *Games* menu instead of the *Collection* menu.

Checking the memory status

To check the amount of memory available for Java applications, select *Memory* in the *Collection* menu.

■ Services (Menu 9)



This menu contains a browser that you can use to access various services. These services may include, for example, weather reports, news or flight times.

To access this menu: Press **Menu** in standby mode and select *Services*.



Note: Your phone must be switched on to use this function. Do not switch the phone on when wireless phone use is prohibited or when it may cause interference or danger.

Check the availability, pricing and tariffs of these browser services with your network operator and/or the service provider. They will also give you instructions on how to use their services.

With your phone's multi-mode browser you can view services that use Wireless Mark-Up Language (WML) or extensible HyperText Markup Language (xHTML) on their pages.

Basic steps for accessing and using browser services

1. Save the settings that are needed to access the service that you want to use. See page 47.
2. Make a connection to the given service. See page 48.
3. Start browsing the pages of the service. See page 49.
4. Once you are finished browsing, end the connection to the service. See page 49.

Setting up the phone for a browser service

You may receive the service settings as an Over The Air (OTA) message from the network operator or service provider that offers the service you want to use. You can also key in the settings manually or define and edit them with Nokia PC Suite.

For more information and the appropriate settings, contact your network operator or service provider that offers the service. The settings may be available, for example, on their website.

Saving the service settings received as a message

- To save the received settings, press **Options** and select **Save**.
- To view or discard the received settings, press **Options** and select **View** or **Discard**.

Keying in the service settings manually

1. In the **Services** menu, select **Settings**, **Connection settings** and **Active service settings**.
2. Scroll to the connection set you want to activate and press **Activate**. A connection set is a collection of settings needed to make a connection to a service.

3. Select *Edit active service settings*.
4. Select the settings one by one and key in all the required settings according to the information you have received from your network operator or service provider.

Appearance settings

1. While browsing, press **Options** and select *Other options* and *Appear. settings*. Or in the *Services* menu, select *Settings* and *Appearance settings*.
2. Select
 - *Text wrapping* to define whether the text continues on the next line if it cannot be shown on one line.
 - *Show images* to show or hide the images on browser pages.
 - *Font size* to select the size for text shown on browser pages.
 - *Character encoding* to select the character set that the phone uses for showing browser pages that do not include that information or to select whether to always use UTF-8 encoding when sending a Web address to a compatible phone.

Cookie settings

You can set the phone to allow or prevent receipt of cookies.

A cookie is data item, for example your user information, that the service saves in the cache memory of your phone. Cookies are deleted if you clear the cache memory, see page 51.

1. While browsing, press **Options** and select *Other options*, *Security* and *Cookies*. Or in the *Services* menu, select *Settings*, *Security settings* and *Cookies*.
2. Select *Allow* or *Reject*.

Making a connection to a browser service

1. Activate the settings of the service that you want to use:
In the *Services* menu, select *Settings* and *Connection settings*. Select *Active service settings*, scroll to the desired connection set and press **Activate**.
2. Make a connection in one of the following ways:

- Open the start page, for example the homepage of the service provider: In the *Services* menu, select *Home*. **OR:** Press and hold  in standby mode.
- Select the bookmark of the service: In the *Services* menu, select *Bookmarks* and the desired bookmark.

If the bookmark does not work with the current active service settings, activate another set of service settings and try again.





- Key in the address of the service: In the *Services* menu, select *Go to address*, key in the address (press  for special characters), and press **OK**.

Browsing the pages of a service

After you have made a connection to the service, you can start browsing its pages. The functions of the phone keys may vary in different services. Follow the text guides on the display.

If GPRS is selected as the data bearer, see "GPRS" on page 33 for the (E)GPRS indicators shown during the connection.

Using the phone keys while browsing

- Use the scroll keys to browse through the page.
- To select a highlighted item, press .
- To key in letters and numbers, use the keys  to . To insert a special character, press .

Options while browsing

Some of the following options may be available while browsing. Press **Options** and select the desired option. The service provider may also offer other options.

The options are: *Open*, *Home*, *Shortcuts*, *Add bookmark*, *Bookmarks* (see page 50), *Download links*, *Save to folder*, *Save image*, *Other options*, *Reload*, *Quit* (to end the connection, see page 49).

Select

- *Home* to return to the homepage of the service provider.
- *Shortcuts* to open a new list of options that can be, for example, specific to the page.
- *Add bookmark* to save the current page as a bookmark.
- *Download links* to view the list of bookmarks for downloading content. For more information, see step 2 in "Downloading content and applications" on page x.
- *Save image* to save the selected image in the *Gallery* menu.
- *Other options* to view a list of other available options. These include, for example, *Use detail* (to copy, for example, a phone number from the page), *Go to address*, *Service inbox* (see page 50), *Appear. settings* (see page 48), *Security* (for security information and cookie setting), *Clear the cache* (see page 51).
- *Reload* to reload and update the current page.

Disconnecting from a browser service

To quit browsing and to end the connection, press **Options**, select *Quit* and, when *Quit browsing?* is shown, press **Yes**. **OR:** Press and hold .



Note: The information or services you have accessed are stored in the cache of your phone. A cache is a buffer memory, which is used to store data temporarily. If you have tried to access or have accessed confidential information requiring passwords (for example, your bank account), empty the cache of your phone after each use.

To empty the cache, see "[Emptying the cache memory](#)" on page 51.

Bookmarks

To use and manage the page addresses that you have saved as bookmarks in the phone's memory:

1. While browsing, press **Options** and select *Bookmarks*, or select *Bookmarks* in the *Services* menu.
2. Scroll to the desired bookmark and press **Options**.
3. Select *Go to* to make a connection to the page associated with the bookmark. You can also, for example, edit or delete the bookmark, send it to another phone, save it in the desired folder or create a new bookmark.

Note that your phone may have some pre-installed bookmarks for sites not affiliated to Nokia. Nokia does not warrant or endorse these sites. If you choose to access them, you should take the same precautions, for security or content, as you would with any Internet site.

Receiving a bookmark

When you receive a bookmark as an OTA message, press **Options** and select *View* to view the bookmark, *Save* to add it to the bookmark list or *Discard* to discard it.

Service inbox

The phone is able to receive service messages ('pushed messages') from your service provider (network service).

To set the phone to receive service messages: In the *Services* menu, select *Settings*, *Service inbox settings*, *Service messages*, and *On*.

To set the phone to automatically fetch the content indicated in the service message: In the *Services* menu, select *Settings*, *Service inbox settings*, *Automatic connection* and *On*.

To view a service message:

1. Press **Show** to view the message right away or press **Exit** to view it later in *Service inbox* in the *Services* menu. OR: While browsing, press **Options** and select *Other options* and *Service inbox*.

2. Scroll to the message you want and press **Options**. Select *Retrieve* to fetch the content indicated in the message, *Details* to view the details of the service message or *Delete* to delete the message.

Emptying the cache memory

In the *Services* menu, select *Clear the cache*. **OR:** While browsing, press **Options** and select *Other options* and *Clear the cache*.

Browser security

Security features may be required for some services, such as banking services. For such connections you need security certificates and possibly a security module which may be available on your SIM card. For more information, contact your service provider.

Security module

The security module can contain certificates as well as private and public keys. The security module is to improve security services for functions requiring browser connection, and allows you to use a digital signature. The certificates are saved in the security module by the service provider.

In the *Services* menu, select *Settings*, *Security settings* and *Security module settings*. Select

- *Security module details* to view the security module's title, status, manufacturer and serial number.
- *Module PIN request* and *On* to set the phone to ask for the module PIN when using services provided by the security module.
- *Change module PIN* to change the module PIN, if allowed by the security module.

Certificates

The phone supports three kinds of certificates: server certificates, authority certificates and user certificates. You may receive these certificates from a service provider. Authority certificates and user certificates may also be saved in the security module by the service provider. For details and availability, contact your service provider.

When using a server certificate, the security indicator  is displayed during a connection, if the data transmission between the phone and the gateway (identified by the *IP address* in the *Edit active service settings*) is encrypted. However, the security indicator does not indicate that the data transmission between the gateway and the content server (place where the requested resource is saved) is secure. It is up to the service provider to secure the data transmission between the gateway and the content server.

■ Go to (Menu 10)



In this menu you can activate the functions that can be accessed by pressing **Go to** in standby mode.

To access this menu: Press **Menu** in standby mode and select **Go to**.

To remove functions from or add more functions to the list, see "**Personal shortcuts**" on page 32.

You can set the phone to show the confirmation messages sent between your phone and the network when you are using a SIM service. Select the option **Yes** in the **Confirm SIM service actions** setting, see page 35.

Note that accessing these services may involve sending a text message (SMS) or making a phone call for which you may be charged.

■ SIM services (Menu 11)



In addition to the functions available on the phone, your SIM card may provide additional services that you can access in this menu. This menu is shown only if it is supported by your SIM card. The name and contents of the menu depend on the services available.



Note: For availability, rates and information on using SIM services, contact your SIM card vendor, e.g. network operator, service provider or other vendor.

6. Battery information

■ Charging and Discharging

Your phone is powered by a rechargeable battery.

Note that a new battery's full performance is achieved only after two or three complete charge and discharge cycles!

The battery can be charged and discharged hundreds of times but it will eventually wear out. When the operating time (talk-time and standby time) is noticeably shorter than normal, it is time to buy a new battery.

Use only batteries approved by the phone manufacturer and recharge your battery only with the chargers approved by the manufacturer. Unplug the charger when not in use. Do not leave the battery connected to a charger for longer than a week, since overcharging may shorten its lifetime. If left unused a fully charged battery will discharge itself over time.

Temperature extremes can affect the ability of your battery to charge.

Use the battery only for its intended purpose.

Never use any charger or battery which is damaged.

Do not short-circuit the battery. Accidental short-circuiting can occur when a metallic object (coin, clip or pen) causes direct connection of the + and - terminals of the battery (metal strips on the battery) for example when you carry a spare battery in your pocket or purse. Short-circuiting the terminals may damage the battery or the connecting object.

Leaving the battery in hot or cold places, such as in a closed car in summer or winter conditions, will reduce the capacity and lifetime of the battery. Always try to keep the battery between 15°C and 25°C (59°F and 77°F). A phone with a hot or cold battery may temporarily not work, even when the battery is fully charged. Batteries' performance is particularly limited in temperatures well below freezing.

Do not dispose of batteries in a fire !

Dispose of batteries according to local regulations (e.g. recycling). Do not dispose as household waste.

7. Genuine Enhancements

A new extensive range of enhancements is available for your phone. Select the enhancements which accommodate your specific communication needs.



Some of the enhancements are described in detail below.

For availability of the enhancements, please check with your local dealer. A few practical rules for enhancements operation:

- Keep the enhancements out of small children's reach.
- When you disconnect the power cord of any accessory, grasp and pull the plug, not the cord.
- Check regularly that all mobile phone equipment in a vehicle is mounted and operating properly.

Use only batteries, chargers and enhancements approved by the phone manufacturer. The use of any other types may invalidate any approval or warranty applying to the phone, and may be dangerous.

■ Battery

Type	Tech	Talktime*	Standby*
BLD-3	Li-Ion	Up to 2h - 4h	Up to 6 days - 12 days

* Variation in operation times may occur depending on SIM card, network and usage settings, usage style and environments. Use of FM radio and integrated hands-free will affect talktime and standby.

■ Indoor

Travel Charger (ACP-12)

Small, lightweight travel charger with multivoltage (100 - 240V) switcher technology. Provides easy and convenient way to charge the phone.

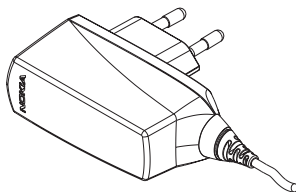

Note: The plug types vary according to different markets.

■ Indoor and Vehicle

Boom Headset (HDB-4)

This small and lightweight headset has a beautiful and distinctive Nokia design. Gives you excellent audio quality and you can answer or end calls by pressing the button on the microphone part of the headset.

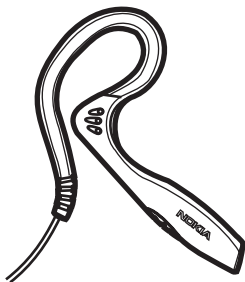

Stereo Headset (HDS-3)

This stereo headset has a beautiful and distinctive Nokia design. Gives you excellent audio quality and you can answer or end calls by pressing the remote control button. A comfortable hands-free solution that makes listening to the phone's FM radio, a pleasure.

■ Vehicle

Mobile Charger (LCH-9)

The multi-voltage Mobile Charger, LCH-9, ensures your phone is always ready for use whenever you travel. This small charger's functional design fits most car lighters and interiors.

A green light indicates that the Mobile Charger is ready for charging. Check the charging status on the phone display. The input voltage can be 12 or 24 V DC, negative grounding.

Avoid prolonged charging with the Mobile Charger when the car engine is not running; this may cause the battery of your car to drain. Note also that in some cars the cigarette lighter plug is not provided with electricity if the ignition is switched off. Verify that the green LED light is on.

8. Care and Maintenance

Your phone is a product of superior design and craftsmanship and should be treated with care. The suggestions below will help you to fulfil any warranty obligations and to enjoy this product for many years.

- Keep the phone and all its parts and accessories out of the reach of small children.
- Keep the phone dry. Precipitation, humidity and all types of liquids or moisture can contain minerals that will corrode electronic circuits.
- Do not use or store the phone in dusty, dirty areas. Its moving parts can be damaged.
- Do not store the phone in hot areas. High temperatures can shorten the life of electronic devices, damage batteries, and warp or melt certain plastics.
- Do not store the phone in cold areas. When it warms up (to its normal temperature), moisture can form inside, which may damage electronic circuit boards.
- Do not attempt to open the phone. Non-expert handling may damage it.
- Do not drop, knock or shake the phone. Rough handling can break internal circuit boards.

- Do not use harsh chemicals, cleaning solvents, or strong detergents to clean the phone.
- Do not paint the phone. Paint can clog the moving parts and prevent proper operation.
- Use only the supplied or an approved replacement antenna. Unauthorised antennas, modifications or attachments could damage the phone and may violate regulations governing radio devices.

All of the above suggestions apply equally to your phone, battery, charger or any accessory. If any of them is not working properly, take it to your nearest qualified service facility. The personnel there will assist you and, if necessary, arrange for service.

9. Important Safety Information

■ Traffic Safety

Do not use a hand-held telephone while driving a vehicle. Always secure the phone in its holder; do not place the phone on the passenger seat or where it can break loose in a collision or sudden stop.

Remember road safety always comes first!

■ Operating environment

Remember to follow any special regulations in force in any area and always switch off your phone whenever it is forbidden to use it, or when it may cause interference or danger.

Use the phone only in its normal operating positions.

Parts of the phone are magnetic. Metallic materials may be attracted to the phone, and persons with a hearing aid should not hold the phone to the ear with the hearing aid. Always secure the phone in its holder, because metallic materials may be attracted by the earpiece. Do not place credit cards or other magnetic storage media near the phone, because information stored on them may be erased.

■ Electronic devices

Most modern electronic equipment is shielded from radio frequency (RF) signals. However, certain electronic equipment may not be shielded against the RF signals from your wireless phone.

Pacemakers

Pacemaker manufacturers recommend that a minimum separation of 20 cm (6 inches) be maintained between a handheld wireless phone and a pacemaker to avoid potential interference with the pacemaker. These recommendations are consistent with the independent research by and recommendations of Wireless Technology Research. Persons with pacemakers:

- Should always keep the phone more than 20 cm (6 inches) from their pacemaker when the phone is switched on;
- Should not carry the phone in a breast pocket;
- Should use the ear opposite the pacemaker to minimise the potential for interference.
- If you have any reason to suspect that interference is taking place, switch off your phone immediately.

Hearing aids

Some digital wireless phones may interfere with some hearing aids. In the event of such interference, you may want to consult your service provider.

Other medical devices

Operation of any radio transmitting equipment, including cellular phones, may interfere with the functionality of inadequately protected medical devices. Consult a physician or the manufacturer of the medical device to determine if they are adequately shielded from external RF energy or if you have any questions. Switch off your phone in health care facilities when any regulations posted in these areas instruct you to do so. Hospitals or health care facilities may be using equipment that could be sensitive to external RF energy.

Vehicles

RF signals may affect improperly installed or inadequately shielded electronic systems in motor vehicles (e.g. electronic fuel injection systems, electronic anti-skid (anti-lock) braking systems, electronic speed control systems, air-bag systems). Check with the manufacturer or its representative regarding your vehicle. You should also consult the manufacturer of any equipment that has been added to your vehicle.

Posted facilities

Switch your phone off in any facility where posted notices so require.

Potentially explosive atmospheres

Switch off your phone when in any area with a potentially explosive atmosphere and obey all signs and instructions. Sparks in such areas could cause an explosion or fire resulting in bodily injury or even death.

Users are advised to switch off the phone when at a refuelling point (service station). Users are reminded of the need to observe restrictions on the use of radio equipment in fuel depots (fuel storage and distribution areas), chemical plants or where blasting operations are in progress.

Areas with a potentially explosive atmosphere are often but not always clearly marked. They include below deck on boats; chemical transfer or storage facilities; vehicles using liquified petroleum gas (such as propane or butane); areas where the air contains chemicals or particles, such as grain, dust or metal powders; and any other area where you would normally be advised to turn off your vehicle engine.

Vehicles

Only qualified personnel should service the phone, or install the phone in a vehicle. Faulty installation or service may be dangerous and may invalidate any warranty which may apply to the unit.

Check regularly that all wireless phone equipment in your vehicle is mounted and operating properly.

Do not store or carry flammable liquids, gases or explosive materials in the same compartment as the phone, its parts or accessories.

For vehicles equipped with an air bag, remember that an air bag inflates with great force. Do not place objects, including both installed or portable wireless equipment in the area over the air bag or in the air bag deployment area. If in-vehicle wireless equipment is improperly installed and the air bag inflates, serious injury could result.

Using your phone while in the air is prohibited. Switch off your phone before boarding an aircraft. The use of wireless telephones in an aircraft may be dangerous to the operation of the aircraft, disrupt the wireless telephone network and may be illegal.

Failure to observe these instructions may lead to suspension or denial of telephone services to the offender, or legal action or both.



■ Emergency calls



Important: This phone, like any wireless phone, operates using radio signals, wireless and landline networks as well as user-programmed functions. Because of this, connections in all conditions can not be guaranteed. Therefore, you should never rely solely upon any wireless phone for essential communications (e.g. medical emergencies).

Emergency calls may not be possible on all wireless phone networks or when certain network services and/or phone features are in use. Check with local service providers.

To make an emergency call:

1. If the phone is not on, switch it on. Check for adequate signal strength. Some networks may require that a valid SIM card is properly inserted in the phone.
2. Press  as many times as needed (e.g. to exit a call, to exit a menu, etc.) to clear the display and ready the phone for calls.
3. Key in the emergency number for your present location (e.g. 112, 911 or other official emergency number). Emergency numbers vary by location.
4. Press the  key.

If certain features are in use, you may first need to turn those features off before you can make an emergency call. Consult this guide and your local cellular service provider.

When making an emergency call, remember to give all the necessary information as accurately as possible. Remember that your wireless phone may be the only means of communication at the scene of an accident – do not cut off the call until given permission to do so.

■ Certification information (SAR)

THIS MODEL PHONE MEETS INTERNATIONAL GUIDELINES FOR EXPOSURE TO RADIO WAVES.

Your mobile phone is a radio transmitter and receiver. It is designed and manufactured not to exceed the limits for exposure to radio frequency (RF) recommended by international guidelines (ICNIRP). These limits are part of comprehensive guidelines and establish permitted levels of RF energy for the general population. The guidelines were developed by independent scientific organisations through periodic and thorough evaluation of scientific studies. The guidelines include a substantial safety margin designed to assure the safety of all persons, regardless of age and health.

The exposure standard for mobile phones employs a unit of measurement known as the Specific Absorption Rate, or SAR. The SAR limit stated in the international guidelines is 2.0 W/kg*. Tests for SAR are conducted using standard operating positions with the phone transmitting at its highest certified power level in all tested frequency bands. Although the SAR is determined at the highest certified power level, the actual SAR of the phone while operating can be well below the maximum value. This is because the phone is designed to operate at multiple power levels so as to use only the power required to reach the network. In general, the closer you are to a base station, the lower the power output of the phone.

The highest SAR value for this model phone when tested for use at the ear is 0.56 W/kg. While there may be differences between the SAR levels of various phones and at various positions, they all meet the relevant international guidelines for RF exposure.

This product meets RF exposure guidelines when used either in the normal use position against the ear or when positioned at least 1.5 cm away from the body. When a carry case, belt clip or holder is used for body-worn operation, it should not contain metal and should position the product at least 1.5 cm away from your body.

* The SAR limit for mobile phones used by the public is 2.0 watts/kilogram (W/kg) averaged over ten grams of body tissue. The guidelines incorporate a substantial margin of safety to give additional protection for the public and to account for any variations in measurements. SAR values may vary depending on national reporting requirements and the network band. For SAR information in other regions please look under product information at www.nokia.com.

Index

SYMBOLS

(E) GPRS xi

A

About accessories viii
Access codes ix
Accessing a menu function 12
Adding an image to a saved name or number 27
Alarm clock 42
Alternative ways to access the functions in this menu 25
Answering or rejecting an incoming call 8
Applications (Menu 8) 44

B

Basic functions 7
Basic step for accessing and using browser services 47
Battery 54
Battery information 53
 type 54
Bookmarks 50
Boom Headset (HDB-4) 55
Browser security 51
 browser security
 security module for WAP applications 51
Browsing the pages of a service 49

C

Calculator 44
Calendar 42
Call counters and call timers 25
Call settings 33
Care and Maintenance 56
Certification information (SAR) 60
Changing the covers 4
Charging and Discharging 53
Charging the battery 5
Collection 45
Connectivity 32
Connectors, flashlight and camera 1
Contacts (Menu 3) 25
Copying contacts 28

D

Deleting contacts 27
Deleting messages 22
Disconnecting from a browser service 49
Display settings 30
Downloading content and applications x

E

Editing a name, number or text item 27
Electronic devices 57
Emergency calls 59
Emptying the cache memory 51
Enhancement settings 35

F

Flashlight 2
Functions available during a call 8

G

Gallery (Menu 5) 37
Games 45
General information ix
General instructions on writing text 11
Genuine Enhancements 54
Getting started 3
Go to (Menu 10) 52

I

Info messages 22
Installing the SIM card and the battery 3

K

Keypad lock (Keyguard) 9
Keys 1

M

Making a call 7
Making a connection to a browser service 48
Media (Menu 6) 39
 menu
 list of functions 13
Menu functions 16

Message settings 23
Messages (Menu 1) 16
Missed, received and dialled calls 24
Mobile Charger (LCH-9) 55
Multimedia messages (MMS) 19

N

Network services viii
Nokia PC Suite software ix

O

Operating environment 57
Options for the files in the gallery 38
Organiser (Menu 7) 42
Other functions related to the contacts list 28

P

Personal shortcuts 32
Phone settings 34
Potentially explosive atmospheres 58
Predictive text input 9
Profiles 29

R

Radio 40
Restore factory settings 37

S

SAFETY vi
Safety information 57
SAR value 60
Saving names and phone numbers 26
Searching for a name in the contacts 27
Security settings 36
Selecting the settings for contacts 26
Service commands 24
Service inbox 50
Services (Menu 9) 46
Setting up the phone for a browser service 47
Settings (Menu 4) 29
Shared memory x
SIM services (Menu 11) 52
Standby mode and display indicators 1
Stereo Headset (HDS-3) 55
Stickers in the sales package ix
Switching the phone on and off 5

T

Text and picture messages (SMS) 16
Time and date settings 31
Tone settings 29
Traffic Safety 57

U

Using the loudspeaker 9
Using the menu 12
Using traditional text input 10

V

Vehicles 58
Voice messages 22
Voice recorder 41

W

WAP services
 security module in SIM 51
Writing text 9

Y

Your phone 1